

WATER METER SUMMARY				
BL Station	Lt./Rt.	Service (Long or Short)	Address	As Built
6+63	Rt.	Long	2822 S. LARKIN	
6+72	Lt.	Short	2821 S. LARKIN	
7+28	Rt.	Long	2816 S. LARKIN	
7+31	Lt.	Short	2815 S. LARKIN	
7+91	Rt.	Long	2810 S. LARKIN	
7+92	Lt.	Short	2809 S. LARKIN	

WATER METER SUMMARY				
BL Station	Lt./Rt.	Service (Long or Short)	Address	As Built
8+47	Lt.	Short	2801 S. LARKIN	
8+60	Rt.	Long	2802 S. LARKIN	
10+26	Rt.	Long	2752 S. LARKIN	
10+60	Lt.	Short	2751 S. LARKIN	
11+35	Rt.	Long	2746 S. LARKIN	
11+41	Lt.	Short	2745 S. LARKIN	

WATER METER SUMMARY				
BL Station	Lt./Rt.	Service (Long or Short)	Address	As Built
12+10	Rt.	Long	2740 S. LARKIN	
12+19	Lt.	Short	2739 S. LARKIN	

Contractor to coordinate with Westar to support pole during construction.

Replace Wheel Chair Ramp

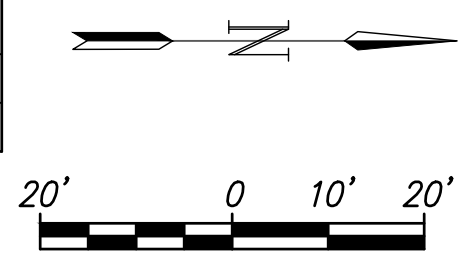

F:\Projects\Projects 4700-4799\4701W (Rose Marie waterline replacement)\LINE 13 - Larkin 1-2.dwg

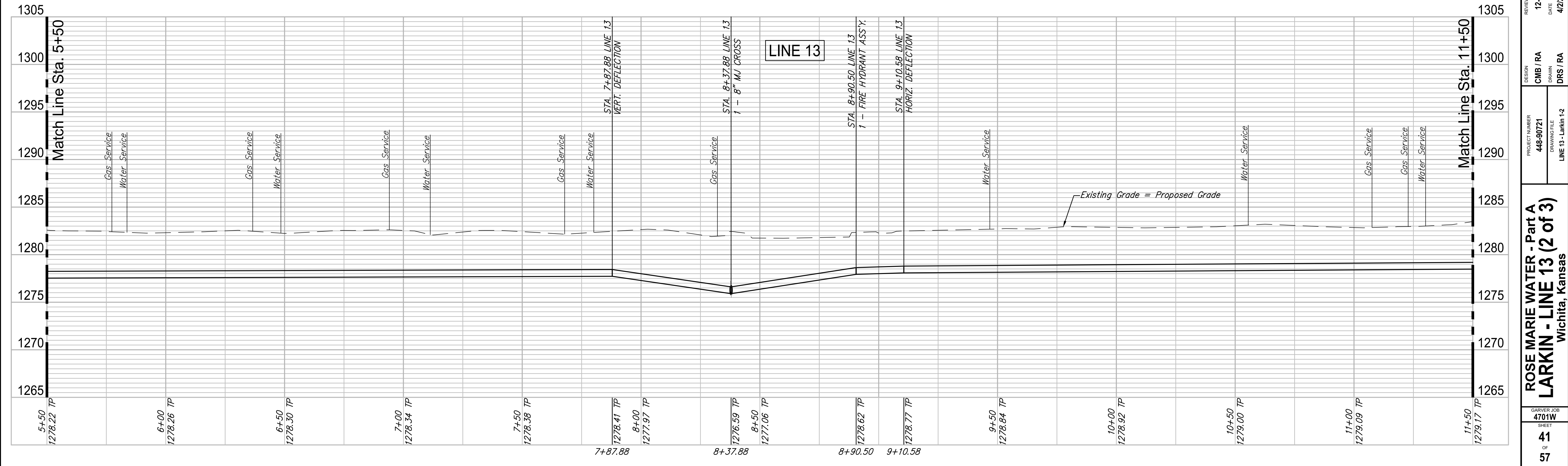

REVIEW: 12-7-16
 DATE: 4/20/18
 DESIGN: CMB / RA
 DRAWING FILE: LINE 13 - Larkin 1-2
 DRS / RA
ROSE MARIE WATER - Part A
LARKIN - LINE 13 (2 of 3)
 Wichita, Kansas
 GARVER JOB NO. 4701W
 SHEET NO. 41 OF 57
 © Copyright 2018, Garver