

N 1669113.96 E 1654523.86  
 STA. 9+60.93, LINE 16 =  
 STA. 13+77.07 JUMP, 25.00' LT.  
 1-8" MJ CROSS  
 2-8" MJ ANCHORED GV (E & W)

STA. 12+91.58 - CONCRETE ENCASE  
 SANITARY SEWER LINE 10' LT. & RT.  
 OF WATERLINE CROSSING.

N 1669122.30 E 1654972.86  
 STA. 14+10.00, LINE 16 =  
 STA. 18+26.14 JUMP, 25.00' LT.  
 1-FIRE HYDRANT ASS'Y. (S)  
 L = 4'  
 BURY LINE ELEV. 1282.10  
 VALVE BOX ELEV. 1282.30

N 1669123.63 E 1655044.67  
 STA. 14+81.82, LINE 16 =  
 STA. 18+97.97 JUMP, 25.00' LT.  
 CONNECT TO EXIST. 12" MAIN  
 \* 1-8" TAPPING VALVE  
 \* 1-12"x8" TAPPING SLEEVE  
 \*\* 1-6" VALVE BOX ASS'Y.  
 VALVE BOX ELEV. 1282.30  
 \* SUPPLIED AND INSTALLED BY  
 CITY OF WICHITA WATER DEPT.  
 \*\* SUPPLIED BY C.O.W.  
 INSTALLED BY CONTRACTOR

WATER METER SUMMARY				
BL Station	Lt./Rt.	Service (Long or Short)	Address	As Built
14+12 Δ	Lt.	Short	1602 E. JUMP	
15+57	Rt.	Long	1609 E. JUMP	
15+69 **	Lt.	Short	1610 E. JUMP	
15+90 **	Lt.	Short	1620 E. JUMP	
16+10	Rt.	Long	1615 E. JUMP	
16+48 **	Lt.	Short	1630 E. JUMP	

WATER METER SUMMARY				
BL Station	Lt./Rt.	Service (Long or Short)	Address	As Built
16+66	Rt.	Long	1621 E. JUMP	
17+90 *1	Rt.	Long	1625 E. JUMP	
17+90 *1	Rt.	Long	1627 E. JUMP	
17+99 **	Lt.	Short	1640 E. JUMP	

Δ 1602 Jump Street's current meter is connected to a main across Greenwood. Re-Connect to new main along Jump Street.

\*1 - This duplex shares the same tap and the same meter box. 1625 & 1627 E. Jump.

\*\* These meters are single, but are connected to 4 addresses each.

Contractor to coordinate with Westar to support pole during construction.

Replace Wheel Chair Ramp

Existing Pavement, Curb and Gutter to be Removed and Replaced as necessary for construction. No additional pay shall be made for this work, Subsidiary to other pay items.

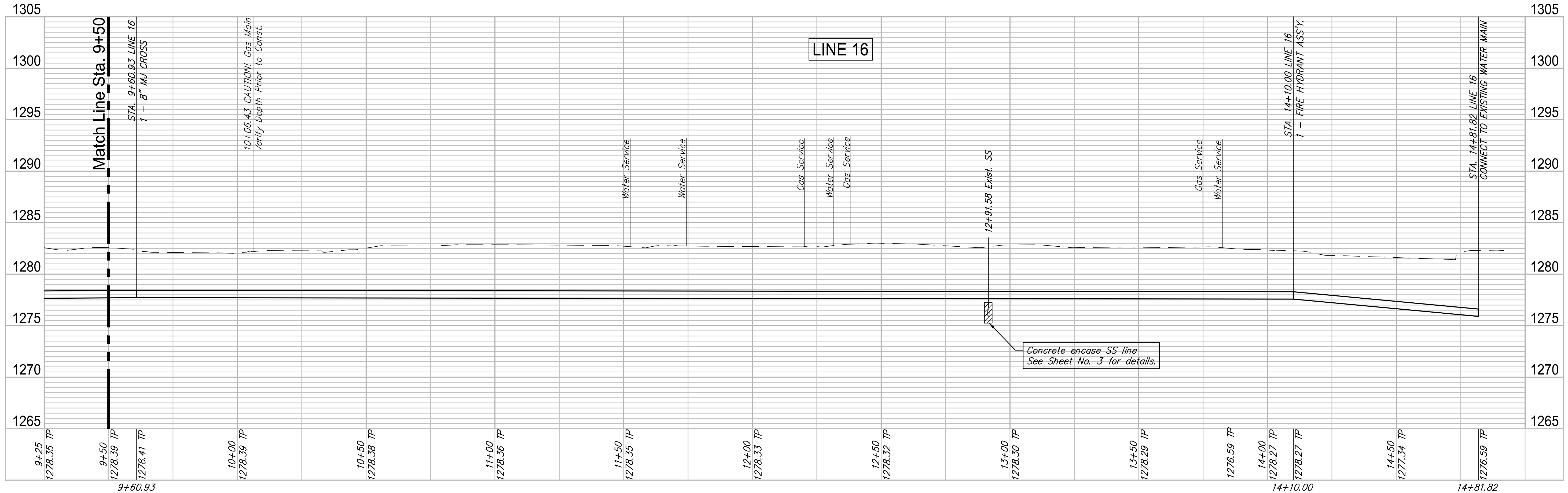

REVIEW: 12-7-16  
 DATE: 4/20/18  
 DESIGN: CMB / RA  
 DRAWN: DRS / RA  
 PROJECT NUMBER: 448-90721  
 DRAWING FILE: LINE 16 - Jump St  
**ROSE MARIE WATER - Part A**  
**JUMP - LINE 16 (3 of 3)**  
 Wichita, Kansas  
 GARVER JOB: 4701W  
 SHEET: 49 OF 57  
 © Copyright 2018, Garver