

File: L:\2018\18267011 - Casa Bella Phase 5\Drawings\CD\18267011-Erosion-Control.dwg Last Save: 10/31/2018 10:58 AM Last saved by: MTDolechek
 Last plotted by: Dolechek, Mark T. Plot Style: --- Plot Scale: 1:2,884.9 Plot Date: 10/31/2018 11:28 AM Plotter used: None

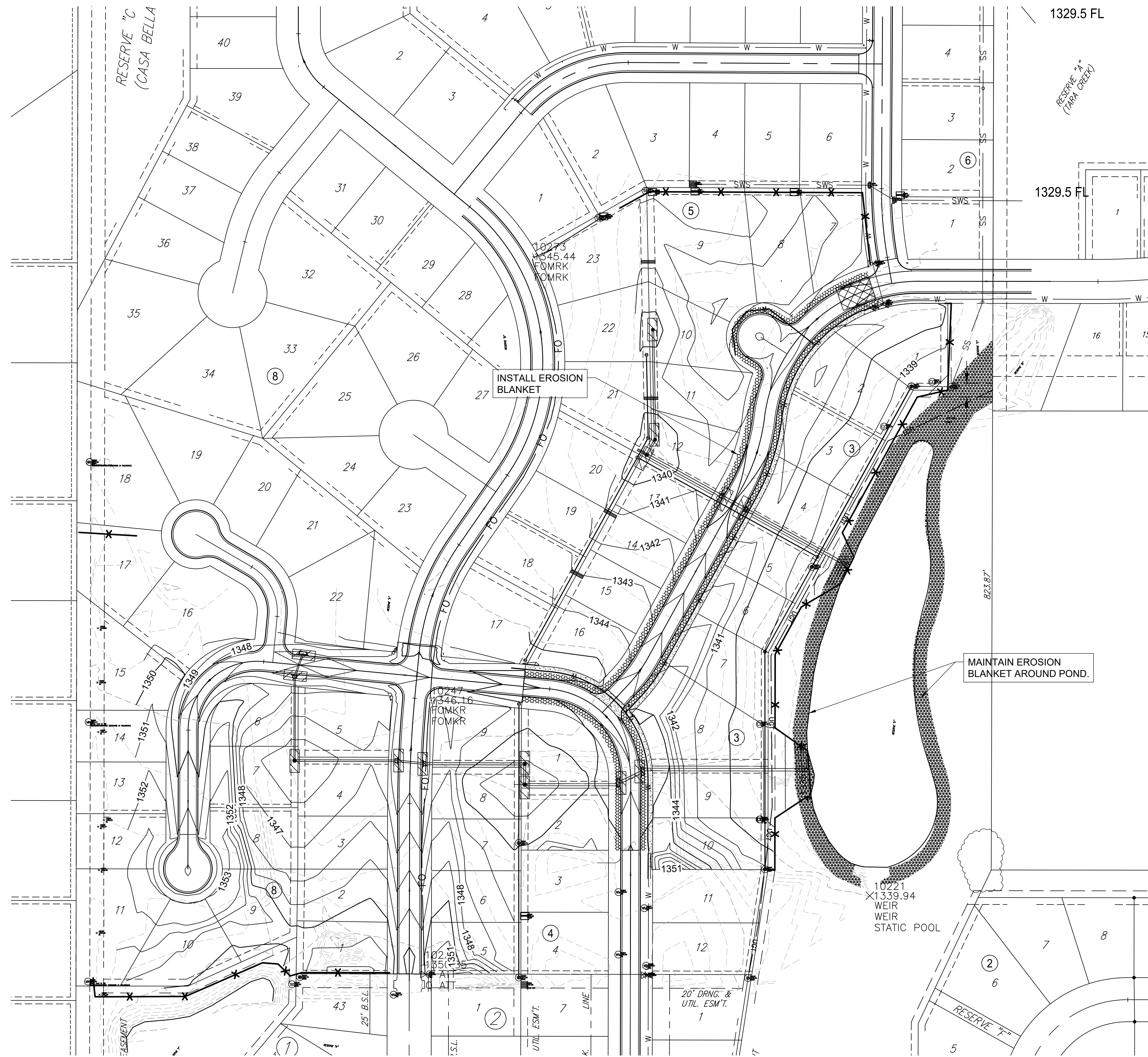

- ### LEGEND
- MAINTAIN Construction Entrance (1 Each)
 - MAINTAIN Silt Fence (2028 L.F.)
 - MAINTAIN Linear Sediment Barrier (80 L.F.)
 - MAINTAIN Inlet Protection (13 Each)
 - MAINTAIN Erosion Blanket (4173 Sq. Yds.)
 - INSTALL Erosion Blanket (1934 Sq. Yds.)

NOTES:

1. All street Right-of-Way and Reserves shall be permanently seeded. All other areas may be temporarily seeded. All seeding per City of Wichita Specifications.
2. Contractor to ensure easements are free of excess silt and properly graded to allow for adequate drainage. Subsidiary to maintaining existing BMPs.

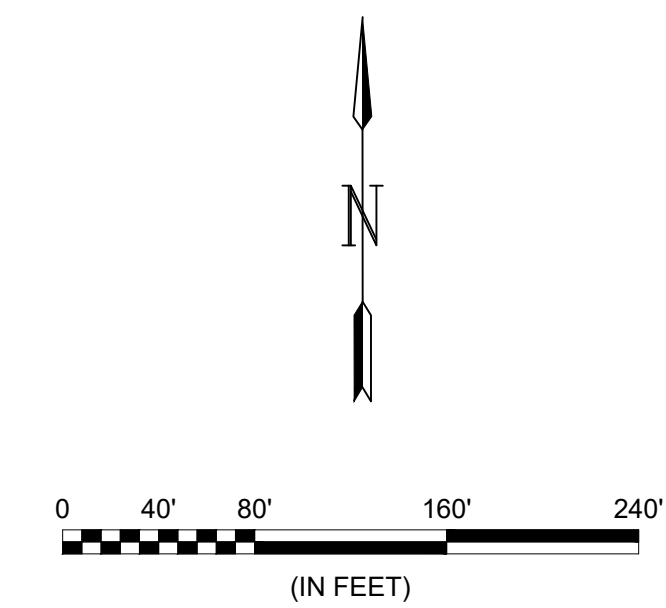

© 2018 GARVER, LLC
 THIS DOCUMENT, ALONG WITH THE IDEAS AND DESIGNS CONVEYED HEREIN, SHALL BE CONSIDERED INSTRUMENTS OF PROFESSIONAL SERVICE AND ARE PROPERTY OF GARVER, LLC. ANY USE, REPRODUCTION, OR DISTRIBUTION OF THIS DOCUMENT, ALONG WITH THE IDEAS AND DESIGN CONTAINED HEREIN, IS PROHIBITED UNLESS AUTHORIZED IN WRITING BY GARVER, LLC OR EXPLICITLY ALLOWED IN THE GOVERNING PROFESSIONAL SERVICES AGREEMENT FOR THIS WORK.



Digitally Signed 10/31/2018

REV.	DATE	DESCRIPTION	BY



CITY OF WICHITA
 WICHITA, KANSAS
 CASA BELLA 2nd ADD.
 PHASE 5 - PAVING

Erosion Control Paving

JOB NO.: 18267011
 DATE: SEPT. 2018
 DESIGNED BY: MTD
 DRAWN BY: DRS

BAR IS ONE INCH ON ORIGINAL DRAWING
 IF NOT ONE INCH ON THIS SHEET, ADJUST SCALES ACCORDINGLY.

DRAWING NUMBER