

PAVING & INCIDENTAL DRAINAGE FOR
CHENEY PUMP STATION
 PAVEMENT REPLACEMENT & REPAIR

©2018
 MKEC Engineering
 All Rights Reserved
 www.mkec.com
 These drawings and their contents, including, but not limited to, all concepts, designs, & ideas are the exclusive property of MKEC Engineering (MKEC), and may not be used or reproduced in any way without the express consent of MKEC.

WEST PAVING PLAN

PROJECT NO. 448-90934

DATE NOV. 2018

SCALE 1"=10'

DESIGNED SLF DRAWN CRM CHECKED SLF

NO. REVISION DATE

SHEET NO.

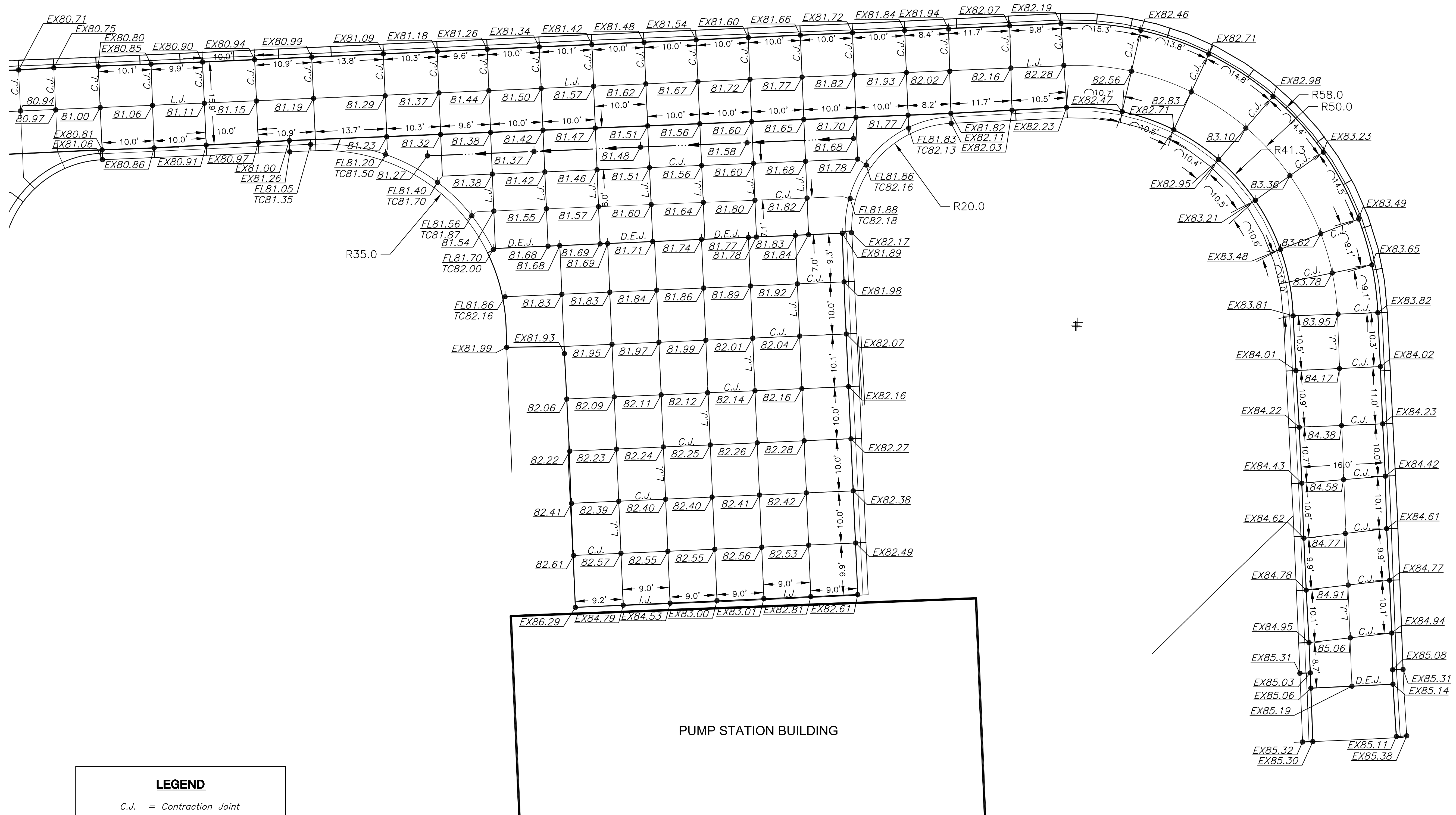

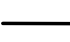
LEGEND	
C.J.	= Contraction Joint
L.J.	= Longitudinal Joint
I.J.	= Isolation Joint
T.J.	= Tied Construction Joint
D.E.J.	= Doweled Expansion Joint
	= Valley Gutter Flow Direction

NOTE:
 1. UNLESS OTHERWISE NOTED, EXISTING CONCRETE PAVEMENT, CURB & GUTTER, OR VALLEY GUTTERS/FLUMES SHALL BE TIED TO THE NEW PAVEMENT WITH #4 BARS (L=1'-0") @ 24" O.C. CONTRACTOR WILL BE REQUIRED TO DRILL AND EPOXY THE BARS INTO THE EXISTING CONCRETE.

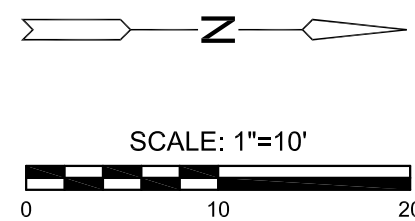

J:\PROJECTS\2018\1601010411_CAD\ONCALLSERVICES_160411 CAD CHENEY PUMP STATION\SHOTS505 CIVIL\PAV\16411_PAV_LDWG
 PLOTTED: Tuesday, November 06, 2018 @ 08:13PM