

J:\PROJECTS\2018\1601010411\_CAD\ONCALLSERVICES\_160411\_CAD\_CHENEY PUMP STATIONS\160411\_PAV.DWG  
 PROJECTS\2018\1601010411\_CAD\ONCALLSERVICES\_160411\_CAD\_CHENEY PUMP STATIONS\160411\_PAV.DWG  
 PLOTTED: Tuesday, November 06, 2018 @ 08:14PM

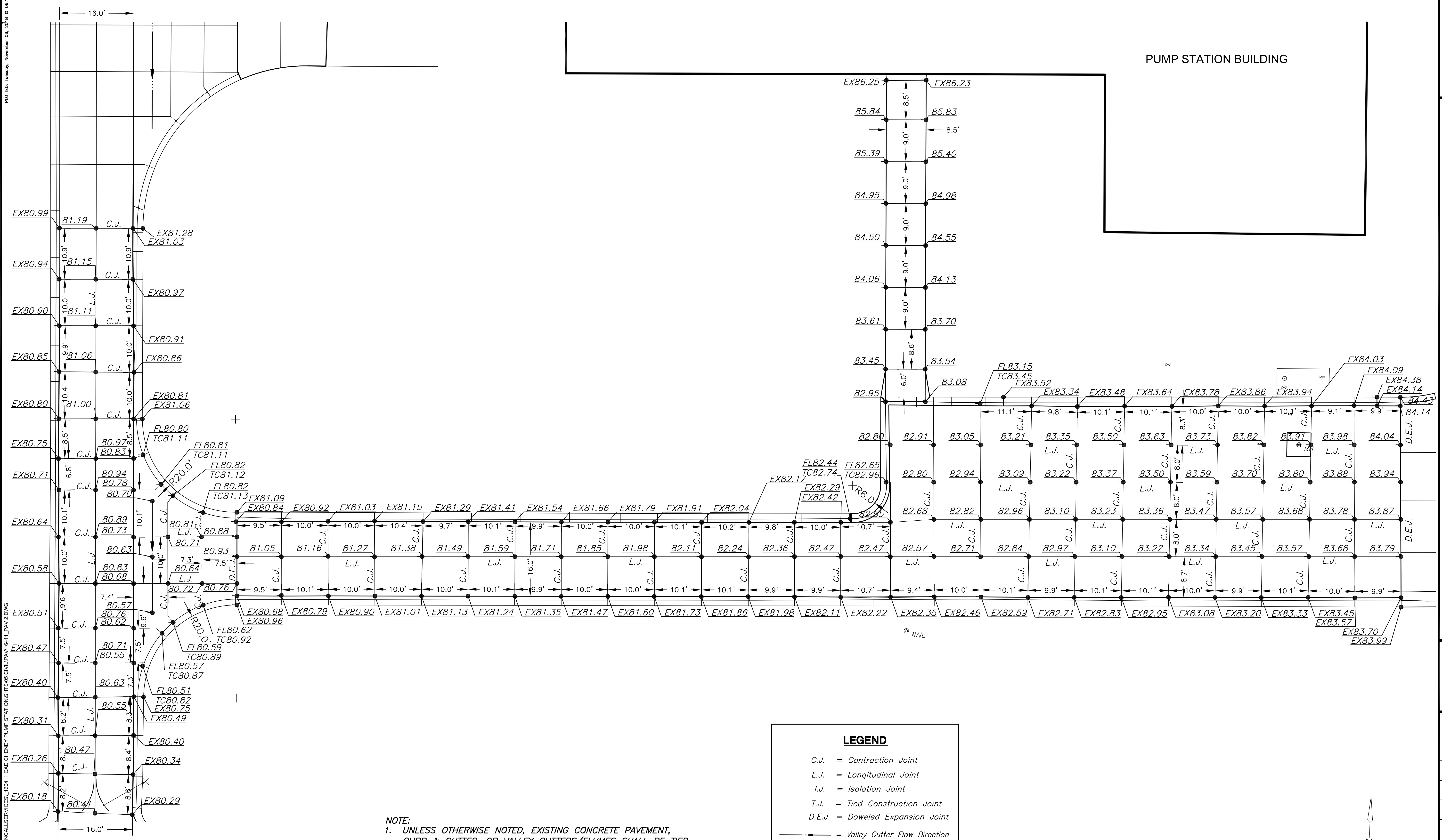

**NOTE:**  
 1. UNLESS OTHERWISE NOTED, EXISTING CONCRETE PAVEMENT, CURB & GUTTER, OR VALLEY GUTTERS/FLUMES SHALL BE TIED TO THE NEW PAVEMENT WITH #4 BARS (L=1'-0") @ 24" O.C. CONTRACTOR WILL BE REQUIRED TO DRILL AND EPOXY THE BARS INTO THE EXISTING CONCRETE.

LEGEND	
C.J.	= Contraction Joint
L.J.	= Longitudinal Joint
I.J.	= Isolation Joint
T.J.	= Tied Construction Joint
D.E.J.	= Doweled Expansion Joint
	= Valley Gutter Flow Direction



PAVING & INCIDENTAL DRAINAGE FOR  
**CHENEY PUMP STATION**  
 PAVEMENT REPLACEMENT & REPAIR

©2018  
 MKEC Engineering  
 All Rights Reserved  
 www.mkec.com  
 These drawings and their contents, including, but not limited to, all concepts, designs, & ideas are the exclusive property of MKEC Engineering (MKEC), and may not be used or reproduced in any way without the express consent of MKEC.

**SOUTH PAVING PLAN**

PROJECT NO.	448-90934	
DATE	NOV. 2018	
SCALE	1"=10'	
DESIGNED	DRAWN	CHECKED
SLF	ABC	SLF
NO.	REVISION	DATE