

**BENCHMARKS:**  
 Chiseled square at the end of the top of curb at the southeast corner of Ridge Port and 37th ST N.  
 Elev. = 1333.05 NAVD88

Chiseled square on the south side of curb inlet on the east side of Lakeway ST  
 Elev. = 1329.58 NAVD88

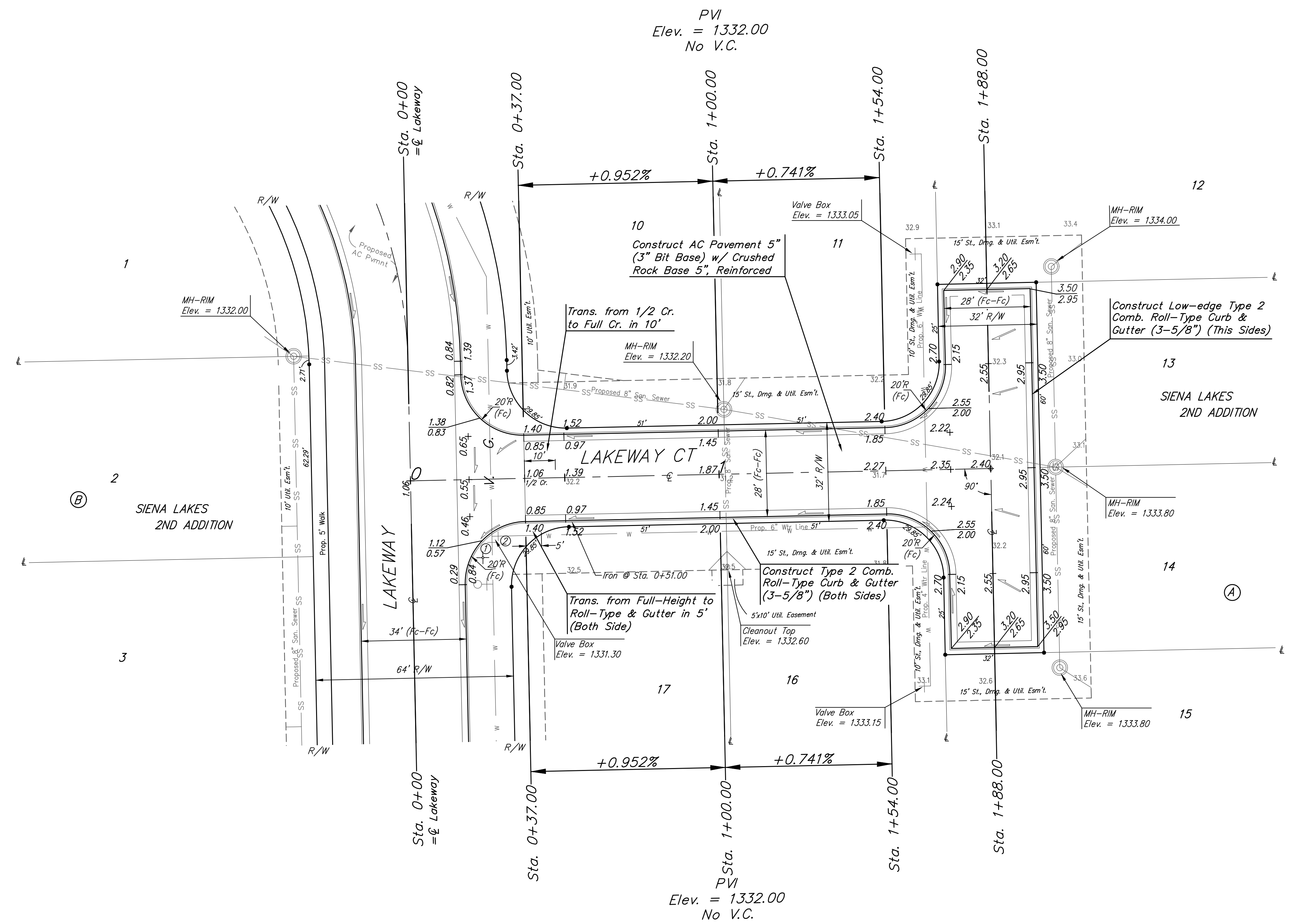
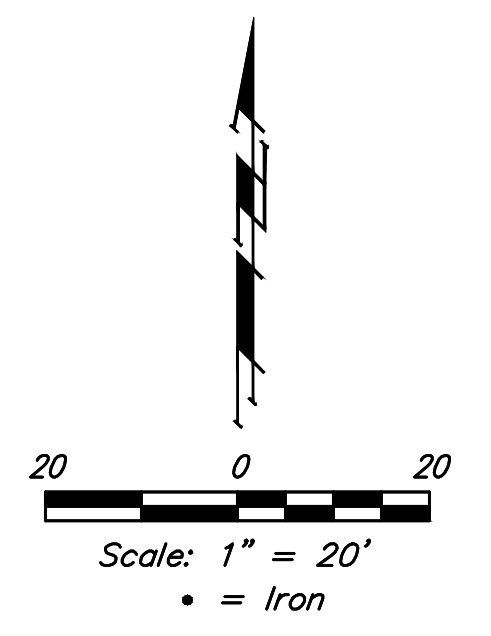

Roll type curb & gutter to be constructed on the pavement on this sheet.  
 Top of curb elevation are given for full height curb.

		Siena Lakes 2nd Addition - Phase I	
		<b>LAKEWAY CT</b>	
Lot 19-Lot 26, Block 2		<small>Baughman Company, P.A. 315 Ellis St. Wichita, KS 67211 P 316-262-7271 F 316-262-0149          ENGINEERING   SURVEYING   PLANNING   LANDSCAPE ARCHITECTURE</small>	
PROJECT NUMBER 472-85177	DESIGN AEG	DRAWN JAK	APPROVED DATE 11/06/18
REVISIONS:	SCALE Noted		
	SHEET <b>10 OF 31</b>		