

PLOTTED: Wednesday, January 23, 2019 @ 01:20PM

J:\PROJECTS\2017\17010143_LANES_STEEPLE BAY_17143_CADD\SHOTS\08_ELECTRICAL LIGHTING\2-63- ELECTRICAL PLANS.DWG

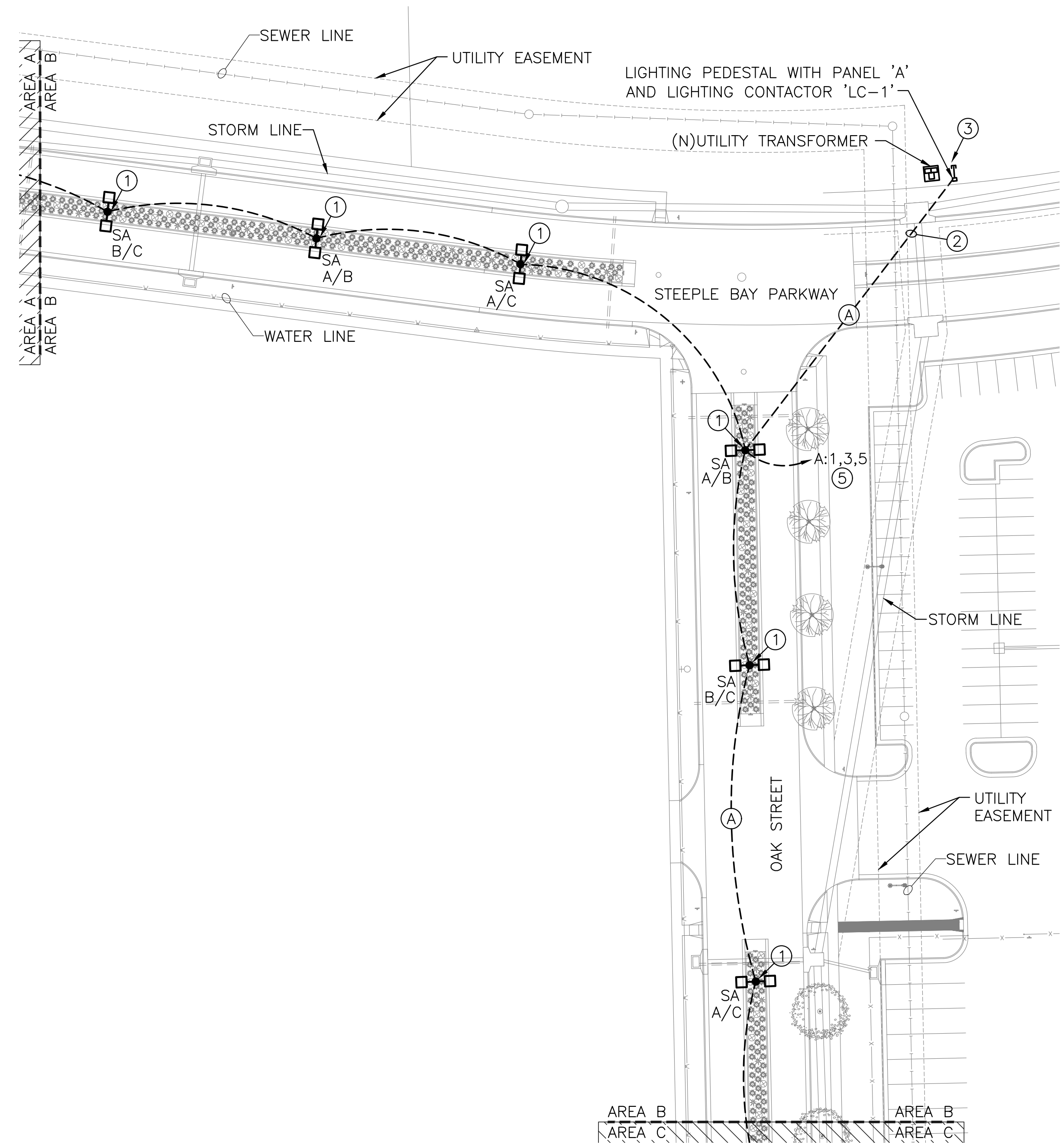

A ELECTRICAL PLAN - AREA B
SCALE: 1"=40'

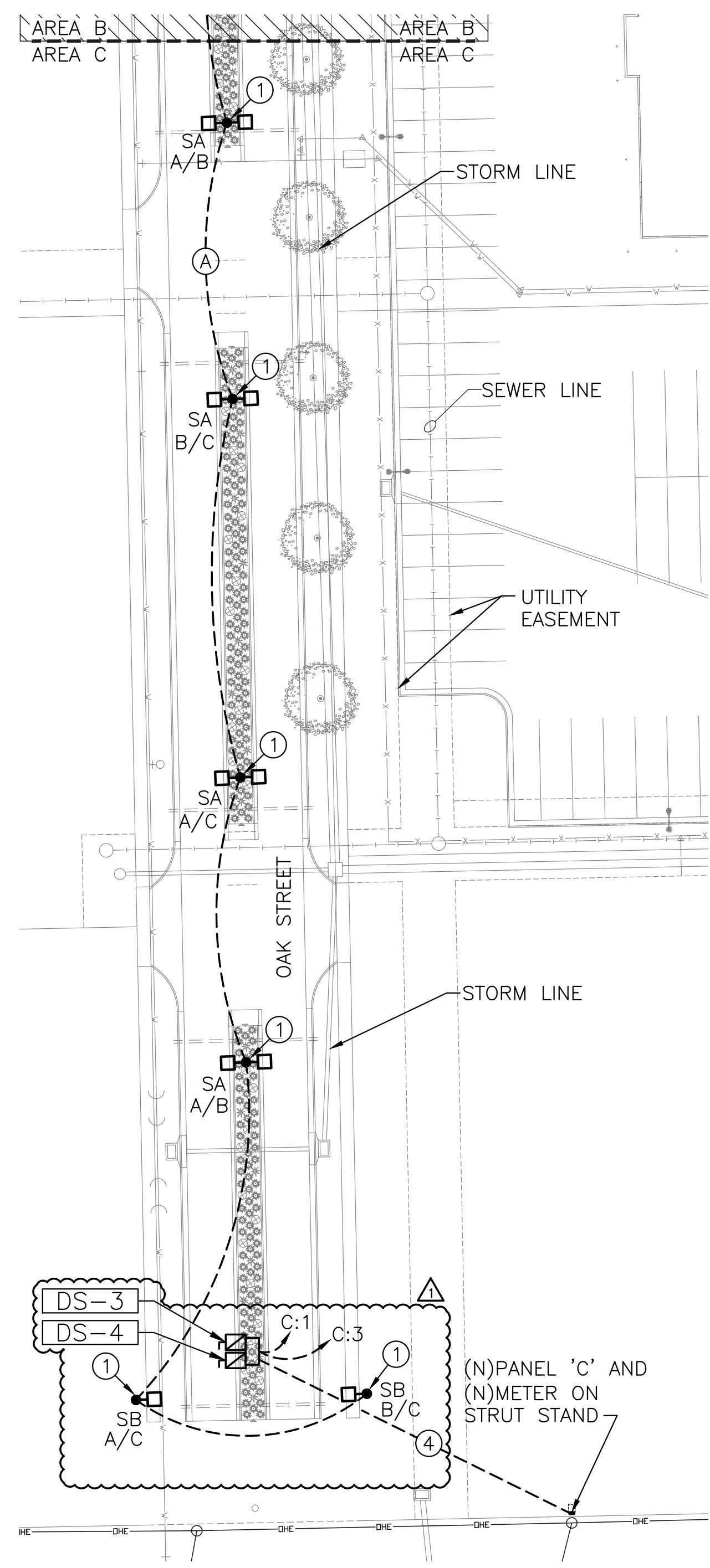

B ELECTRICAL PLAN - AREA C
SCALE: 1"=40'

KEYED NOTES

1. PROVIDE AND INSTALL POLE BASE PER DETAIL 2/05.
2. E.C. SHALL ROUTE (1) 480V CIRCUIT FROM PEDESTAL TO OAK STREET LIGHTING. SEE FEEDER SCHEDULE FOR CONDUIT AND CONDUCTOR SIZE AND TYPE.
3. E.C. SHALL ROUTE (6) 2" SPARE CONDUITS FROM PEDESTAL NORTH, 5'-0" AWAY FROM PEDESTAL. LABEL "SPARE CONDUIT" WITH CONDUIT MARKER. SEE DETAIL 7/05.
4. ROUTE (2) 120V FEEDERS FROM PANEL 'C' TO SIGNAGE LOCATION. ROUTE EACH FEEDER WITH (2)-#12, (1)-#12 IN 1" C. PROVIDE FINAL CONNECTION TO SIGN. COORDINATE WITH SIGN VENDOR.
5. ROUTE CIRCUIT THROUGH LIGHTING CONTACTOR 'LC-1' PER DETAIL 4/05.

FEEDER SCHEDULE

- (A)** (3)-#10, (1)-#10 GND IN 1" C. FOR ENTIRE CIRCUIT. CONDUCTORS UPSIZED FOR VOLTAGE DROP.

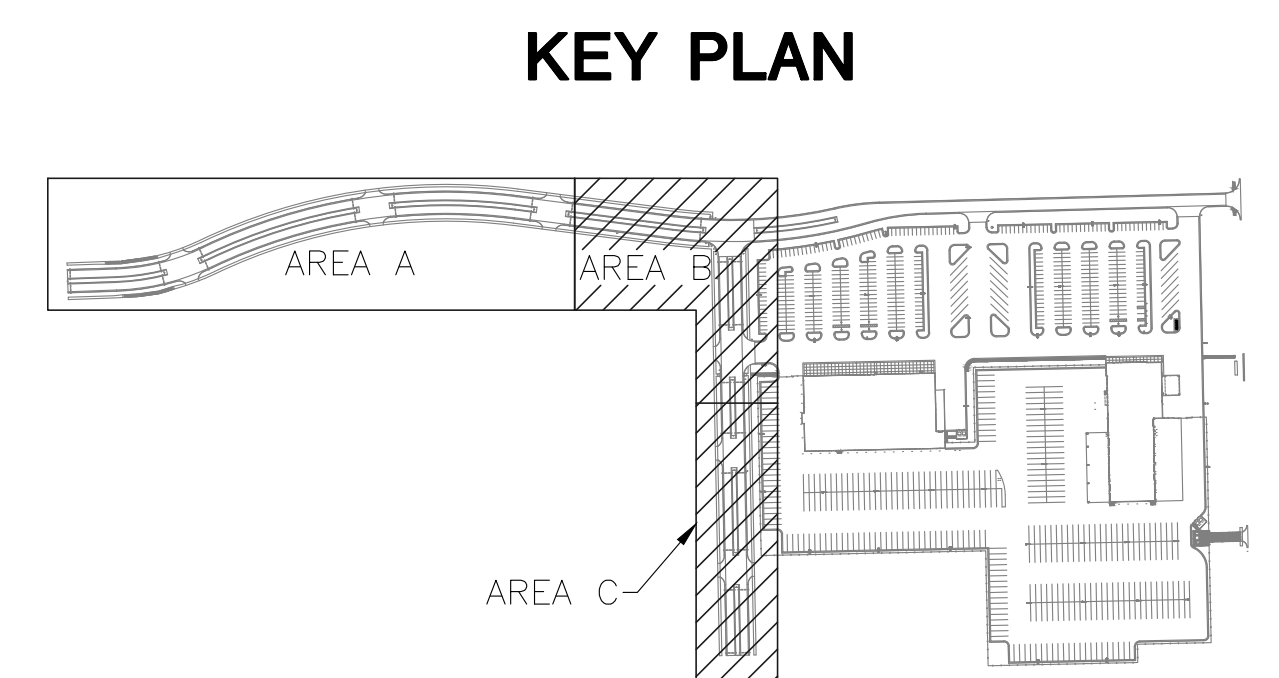

PART A: LIGHTING & LANDSCAPE PLANS FOR
STEEPLE BAY ADDITION
WICHITA, KANSAS



©2019 MKEC Engineering All Rights Reserved www.mkec.com
These drawings and their contents, including, but not limited to, all concepts, designs, & ideas are the exclusive property of MKEC Engineering (MKEC), and may not be used or reproduced in any way without the express consent of MKEC.

ELECTRICAL PLANS

PROJECT NO.	472-85453	
DATE	DEC 2018	
SCALE	1"=40'-0"	
DESIGNED	DRAWN	CHECKED
CNG	ECW	JRBW
1	REVISION 1	01/23/19
NO.	REVISION	DATE
SHEET NO.		
04 OF 07		