

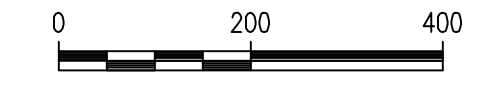

SCALE: 1" = 200'



WATERLINE NO. 1,
See sheet no. 5 - 15

WATERLINE NO. 2,
See sheet no. 16

WATERLINE NO. 3,
See sheet no. 17

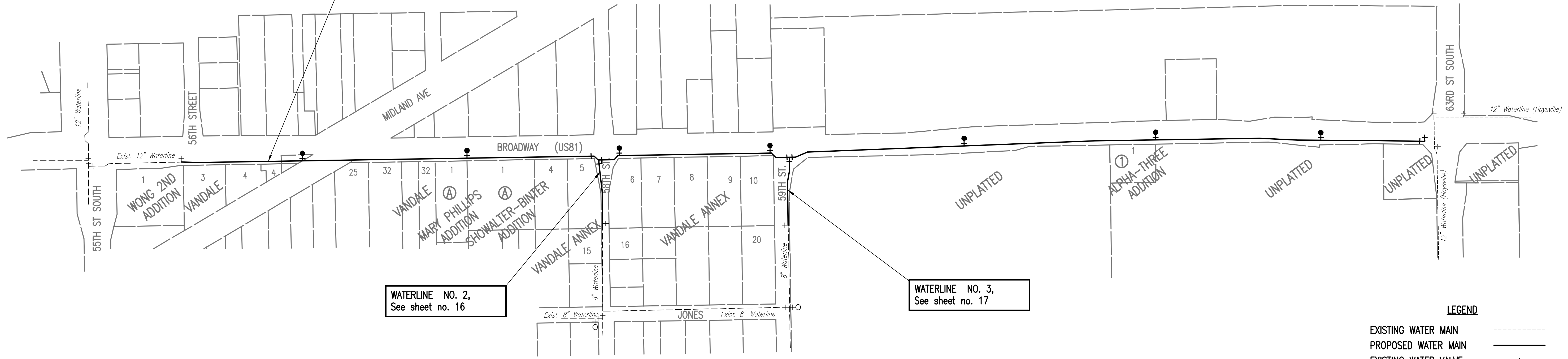

GENERAL NOTES

- ALL CONSTRUCTION WORK AND MATERIAL IN THIS PROJECT SHALL BE INSTALLED IN ACCORDANCE WITH CITY OF WICHITA, KANSAS STANDARD SPECIFICATIONS AND SPECIAL PROVISIONS.
- ALL ELEVATIONS SHOWN ARE NAVD 88 DATUM.
- CONTRACTOR WILL BE REQUIRED TO PROVIDE A MINIMUM ADVANCE NOTICE OF SEVENTY-TWO (72) HOURS TO UTILITY COMPANIES PRIOR TO STARTING ANY EXCAVATION AS FOLLOWS:

KANSAS ONE-CALL 687-2470 or 811

THE CONTRACTOR MUST NOTIFY THE FOLLOWING IN CASE OF AN EMERGENCY:

EMERGENCY DISPATCH 911
COX COMMUNICATIONS 316-260-7745
KANSAS GAS SERVICE 316-832-3126
WESTAR ENERGY 316-261-6264
AT&T 316-268-2008
KANSAS INDUSTRIAL ENERGY SUPPLY 316-832-3126
KDOT - DISTRICT 5, AREA 6 316-744-1271
WICHITA WATER UTILITIES (SS) 316-268-4329
WICHITA WATER UTILITIES (WL) 316-268-4334
WICHITA STORM WATER MANAGEMENT 316-268-4307
HAYSVILLE PUBLIC WORKS 316-529-5940
- THE BURIED UTILITIES AS LOCATED ON THE DRAWINGS ARE APPROXIMATE LOCATIONS ONLY. LOCATION INFORMATION HAS BEEN OBTAINED FROM THE VARIOUS UTILITY COMPANIES AND IS EITHER FROM COMPANY RECORD DRAWINGS OR COMPANY PROVIDED FIELD LOCATIONS. IT SHOULD BE NOTED THAT OTHER BURIED LINES AND CABLES MAY EXIST WHICH ARE NOT SHOWN ON THESE DRAWINGS. THE CONTRACTOR SHALL HAVE ALL BURIED LINES LOCATED AND FLAGGED IN THE FIELD PRIOR TO COMMENCING WORK. THE CONTRACTOR SHALL CONTACT THE ENGINEER AND REVIEW ALL BURIED LINES LOCATED TO DETERMINE IF CONFLICTS EXIST. THE CONTRACTOR SHALL EXERCISE EXTREME CAUTION DURING TRENCHING OPERATIONS TO AVOID DAMAGING THESE LINES. ANY LINES DAMAGED SHALL BE REPLACED OR REPAIRED IMMEDIATELY AS DIRECTED BY THE ENGINEER AT THE CONTRACTOR'S EXPENSE.
- EXISTING UTILITIES AND THEIR LOCATION, AS SHOWN ON THE DRAWINGS, REPRESENT THE BEST INFORMATION OBTAINABLE FOR DESIGN. THE CONTRACTOR WILL BE REQUIRED TO WORK AROUND EXISTING UTILITIES WITHIN THE RIGHT-OF-WAY WHICH DO NOT CONFLICT WITH PROPOSED CONSTRUCTION.
- THE CONTRACTOR SHALL NOT START WORK ON THE PROJECT UNTIL THE PROJECT INSPECTOR IS ASSIGNED TO THE PROJECT AND IS PRESENT ON THE SITE. ANY WORK DONE WITHOUT INSPECTION WILL BE REQUIRED TO BE UNCOVERED FOR INSPECTION.
- EACH BIDDER SHALL VISIT THE SITE OF THE PROJECT BEFORE SUBMITTING THE PROPOSAL FOR THIS WORK SO THAT HE WILL BE FULLY INFORMED OF THE EXISTING FIELD CONDITIONS AND THE OBSTACLES WHICH MIGHT BE ENCOUNTERED. UPON AWARD OF THE CONTRACT THE CONTRACTOR WILL NOT BE GRANTED ANY ADDITIONAL COMPENSATION WITH REGARD TO TIME AND MONEY FOR CONDITIONS THAT MAY HAVE BEEN EVALUATED DURING ANY INSPECTION OF THE SITE.
- THE CONTRACTOR SHALL GIVE ALL PROPERTY OWNERS AND/OR TENANTS OF DEVELOPED PROPERTY DIRECTLY ABUTTING THE CONSTRUCTION OF THIS PROJECT A MINIMUM OF TEN (10) DAYS ADVANCE NOTICE PRIOR TO START OF CONSTRUCTION.
- THE CONTRACTOR SHALL BE RESPONSIBLE FOR PRESERVING PROPERTY IRONS. THE CONTRACTOR SHALL BE REQUIRED TO RE-ESTABLISH ANY PROPERTY IRONS WHICH ARE DAMAGED OR DESTROYED BY HIS CONSTRUCTION OPERATIONS. SUCH IRONS SHALL BE RE-ESTABLISHED BY A LICENSED LAND SURVEYOR IN ACCORDANCE WITH STATE LAWS. ALL COSTS FOR THIS WORK SHALL BE SUBSIDIARY TO "SITE RESTORATION".

- THE CONTRACTOR SHALL CONTAIN HIS OPERATIONS TO PERMIT LOCAL AND EMERGENCY TRAFFIC THROUGH AND ACROSS CONSTRUCTION AT ALL TIMES. THE CONTRACTOR SHALL ERECT WARNING SIGNS, FLASHING LIGHTS, AND BARRICADES IN COMPLIANCE WITH THE MANUAL ON UNIFORM TRAFFIC CONTROL DEVICES (MUTCD) TO ENSURE SAFETY AS DIRECTED IN THE GENERAL CONDITIONS. THE CONTRACTOR SHALL LIMIT THE EXTENT OF TRENCH TO REMAIN OPEN OVERNIGHT AND WEEKENDS TO LESS THAN 50 FEET.
- EASEMENTS AND RIGHT-OF-WAY PROVIDED BY THE OWNER FOR THE PROJECT ARE SHOWN ON THE DRAWINGS. THE CONTRACTOR SHALL BE RESPONSIBLE FOR THE ACQUISITION OF ANY ADDITIONAL TEMPORARY EASEMENTS OR RIGHT-OF-WAY THAT HE DESIRES TO USE IN COMPLETING THE WORK.
- THE WATER MAIN SHALL BE CONSTRUCTED ON THE ALIGNMENT SHOWN BY THE DRAWINGS. TREES AND SHRUBS IN PUBLIC RIGHT-OF-WAY WHICH ARE IN DIRECT CONFLICT WITH PROPOSED NEW CONSTRUCTION SHALL BE REMOVED BY THE CONTRACTOR WITH THE ENGINEER'S APPROVAL. TREES AND SHRUBS WHICH ARE NOT IN DIRECT CONFLICT WITH PROPOSED NEW CONSTRUCTION SHALL BE SAVED AND PROTECTED FROM DAMAGE. THE COST FOR ANY NECESSARY TREE TRIMMING, CLEARING AND/OR GRUBBING SHALL BE SUBSIDIARY TO "SITE CLEARING". FULL TREE REMOVAL SHALL BE NOTED ON THE PLANS AND SHALL BE BID AS "TREE REMOVED, LARGE" OR "TREE REMOVED, SMALL".
- RUBBLE FROM THE REMOVAL OF MISCELLANEOUS STRUCTURES INCLUDING ANY TREES REMOVED AND TREE TRIMMINGS AND EXCESS EXCAVATED MATERIAL SHALL BE DISPOSED OF ON SITES PROVIDED BY THE CONTRACTOR. THESE SITES SHALL ALSO BE APPROVED OF BY THE ENGINEER AS TO SUITABILITY, APPEARANCE, AND SITE LOCATION. LOCATIONS THAT, IN THE OPINION OF THE ENGINEER, LEAVE AN UNSIGHTLY APPEARANCE WILL NOT BE APPROVED. ALL DISPOSAL SITES MUST BE APPROVED BY THE KANSAS DEPARTMENT OF HEALTH AND ENVIRONMENT. MATERIAL EITHER STOCKPILED OR DISPOSED OF IN A FLOOD PLAIN WILL REQUIRE A KANSAS STATE BOARD OF AGRICULTURE PERMIT. ANY MATERIAL DUMPED IN WATERS OF THE UNITED STATES OR WETLANDS IS SUBJECT TO U.S. CORPS OF ENGINEERS PERMITTING REGULATIONS. ANY MATERIAL BURIED OR STOCKPILED BEYOND APPROVED CONSTRUCTION LIMITS MAY REQUIRE ARCHAEOLOGICAL INVESTIGATIONS UNLESS BURIED IN A PREVIOUSLY APPROVED DISPOSAL LOCATION.
- ALL LAWN/TURF AREAS DISTURBED BY CONSTRUCTION OF THE PROPOSED IMPROVEMENTS SHALL BE RESTORED WITH THE SAME GRASS/SOD AS EXISTING. APPROXIMATE TYPES AND LIMITS TO BE USED ARE SOD-FESCUE NORTH OF MIDLAND AVENUE, SOD-BUFFALO BETWEEN MIDLAND AVENUE AND 59TH STREET, AND SEED SOUTH OF 59TH STREET (CONTRACTOR TO VERIFY AND MATCH EXISTING). RESTORATION OF DISTURBED AREAS SHALL INCLUDE, BUT NOT BE LIMITED TO, TOP SOIL PREPARATION, SEEDING, MULCH, AND/OR RESEEDING. ALL SEEDING/SODDING WORK SHALL BE IN ACCORDANCE WITH THE CITY OF WICHITA STANDARD SPECIFICATIONS AND THE CITY OF WICHITA ADMINISTRATIVE REGULATION NO. AR6.5 WHICH GOVERNS CLEANUP AND RESTORATION OR REPLACEMENT FOLLOWING CONSTRUCTION. ALL COSTS FOR THIS WORK SHALL BE SUBSIDIARY TO THE LUMP SUM PRICE BID FOR "SEEDING".
- THE CONTRACTOR SHALL SEED ALL AREAS DISTURBED BY CONSTRUCTION ACTIVITIES WITH TEMPORARY RYE GRASS. RYE GRASS SEED SHALL BE PLANTED AT A MINIMUM RATE OF SIX (6) POUNDS PER ONE THOUSAND (1,000) SQUARE FEET. THIS TEMPORARY SEEDING MAY BE OMITTED ONLY IF OTHER SEEDING IS REQUIRED IN ACCORDANCE WITH GENERAL NOTE NO. 14 ABOVE. TEMPORARY SEEDING OR PERMANENT SEEDING/SODDING SHALL BE APPLIED WITHIN 14 DAYS AFTER THE AREA HAS BEEN DISTURBED. ALL COSTS FOR TEMPORARY RYE GRASS SHALL BE CONSIDERED SUBSIDIARY TO "SEEDING, TEMPORARY".
- THE CONTRACTOR SHALL RESTORE ALL DITCHES, SWALES, ROAD SHOULDERS, AND BANKS TO THEIR ORIGINAL SLOPES AND GRADES WHERE EXISTING ENTRANCE PIPE, DRAINAGE PIPE, SIGNS, FENCES, IRRIGATION, LANDSCAPING, ETC., CONFLICT WITH THE PROPOSED WORK HEREIN, THEY SHALL BE REMOVED AND REPLACED OR RESET, UNLESS OTHERWISE NOTED ON THE DRAWINGS, THE REPLACEMENT OF ALL THE AFOREMENTIONED ITEMS SHALL BE CONSIDERED SUBSIDIARY TO "SITE CLEARING" AND "SITE RESTORATION".
- THE CONTRACTOR SHALL TAKE CARE TO PREVENT SILT AND DEBRIS FROM ENTERING ANY STORM DRAINAGE SYSTEM DURING CONSTRUCTION. PIPES OR STRUCTURES WHICH CONTAIN MATERIALS FROM THE CONTRACTOR'S ACTIVITIES SHALL BE THOROUGHLY CLEANED BY THE CONTRACTOR, AT HIS OWN EXPENSE, PRIOR TO THE FINAL INSPECTION.
- THE CONTRACTOR SHALL INSTALL AND/OR MAINTAIN EROSION CONTROL METHODS AS SPECIFIED ON SHEETS 5-17. THE FOLLOWING QUANTITIES ARE ESTIMATED, AND SHOULD BE CONSIDERED THE MINIMUM EFFORT REQUIRED. THE GENERAL LOCATION OF THE REQUIRED EROSION CONTROL IS ILLUSTRATED IN THE DRAWINGS. THE WATERLINE CONTRACTOR SHALL BE RESPONSIBLE FOR MAINTAINING THE EROSION CONTROL SHOWN THROUGH THE COMPLETION OF THIS PROJECT. INSTALLATION OF THESE BMP'S DOES NOT RELIEVE THE CONTRACTOR OF THE RESPONSIBILITY OF ABATING SOIL EROSION.

SILT FENCE BARRIER 4,394 L.F.
DITCH CHECK 4 EA.

- IF NECESSARY, CONTRACTOR SHALL RESTRAIN POWER POLES AND LIGHT POLES IN PLACE THRU CONSTRUCTION. AT LEAST 72 HOURS PRIOR TO START OF CONSTRUCTION, COORDINATE RESTRAINT WITH MR. ZACH LAWS AT 261-6264.
- THE CONTRACTOR SHALL VERIFY HORIZONTAL AND VERTICAL LOCATION, TYPE, SIZE AND CLASS OF EXISTING WATERLINES PRIOR TO MAKING CONNECTIONS. EXISTING WATERLINE LOCATIONS AS SHOWN ON THE DRAWINGS ARE APPROXIMATE. CONTRACTOR SHALL MAKE ADJUSTMENTS AS REQUIRED. PROVISION AND INSTALLATION OF PIPE ADAPTORS, SHORT SECTION OF PIPE, AND COUPLERS SHALL BE SUBSIDIARY TO THE PRICE BID FOR PIPE IN PLACE.
- OPENING AND CLOSING WATER VALVES SHALL BE DONE SLOWLY TO PREVENT DAMAGE TO THE WATER DISTRIBUTION SYSTEM FROM WATER HAMMER. ALL VALVES CLOSED BY THE CONTRACTOR MUST BE REOPENED AS NEW CONSTRUCTION PERMITS. PROJECT INSPECTOR MUST ASCERTAIN THAT ANY VALVE CLOSED BY THE CONTRACTOR IS REOPENED.
- THE CONTRACTOR MUST SCHEDULE THE CONNECTIONS TO THE EXISTING WATER MAINS WITH THE CITY SUCH THAT THERE IS A MINIMUM OF DISRUPTION TO THE CITY AND SHALL PROVIDE 48 HOURS WRITTEN NOTICE TO ANY PROPERTY OWNERS THAT WILL HAVE LOSS OF WATER SERVICE.
- THE CONTRACTOR SHALL PROVIDE POSITIVE DRAINAGE AWAY FROM ALL VALVE BOX COVERS.
- FIRE HYDRANT BURY DEPTHS ARE BASED ON THE TOP ELEVATION OF THE PROPOSED WATER MAIN AND THE GROUND ELEVATION AT THE LOCATION OF THE FIRE HYDRANT. THE CONTRACTOR SHALL VERIFY THESE ELEVATIONS PRIOR TO INSTALLING FIRE HYDRANTS. ANY MODIFICATIONS REQUIRED TO THE FIRE HYDRANT BURY DEPTH DUE TO THE CONTRACTOR'S FIELD ADJUSTMENTS TO THE WATER MAIN PROFILE SHALL BE MADE BY THE CONTRACTOR AT NO ADDITIONAL COST TO THE CITY. PROPOSED ADJUSTMENTS MUST BE APPROVED BY THE RESIDENT INSPECTOR PRIOR TO CONSTRUCTION.
- THE CONTRACTOR SHALL PROVIDE MATERIALS FOR TEMPORARY BLOWOFF OF WATERLINE FOR CONNECTION TO THE EXISTING WATERLINES. WATERLINE CONNECTIONS SHALL BE CONSTRUCTED WITH CLEAN SWABBED PIPE, AND FLUSHED UPON COMPLETION OF TIE-INS.
- NO SERVICES WILL BE INSTALLED AS PART OF THIS PROJECT.
- RESTRAINED JOINT PIPE SHALL BE NORTH AMERICAN PIPE RUIB CERTA-LOK, IN ACCORDANCE WITH CITY OF WICHITA SPECIFICATIONS.

THE CONTRACTOR MAY USE SIGMA PV-LOK SERIES PWM OR APPROVED EQUAL FOR RESTRAINT OF FITTINGS ON THE PROJECT. CLAMPING RING SHALL BE OF HIGH STRENGTH DUCTILE IRON AND SHALL CONFORM TO ASTM A536, GRADE 65-45-12. SIDE CLAMPING BOLT AND HEX NUTS SHALL BE A HIGH STRENGTH STEEL AND SHALL CONFORM TO ASTM A449 AND ZINC PLATED TO B633, TYPE III SC. 1. RESTRAINING RODS AND HEX NUTS SHALL BE A HIGH STRENGTH, LOW ALLOY STEEL AND SHALL CONFORM TO AWWA/ANSI C111/A21.11 AND PRORATE A MINIMUM 45,000 PSI YIELD AND 60,000 PSI TENSILE STRENGTH.

AIR RELEASES INSTALLED NEXT TO A HYDRANT TEE OR VALVE SHALL BE INSTALLED 3' FROM THE TEE/VALVE.

THE OWNER WILL ACQUIRE THE KDOT PERMIT FOR USE OF RIGHT-OF-WAY HIGHWAY 81. CONTRACTOR SHALL VERIFY PERMIT HAS BEEN ACQUIRED. A COPY OF THE PERMIT WILL BE MADE AVAILABLE TO THE CONTRACTOR UPON REQUEST. CONTRACTOR SHALL COMPLY WITH ALL PERMIT REQUIREMENTS. THE CONTACT INFORMATION IS:

KANSAS DEPARTMENT OF TRANSPORTATION
3200 E 45TH STREET NORTH
WICHITA, KS 67230
JERALD RUNNEBAUM
316-744-1271

LEGEND

- EXISTING WATER MAIN - - - - -
- PROPOSED WATER MAIN ———
- EXISTING WATER VALVE - - - - -
- PROPOSED WATER VALVE ———
- EXISTING FIRE HYDRANT ———
- PROPOSED FIRE HYDRANT ———
- EXISTING BLOW OFF - - - - -
- PROPOSED BLOW OFF ———

SEE SHEET 3 AND 4 FOR HORIZONTAL/VERTICAL CONTROL AND FOR WATERLINE COORDINATES.

NOTE: WATERLINE VALVES OWNED BY THE CITY TO BE OPERATED BY CONTRACTOR ONLY IF WATER DEPARTMENT REPRESENTATIVE IS ON SITE.

Sowed 06-26-2018 8:05:40 AM by KURTIS DEKAT
Plot Scale 1:1 06-26-2018 8:53:17 AM by KURTIS DEKAT
U:\Wichita-Civil\2017\170585\000\Main\Drawings\170585-000-002-KEY MAP AND GENERAL NOTES

	Revision		By	Date
	WATER DISTRIBUTION IMPROVEMENTS 12" WATERLINE ALONG BROADWAY, 55TH TO 63RD STREET SOUTH KEY MAP AND GENERAL NOTES			
	GARY JANZEN, P.E. - CITY ENGINEER CITY OF WICHITA PROJECT NO. 448-90821			
	PROFESSIONAL ENGINEERING CONSULTANTS, P.A. 303 SOUTH TOPEKA WICHITA, KS 67202 316-262-2891 www.pec1.com			
Designed by	JAG, TBK	Job No.	35-170585-0-42	Sht. 2 of 26
Drawn by	CSL, KTD	Date	August 2017	