

BENCHMARKS:
BM#1: RR spike in high line pole, 40' west and 30' south of Lot 60, Block D, Firefly Way Addition.
 Elev. = 1399.54 NAVD88

BM#2: Benchmark disc in top of curb, adjacent to fire hydrant 15' south of SE corner of Lot 2, Block C, Firefly Way Addition.
 Elev. = 1396.95 NAVD88

Street & Station	Location Description	Elevation
27th Ct N. 0+32.09, 14.25' Lt.	Adjacent to Fire Hydrant near common front lot corner of Lots 38 and 39, Block A, Firefly Way Addition.	

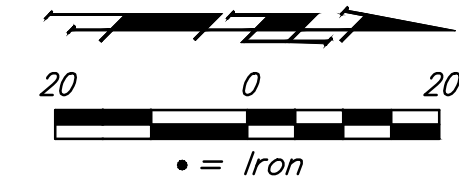

WATER VALVE LOCATION TABLE

VALVE NUMBER	STREET	BASELINE STATION	OFFSET DISTANCE	OFFSET DIRECTION
V6	27th Ct N.	0+32.09	23.00'	Lt.
V7	27th Ct N.	3+71.97'	39.73'	Rt.

Baseline = CL 27th Ct. N.

Paving contractor will be responsible to operate all water valves on the project, in the presence of the inspector, to ensure accessibility to the valves, and that all valves (except blowoffs) are left in the "ON" position when the project is completed.

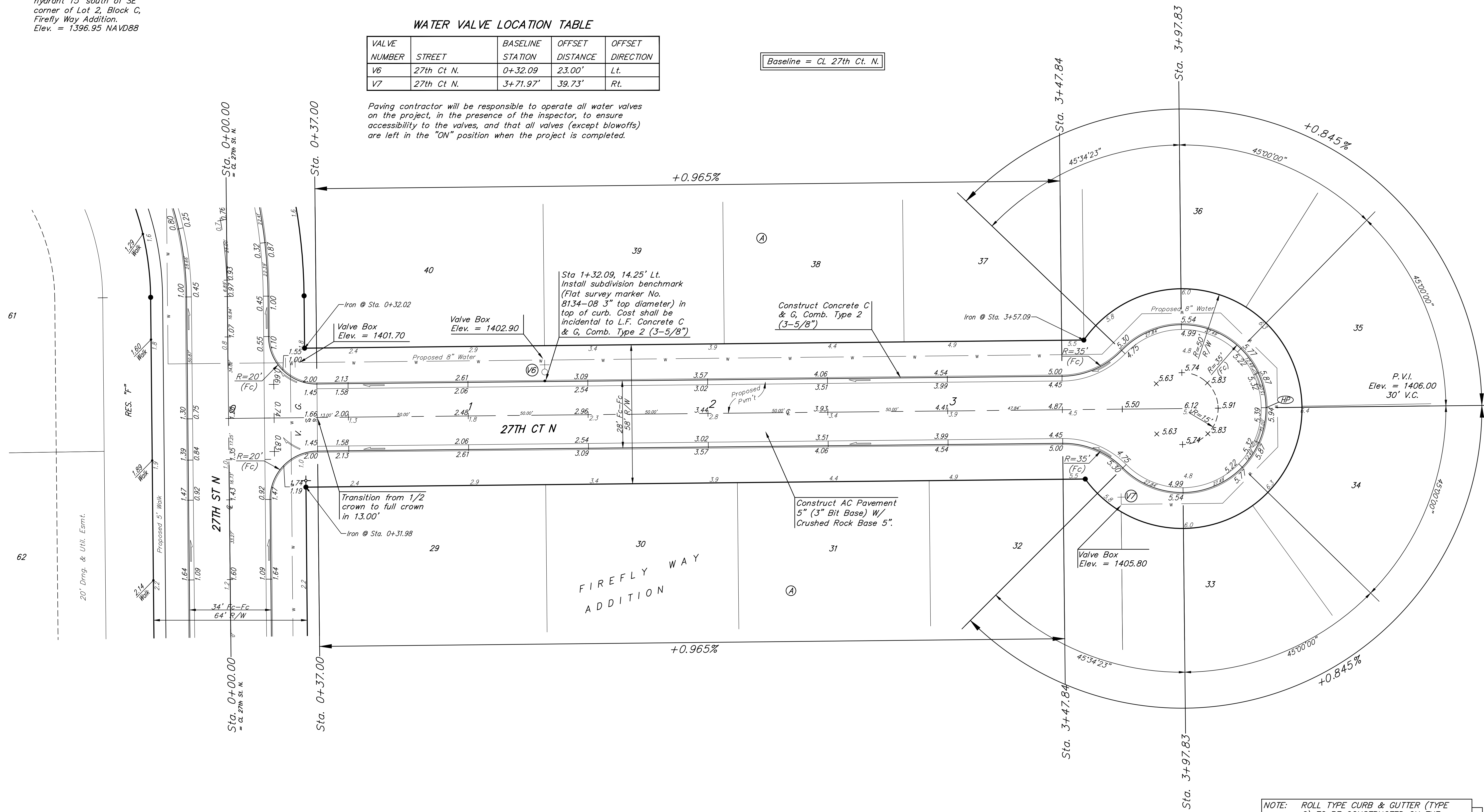

NOTE: ROLL TYPE CURB & GUTTER (TYPE 2) TO BE CONSTRUCTED ON THE PAVEMENT SHOWN ON THIS SHEET. TOP OF CURB ELEVATIONS ARE GIVEN FOR FULL HEIGHT CURB (TYPE 4).

FIREFLY WAY ADD. PH. 2
27TH CT. N.
 STREET IMPROVEMENTS
 Baughman Company, P.A.
 ENGINEERING, SURVEYING, PLANNING, LANDSCAPE ARCHITECTURE
 7 OF 42