

**BENCHMARKS:**  
**BM#1:** RR spike in high line pole, 40' west and 30' south of Lot 60, Block D, Firefly Way Addition.  
 Elev. = 1399.54 NAVD88

**BM#2:** Benchmark disc in top of curb, adjacent to fire hydrant 15' south of SE corner of Lot 2, Block C, Firefly Way Addition.  
 Elev. = 1396.95 NAVD88

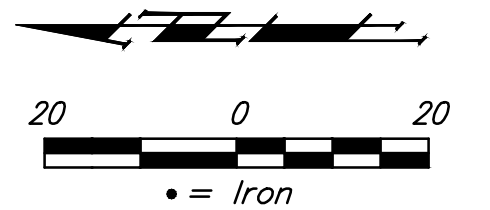

Baseline = CL Bracken St.

**WATER VALVE LOCATION TABLE**

VALVE NUMBER	STREET	BASELINE STATION	OFFSET DISTANCE	OFFSET DIRECTION
V8	Bracken	0+91.00	26.00'	Rt.

Paving contractor will be responsible to operate all water valves on the project, in the presence of the inspector, to ensure accessibility to the valves, and that all valves (except blowoffs) are left in the "ON" position when the project is completed.

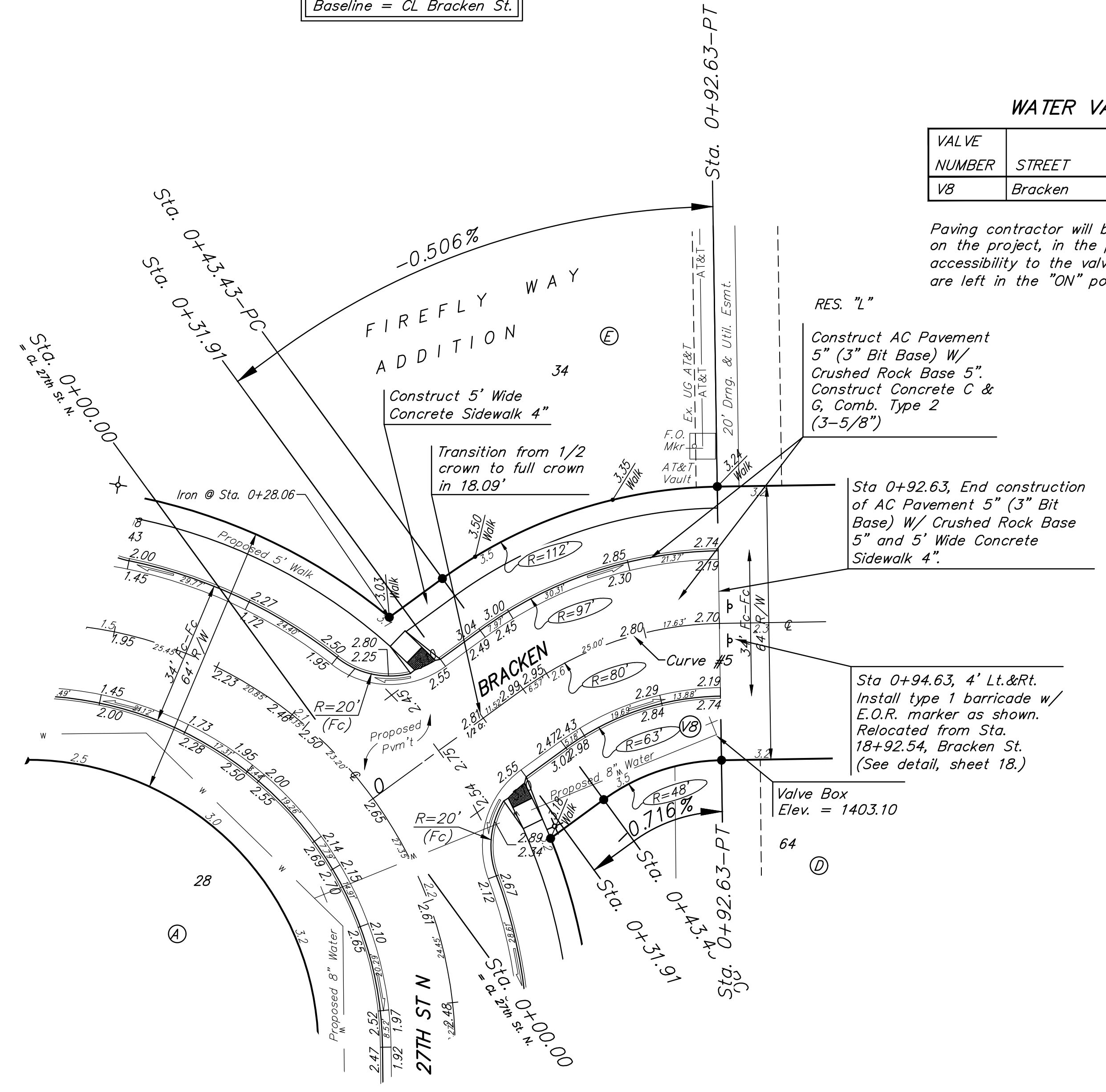

RES. "L"

Construct AC Pavement 5" (3" Bit Base) W/ Crushed Rock Base 5". Construct Concrete C & G, Comb. Type 2 (3-5/8")

Sta 0+92.63, End construction of AC Pavement 5" (3" Bit Base) W/ Crushed Rock Base 5" and 5' Wide Concrete Sidewalk 4".

Sta 0+94.63, 4' Lt.&Rt. Install type 1 barricade w/ E.O.R. marker as shown. Relocated from Sta. 18+92.54, Bracken St. (See detail, sheet 18.)

Valve Box Elev. = 1403.10

Curve #5					
Curve Data Based on Centerline					
Rad. = 80' Delta = 35°14'13" Tangent = 25.41'					
Arc = 49.20' L.C. = 48.43' Def./Ft. = 21.48594 Min.					
Face Chord Lengths					
Station	Arc	8' Left	8' Right	Defl.	Total Defl.
0+43.43	-	-	-	0°00'00"	0°00'00"
0+50.00	6.57'	8.62'	4.52'	2°21'10"	2°21'10"
0+75.00	25.00'	32.68'	17.12'	8°57'09"	11°18'19"
0+92.63	17.63'	23.09'	12.10'	6°18'48"	17°37'07"

NOTE: ROLL TYPE CURB & GUTTER (TYPE 2) TO BE CONSTRUCTED ON THE PAVEMENT SHOWN ON THIS SHEET. TOP OF CURB ELEVATIONS ARE GIVEN FOR FULL HEIGHT CURB (TYPE 4).