

1

2

3

4

5

REFER TO SHEET G-0.01 FOR STANDARD DRAWING LEGEND

RISER/MANHOLE COORDINATES AND TOE-DRAIN PIPE INVERT ELEVATIONS ARE BASED LIDAR TOPOGRAPHIC DATA AND MAY REQUIRE MINOR HORIZONTAL AND VERTICAL ADJUSTMENTS TO BE MADE IN THE FIELD. ANY FIELD CHANGES TO THE TOE-DRAIN ALIGNMENT OR PIPE INVERTS SHALL BE APPROVED BY THE CITY OF WICHITA'S STORMWATER ENGINEER.

POINT NAME	NORTHING	EASTING
MH-03	1680057	1629370
MH-04	1679128	1629204
MH-05	1678184	1629216
MH-06	1677640	1629220
MH-07	1676640	1629236
MH-08	1675740	1629247
MH-09	1675274	1629244

POINT NAME	NORTHING	EASTING
R-04	1680069	1629372
R-05	1679693	1629302
R-06	1679318	1629224
R-07	1678937	1629207
R-08	1678554	1629213
R-09	1678171	1629216
R-10	1677763	1629218

POINT NAME	NORTHING	EASTING
R-11	1677409	1629222
R-12	1677055	1629229
R-13	1676701	1629235
R-14	1676346	1629241
R-15	1675992	1629245
R-16	1675638	1629247
R-17	1675224	1629244

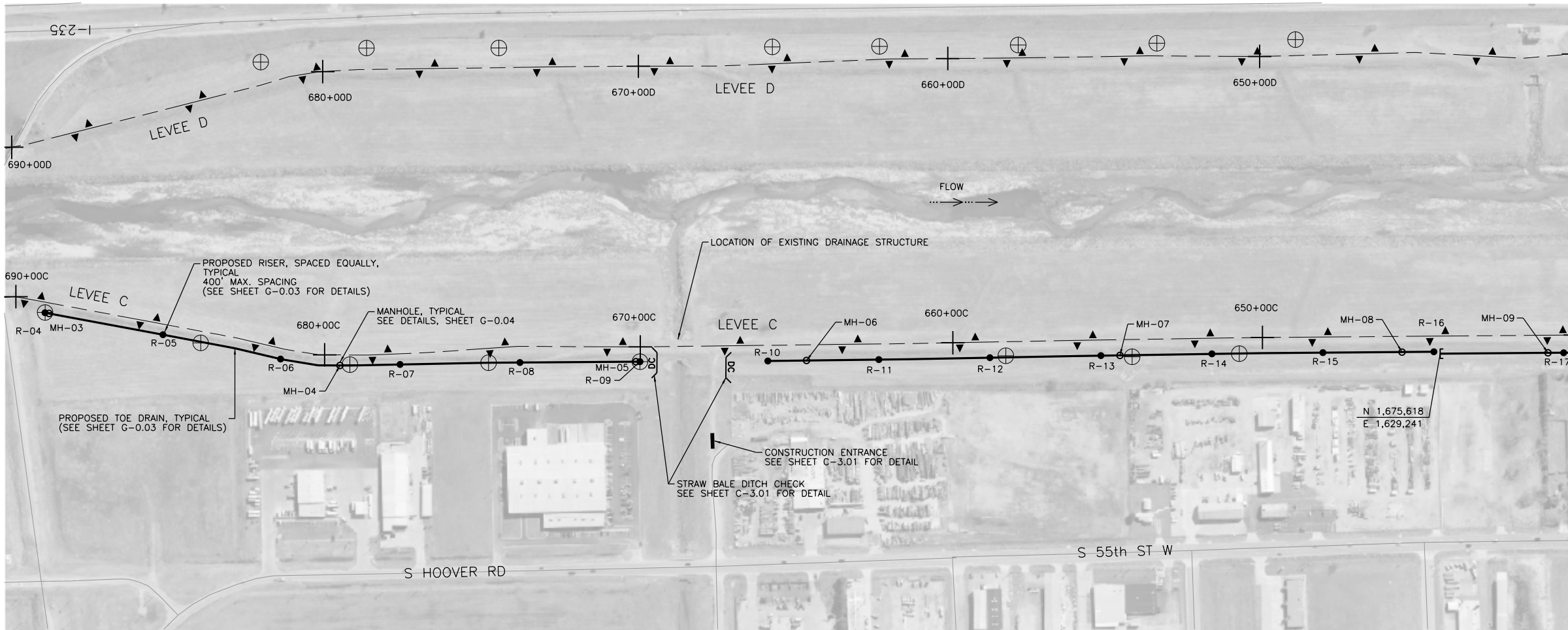
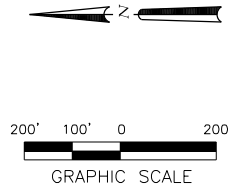

MATCH LINE-SEE SHEET C-2. 03

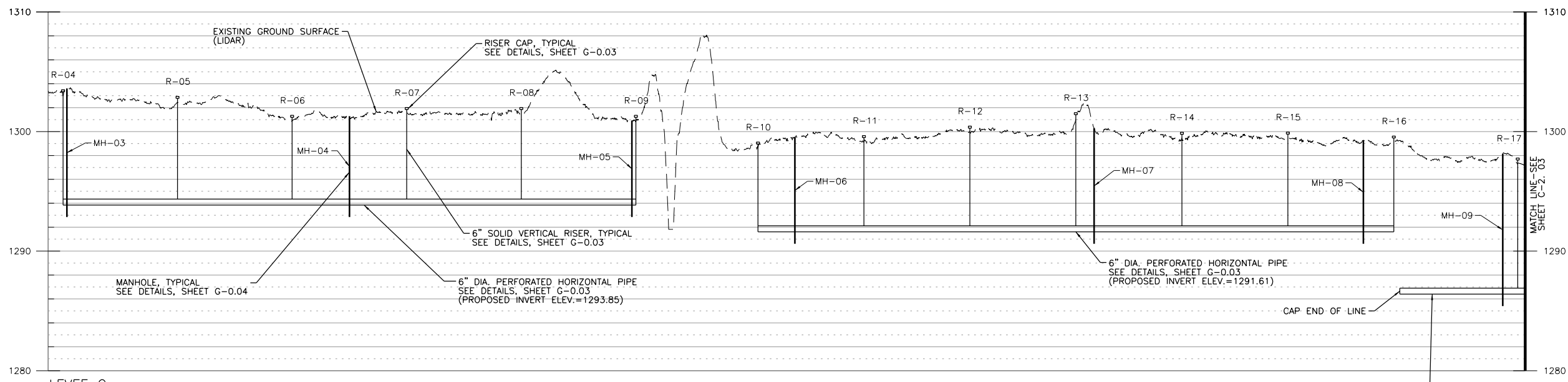

MATCH LINE-SEE SHEET C-2. 03

PROFILE SCALE (40:1 EXAGGERATION):
HORIZONTAL: 1"=200'
VERTICAL: 1"=5'

6" DIA. PERFORATED HORIZONTAL PIPE
SEE DETAILS, SHEET G-0.03
(PROPOSED INVERT ELEV.=1286.40)

DATE	APPR
DESCRIPTION	MARK

amec
AMEC Earth & Environmental, Inc.
1129 SW Wensmaker
Topeka, Kansas 66604
Phone: (785) 272-6830
Fax: (785) 272-6878



LOWER LEVEE TOE DRAIN REPLACEMENT
WICHITA-VALLEY CENTER LOCAL
FLOOD PROTECTION PROJECT
WICHITA, KANSAS

PREPARED FOR
THE CITY OF WICHITA, KANSAS
455 N. Main
Wichita, KS 67202



DESIGNED BY: Larry Sample, PE
DATE: 08-13-2012
DWN BY: RES
CKD BY: LBK
APP BY: L. SAMPLE
FILE NAME: 08_C-2.02.dgn

AMEC PROJ. NO. 5-6150-0001

LEVEE TOE DRAIN PLAN
AND PROFILE
C-2.02
SHEET 2 OF 19