

BENCHMARKS:

BM #1: "□" Cut in top of curb on north side of Athenian, near the SE corner of Lot 13, Block 1, Valencia Addition.
Elev. = 1332.11 NAVD88

BM #2: Cross cut in sidewalk on north side of Harborlight St., near Lot 23, Block 1, Harbor Isle 2nd Addition.
Elev. = 1330.40 NAVD88

Trees to be removed by the Contractor only as necessary for street construction and with approval of the Engineer. Cost of tree removal to be included in bid item "Site Clearing"

Baseline = Athenian/Delaware

PVI TABLE (Lt.)		
STATION	ELEVATION	V.C.
6+72.65	1333.30	No
7+32.22	1333.64	No
7+74.52	1333.85	42.18'
8+16.81	1333.60	No
8+76.40	1333.20	No

Sta 9+13.58, 14.25' Rt.
Install subdivision benchmark (Flat survey marker No. 8134-08 3" top diameter) in top of curb. Cost shall be incidental to L.F. Concrete C & G, Comb. Type 2 (3-5/8")

Sta 9+17.58, 4' Lt.&Rt.
Install type 1 barricade w/ E.O.R. marker as shown. (See detail, sheet 9.)

Sta 9+15.58, End construction of AC Pavement 5" (3" Bit Base) W/ Crushed Rock Base 5".

Subdivision Bench Marks		
Street & Station	Location Description	Elevation
Delaware 9+13.56, 23' Lt.	Adjacent to Fire Hydrant near common front lot corner of Lots 8 & 9, Block 1, Valencia Addition.	

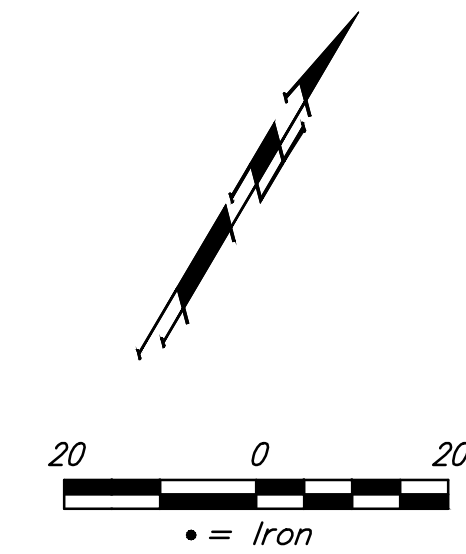

Curve #1					
Curve Data Based on Centerline					
Rad. = 100' Delta = 116° 44' 16" Tangent = 162.35'					
Arc = 203.75' L.C. = 170.29' Def./Ft. = 17.18838 Min.					
Station	Arc	8' Left	8' Right	Defl.	Total Defl.
6+72.65	-	-	-	0° 00' 00"	0° 00' 00"
6+75.00	2.35'	1.83'	2.87'	0° 40' 24"	0° 40' 24"
7+00.00	25.00'	19.45'	30.42'	7° 09' 42"	7° 50' 06"
7+25.00	25.00'	19.45'	30.42'	7° 09' 43"	14° 59' 49"
7+32.22	7.22'	5.63'	8.81'	2° 04' 06"	17° 03' 55"
7+50.00	17.78'	13.85'	21.66'	5° 05' 36"	22° 09' 31"
7+74.52	24.52'	19.08'	29.84'	7° 01' 28"	29° 10' 59"
8+00.00	25.48'	19.82'	31.00'	7° 17' 57"	36° 28' 56"
8+16.81	16.81'	13.10'	20.48'	4° 48' 57"	41° 17' 53"
8+25.00	8.19'	6.39'	9.99'	2° 20' 46"	43° 38' 39"
8+50.00	25.00'	19.45'	30.42'	7° 09' 43"	50° 48' 22"
8+75.00	25.00'	19.45'	30.42'	7° 09' 42"	57° 58' 04"
8+76.40	1.40'	1.09'	1.71'	0° 24' 04"	58° 22' 08"

WATER VALVE LOCATION TABLE

VALVE NUMBER	STREET	BASELINE STATION	OFFSET DISTANCE	OFFSET DIRECTION
V2	Delaware	8+16.81	22'	Lt.
V3	Delaware	9+13.56	23'	Lt.

Paving contractor will be responsible to operate all water valves on the project, in the presence of the inspector, to ensure accessibility to the valves, and that all valves (except blowoffs) are left in the "ON" position when the project is completed.

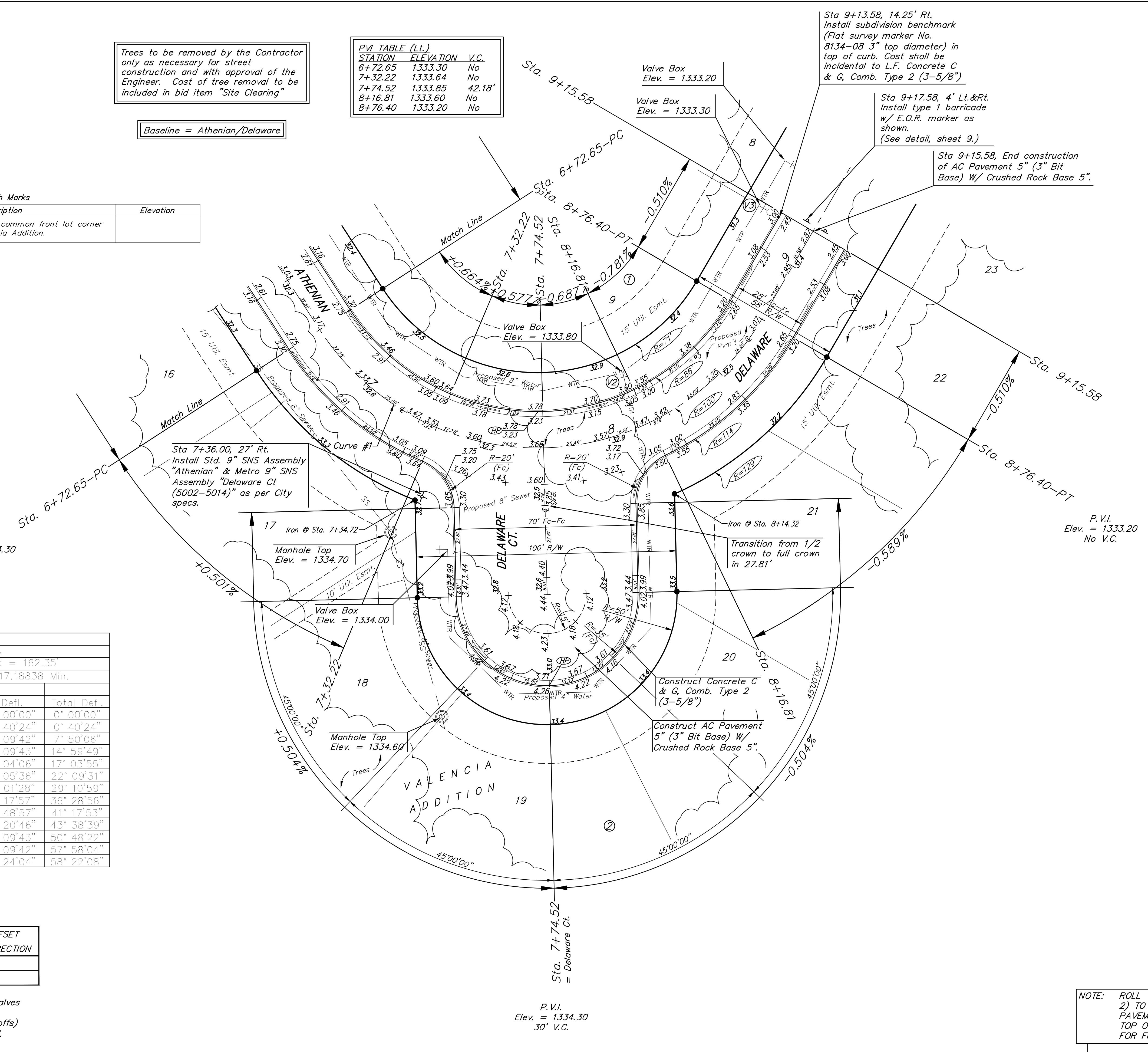

NOTE: ROLL TYPE CURB & GUTTER (TYPE 2) TO BE CONSTRUCTED ON THE PAVEMENT SHOWN ON THIS SHEET. TOP OF CURB ELEVATIONS ARE GIVEN FOR FULL HEIGHT CURB (TYPE 4).

VALENCIA ADDITION - PH. II
DELWARE/ DELAWARE CT.
 STREET IMPROVEMENTS

Baughman Company, P.A.
 P.E. BAUGHMAN, P.E. CHEN, P.E. HANCOCK, P.E. HANCOCK, P.E. HANCOCK
 ENGINEERING, PLANNING, LANDSCAPE ARCHITECTURE
 1000 W. 10th Street, Suite 100, Wilmington, DE 19801
 Phone: 302.478.1111 Fax: 302.478.1112
 www.baughman.com

DATE: 07/19/19
 SHEET: 5 OF 23