

J:\PROJECTS\2019\1801010519_COUNTRY HOLLOW 2ND ADDITION\18519 CAD\SHOTS\05 CIVIL\GRD\PH1\18519_05_1802.DWG
 PLOTTED: Monday, April 22, 2019 @ 10:22AM

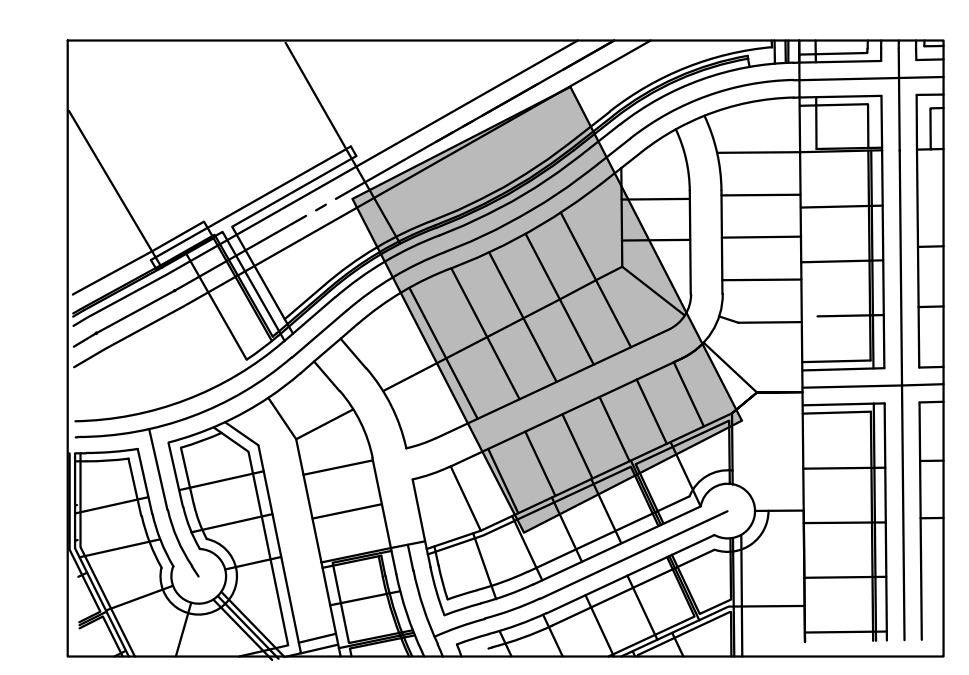
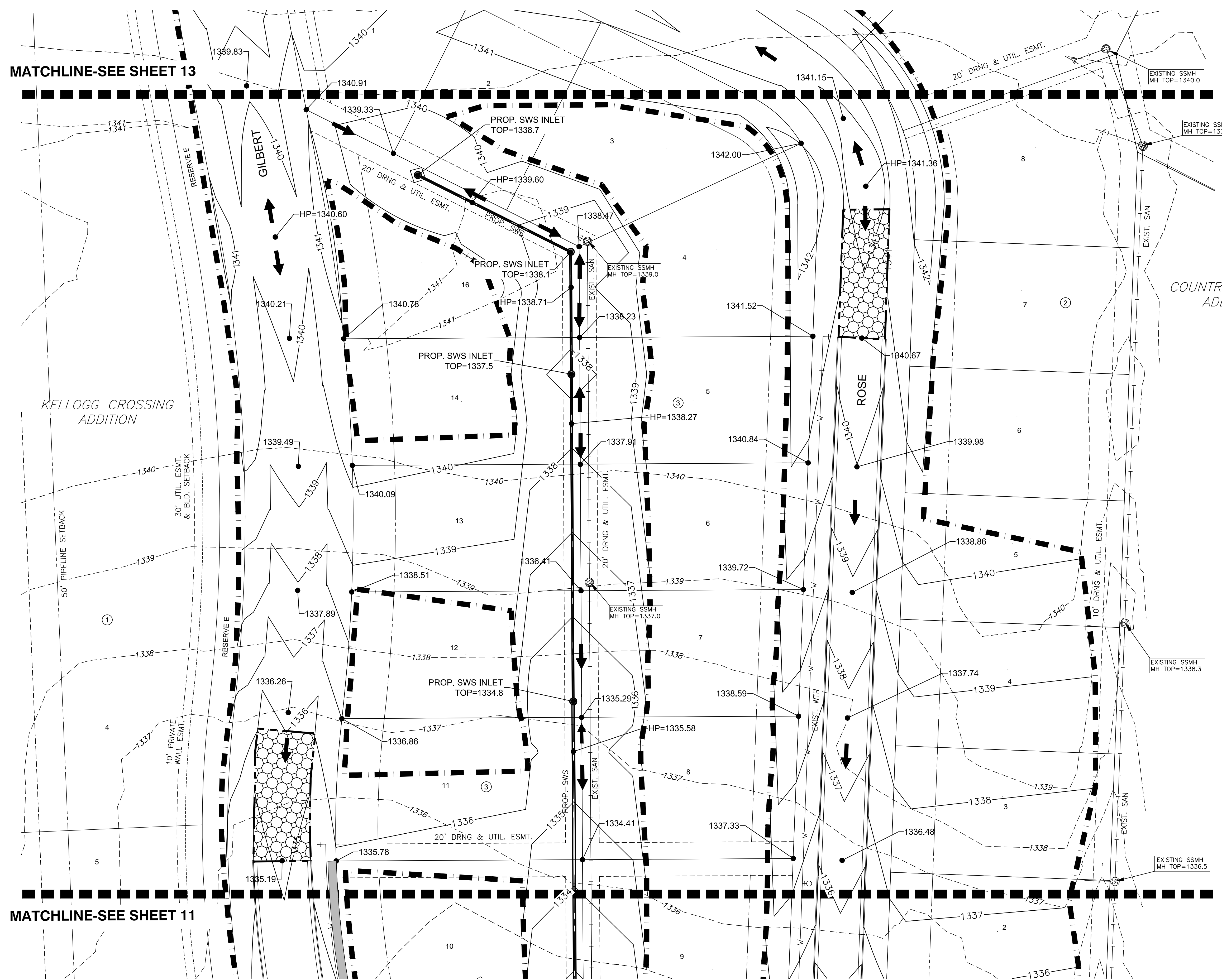

VICINITY MAP

COUNTRY HOLLOW
ADDITION

NOTE:
 THE CONTOURS AND ELEVATIONS SHOWN ON PLAN ARE THE FINISHED GRADE. THE FINISHED GRADE INDICATES THE SURFACE ELEVATION AFTER THE ELEVATION LAYER OF TOPSOIL HAS BEEN PLACED. CONTRACTOR SHALL GRADE FUTURE STREET TO BOTTOM OF ROCK. SEE COUNTRY HOLLOW 2nd ADDITION PHASE 1 PAVING PLANS (PROJECT NO. 472-2019-085525) FOR PROPOSED PAVEMENT GRADES.

LEGEND

- 1250--- EXISTING CONTOUR
- 1250— PROPOSED CONTOUR
- W— WATERLINE
- PROP. STORMWATER SEWER
- EXISTING SANITARY SEWER
- EXISTING STORMWATER SEWER
- UGT— EXISTING UNDERGROUND TELEPHONE
- UGE— EXISTING UNDERGROUND ELECTRICAL
- OHE— EXISTING OVERHEAD ELECTRICAL
- LIMITS OF GRADING
- 1329.86 SPOT ELEVATIONS
- CONTRACTOR TO GRADE TO DRAIN

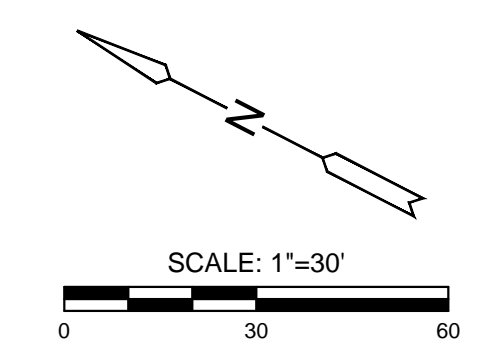

STORM WATER SEWER PLAN FOR
COUNTRY HOLLOW 2ND ADDITION
 PHASE 1

©2019
 MKEC Engineering
 All Rights Reserved
 www.mkec.com
 These drawings and their contents, including, but not limited to, all concepts, designs, & ideas are the exclusive property of MKEC Engineering (MKEC), and may not be used or reproduced in any way without the express consent of MKEC.

GRADING PLAN 2		
PROJECT NO.	468-85268	
DATE	APR. 2019	
SCALE	1" = 30'	
DESIGNED	DRAWN	CHECKED
SLF	DML	MAB
NO.	REVISION	DATE
SHEET NO.		
12 OF 22		