

**BENCHMARK:**  
 BM #1: Brass disc at west end of west return at intersection of Driftwood & Driftwood Ct. (Lots 52-62, Block D), Edge Water Addition.  
 Elev. = 1336.19 NGVD29

BM #2: (Temporary Benchmark)  
 Baughman rebar found at NW corner of Lot 1, Block E, Edge Water Addition.  
 Elev. = 1334.41 NGVD29

Subdivision Bench Marks		
Street & Station	Location Description	Elevation
Driftwood 2+27.63, 17.25' Lt.	Adjacent to Fire Hydrant at E. End of E. Curb Return of Driftwood & Driftwood Ct.	

Curve #1					
Curve Data Based on Centerline					
Rad. = 300' Delta = 16°49'23" Tangent = 44.36'					
Arc = 88.08' L.C. = 87.77' Def./Ft. = 5.72992 Min.					
Face Chord Lengths					
Station	Arc	8' Left	8' Right	Defl.	Total Defl.
0+16.35	-	-	-	0°00'00"	0°00'00"
0+25.00	8.65'	7.93'	9.37'	0°49'34"	0°49'34"
0+50.00	25.00'	22.91'	27.08'	2°23'15"	3°12'49"
0+75.00	25.00'	22.91'	27.08'	2°23'15"	5°36'04"
1+00.00	25.00'	22.91'	27.08'	2°23'14"	7°59'18"
1+04.43	4.43'	4.06'	4.80'	0°25'23"	8°24'41"

Curve #2					
Curve Data Based on Centerline					
Rad. = 280' Delta = 19°58'21" Tangent = 49.30'					
Arc = 97.61' L.C. = 97.11' Def./Ft. = 6.13846 Min.					
Face Chord Lengths					
Station	Arc	8' Left	8' Right	Defl.	Total Defl.
1+04.43	-	-	-	0°00'00"	0°00'00"
1+25.00	20.57'	22.40'	18.73'	2°06'16"	2°06'16"
1+50.00	25.00'	27.22'	22.76'	2°33'28"	4°39'44"
1+64.47	14.47'	15.76'	13.18'	1°28'49"	6°08'33"
1+75.00	10.53'	11.47'	9.59'	1°04'38"	7°13'11"
2+00.00	25.00'	27.22'	22.76'	2°33'28"	9°46'39"
2+02.04	2.04'	2.22'	1.86'	0°12'32"	9°59'11"

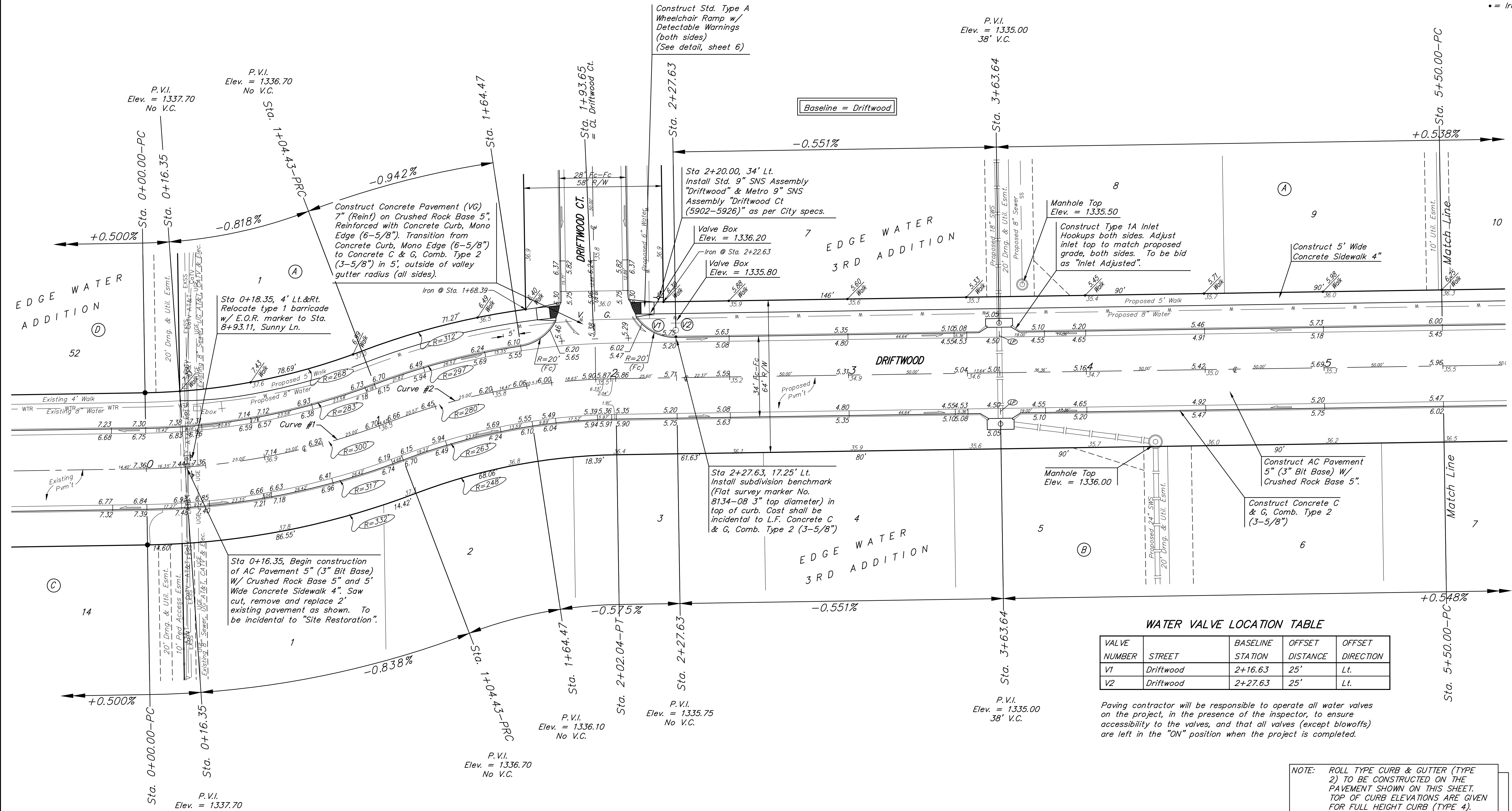
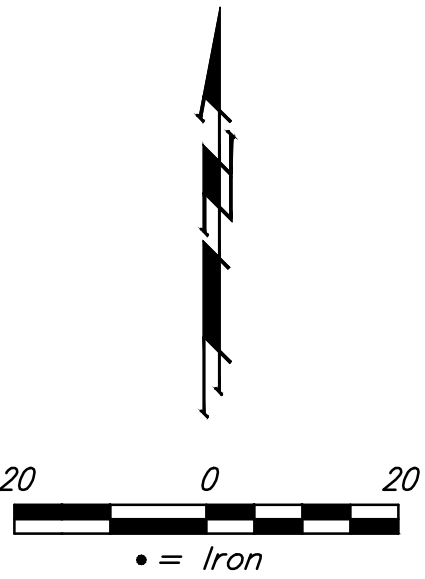

**WATER VALVE LOCATION TABLE**

VALVE NUMBER	STREET	BASELINE STATION	OFFSET DISTANCE	OFFSET DIRECTION
V1	Driftwood	2+16.63	25'	Lt.
V2	Driftwood	2+27.63	25'	Lt.

Paving contractor will be responsible to operate all water valves on the project, in the presence of the inspector, to ensure accessibility to the valves, and that all valves (except blowoffs) are left in the "ON" position when the project is completed.

NOTE: ROLL TYPE CURB & GUTTER (TYPE 2) TO BE CONSTRUCTED ON THE PAVEMENT SHOWN ON THIS SHEET. TOP OF CURB ELEVATIONS ARE GIVEN FOR FULL HEIGHT CURB (TYPE 4).

Baughman Company, P.A.  
 ENGINEERING, ARCHITECTURE, PLANNING & LANDSCAPE ARCHITECTURE  
 1000 W. 10th St., Suite 200, Lincoln, NE 68502  
 (402) 441-1111  
 www.baughman.com

**DRIFTWOOD**  
 STREET IMPROVEMENTS

SHEET 7 OF 26