

STORM WATER SEWER PLAN FOR  
**WILSON FARMS 5TH ADDITION**  
WICHITA, KANSAS

©2019  
MKEC Engineering  
All Rights Reserved  
www.mkec.com  
These drawings and their contents, including, but not limited to, all concepts, designs, & ideas are the exclusive property of MKEC Engineering (MKEC), and may not be used or reproduced in any way without the express consent of MKEC.

**EASEMENT GRADING PLAN**

PROJECT NO. 468-2019-085419

DATE MAY 2019

SCALE 1" = 20'

DESIGNED DRAWN CHECKED  
SLF CRM SLF

NO.	REVISION	DATE

SHEET NO.

9 OF 16

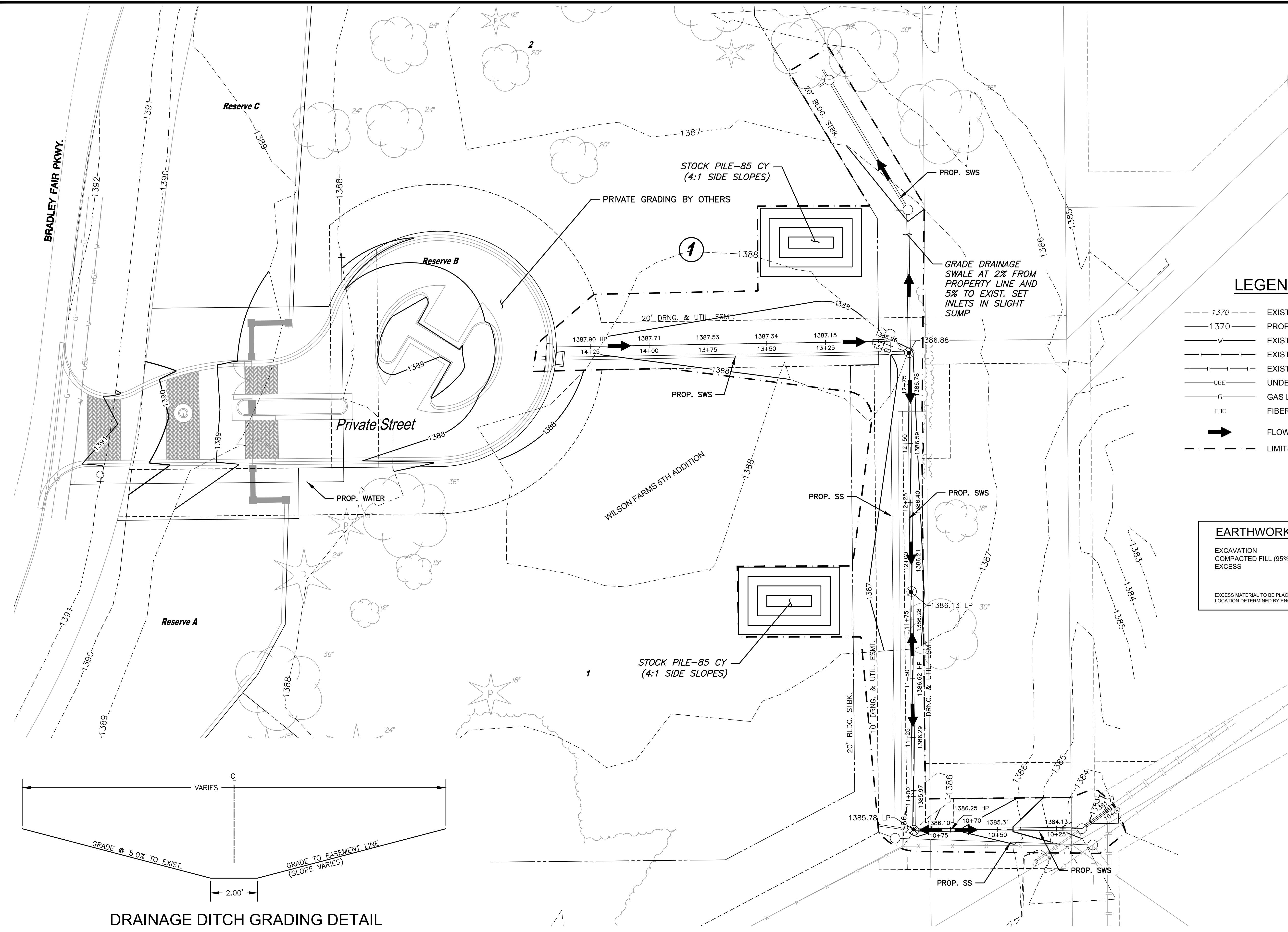

**LEGEND**

- 1370 --- EXIST. CONTOUR
- 1370 --- PROP. CONTOUR
- - - - - EXIST. WATERLINE
- - - - - EXIST. SANITARY SEWER
- - - - - EXIST. STORMWATER SEWER
- - - - - UNDERGROUND ELECTRICAL
- - - - - GAS LINE
- - - - - FIBER OPTIC CABLE
- FLOW ARROW
- - - - - LIMITS OF GRADING

**EARTHWORK SUMMARY**

EXCAVATION	175 C.Y.
COMPACTED FILL (95%)	5 C.Y.
EXCESS	170 C.Y.

EXCESS MATERIAL TO BE PLACED & COMPACTED ON SITE.  
LOCATION DETERMINED BY ENGINEER/OWNER'S DIRECTION

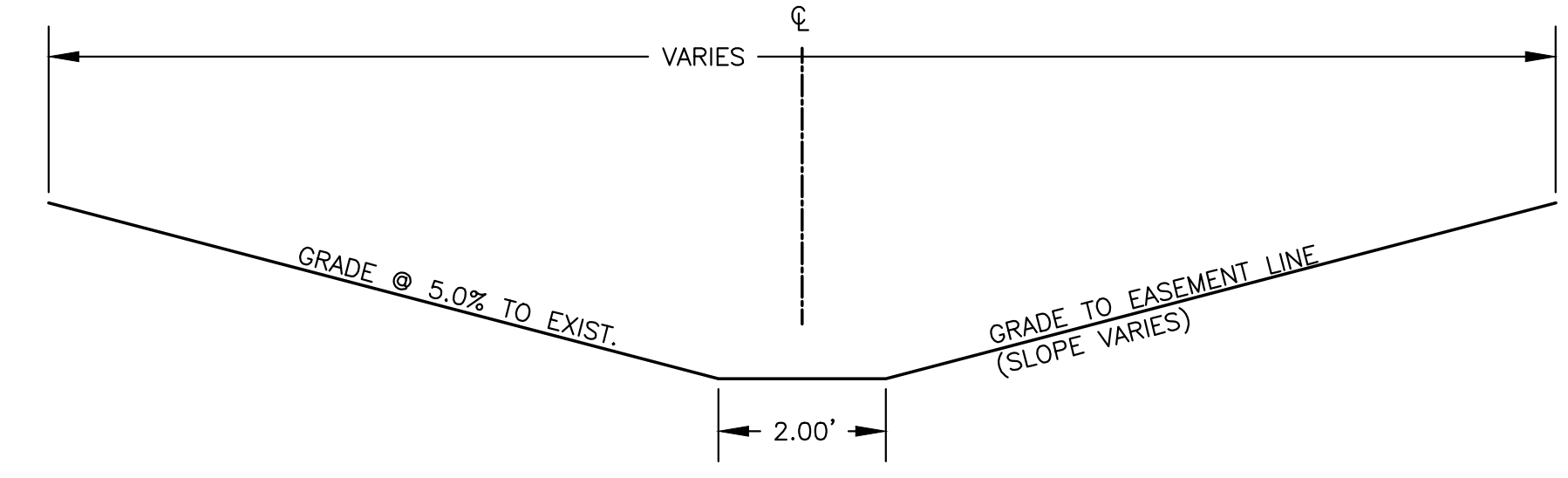

**DRAINAGE DITCH GRADING DETAIL**

STA. 10+00.0 TO STA. 13+00.0 - GRADE PER DETAIL  
STA. 13+00.0 TO STA. 14+25.0 - GRADE @ 5.0% SLOPE TO EXIST. ON BOTH SIDES

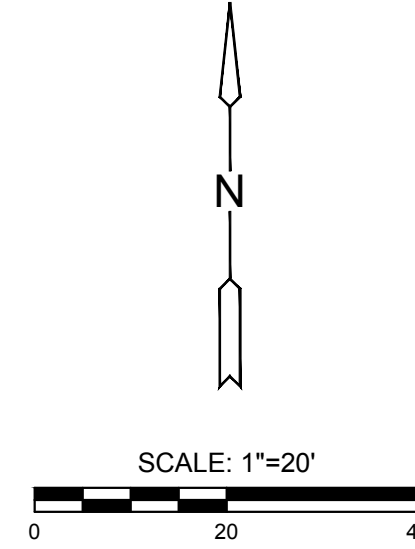

J:\PROJECTS\2019\1801010442\_HOOVER\_WILSON FARMS 5TH\_18442 CAD\SHITS\05 CIVIL\GRD\18442\_05\_0201.DWG  
 PLOTTED: Tuesday, May 07, 2019 @ 04:55PM