

**BENCHMARK:**  
 "□" in top of curb adjacent to the southwest corner of Lot 6, Block A, Rocky Ford 2nd Addition.  
 Elev. = 1385.10 NAVD88

City of Wichita Benchmark Disk  
 Adjacent to fire hydrant at east end of the south return, Lori & Lori Ct, NW Cor., Lot 11, Blk C, Rocky Ford 2nd Addition.  
 Elev. = 1383.10 NAVD88

"□" in top of curb adjacent to the southwest corner of Lot 14, Block C, Rocky Ford 2nd Addition.  
 Elev. = 1380.11 NAVD88

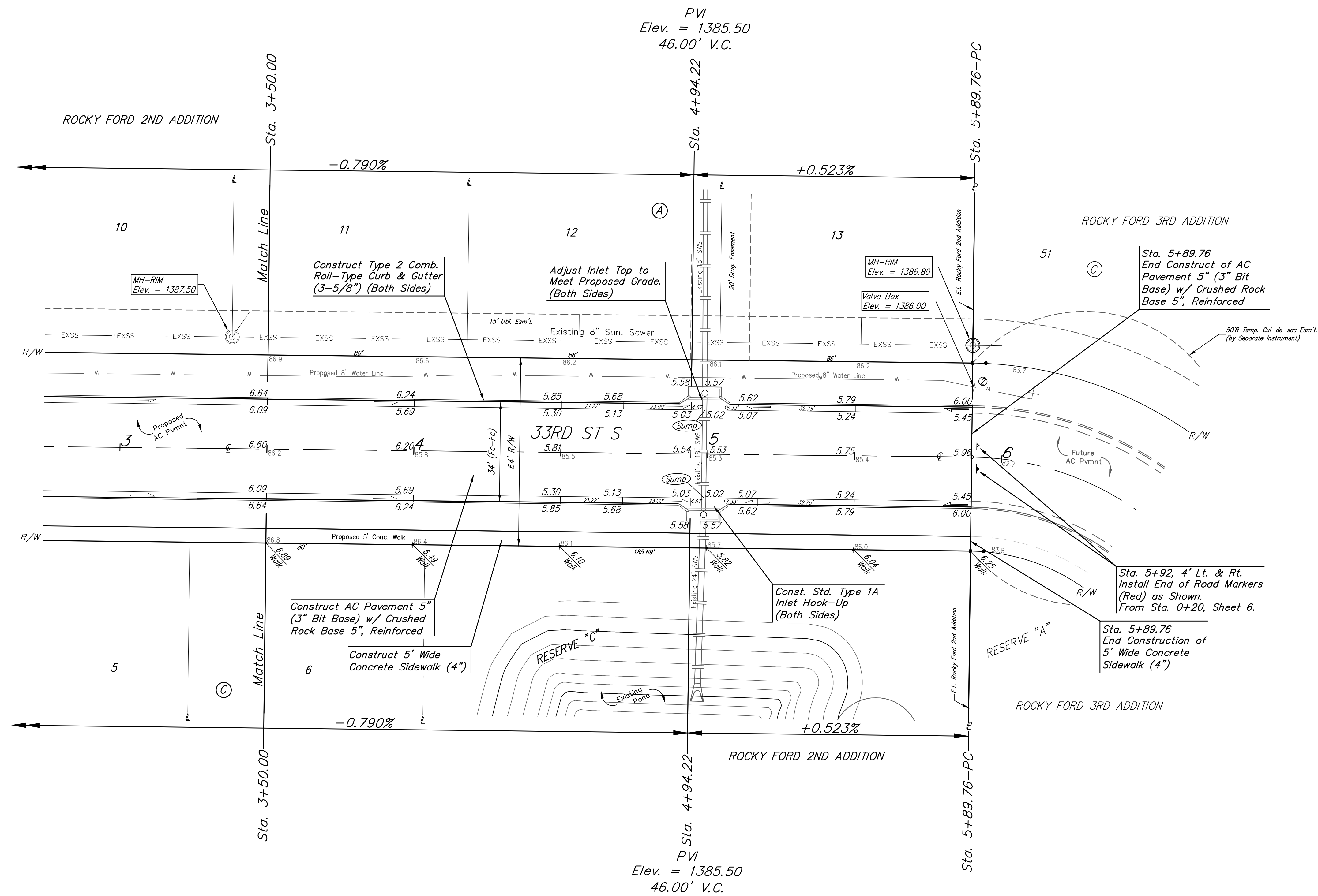
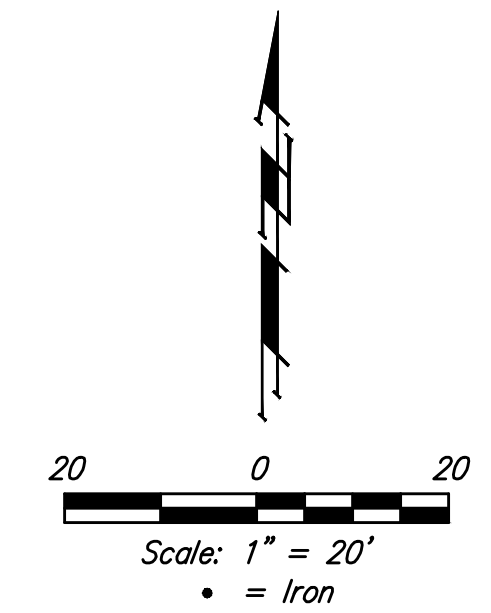

Roll type curb & gutter to be constructed on the pavement on this sheet.  
 Top of curb elevation are given for full height curb.

		Rocky Ford 2nd Addition - Phase II	
		<b>33RD ST SOUTH</b> Sta. 3+50.00 to Sta. 5+89.76	
<small>Baughman Company, P.A. 315 Ellis St. Wichita, KS 67211 P 316-262-7271 F 316-262-0149          ENGINEERING   SURVEYING   PLANNING   LANDSCAPE ARCHITECTURE</small>			
PROJECT NUMBER 472-85431	DESIGN AEG	DRAWN JAK	DATE 5/28/19
REVISIONS:	APPROVED	SCALE Noted	SHEET
			<b>7 OF 21</b>