

J:\PROJECTS\2017\1301040941_Mt. VERNON BIKE LANES\DWG\13541_SW RAMP PLAN.DWG
 PLOTTED: Sunday, July 09, 2017 @ 03:09PM

LEGEND

- SIDEWALK, RAMP, AND CURB & GUTTER REMOVAL
- CONCRETE SIDEWALK

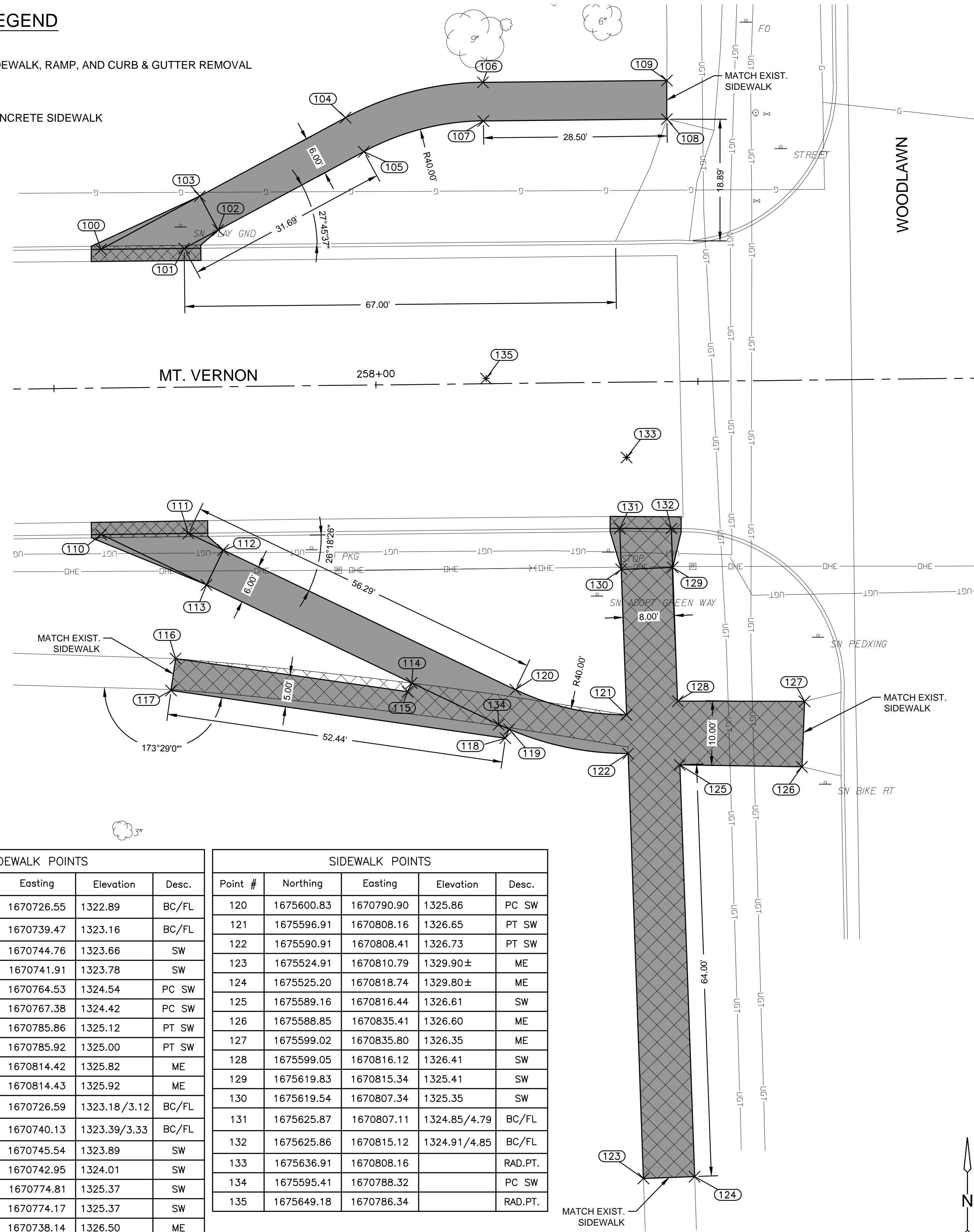

SIDEWALK POINTS				
Point #	Northing	Easting	Elevation	Desc.
100	1675669.24	1670726.55	1322.89	BC/FL
101	1675669.38	1670739.47	1323.16	BC/FL
102	1675672.22	1670744.76	1323.66	SW
103	1675677.51	1670741.91	1323.78	SW
104	1675689.68	1670764.53	1324.54	PC SW
105	1675684.40	1670767.38	1324.42	PC SW
106	1675695.18	1670785.86	1325.12	PT SW
107	1675689.18	1670785.92	1325.00	PT SW
108	1675689.48	1670814.42	1325.82	ME
109	1675695.48	1670814.43	1325.92	ME
110	1675624.94	1670726.59	1323.18/3.12	BC/FL
111	1675625.12	1670740.13	1323.39/3.33	BC/FL
112	1675622.53	1670745.54	1323.89	SW
113	1675617.11	1670742.95	1324.01	SW
114	1675601.87	1670774.81	1325.37	SW
115	1675600.52	1670774.17	1325.37	SW
116	1675605.67	1670738.14	1326.50	ME
117	1675600.72	1670737.44	1326.68	ME
118	1675593.30	1670789.35	1326.08	SW
119	1675594.68	1670789.94	1326.08	SW

SIDEWALK POINTS				
Point #	Northing	Easting	Elevation	Desc.
120	1675600.83	1670790.90	1325.86	PC SW
121	1675596.91	1670808.16	1326.65	PT SW
122	1675590.91	1670808.41	1326.73	PT SW
123	1675524.91	1670810.79	1329.90±	ME
124	1675525.20	1670818.74	1329.80±	ME
125	1675589.16	1670816.44	1326.61	SW
126	1675588.85	1670835.41	1326.60	ME
127	1675599.02	1670835.80	1326.35	ME
128	1675599.05	1670816.12	1326.41	SW
129	1675619.83	1670815.34	1325.41	SW
130	1675619.54	1670807.34	1325.35	SW
131	1675625.87	1670807.11	1324.85/4.79	BC/FL
132	1675625.86	1670815.12	1324.91/4.85	BC/FL
133	1675636.91	1670808.16		RAD.PT.
134	1675595.41	1670788.32		PC SW
135	1675649.18	1670786.34		RAD.PT.

SIDEWALK & RAMP PLAN - STA. 257+55.58 TO STA. 258+65.99
SCALE: 1"=10'

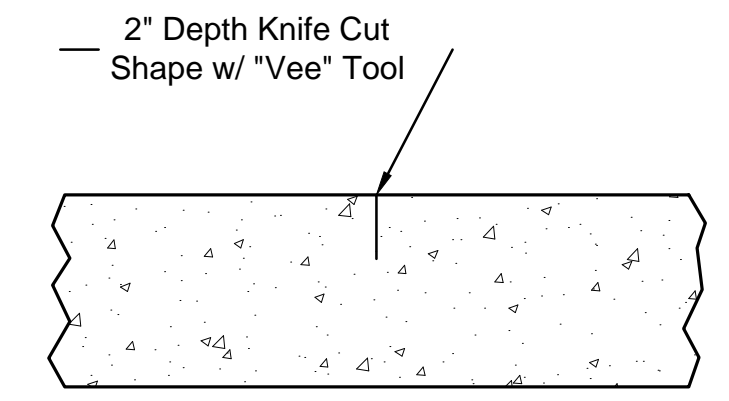

CONTRACTION JOINT (C.J.)
SCALE: NO SCALE

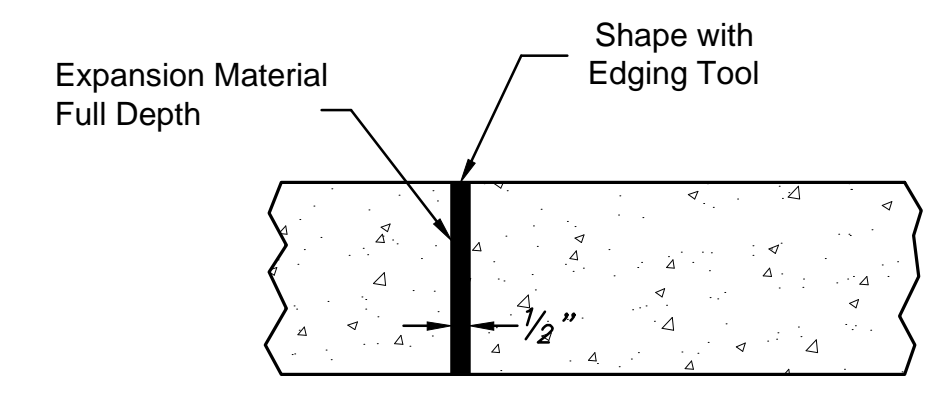

EXPANSION JOINT (E.J.)
SCALE: NO SCALE

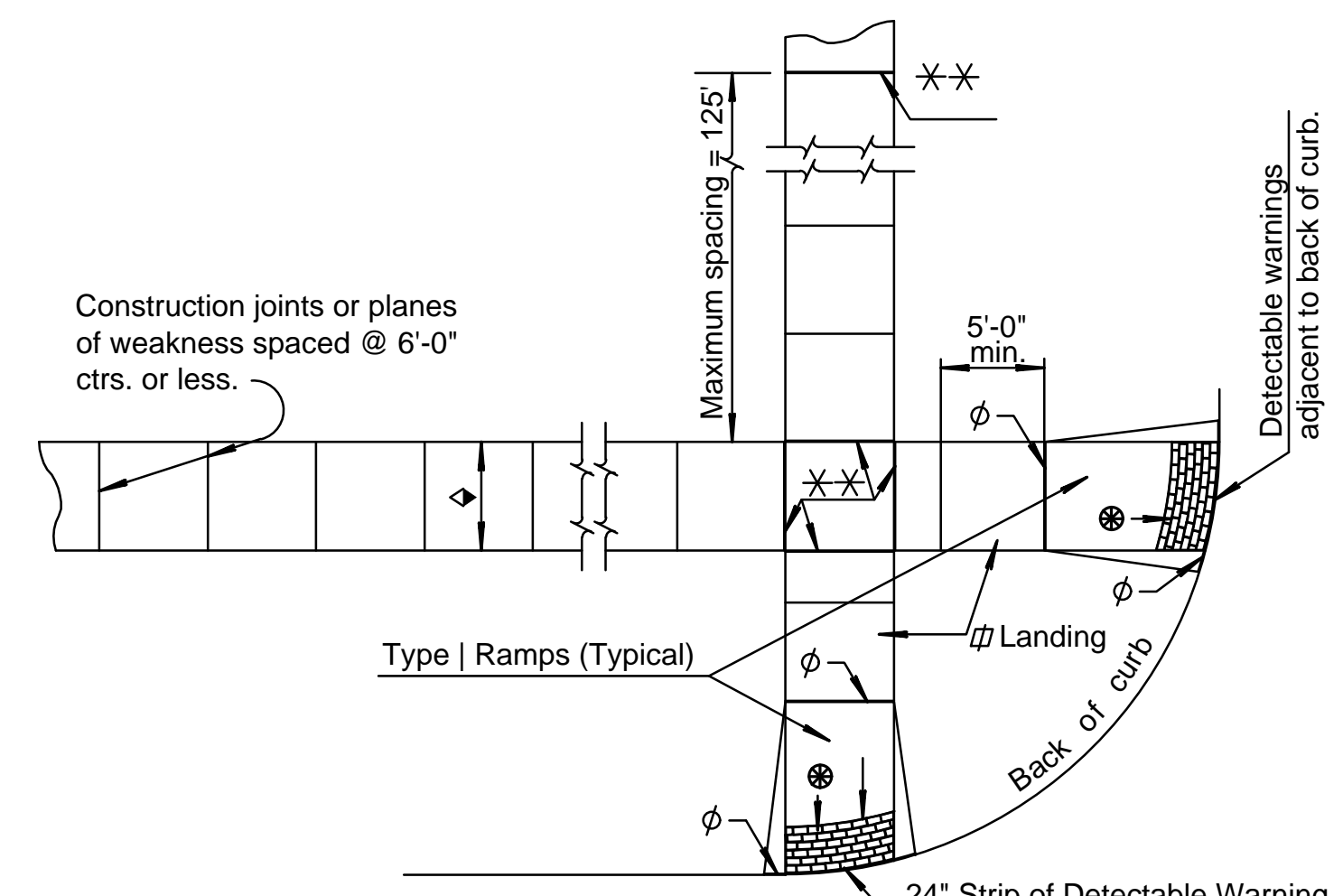

TYPICAL SIDEWALK PLAN
SCALE: NO SCALE

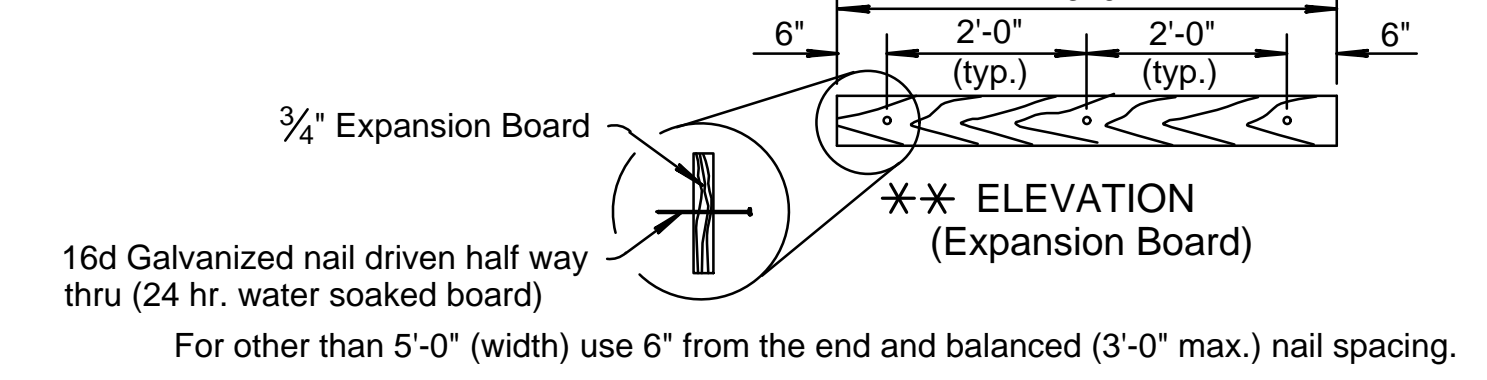

- φ Expansion Joint (3/4" board) placed at either back of curb line or at sidewalk back of curb line or at sidewalk line.
- * Expansion joint (3/4" board) located as shown.
- ◆ Variable width (5'-0" min.). Entrance walk to be same width as approach walk. Use sidewalk width of 4'-0" where existing conditions prohibit use of 5'-0".
- ☆ New construction ramp slopes are 12:1 or flatter. Desirable ramp slopes for existing sites are 12:1 or flatter. Where space limitations prohibit construction of a 12:1 slope on existing sites, use the following slopes:
8:1 or flatter for a maximum rise of 3 inches
10:1 or flatter for a maximum rise of 6 inches
- ∇ Use a landing slope of 48:1 or flatter. Landings are the same width as ramp and a minimum 5'-0" in length.
- ∩ Use a counter slope of 20:1 or flatter at the base of sidewalk ramps. See curb and gutter detail sheet.
- ⊗ Detectable warning installation is typical and required on Sidewalk Ramps Type 1, Type 2, Type 3, median ramp crossings and other locations as shown in the plans. See ramp detail sheet.

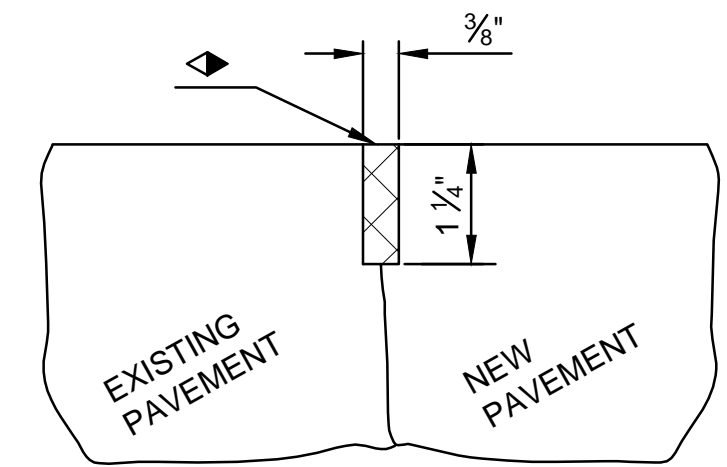

ALT. A - SAWED

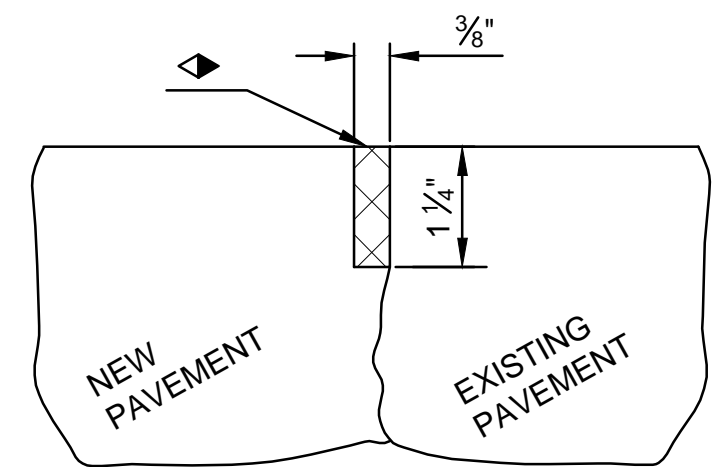

ALT. B - FORMED

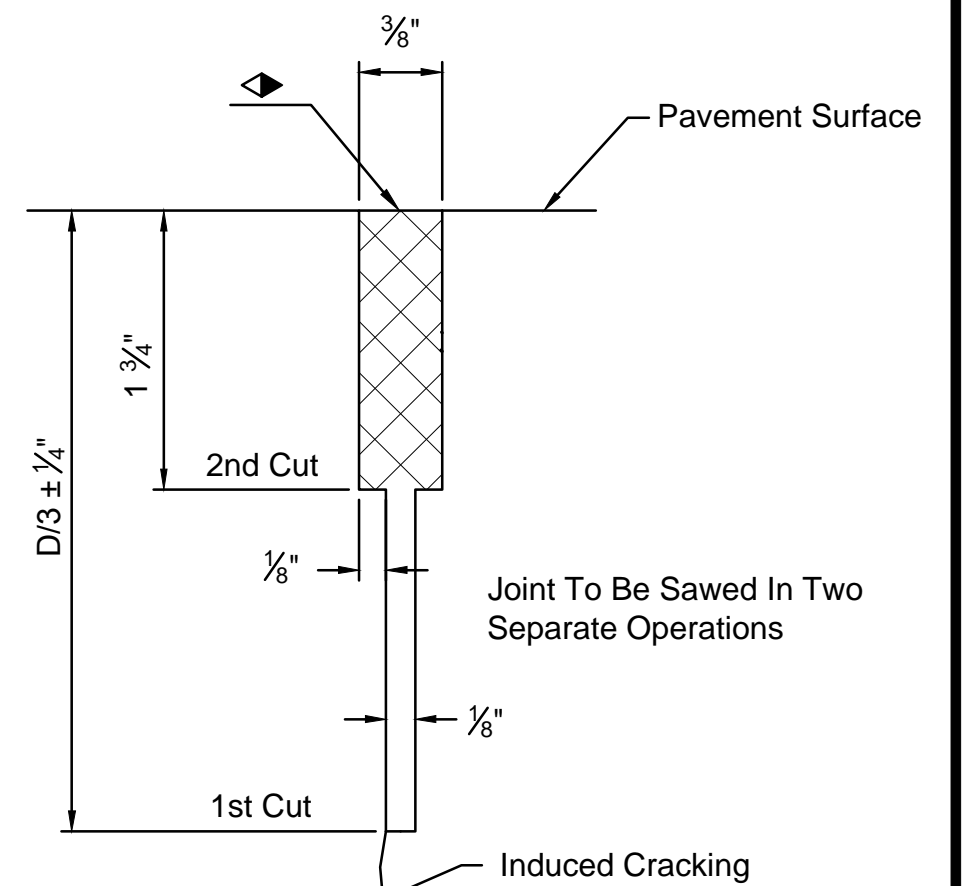

TYPE C

MAKE AN INITIAL 3/8" SAW CUT (D/3 ± 1/4" DEPTH); THE SECOND 3/8" SAW CUT IS A SEPARATE OPERATION DONE AFTER CONCRETE HAS GAINED SUFFICIENT STRENGTH TO AVOID SPALLING AS DETERMINED BY THE ENGINEER.

DETAIL FOR CONCRETE JOINTS
SCALE: NO SCALE

► FILL ALL SAWED JOINTS ON THE PROJECT FLUSH WITH THE PAVEMENT SURFACE IN ACCORDANCE WITH THE STANDARD SPECIFICATIONS.



STREET IMPROVEMENT PLANS FOR
MT. VERNON BIKE LANES
 FROM OLIVER TO WOODLAWN

©2017 MKEC Engineering All Rights Reserved
 These drawings and their contents, including, but not limited to, all concepts, designs, & ideas are the exclusive property of MKEC Engineering (MKEC), and may not be used or reproduced in any way without the express consent of MKEC.

SIDEWALK & RAMP PLAN

PROJECT NO.	472-85295	
DATE	JULY 7, 2017	
SCALE	AS SHOWN	
DESIGNED	DRAWN	CHECKED
JRA	BKS	JRA
NO.	REVISION	DATE