

GENERAL NOTES:

- The Contractor shall comply with all applicable safety regulations. All construction shall be completed following current City Standard Specifications and Special Provisions.
- Contractor will be required to provide notice to utility companies a minimum of seventy-two (72) hours prior to any excavation, as follows:
 Kansas One-Call (316) 687-2470
 The Contractor must notify the following in case of an emergency:
 AT&T 1-800-246-8464
 Black Hills Energy 1-800-694-8989
 City of Wichita Water & Sewer Dept. 1-316-219-8921
 City of Wichita Stormwater 1-316-268-4090
 City of Wichita Traffic 1-316-268-4034
 Cox Communications 1-888-249-3530
 Kansas Gas Service 1-888-482-4950
 Westar Energy 1-800-544-4857
- Utility service lines, poles, etc. are to be adjusted as necessary by others prior to construction unless the plans specifically call for their adjustment by the Contractor or unless the plans specifically identify a utility to be adjusted by its owner during construction. Existing utilities and their location, as shown on the plans, represent the best information obtainable for design. The Contractor will be required to work around existing utilities within the right-of-way which do not conflict with proposed construction.
- Rubble from the removal of miscellaneous structures and excess excavation which is to be wasted shall be disposed of on sites to be provided by the Contractor. These sites shall be approved by the Engineer as to suitability, appearance and site location. Locations, in the opinion of the Engineer, that will leave an unsightly appearance will not be approved. All disposal sites must be approved by the Kansas Department of Health and Environment. Material either stockpiled or disposed of in a flood plain would require a Kansas State Board of Agriculture permit. Any material dumped in waters of the United States or wetlands is subject to U.S. Corps. of Engineers permitting regulations. Any material buried or stockpiled beyond approved construction limits would require additional archaeological investigations unless buried in a previously approved borrow location.
- Trees and shrubs in public right-of-way which are in direct conflict with proposed new construction shall be removed by the Contractor with the Engineer's approval. Trees and shrubs which are not in direct conflict with proposed new construction shall be saved and protected from damage.
- The Contractor shall give all property owners and/or tenants of developed property abutting the construction of this project a minimum of ten (10) days notice prior to start of construction.
- The Contractor shall be responsible for preserving property irons. The Contractor will be required to re-establish any property irons which are damaged or destroyed by his construction operations. Such irons shall be re-established by a licensed land surveyor in accordance with state laws.
- The Water Distribution Division shall field locate water valves one time during construction when requested by the Contractor. It shall be the Contractor's responsibility to preserve such field locations during the construction process. Water valves, valve boxes or fire hydrants damaged during construction shall be repaired by Contractor at his own expense. Valve boxes and water meters within the project limits shall be adjusted to match field grades.
- The Contractor shall notify the consultant engineer and Tom Mason with the City at 316-268-4574 with the anticipated construction start date and notify them of project completion. Staking and inspection for this project will be the responsibility of the Contractor.
- If traffic is impacted by construction, a traffic control plan must be submitted and approved by the City Traffic Engineer, Brian Coon at traffic@wichita.gov before construction can begin. The Contractor shall be responsible for all traffic control measures to facilitate construction. All construction zone markings and signage shall conform to the latest version of the Manual on Uniform Traffic Control Devices (MUTCD) as published by the US Dept. of Transportation, Federal Highway Administration. All costs associated with construction markings and signage shall be the Contractors responsibility.
- All elevations shown are in NAVD88.

- All areas disturbed during construction that will not be under proposed pavement shall be restored to match existing conditions.
- Any sidewalk, drive approach, or street pavement removed to construct project must have a pavement cut permit and be replaced by the City contractor. Permits can be obtained by calling 316-268-4501 or 316-268-4480.
- A portion of excess excavated material shall be mounded around manholes which extend more than one (1) foot above the existing ground. Such mound shall be constructed with new development a six (6) foot diameter flat top with 4 to 1 side slopes down to the original ground. The elevation of the flat top of the mound shall be 0.4 foot below the top to the manhole.
- Contractor shall limit the extent of trench openings overnight and weekends to less than 50 feet.
- City maintenance of storm sewer ends at right-of-way or easement line.
- The inspecting firm shall submit to the City Stormwater Maintenance Division a digital copy of the CCTV inspection of the conduits and structures following construction. The digital file formation shall be compatible with the City input template. A copy of the template is available upon request at 316-268-4090.

PRIVATE STORM WATER DRAIN
to serve

Yost Automotive
1735 E. 2nd Street North
CITY OF WICHITA, KANSAS

Gary Janzen, P.E. City Engineer
Project Number
0522 PPD (132003)

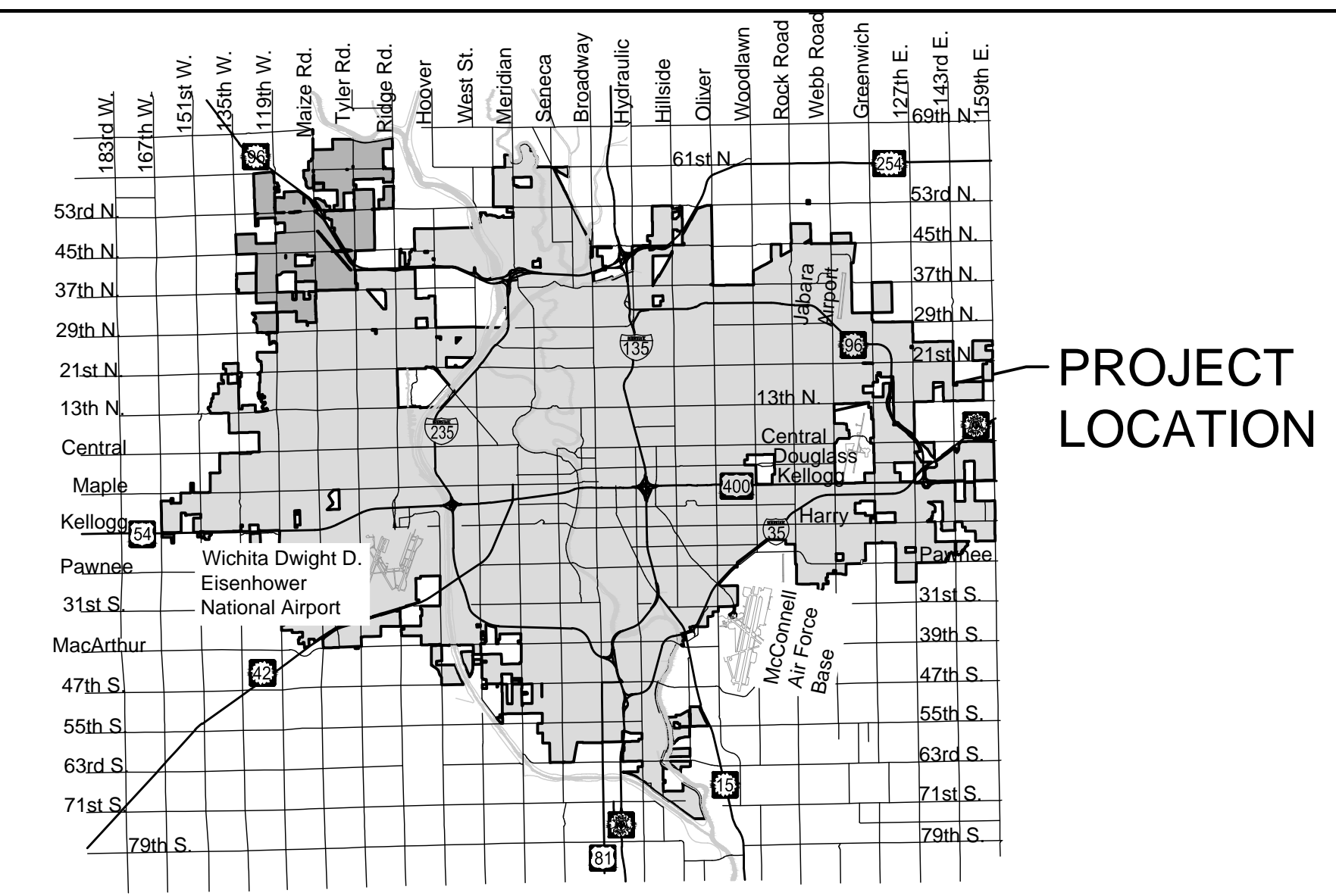

Vicinity Map

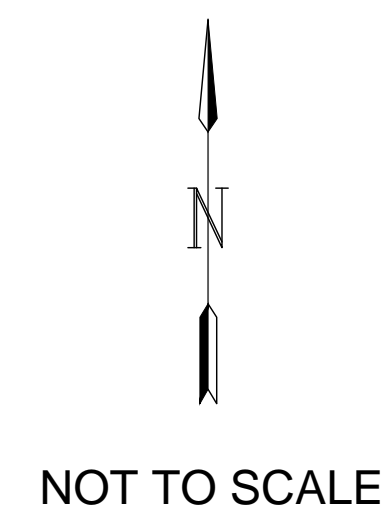
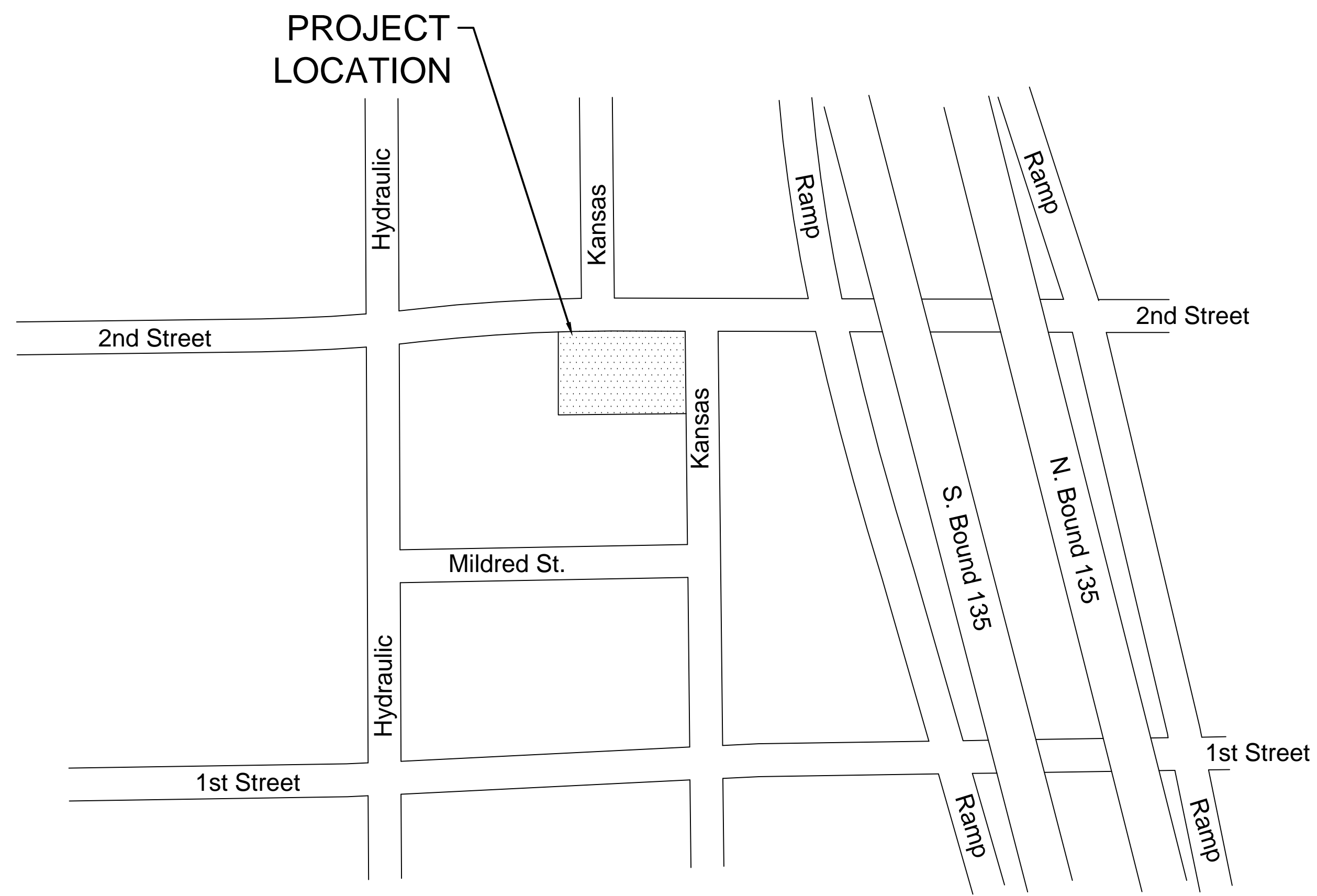

Sheet Index	
Sheet	Title
1	PRIVATE SWS Titlesheet
2	SWS
3	SW-109 Grated Driveway Inlet-Double
4	SW-110 Inlet Beam
5	SW-201 Single-Double Drop Inlet

Benchmarks

BENCHMARK #1:
CHISELED SQUARE ON THE TOP OF CURB, WEST SIDE OF KANSAS AT THE SOUTH PROPERTY LINE OF LOT 34 MOSSBACHER'S ADDITION
ELEVATION = 1297.21 (NAVD88)

BENCHMARK #2:
CHISELED SQUARE ON THE TOP OF CURB, EAST SIDE OF CURB INLET ON SOUTH SIDE OF 2ND STREET, 148 FEET WEST OF KANSAS AVE.
ELEVATION = 1297.36 (NAVD88)



RECORD DRAWINGS
Contractor: Dutton Construction
Inspector: Patrick Herman
GARVER LLC
PDF by: PMH 7-9-2019

Stormwater Certification:
New Development

These construction plans were prepared in accordance with the current Stormwater Management Regulations as set forth in the City of Wichita's Stormwater Management Ordinance 16.32 and the policies/guidelines presented in the Wichita/Sedgwick County Stormwater Manual.

Disturbed Area = 0.45 Acres
Water Quality Treatment: Not Applicable
Downstream Channel Protection: Not Applicable
Detention: Not Applicable
No permanent BMP required for this project.

APPROVED AS NOTED
BY WICHITA PUBLIC WORKS ENGINEERING
AND STORMWATER DIVISION

Engineering *Julianne Kallman 6-14-18*
Stormwater *Joe Hedrick PE 6/15/18*

NOTE TO CONTRACTORS

Installation, inspection and testing for this project is to be provided by a Licensed Consulting Engineering Firm under contract with the Owner/Developer. Said inspection to be in accordance with the City of Wichita standard construction engineering practices and certified by a Licensed Professional Engineer in the state of Kansas. No work shall be performed the Contractor without such inspection nor shall any work be commenced without written authorization by the City Engineer. All Construction and Materials shall comply with the current City of Wichita Specifications and Standards and Special Provisions. (on file and available at Wichita.gov).

An approved copy of these plans signed by City staff are required on-site.



April 2018
PLANS PREPARED BY

C201
GARVER
924 N. Main Street
Wichita, KS 67203
(316) 264-8008
www.GarverUSA.com



© 2018 GARVER, LLC
 THIS DOCUMENT, ALONG WITH THE IDEAS AND DESIGNS CONVEYED HEREIN, SHALL BE CONSIDERED INSTRUMENTS OF PROFESSIONAL SERVICE AND ARE PROPERTY OF GARVER, LLC. ANY USE, REPRODUCTION, OR DISTRIBUTION OF THIS DOCUMENT, ALONG WITH THE IDEAS AND DESIGN CONTAINED HEREIN, IS PROHIBITED UNLESS AUTHORIZED IN WRITING BY GARVER, LLC OR EXPLICITLY ALLOWED IN THE GOVERNING PROFESSIONAL SERVICES AGREEMENT FOR THIS WORK.

924 N. Main
 Wichita, KS 67203
 (316) 264-8008



REV.	DATE	DESCRIPTION	BY

RELPH CONSTRUCTION
 8550 NW Parallel Parkway
 TOWANDA, KANSAS 67144

YOST AUTOMOTIVE
 SITE IMPROVEMENTS

SWS

JOB NO.: 18267601
 DATE: June 2018
 DESIGNED BY: KWL
 DRAWN BY: DRS

BAR IS ONE INCH ON ORIGINAL DRAWING
 0" = 1" (AS SHOWN)
 IF NOT ONE INCH ON THIS SHEET, ADJUST SCALES ACCORDINGLY.

DRAWING NUMBER
C202

SHEET NUMBER **2** OF **4**

NOTES:

1. CONTRACTOR SHALL CUT EXISTING INLET DOWN AS NECESSARY TO INSTALL NEW GRATED INLET TOP.
2. AN INLET BEAM SHALL BE INSTALLED TO SUPPORT THE NEW TOP.
3. FIELD ADJUST ELEVATION OF CONNECTION TO EXISTING INLET TO PROVIDE 12" CLEARANCE FROM EXISTING UTILITIES EXPOSED DURING CONSTRUCTION.
4. SWS PIPE IN STREET R/W SHALL BE RCP PIPE. CONTRACTOR MAY USE A COUPLING TO USE HDPE PIPE IN LIEU OF RCP ON PRIVATE PROPERTY.

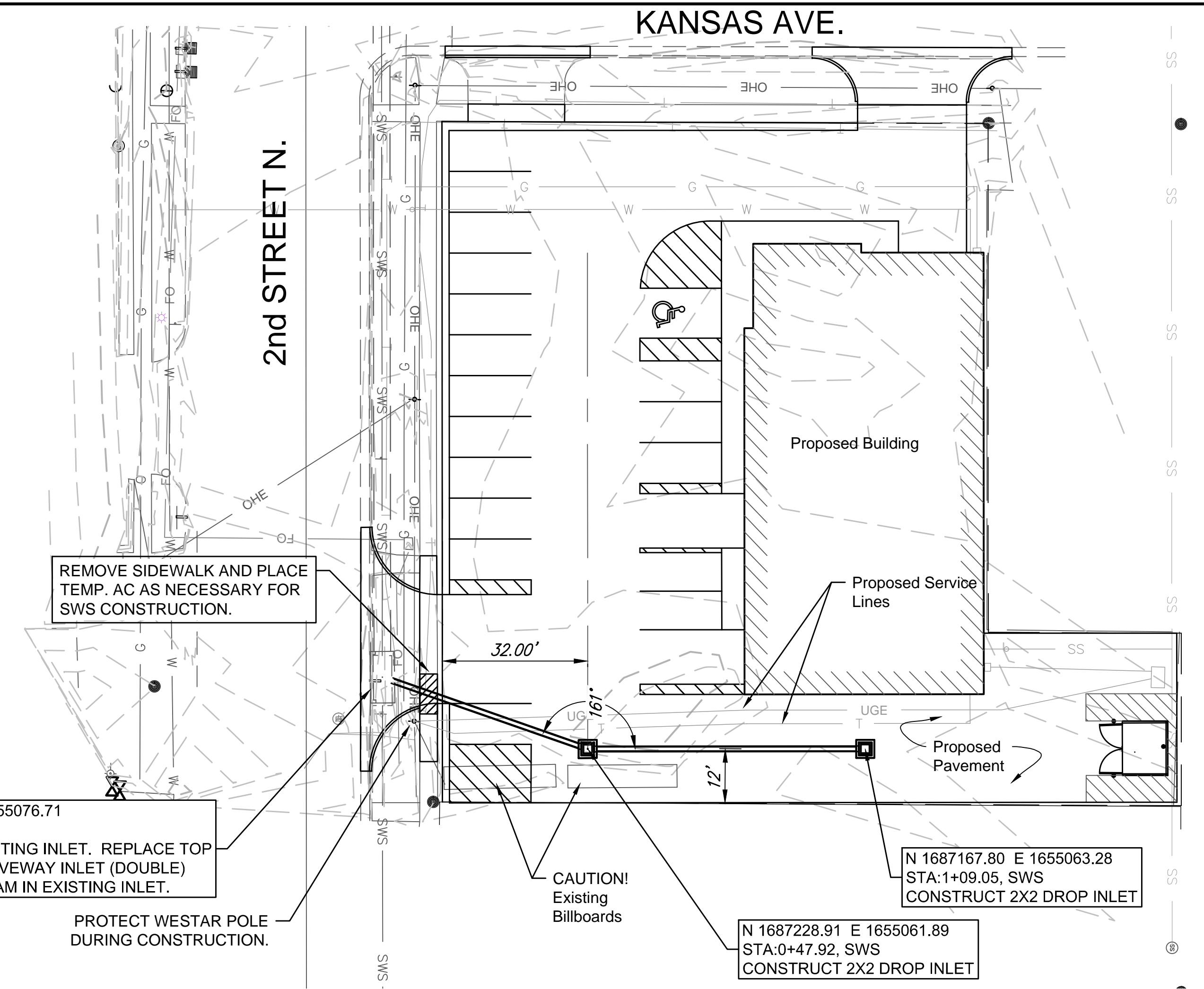
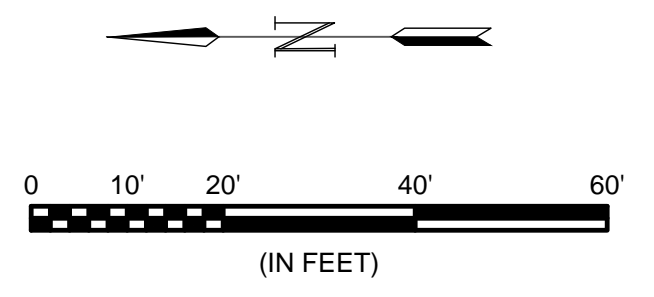

N 1687274.49 E 1655076.71
 STA:0+00.00, SWS
 CONNECT TO EXISTING INLET. REPLACE TOP WITH GRATED DRIVEWAY INLET (DOUBLE) INSTALL INLET BEAM IN EXISTING INLET.

N 1687167.80 E 1655063.28
 STA:1+09.05, SWS
 CONSTRUCT 2X2 DROP INLET

ELEVATION OF CONNECTION POINT MAY BE ADJUSTED TO CLEAR UTILITIES ENCOUNTERED DURING CONSTRUCTION.

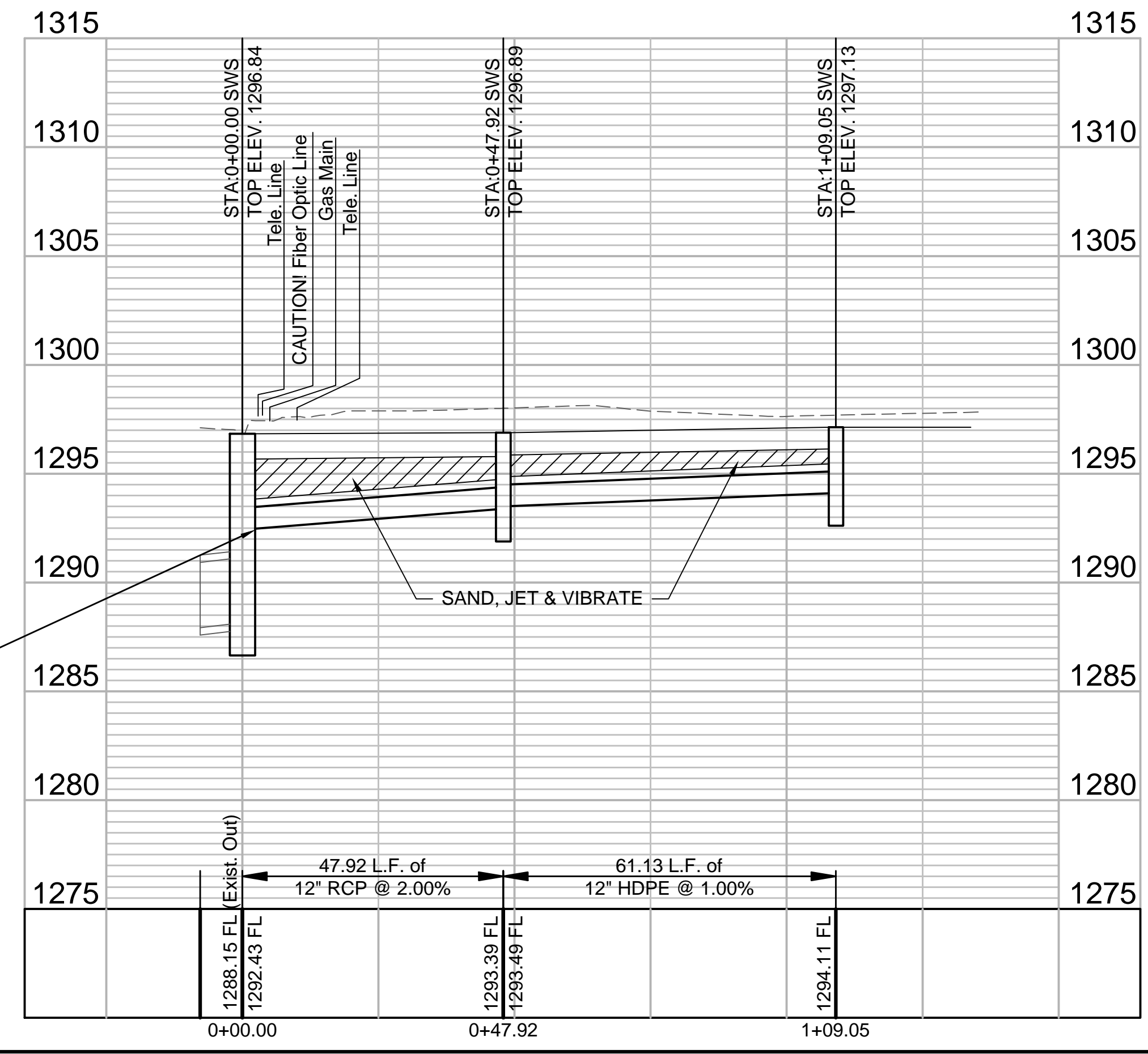

ATT FACILITY NOTIFICATION

AT&T HAS FIBER OPTIC LINES IN THIS AREA. HAND DIGGING IS MANDATORY WITHIN THE 24" STATUTORY TOLERANCE ZONE OF THE MARKED LINES.

CONTRACTOR MAY CONTACT STEVE BARRON AT 314-420-1973 IF THERE ARE QUESTIONS OR ASSISTANCE NEEDED DURING EXCAVATION ACTIVITIES.

File: L:\2018\18267601 - Yost Automotive Civil\Drawings\C202\SWS.dwg, Last Saved: 6/13/2018 11:09 AM, Last saved by: KWL
 Last plotted by: Lee, Ken W., Plot Style: ---, Plot Scale: 1:2.5849, Plot Date: 3/27/2019 9:40 AM, Plotter used: None

RECORD DRAWINGS
 Contractor: Dutton Construction
 Inspector: Patrick Herman
 GARVER LLC
 PDF by: PMH 7-9-2019

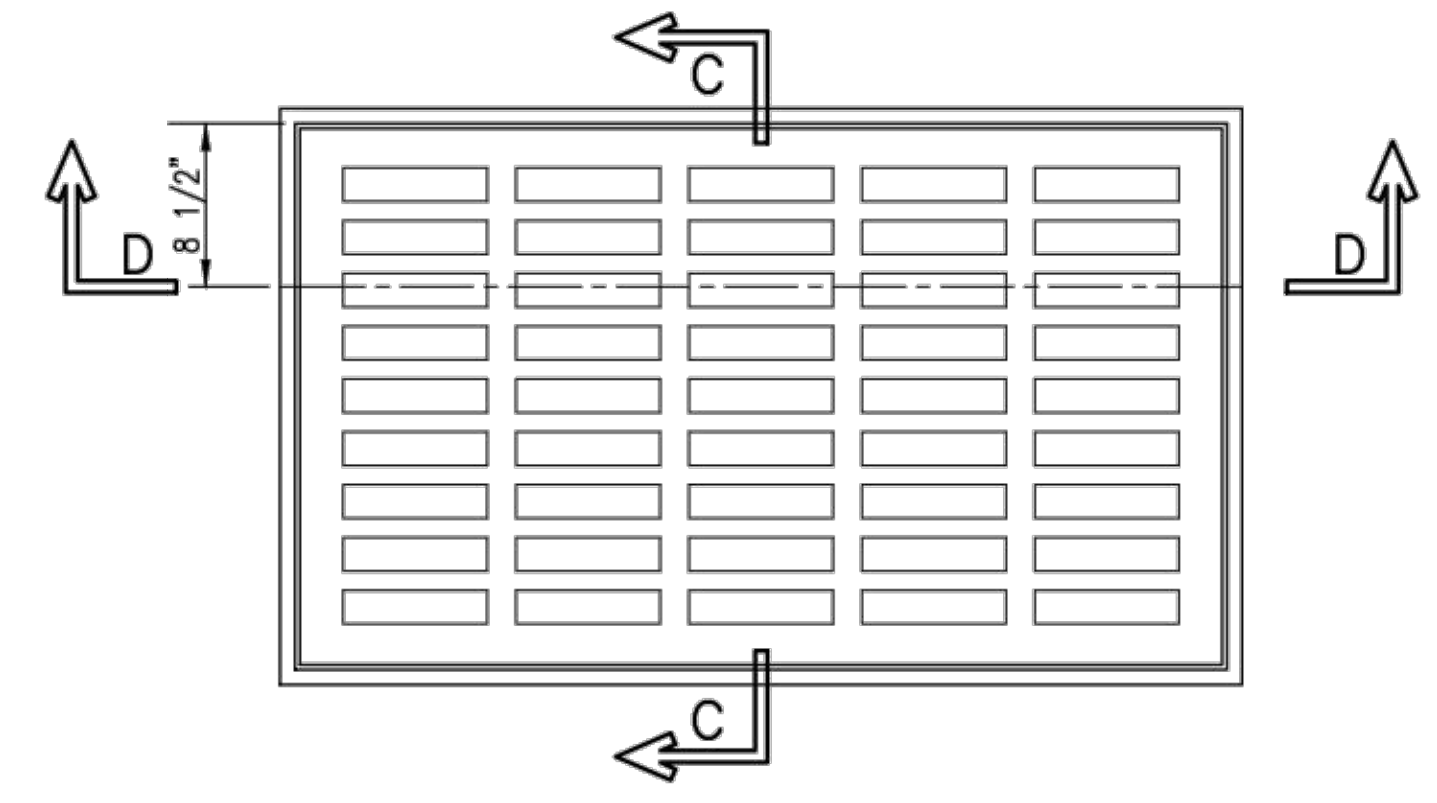
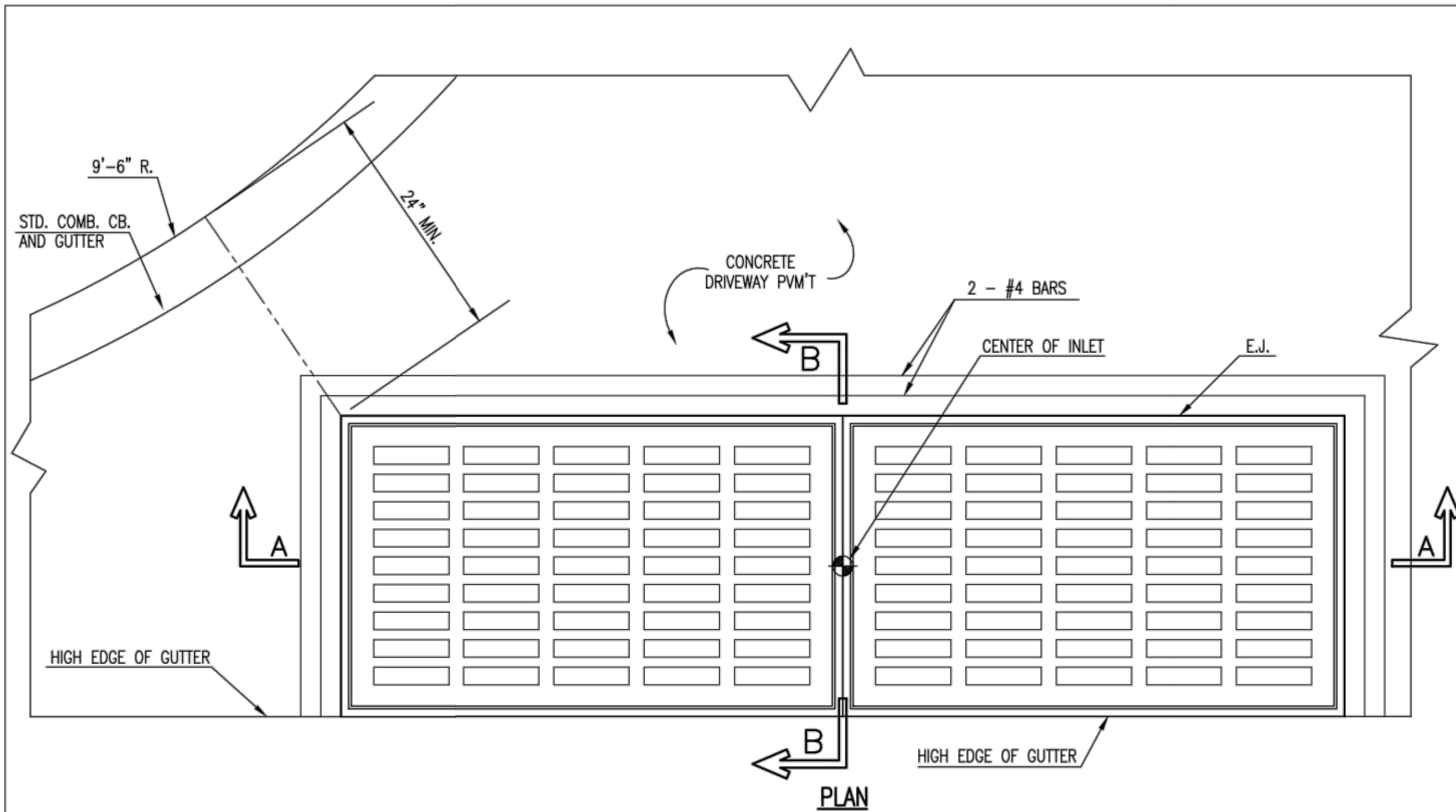

PLAN
DEETER #2095 FRAME & GRATE
TOTAL WEIGHT: 705 LBS.
(2 EACH REQUIRED)
OR EJIW #7392

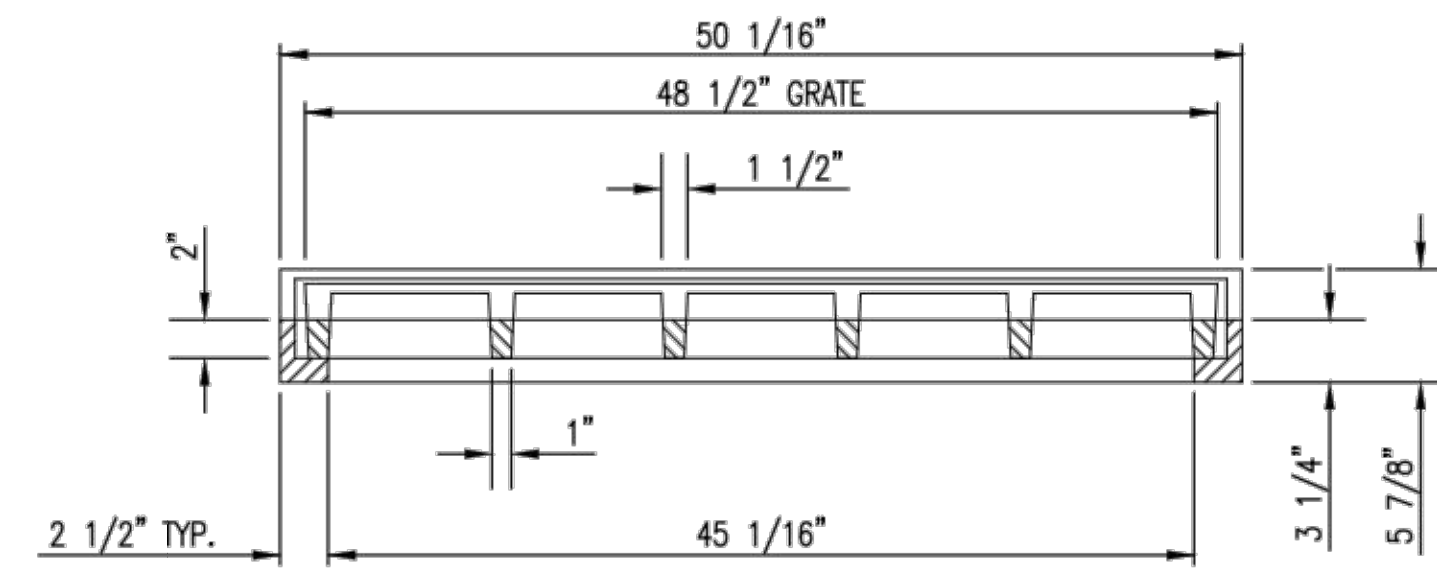

SECTION D-D

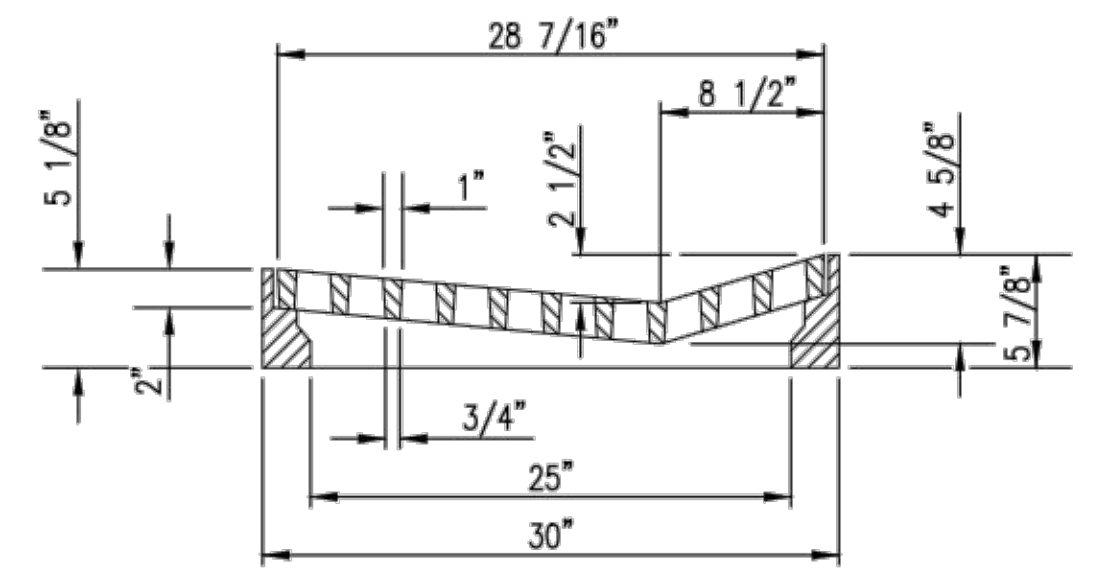

SECTION C-C

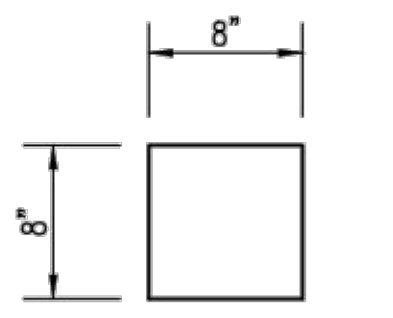

CONCRETE BEAM POCKET

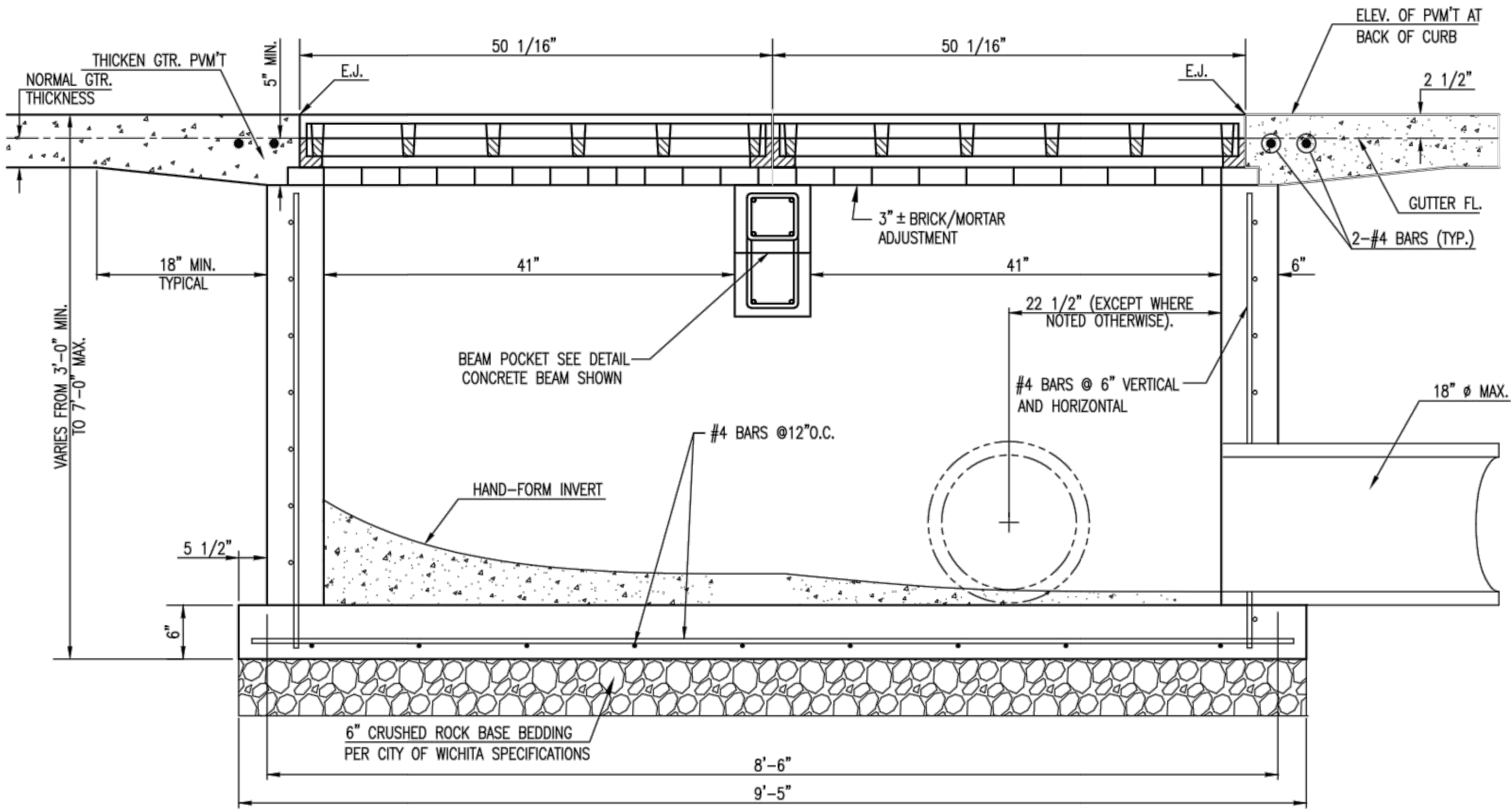

SECTION A-A

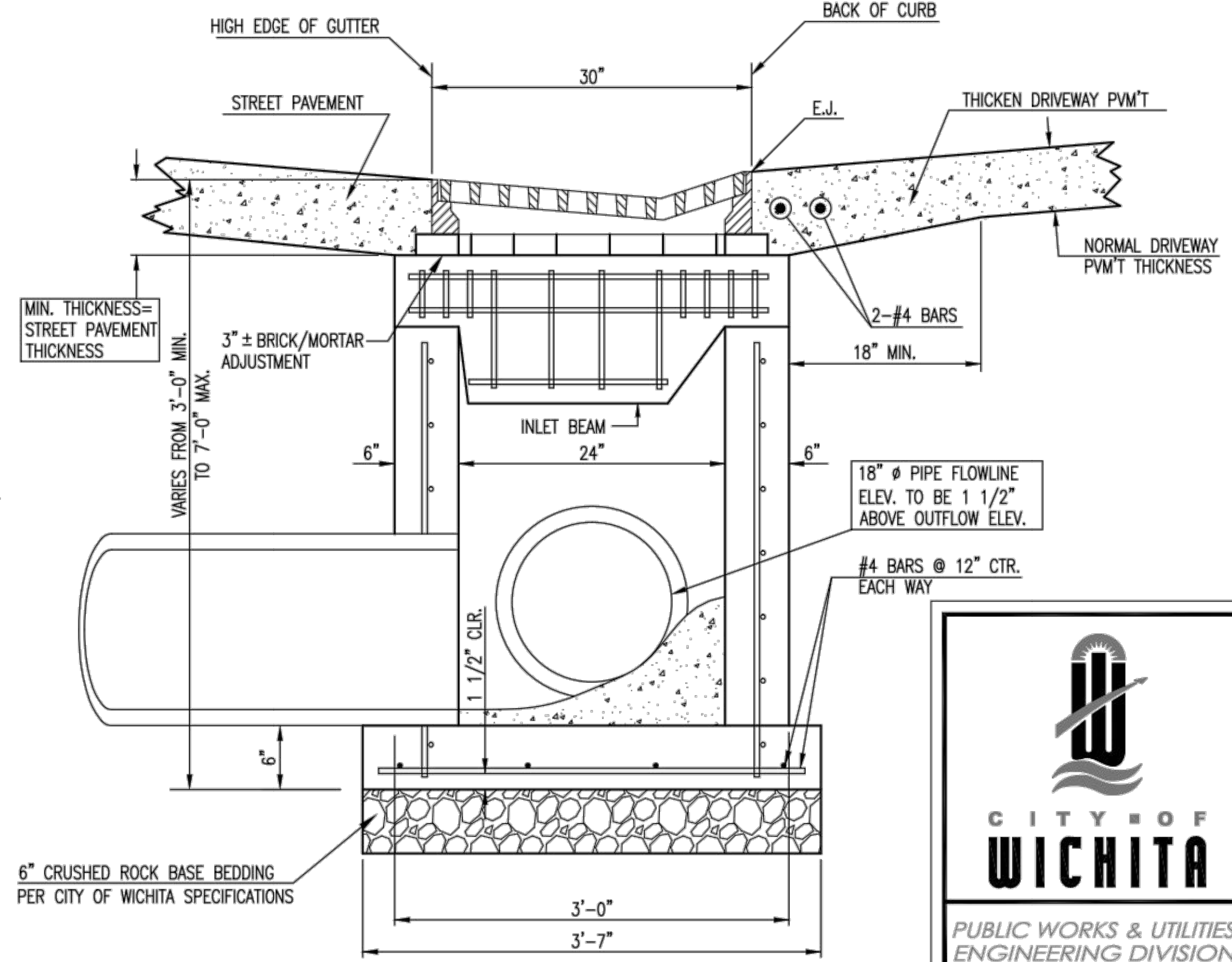

SECTION B-B

GENERAL NOTES

1. GRATE FRAME TO BE INSTALLED ON THIN MORTAR CUSHION TO INSURE FULL SUPPORT ALONG BRICK. CONCRETE USED FOR INLET CONSTRUCTION SHALL CONFORM TO CITY OF WICHITA SPECIFICATIONS FOR CONCRETE PAVEMENT MIX.
2. CONTRACTOR SHALL HAVE THE OPTION OF CONSTRUCTING 8" BRICK MASONRY WALL BETWEEN THE CONCRETE INLET BASE AND TOP OF THIS INLET WHEN H=7'-0" OR LESS.
3. INLET INVERT SHALL BE SHAPED WITH 8 SACK SAND MIX CONCRETE TO CREATE FLOW CHANNELS AND TO INCREASE HYDRAULIC EFFICIENCY SUCH THAT THE INLET WILL BE SELF CLEANING BETWEEN ALL INLET AND/OR OUTLET PIPES.
4. THE ENDS OF ALL PIPES INSTALLED IN INLETS SHALL BE CUT OFF FLUSH WITH THE INSIDE FACE OF THE INLET WALL.
5. INLET FRAME AND GRATE TO BE DEETER #2095, EJIW #7392, OR APPROVED EQUAL.
6. CONTRACTOR SHALL REMOVE LIFTING HOOKS AFTER INSTALLATION. RECESSES IN INLET WALL SHALL BE GROUTED FLUSH TO THE INLET WALL WITH HYDRAULIC CEMENT AFTER THE INLET IS IN PLACE. LIFTING HOLES THRU THE INLET WALL WILL NOT BE ACCEPTED.

RECORD DRAWINGS
Contractor: Dutton Construction
Inspector: Patrick Herman
GARVER LLC
PDF by: PMH 7-9-2019



GRATED DRIVEWAY INLET (DOUBLE)		
CITY ENGINEER GARY JANZEN, P.E.		
PROJECT NUMBER 0522	OCA NUMBER .	DATE 05/2013
CITY ENGINEER'S OFFICE CITY HALL - SEVENTH FLOOR 455 NORTH MAIN STREET WICHITA, KANSAS 67202-1620 (316) 268-4501		SHEET 3 4

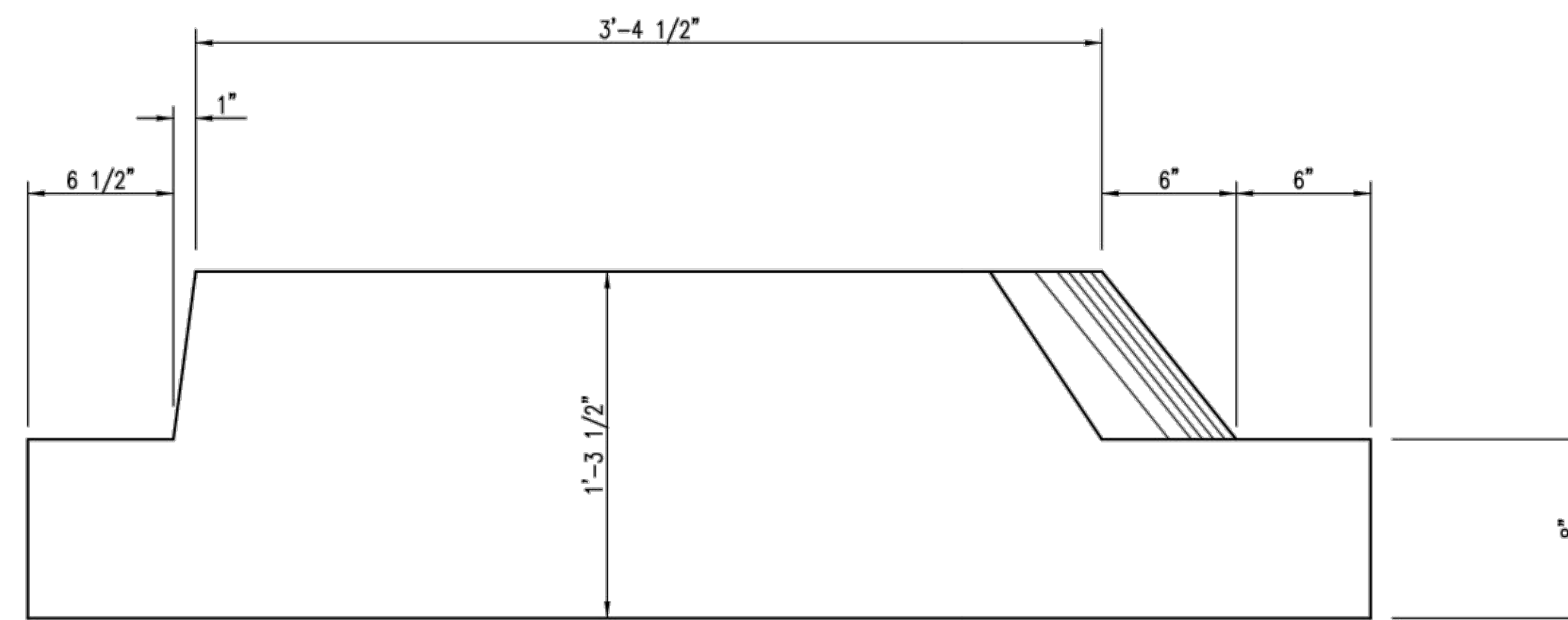
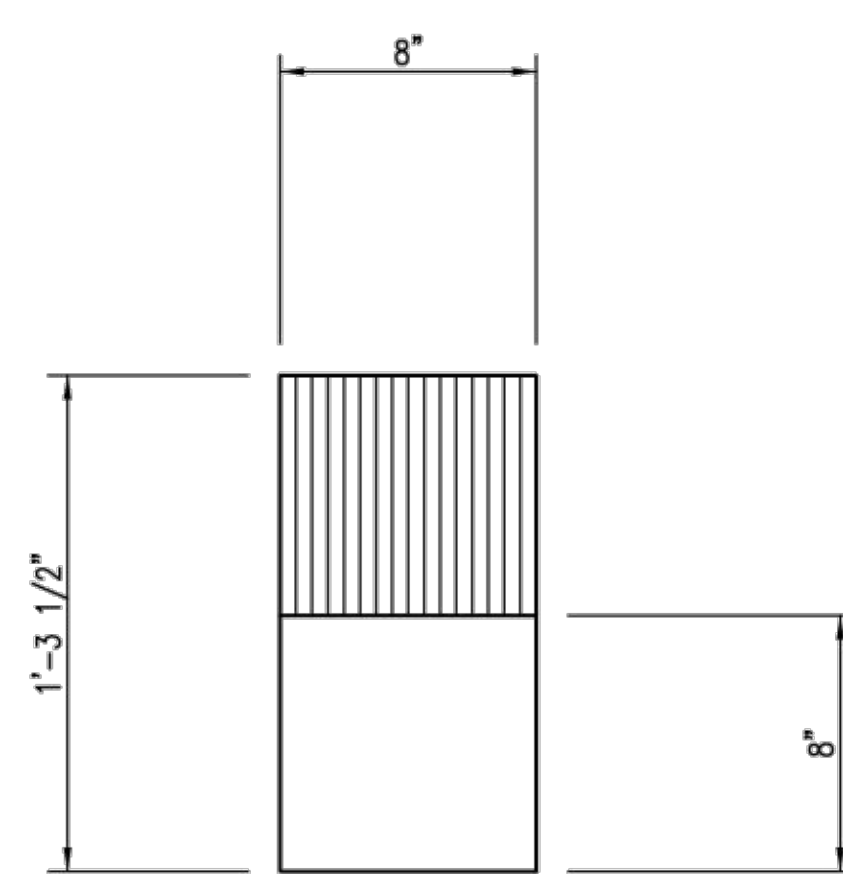
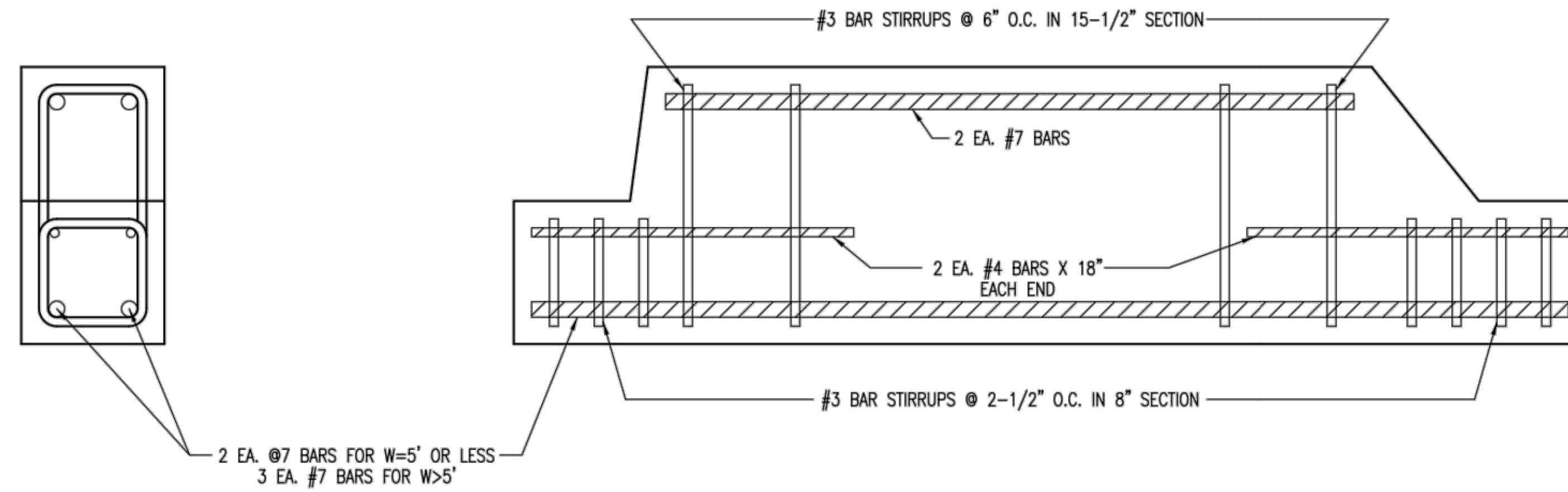

RECORD DRAWINGS
 Contractor: Dutton Construction
 Inspector: Patrick Herman
 GARVER LLC
 PDF by: PMH 7-9-2019



C204		
INLET BEAM		
CITY ENGINEER GARY JANZEN, P.E.		
PROJECT NUMBER 0522	OCA NUMBER .	DATE 11/2010
CITY ENGINEER'S OFFICE CITY HALL - SEVENTH FLOOR 455 NORTH MAIN STREET WICHITA, KANSAS 67202-1620 (316) 268-4501		SHEET 4 4

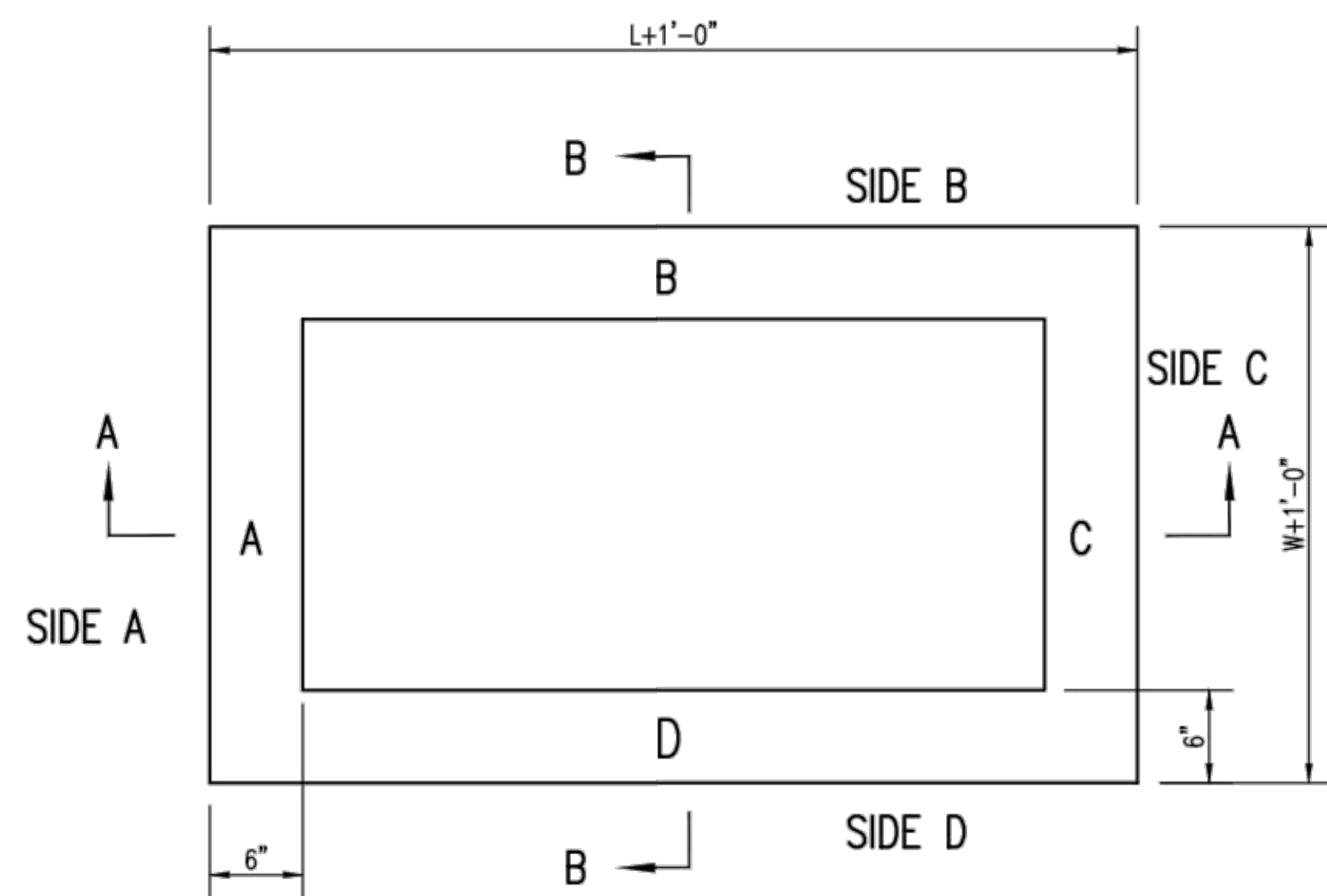

TOP VIEW

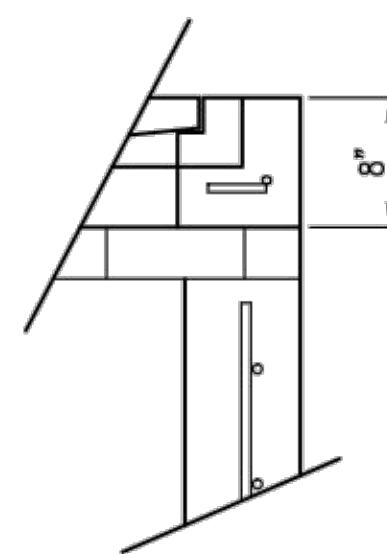

FLUSH STYLE TOP
NO APRON

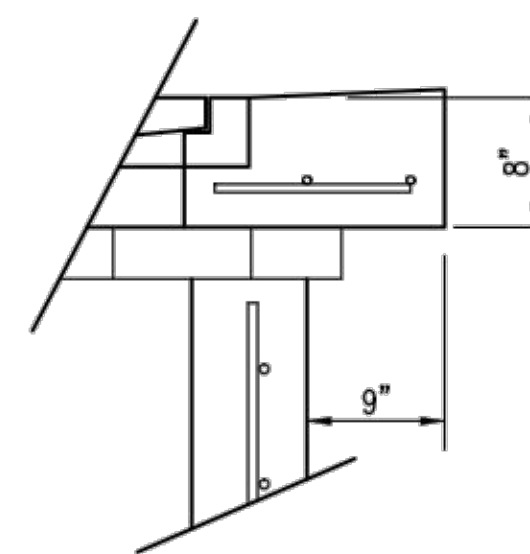

9" APRON

* APRON TO EXTEND ON ALL 4 SIDES OF INLET.
DESIGNER TO DESIGNATE APRON SIZE.

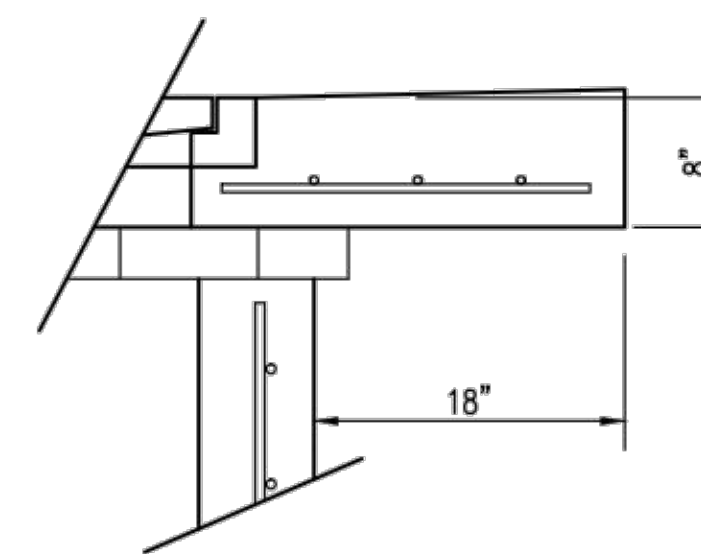

18" APRON

W=2' and L=2' for SINGLE DROP INLET
W=2' and L=4' for DOUBLE DROP INLET

The structure(s) on this detail sheet are designed for HS-20 loading at these specific dimensions only. If larger dimensions are required, the ENGINEER shall provide a project specific structure design for approval by the City Engineer's office.

GENERAL NOTES

1. GRATE FRAME TO BE INSTALLED ON THIN MORTAR CUSHION TO INSURE FULL SUPPORT ALONG BRICK. CONCRETE USED FOR INLET CONSTRUCTION SHALL CONFORM TO CITY OF WICHITA SPECIFICATIONS FOR CONCRETE PAVEMENT MIX.
2. INLET INVERT SHALL BE SHAPED WITH 8 SACK SAND MIX CONCRETE TO CREATE FLOW CHANNELS AND TO INCREASE HYDRAULIC EFFICIENCY SUCH THAT THE INLET WILL BE SELF CLEANING BETWEEN ALL INLET AND/OR OUTLET PIPES.
3. THE ENDS OF ALL PIPES INSTALLED IN INLETS SHALL BE CUT OFF FLUSH WITH THE INSIDE FACE OF THE INLET WALL.
4. INLET FRAME AND GRATE TO BE DEETER #2433, EJIW #5391-21 OR APPROVED EQUAL FOR 2'x2' SINGLE DROP INLET AND DEETER #2434, EJIW #5391 Z3 OR APPROVED EQUAL FOR 2'x4' DOUBLE DROP INLET.
5. CONTRACTOR SHALL REMOVE LIFTING HOOKS AFTER INSTALLATION. RECESSES IN INLET WALL SHALL BE GROUTED FLUSH TO THE INLET WALL WITH HYDRAULIC CEMENT AFTER THE INLET IS IN PLACE. LIFTING HOLES THRU THE INLET WALL WILL NOT BE ACCEPTED.

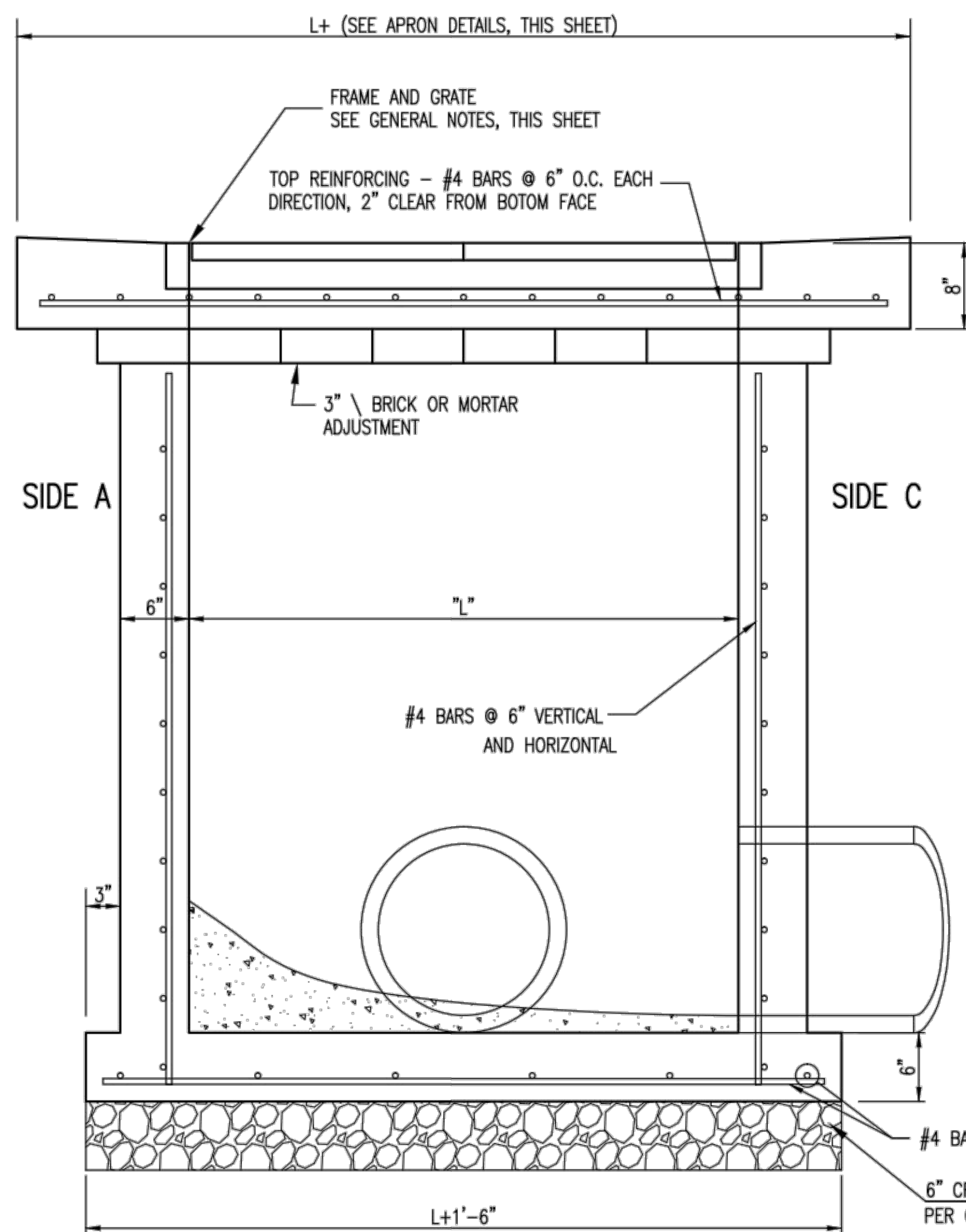

SECTION "A-A"

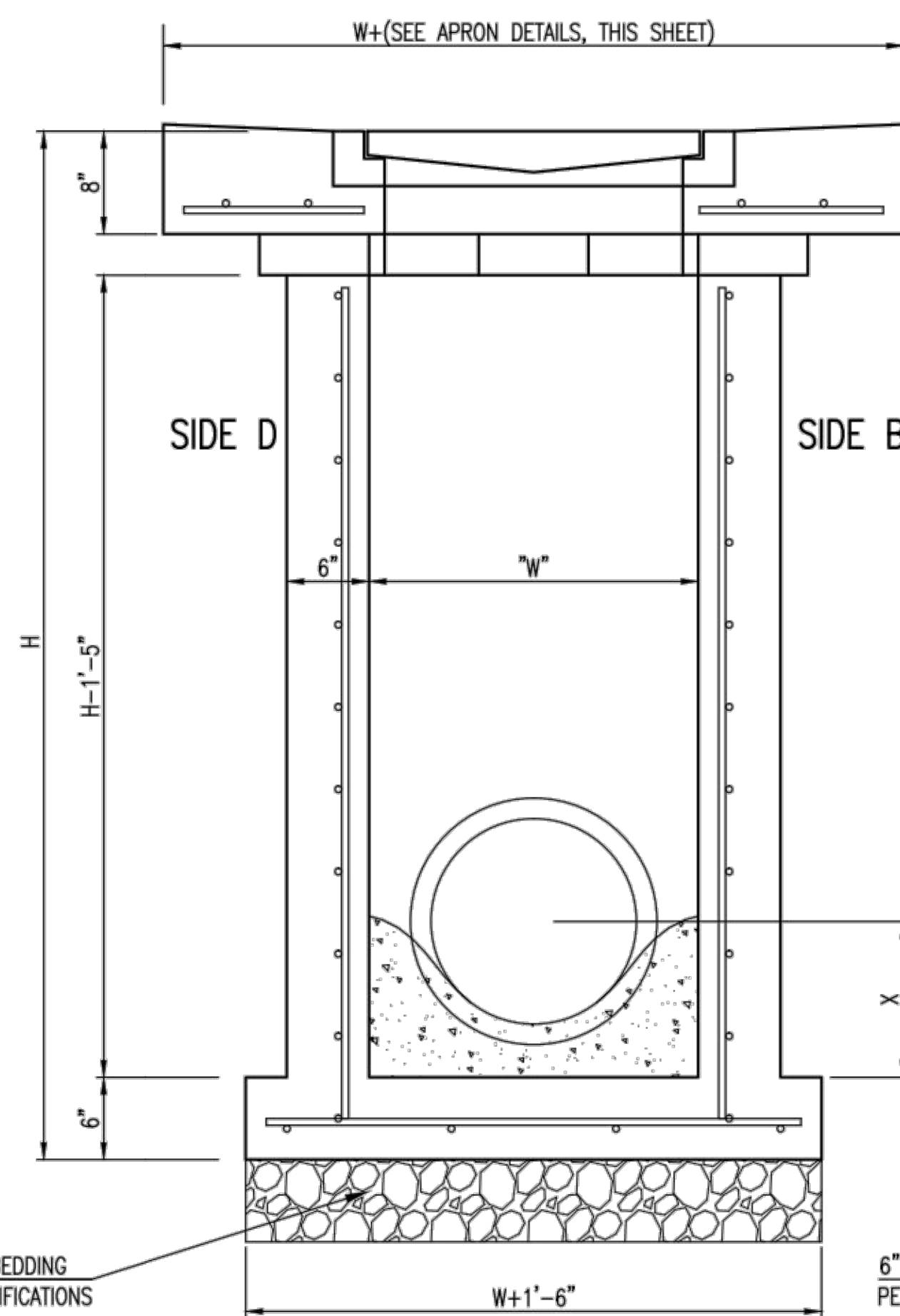

SECTION "B-B"
END OUTLET

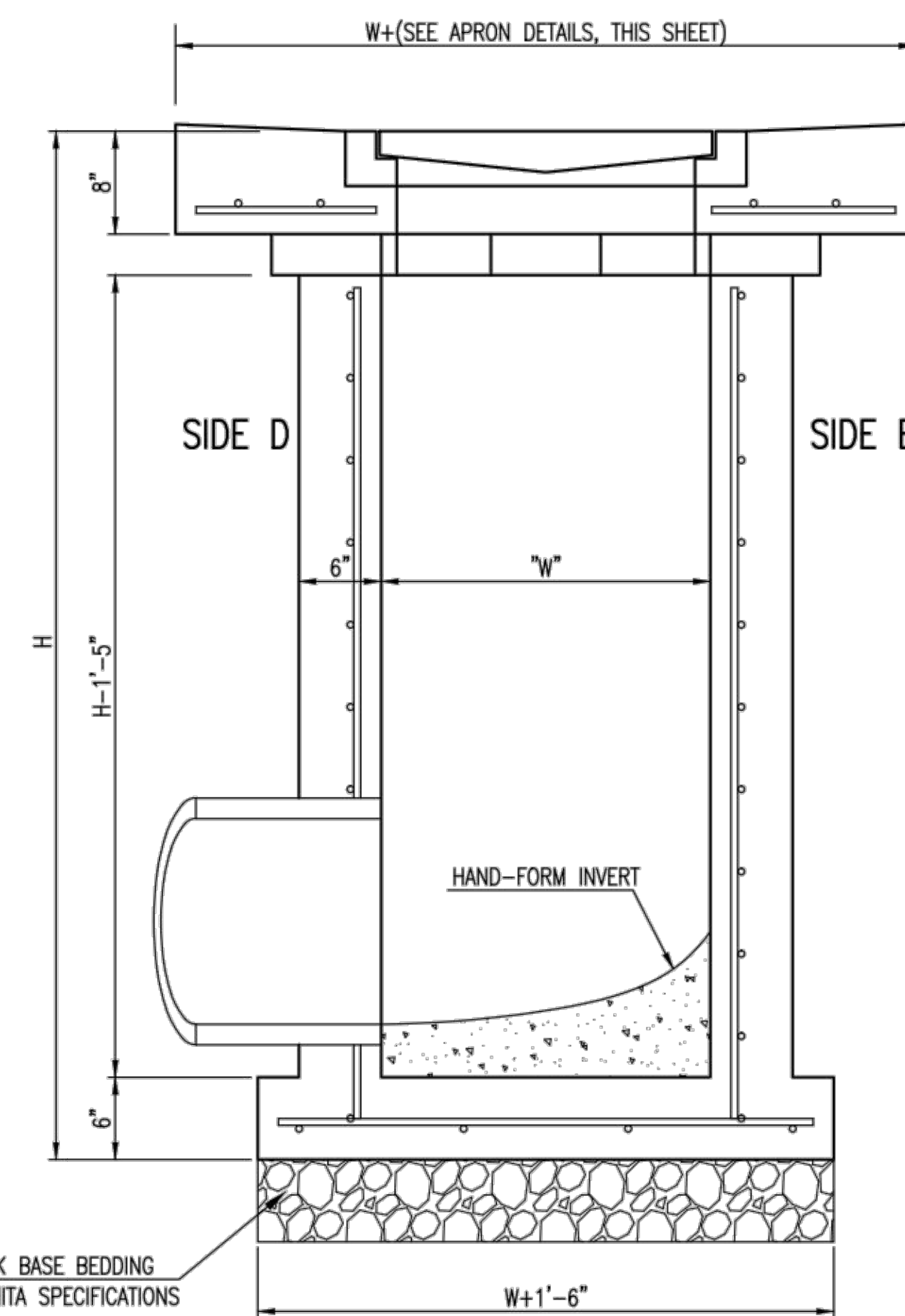

SECTION "B-B"
SIDE OUTLET

RECORD DRAWINGS
Contractor: Dutton Construction
Inspector: Patrick Herman
GARVER LLC
PDF by: PMH 7-9-2019



SINGLE/DOUBLE DROP INLET		
CITY ENGINEER GARY JANZEN, P.E.		
PROJECT NUMBER 0522	OCA NUMBER .	DATE 05/2011
CITY ENGINEER'S OFFICE CITY HALL - SEVENTH FLOOR 455 NORTH MAIN STREET WICHITA, KANSAS 67202-1620 (316) 268-4501		SHEET 5 4