

J:\PROJECTS\2019\1810010221_PERFECTION_AUBURN_LAKES_18221_CAD\SHOTS\05_CIVIL\PAVPHASE2\18221-05-2019-PH2.DWG
 PLOTTED: Tuesday, July 30, 2019 @ 11:35AM

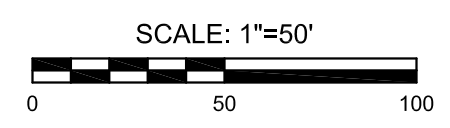
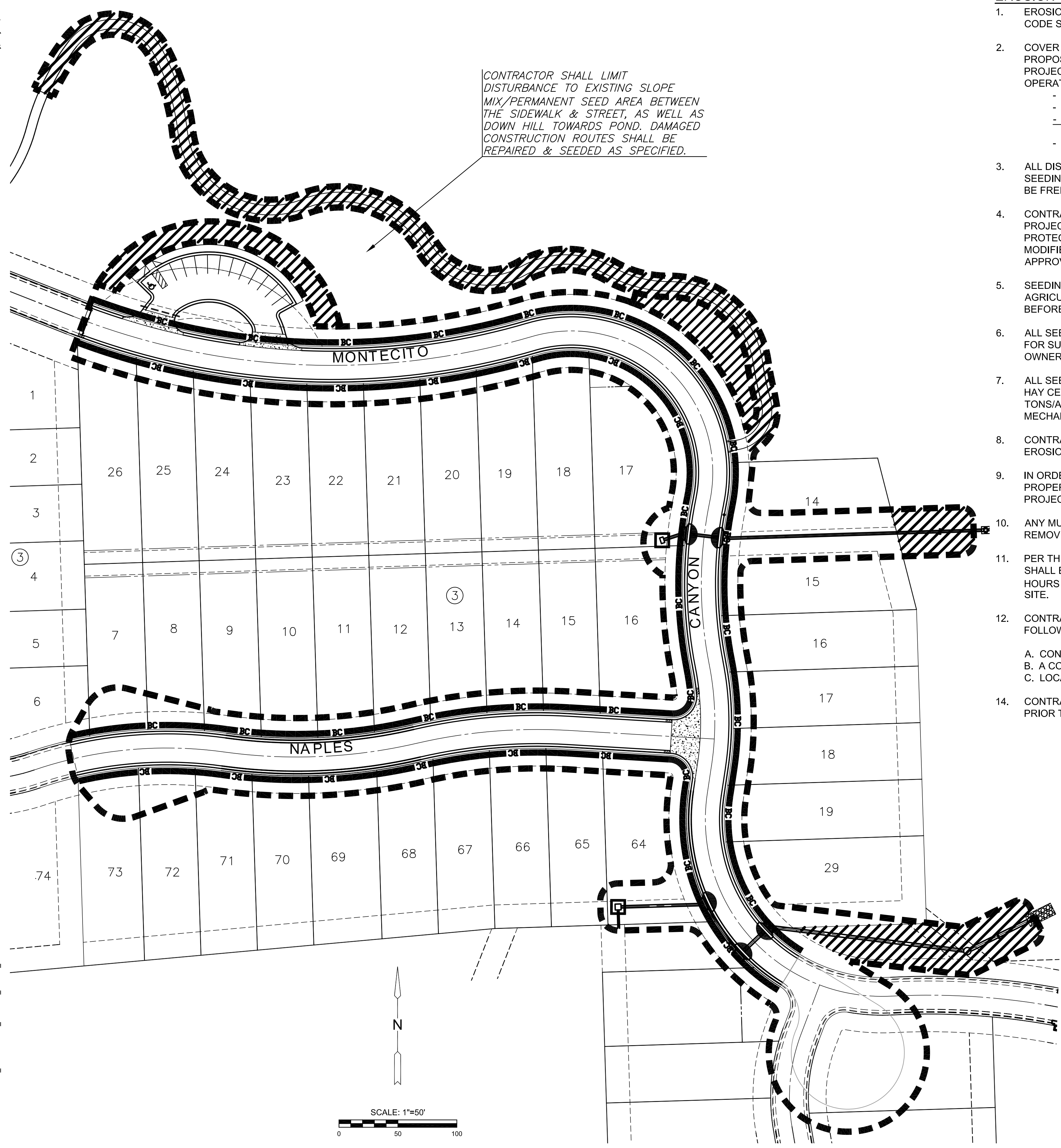

EROSION CONTROL/SEEDING NOTES

1. EROSION CONTROL IS TO MEET ALL FEDERAL, STATE, COUNTY AND LOCAL CODE STANDARDS.
2. COVER CROP SEEDING MIX: ALL AREAS DISTURBED WITH EXCEPTION OF PROPOSED STREET PAVEMENT SHALL BE SEED (COST SUBSIDIARY TO PROJECT) AND FERTILIZED AS FOLLOWS IMMEDIATELY AFTER GRADING OPERATIONS ARE COMPLETE:
 - OATS @ 45 LBS./ACRE
 - "REGREEN" STERILE WHEAT @ 45 LBS./ACRE
 - CANADA WILD RYE @ 20 LBS./ACRE
 - 110 LBS./ACRE TOTAL
 - SLOW RELEASE @ 150 LBS./ACRE
3. ALL DISTURBED AREAS, INCLUDING THOSE LOCATIONS BEYOND THE SEEDING LIMITS DEPICTED, SHALL BE FINE GRADED AND SURFACE SHALL BE FREE FROM LIMBS, STONES, AND OTHER EXTRANEIOUS MATERIALS.
4. CONTRACTOR SHALL PROVIDE EROSION PROTECTION THROUGHOUT PROJECT CONSTRUCTION. THE PLAN PROVIDED HERE IS FOR FINAL PROTECTION, VARIOUS PHASES OF THIS PLAN SHALL BE IMPLEMENTED OR MODIFIED TO CONTROL EROSION. MODIFICATIONS OF THE PLAN SHALL BE APPROVED BY THE OWNER'S REPRESENTATIVE.
5. SEEDING AREAS SHALL BE PREPARED FOR PLANTING WITH COMMON AGRICULTURAL TECHNIQUES. APPROVE WITH OWNER'S REPRESENTATIVE BEFORE PLANTING.
6. ALL SEED SHALL BE DISTRIBUTED WITH AN ACCEPTABLE DRILL INTENDED FOR SUCH OPERATIONS, OR OTHER EQUIPMENT APPROVED BY THE OWNER'S REPRESENTATIVE. SEEDING DEPTH SHALL BE 1/4 OF AN INCH.
7. ALL SEEDED AREAS SHALL BE IMMEDIATELY MULCHED WITH CLEAN PRAIRIE HAY CERTIFIED BY THE NORTH AMERICAN FORAGE ASSOCIATION AT 2 TONS/ACRE. ANCHOR MULCH BY CRIMPING INTO TOPSOIL WITH SUITABLE MECHANICAL EQUIPMENT.
8. CONTRACTOR IS RESPONSIBLE FOR MAINTAINING AND IMPLEMENTING ALL EROSION CONTROL.
9. IN ORDER TO PREVENT SILT OR SEDIMENT FROM ENTERING ADJACENT PROPERTIES, APPROPRIATE BMP'S SHALL BE IMPLEMENTED WITHIN THE PROJECT.
10. ANY MUD TRACKED ONTO ADJACENT PAVED AREAS OR STREETS SHALL BE REMOVED AT THE END OF EACH WORK DAY.
11. PER THE REQUIREMENTS OF THE NOI/SWPPP, BMP INSPECTION REPORTS SHALL BE COMPLETED BY THE CONTRACTOR WEEKLY AND WITHIN 24 HOURS AFTER A 1/2" RAIN. REPORTS SHALL BE KEPT WITH THE SWPPP ON SITE.
12. CONTRACTOR SHALL PROVIDE A SIGN NEAR THE ENTRANCE WITH THE FOLLOWING INFORMATION:
 - A. CONTACT NAME AND INFORMATION
 - B. A COPY OF THE NOI
 - C. LOCATION OF SWPPP
14. CONTRACTOR SHALL MAINTAIN ALL EROSION CONTROL DEVICES IN-PLACE PRIOR TO AND DURING CONSTRUCTION.

LEGEND

- BC BACK OF CURB PROTECTION (3,117 LF)
- STABILIZED CONSTRUCTION ENTRANCE
- 12" STRAW WAFFLE DITCH CHECK
- DROP INLET PROTECTION (2)
- CURB INLET PROTECTION (5)
- COVER CROP SEEDING (1.38 AC.) AS DEPICTED FOR INFO. ONLY
- SLOPE MIX (PERMANENT) SEEDING (0.68 AC.) AS DEPICTED FOR INFO. ONLY

NATIVE GRASS & WILDFLOWER INSTALLATION

- SEEDBED PREPARATION:
1. ONCE TOPSOIL HAS BEEN PLACED, DISC/SCARIFY SOIL PRIOR TO SEEDING UNLESS SEEDING INTO INTENTIONALLY PLANTED COVER CROP.
 2. IT IS INTENDED A COVER CROP BE PLANTED IN ALL DISTURBED AREAS WHEN THE CALENDAR IS OUTSIDE OF THE NATIVE SEEDING DATES. THIS INCLUDES ALL NATIVE SEEDING AREAS (COST FOR COVER CROP WITHIN NATIVE SEEDING AREAS SHALL BE SUBSIDIARY TO NATIVE SEED ITEMS), REFER TO EROSION CONTROL & SEEDING PLAN NOTES.
- SEEDING METHOD:
3. SEED PLACEMENT IS IMPORTANT AND SHOULD BE PLANTED NO MORE THAN 1/4" DEEP. TO ENSURE ACCURATE PLACEMENT OF SEED IT IS PREFERRED THAT SEED IS PLACED WITH A 'SEED DRILL' OR 'NO-TILL DRILL'. WHEN THIS METHOD IS NOT PRACTICAL THE SEED BED CAN BE PREPARED WITH A CULTIPACKER THEN BROADCAST SEED AND ROLL AGAIN. NOTE: A CULTIPACKER IS A SEGMENTED ROLLER THAT PREPARES THE SEEDBED THEN SLIGHTLY COMPACT THE SOIL AFTER SEEDING.
- SEEDING RATES:
4. ALL SEED SHOULD BE PLACED AT A UNIFORM RATE OVER THE DELINEATED AREA AT THE SPECIFIED SEEDING RATE ACCORDING TO THE DIRECTIONS OF THE SEED SUPPLIER (A.E.S. OR APPROVED EQUAL).
- SEEDING DATES:
5. PLANT SEED BETWEEN MARCH 25TH AND APRIL 10TH (PREFERRED) BETWEEN FEBRUARY 15TH AND MAY 1ST (ACCEPTABLE); OR AS APPROVED BY THE LANDSCAPE ARCHITECT THROUGH COORDINATION WITH THE CONTRACTOR.
- FERTILIZING:
6. GENERALLY FERTILIZING IS NOT REQUIRED OR RECOMMENDED FOR NATIVE GRASS OR WILDFLOWER ESTABLISHMENT AS IT WOULD PROMOTE WEED GROWTH. IN THIS INSTANCE HOWEVER, ALL WEEDS SHOULD BE KILLED PRIOR TO PLANTING. THE ONE TIME APPLICATION OF A GRANULAR FERTILIZER IS RECOMMENDED DURING ESTABLISHMENT.
- WATERING (BY OTHERS):
7. DURING THE ESTABLISHMENT PHASE, SUPPLEMENTAL WATERING (ONCE A WEEK) FOR 4 TO 6 WEEKS MAY BE REQUIRED TO ENSURE SEED GERMINATION; THEN GRADUALLY REDUCE WATERING. A TEMPORARY IRRIGATION SYSTEM SHALL BE UTILIZED FOR INITIAL PLANT ESTABLISHMENT IF NECESSARY. ADDITIONAL WATERING WILL BE REQUIRED DURING TIMES OF PROLONGED DRY WEATHER IN THE FIRST 2 - 3 GROWING SEASONS.
- MANAGEMENT DURING ESTABLISHMENT (BY OTHERS):
8. WEED CONTROL IS NECESSARY IN NEW SEEDING TO REDUCE COMPETITION FOR MOISTURE, NUTRIENTS AND SUNLIGHT. HERBICIDES ARE NOT RECOMMENDED, AS THEY WILL HARM THE WILDFLOWER STAND. IF NECESSARY, HERBICIDES MAY BE APPLIED USING A WICK APPLICATOR. MOWING DURING THE FIRST YEAR OF ESTABLISHMENT IS THE MOST APPROPRIATE METHOD TO REDUCE WEED POPULATIONS. MOWING MUST TAKE PLACE BEFORE THE WEEDY PLANTS PRODUCE SEED. WEEDS SHALL BE MOWED BEFORE THEY ARE 6" TALL; AS MUCH OF THE WEED SHOULD BE CUT AS POSSIBLE WITHOUT REMOVING TOO MUCH OF THE NEW GROWTH OF NATIVE GRASSES.
- TRASH AND DEBRIS REMOVAL:
9. THE BMP AREA SHOULD BE INSPECTED FOLLOWING MAJOR STORMS AND ON A REGULAR MONTHLY SCHEDULE. ANY TRASH OR DEBRIS SHOULD BE REMOVED AS SOON AS IT IS FOUND TO PREVENT PLANTS FROM BEING SMOTHERED. REGULARLY REMOVING TRASH AND DEBRIS WILL MAINTAIN AESTHETICS OF THE FEATURE. ALL TRASH AND DEBRIS SHOULD BE DISPOSED OF PROPERLY.
- VEGETATION (BY OTHERS):
10. REVIEW AND INSPECT VEGETATION WITHIN THE PLANTING AREA ON A MONTHLY BASIS DURING THE SPRING AND SUMMER MONTHS. INSPECTION SHOULD BE PERFORMED TO DETERMINE HEALTH AND TO IDENTIFY WEEDS AND INVASIVE SPECIES. INSPECTIONS SHOULD BE PERFORMED BY A PERSON TRAINED IN PLANT IDENTIFICATION AND CHARACTERISTICS. VEGETATION SHOULD ONLY INCLUDE PLANT SPECIES AS IDENTIFIED IN THE SEED MIX SPECIFIED. ALL OTHER PLANT SPECIES NOT IDENTIFIED IN SEED MIX ARE TO BE REMOVED DURING MAINTENANCE.
- FALL AND WINTER MANAGEMENT (BY OTHERS):
11. SEEDED AREAS SHOULD BE MOWED FOLLOWING A HARD FREEZE AND AFTER PLANTS HAVE ESTABLISHED SEEDS. IF MOWING IS USED IT SHOULD BE A TWO STEP PROCESS. MOW SITE AND THEN REMOVE TOP GROWTH. TOP GROWTH MAY BE REMOVED BY RAKING, BALING OR MOWING WITH A BAGGER BUT A LAWN VACUUM SHOULD NOT BE USED.
- SATISFACTORY NATIVE STAND:
12. WITHIN ONE FULL GROWING SEASON AND AT THE END OF THE MAINTENANCE PERIOD, A HEALTHY, WELL-ROOTED, VIABLE NATIVE STAND SHALL BE ESTABLISHED, FREE OF BARE AREAS GREATER THAN TWO SQUARE FEET IN SIZE AND FREE OF BROADER AREAS FAILING TO ACHIEVE 85% DESIRABLE PLANT COVERAGE.
13. REESTABLISH NATIVE STANDS THAT DO NOT COMPLY WITH REQUIREMENTS AND CONTINUE MAINTENANCE UNTIL NATIVE STANDS ARE SATISFACTORY.



PAVING & INCIDENTAL DRAINAGE FOR
AUBURN LAKES ADDITION
 PHASE 2

©2019
 MKEC Engineering
 All Rights Reserved
 www.mkec.com
 These drawings and their contents, including, but not limited to, all concepts, designs, & ideas are the exclusive property of MKEC Engineering (MKEC), and may not be used or reproduced in any way without the express consent of MKEC.

EROSION CONTROL PLAN

PROJECT NO.	472-85328	
DATE	JULY 2019	
SCALE	1" = 50'	
DESIGNED	DRAWN	CHECKED
DFL	RWB	GJA
NO.	REVISION	DATE