

N 1671701.54 E 1654943.99
 STA. 0+00.00, Line 29 =
 STA. 0+68.10 SCOTT, 25.00' RT.
 CONNECT TO EXIST. 8" MAIN
 * 1-8" TAPPING VALVE
 * 1-8"X8" TAPPING SLEEVE
 ** 1-6" VALVE BOX ASS'Y.
 VALVE BOX ELEV. 1283.45
 * SUPPLIED AND INSTALLED BY
 CITY OF WICHITA WATER DEPT.
 ** SUPPLIED BY C.O.W.
 INSTALLED BY CONTRACTOR

N 1671712.97E 1655483.77
 STA. 5+40.30, Line 29 =
 STA. 2+06.27, Line 31 =
 STA. 6+08.00, SCOTT, 23.04 RT.
 CONNECT TO LINE 31
 SEE SHEET 30

N 1671710.93 E 1655479.20
 STA. 5+35.30, Line 29 =
 STA. 6+03.40 SCOTT, 25.00' RT.
 1-8" MJ BEND 22.5'
 (DEFLECT 23' 7')

Contractor to coordinate with Westar to support pole during construction.

Replace Wheel Chair Ramp

Existing Gravel to be Removed and Replaced as necessary for construction. No additional pay shall be made for this work, Subsidiary to other pay items.

Existing Pavement, Curb and Gutter to be Removed and Replaced as necessary for construction. No additional pay shall be made for this work, Subsidiary to other pay items.

WATER METER SUMMARY				
BL Station	Lt./Rt.	Service (Long or Short)	Address	As Built
2+22	Lt.	Long	1704 E SCOTT	
2+55	Rt.	Short	1707 E SCOTT	
3+11	Rt.	Short	1713 E SCOTT	
3+34	Lt.	Long	1716 E SCOTT	
3+66	Rt.	Short	1719 E SCOTT	

WATER METER SUMMARY				
BL Station	Lt./Rt.	Service (Long or Short)	Address	As Built
4+21	Rt.	Short	1725 E SCOTT	
4+75	Rt.	Short	1731 E SCOTT	
5+05	Lt.	Long	1736 E SCOTT	
5+31	Rt.	Short	1737 E SCOTT	
5+86	Rt.	Short	1741 E SCOTT	



GARVER
 624 N. MAIN
 WICHITA, KS 67203
 316.264.8000
 WWW.GARVERUSA.COM

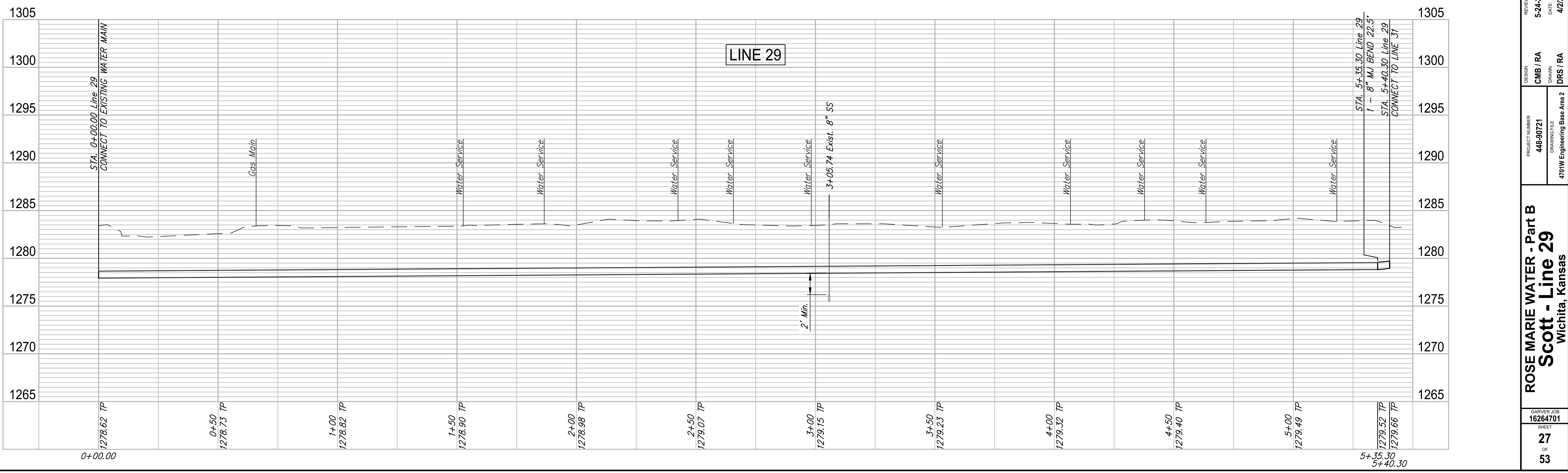

REVIEW: 5-24-2017
 DATE: 4/2/2018
 DESIGN: CMB / RA
 DRAWN: DRS / RA

ROSE MARIE WATER - Part B
 Scott - Line 29
 Wichita, Kansas
 PROJECT NUMBER: 448-30721
 DRAWING FILE: 4701W Engineering Base Area 2
 GARVER JOB: 16264701
 SHEET: 27 OF 53
 © Copyright 2018, Garver