

J:\PROJECTS\2018\1801010316_COW_DOUGLAS ST. BRIDGE AT BROOKSIDE\1801010316_CAD\SHOTS\06_CIVIL\PAV1816 CONT MAP.DWG
 PLOTTED: Friday, July 26, 2019 @ 09:31AM

CONTROL POINT #219
 1. CP / EIBC #5 MKEC
 2. STA. 10+21.41 27.78' LT.
 3. N 1686257.57 E 1668581.85
 4. ELEV. 1353.65

CONTROL POINT #306
 1. CP / IBSC #306 EL=1352.65
 2. STA. 10+82.67 96.98' RT.
 3. N 1686133.55 E 1668644.58
 4. ELEV. 1352.65

BENCHMARK POINT
 1. BM #10 / COW BRASS DISK 1353.865
 2. STA. 10+13.49 38.80' LT.
 3. N 1686268.5 E 1668573.8
 4. ELEV. 1353.87

DRAINAGE DATA

Drainage Area -----	1.1 Sq. Mi.
Design Frequency -----	100 Years
Design Discharge -----	830 cfs
Design High Water Elevation -----	1352.41
Overtopping Elevation -----	1353.52
Overtopping Discharge -----	1000 cfs
Overtopping Frequency -----	>500 Years
Historic High Water Elevation -----	Unknown
Estimated Ordinary High Water Discharge -----	830.0 cfs
Estimated Ordinary High Water Elevation -----	1352.73



**CONSTRUCTION PLANS FOR
 DOUGLAS STREET BRIDGE AT BROOKSIDE
 WICHITA, KS**

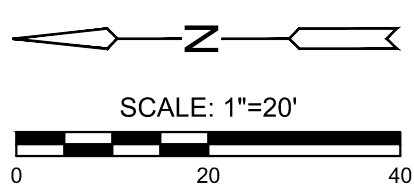
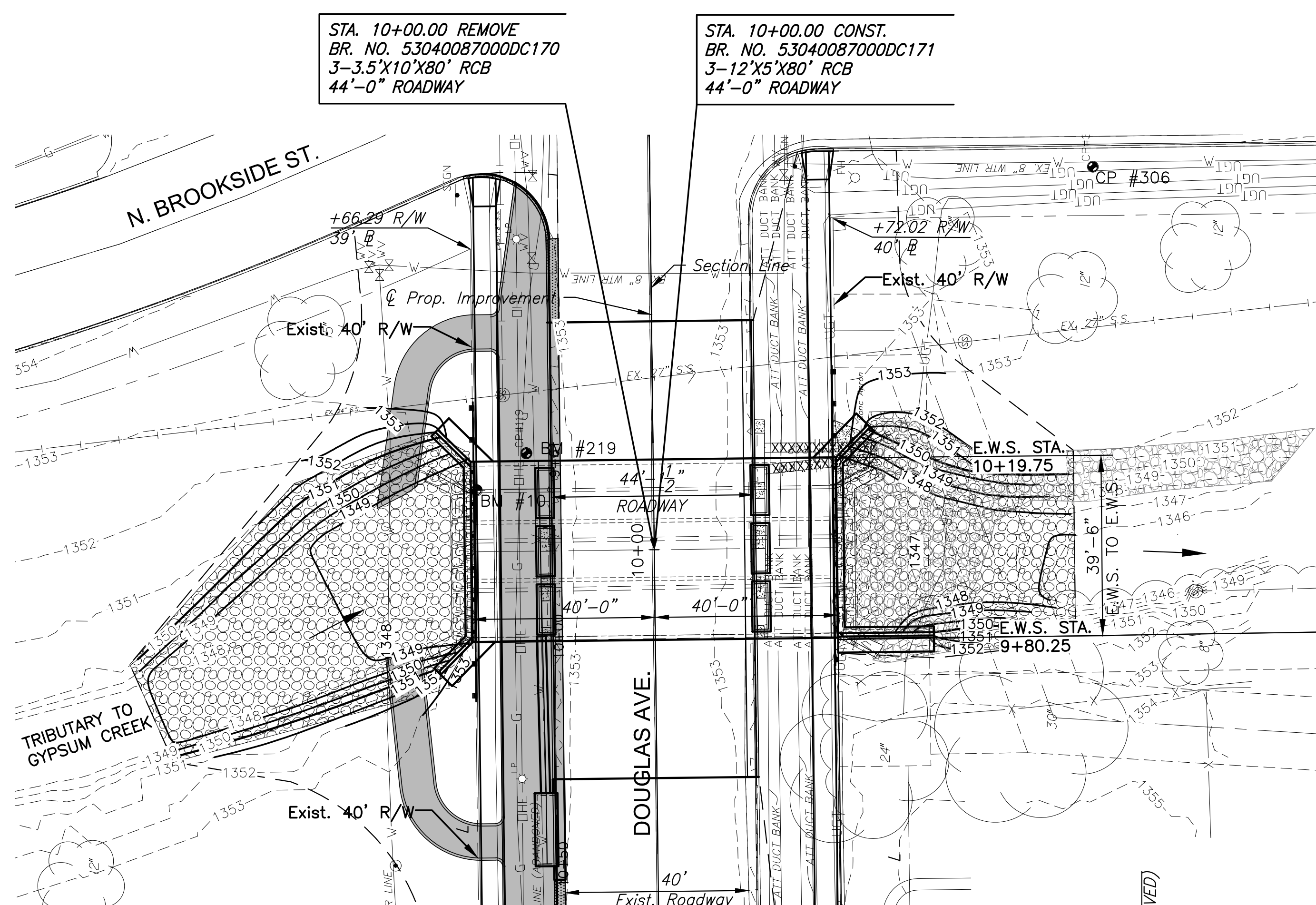

REMOVAL OF EXISTING STRUCTURE: The Contractor shall remove the existing concrete RFB and wings. All materials shall become the property of the Contractor and shall be removed from the project site by the Contractor.

DESIGN SPECIFICATIONS:
 AASHTO LRFD Bridge Design Specifications, 8th Edition

LOADING: HL93

UNIT STRESSES: Grade 4.0 Concrete: $f'_c = 4,000$ p.s.i.
 Reinforcing Steel: $f_y = 60,000$ p.s.i.

NOTES:

1. Cast-In-Place and Pre-Cast construction allowed. End Sections shall be Cast-In-Place only in accordance with these plans.
2. Structure will require special hubguard and wingwalls. See Sheets 19-21.
3. Backfill at outside barrel walls shall be placed in lifts not exceeding 0'-6" and the difference in elevation of the two backfilling operations shall not exceed 1'-0".
4. It is the responsibility of the Contractor to provide Temporary Shoring Plans bearing the seal of a licensed Professional Engineer in the state of Kansas.

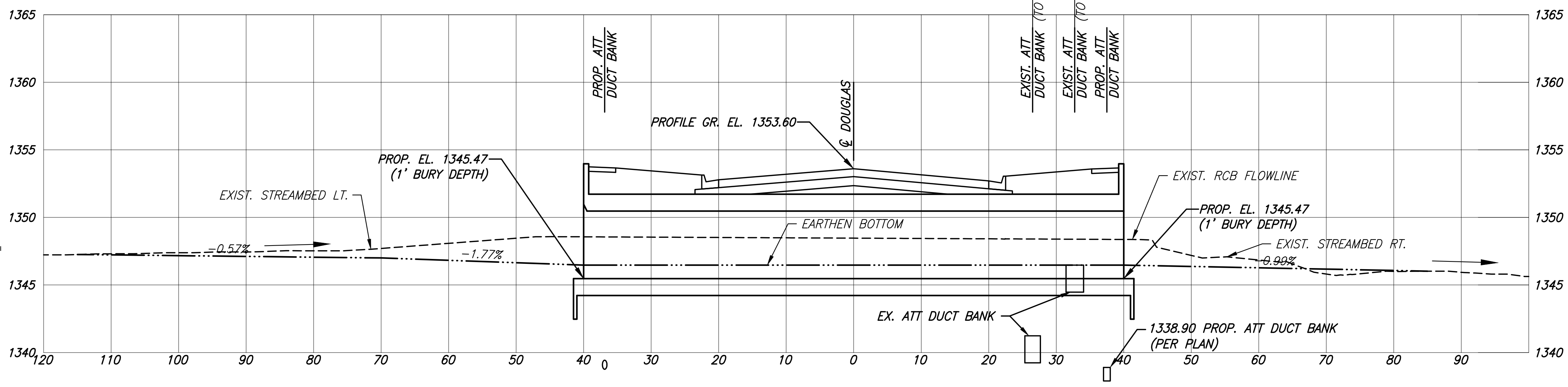

Rating	Inventory	Operating
Design Load		
HL-93 Loading	1.18	1.53

2017 Manual for Bridge Evaluation

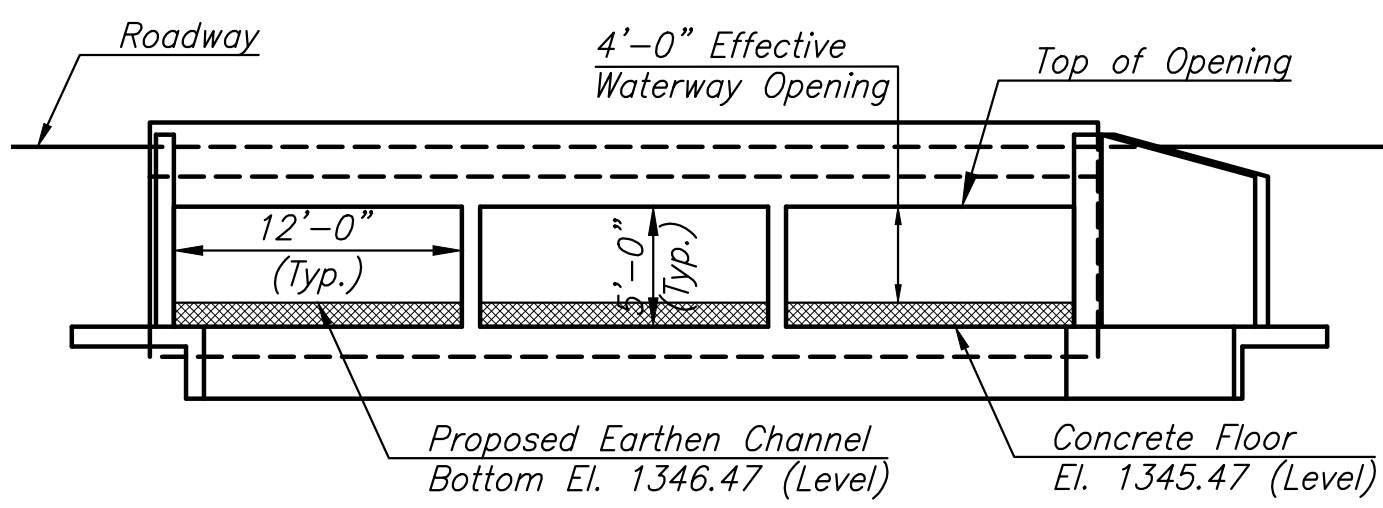

PROPOSED RCBC WATERWAY OPENING
 Note: Bottom of RCB will be buried 1' below the proposed stream channel bottom as required by the Kansas Department of Wildlife, Parks and Tourism.

©2019 MKEC Engineering All Rights Reserved
 These drawings and their contents, including, but not limited to, all concepts, designs, & ideas are the exclusive property of MKEC Engineering (MKEC), and may not be used or reproduced in any way without the express consent of MKEC.

BRIDGE CONTOUR MAP

PROJECT NO.	472-85436	
DATE	JULY 2019	
SCALE	1"=20'	
DESIGNED	DRAWN	CHECKED
JRA	BKS	JRA

NO.	REVISION	DATE
-----	----------	------

SHEET NO.