

EROSION CONTROL MEASURE	INSTALL	MAINTAIN	REMOVE
BACK OF CURB PROTECTION (LF)	1,894	0	0
CONSTRUCTION ENTRANCE (EA)	0	1	0
CURB INLET BARRIER (EA)	2	0	0
DITCH CHECK (EA)	0	11	0
DROP INLET PROTECTION (EA)	0	4	0
EROSION CONTROL (LS)	0	0	0
EROSION CONTROL BERM (LF)	0	0	0
SILT FENCE (LF)	0	615	0
EROSION CONTROL MAT (SY)	0	0	0

QUANTITIES ARE FOR INFORMATION ONLY! CONTRACTOR SHALL VERIFY QUANTITIES PER FINAL BID QUANTITY SHEET.

* ALL EXISTING BMPs INCLUDING CONSTRUCTION ENTRANCE, SEDIMENT BARRIERS, SILT FENCE, EROSION CONTROL BERM, AND EROSION CONTROL MAT SHALL BE MAINTAINED AND REPAIRED IF NECESSARY. REPLACEMENT OR REMOVAL OF EROSION CONTROL MEASURES TO BE PAID FOR BY L.S. BID ITEM "MAINTAIN EXISTING EROSION CONTROL BMPs"

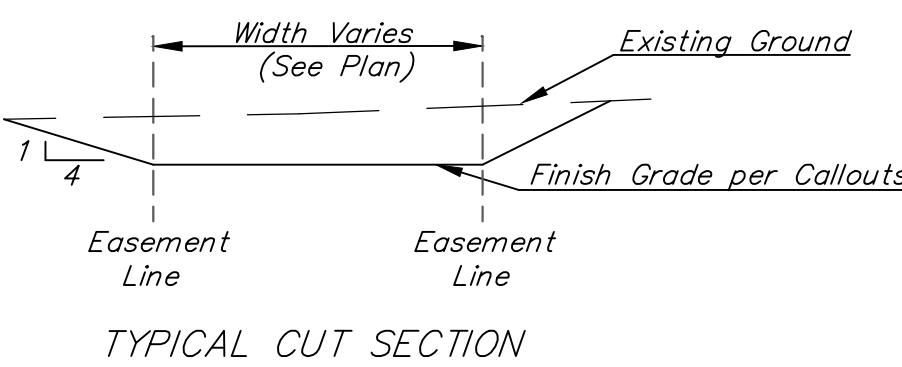
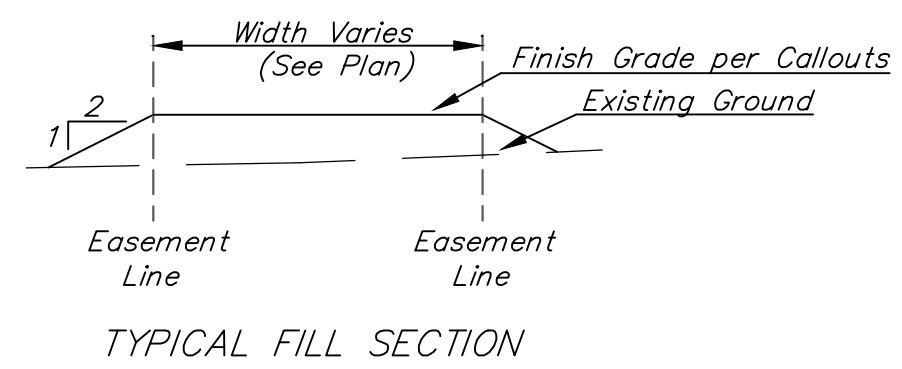

SECTION A-A

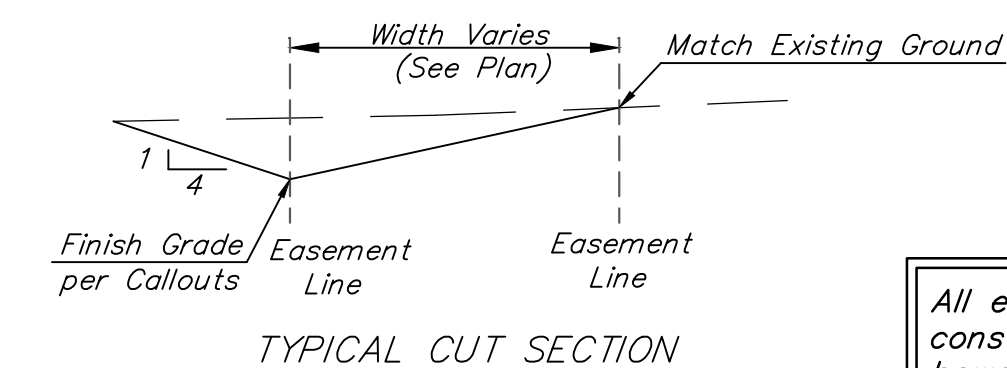
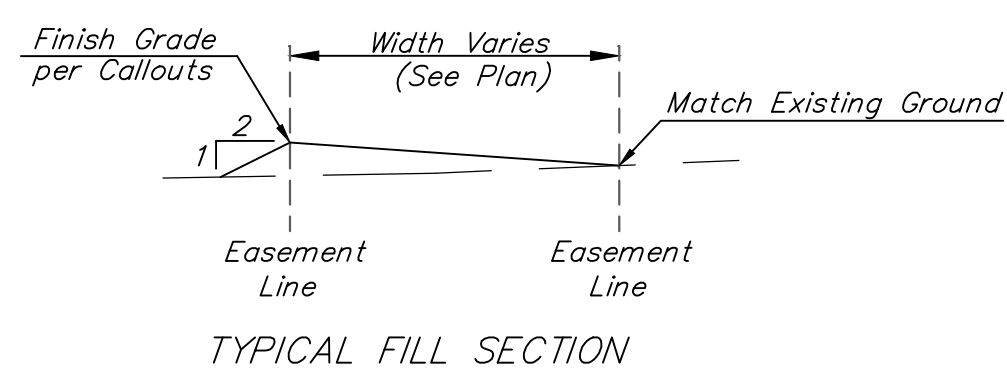

SECTION B-B

All easements have been graded prior to construction with the mass grading plan, however, all easements shall be fine graded with this project after street & sws construction has been completed. All cost associated with the fine grading shall be included in the lump sum bid item "Easement Grading".

= Easements To Be Graded

The contractor shall grade the easements as shown to the elevations given on the easement grading plan. All costs for grading shall be incidental to the Easement Grading Bid Item.

The contractor shall 'straight' grade the easements between the elevations given. Where a callout designates 'Match', the contractor will grade to the existing ground elevation.

Maintain drop inlet sediment barriers per detail, sheet 11.

Maintain ditch check sediment barriers per detail, sheet 11.

Maintain 50'x12' gravel construction entrance per detail, sheet 9.

Maintain ditch check sediment barriers per detail, sheet 11.

Install back-of-curb protection both sides per detail, sheet 9.

Maintain ditch check sediment barriers per detail, sheet 11.

Install curb inlet sediment barriers per detail, sheet 9.

Install back of curb protection per detail, sheet 9.

Maintain ditch check sediment barriers per detail, sheet 11.

Install curb inlet sediment barriers per detail, sheet 9.

Maintain ditch check sediment barriers per detail, sheet 11.

Maintain ditch check sediment barriers per detail, sheet 11.

Maintain drop inlet sediment barrier per detail, sheet 11.

WICHITA, K

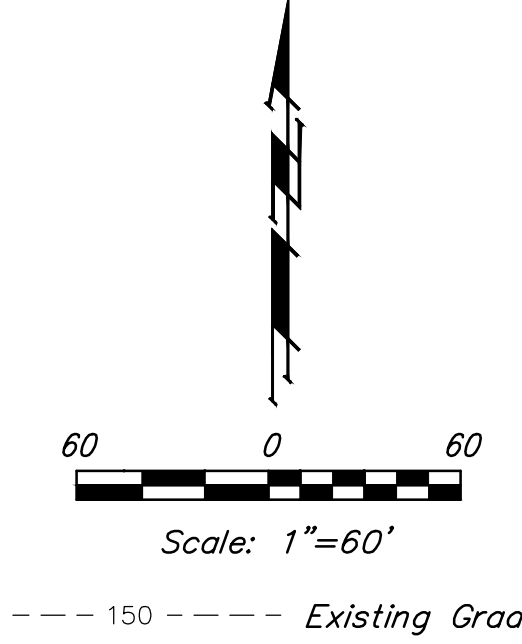
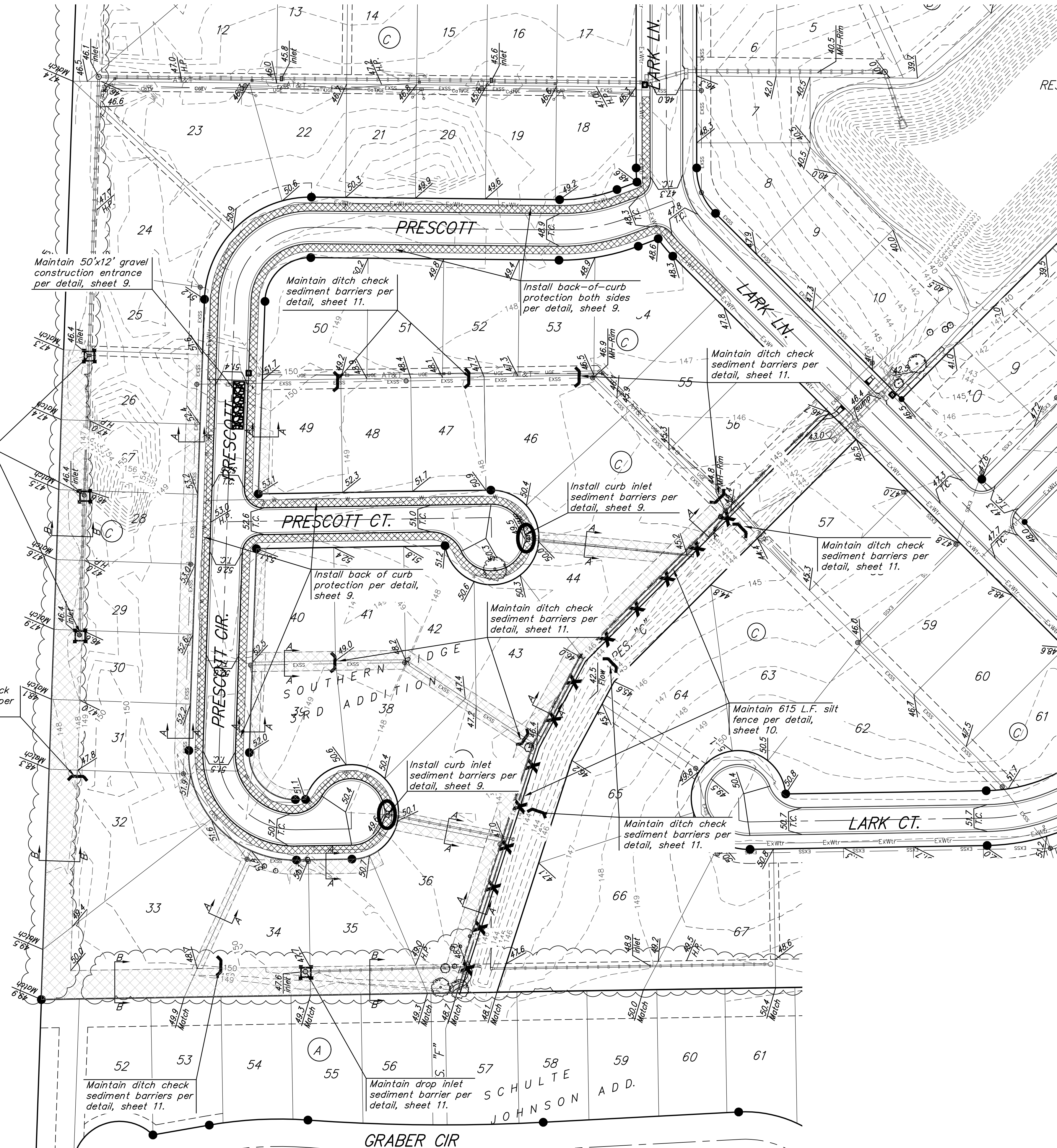

EROSION CONTROL PLAN LEGEND

- DROP INLET PROTECTION
- CURB INLET PROTECTION
- DITCH CHECKS
- SILT FENCING
- STRAW WATTLE FENCING
- EROSION CONTROL BERM
- BACK OF CURB PROTECTION
- EROSION CONTROL MAT
- TEMPORARY DITCH

Site has been graded with SWD project prior to street construction.

SOUTHERN RIDGE 3RD ADD. PH. 5C & 6
ESMT. GRADING & EROSION CONTROL PLAN
 STREET IMPROVEMENTS
 Baughman Company, P.A.
 ENGINEERING & PLANNING ARCHITECTURE
 1000 W. 10TH ST. SUITE 200
 WICHITA, KS 67203
 DATE: 10/19/19