

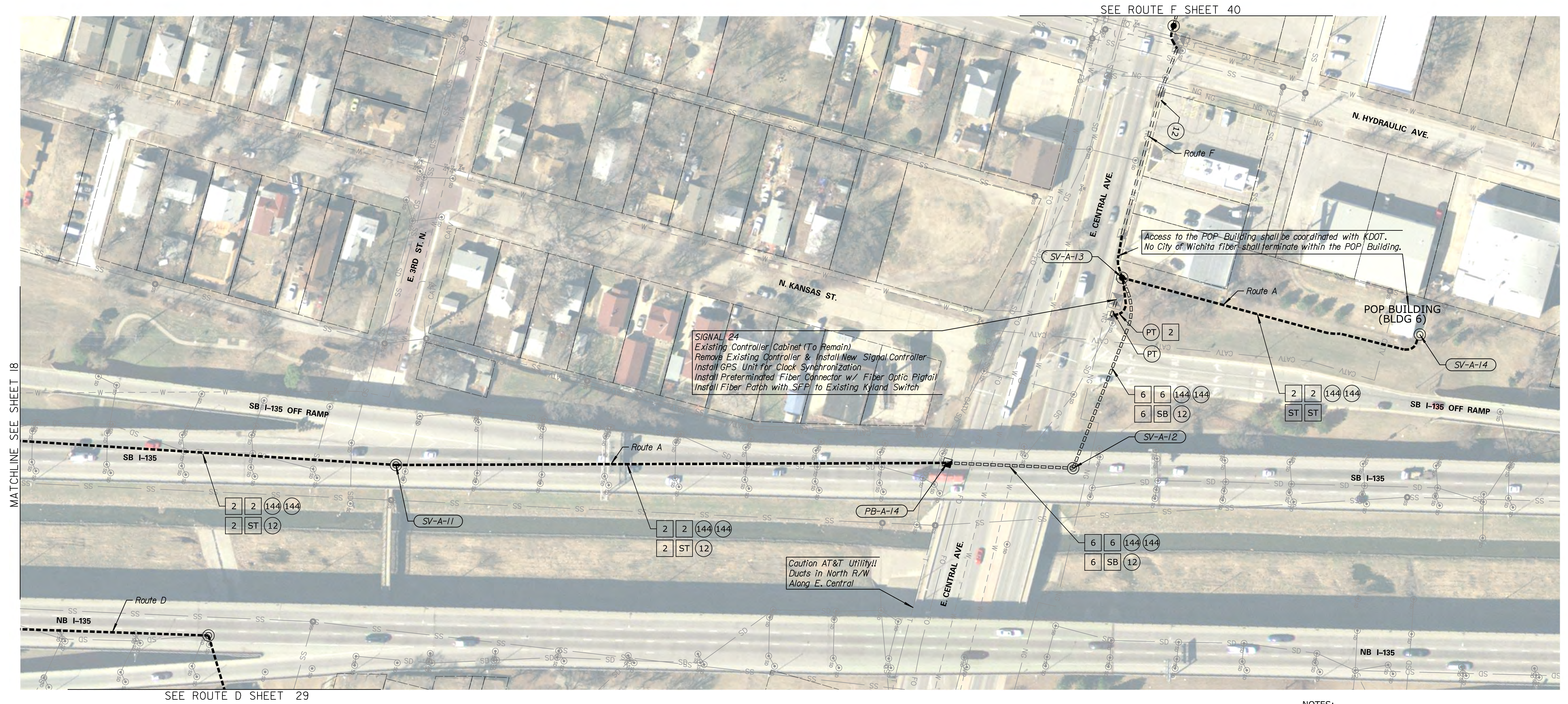

| STATE | PROJECT NO. | YEAR | SHEET NO. | TOTAL SHEETS |
|--------|--------------|------|-----------|--------------|
| KANSAS | 87 N-0684-01 | 2019 | 19 | 109 |

| DATE | BY |
|------|----|
| | |

| REFERENCES NOTED | REFERENCES CHECKED |
|------------------|--------------------|
| | |



SIGNAL 24
 Existing Controller Cabinet (To Remain)
 Remove Existing Controller & Install New Signal Controller
 Install GPS Unit for Clock Synchronization
 Install Preterminated Fiber Connector w/ Fiber Optic Pigtail
 Install Fiber Patch with SFP to Existing Kyland Switch

Access to the POP Building shall be coordinated with KDOT.
 No City of Wichita fiber shall terminate within the POP Building.

Caution AT&T Utility!!
 Ducts in North R/W
 Along E. Central

MATCHLINE SEE SHEET 18

SEE ROUTE D SHEET 29

SEE ROUTE F SHEET 40

NOTES:
 DEVICE & CONDUIT SYMBOLY ON PLAN SHEET IS NOT SHOWN TO SCALE FOR PLAN CLARITY. DO NOT SCALE LOCATIONS FROM PLAN SHEET. EXISTING UTILITIES & STRUCTURES ON PLAN SHEET MAY DIFFER FROM FIELD CONDITIONS & SHALL BE VERIFIED PRIOR TO ANY EXCAVATION OR CONSTRUCTION ACTIVITIES.

FOR FIBER SCHEMATIC & SPLICING DETAILS, SEE SHEETS 52-64

KANSAS DEPARTMENT OF TRANSPORTATION
 FIBER OPTIC CONDUIT
 ROUTE A

Drawn By : Road
 Plotted : 7/23/2019
 File : c:\transystems\pw_local\transcorp-pw\ccbankid0643930\C-FBR-M0A-112.dgn