

| STATE | PROJECT NO. | YEAR | SHEET NO. | TOTAL SHEETS |
|--------|--------------|------|-----------|--------------|
| KANSAS | 87 N-0684-01 | 2019 | 35 | 109 |

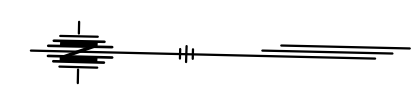

| DATE | BY |
|------|----|
| | |
| | |

| REFERENCES NOTED | REFERENCES CHECKED |
|------------------|--------------------|
| | |
| | |

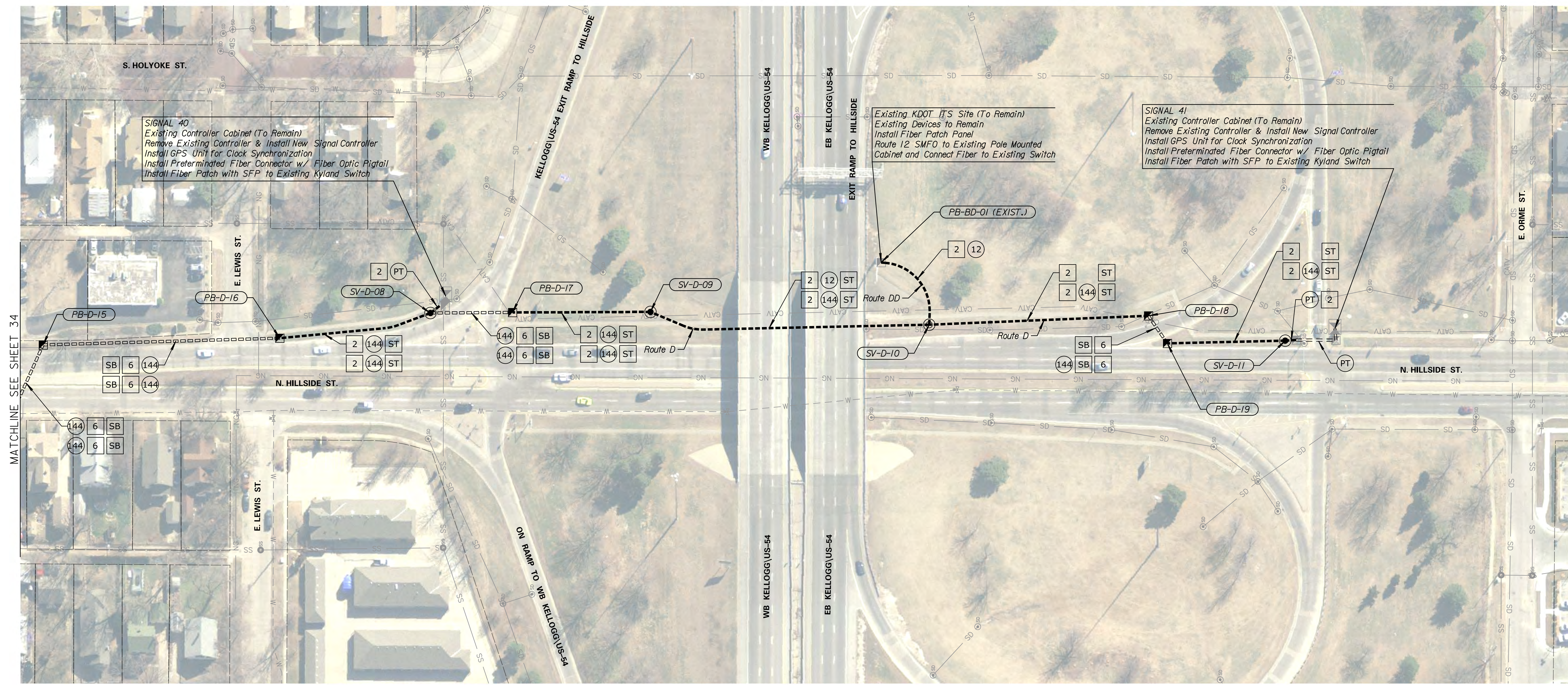

MATCHLINE SEE SHEET 34

SIGNAL 40
 Existing Controller Cabinet (To Remain)
 Remove Existing Controller & Install New Signal Controller
 Install GPS Unit for Clock Synchronization
 Install Preterminated Fiber Connector w/ Fiber Optic Pigtail
 Install Fiber Patch with SFP to Existing Kyland Switch

Existing KDOT ITS Site (To Remain)
 Existing Devices to Remain
 Install Fiber Patch Panel
 Route 12 SMFO to Existing Pole Mounted Cabinet and Connect Fiber to Existing Switch

SIGNAL 41
 Existing Controller Cabinet (To Remain)
 Remove Existing Controller & Install New Signal Controller
 Install GPS Unit for Clock Synchronization
 Install Preterminated Fiber Connector w/ Fiber Optic Pigtail
 Install Fiber Patch with SFP to Existing Kyland Switch

NOTES:
 DEVICE & CONDUIT SYMBOLY ON PLAN SHEET IS NOT SHOWN TO SCALE FOR PLAN CLARITY. DO NOT SCALE LOCATIONS FROM PLAN SHEET. EXISTING UTILITIES & STRUCTURES ON PLAN SHEET MAY DIFFER FROM FIELD CONDITIONS & SHALL BE VERIFIED PRIOR TO ANY EXCAVATION OR CONSTRUCTION ACTIVITIES.

FOR FIBER SCHEMATIC & SPLICING DETAILS, SEE SHEETS 52-64

KANSAS DEPARTMENT OF TRANSPORTATION
 FIBER OPTIC CONDUIT
 ROUTES D & DD

Drawn By : Road
 File : c:\transystems\pw_local\transyscorp-pw\ccbankid0643930\C-FBR-MOD-107.dgn
 Plotted : 7/23/2019