

**HARRY STREET BRIDGE
OVER ARKANSAS RIVER**
**SIDEWALK B
STA. 199+00 TO STA. 201+25**

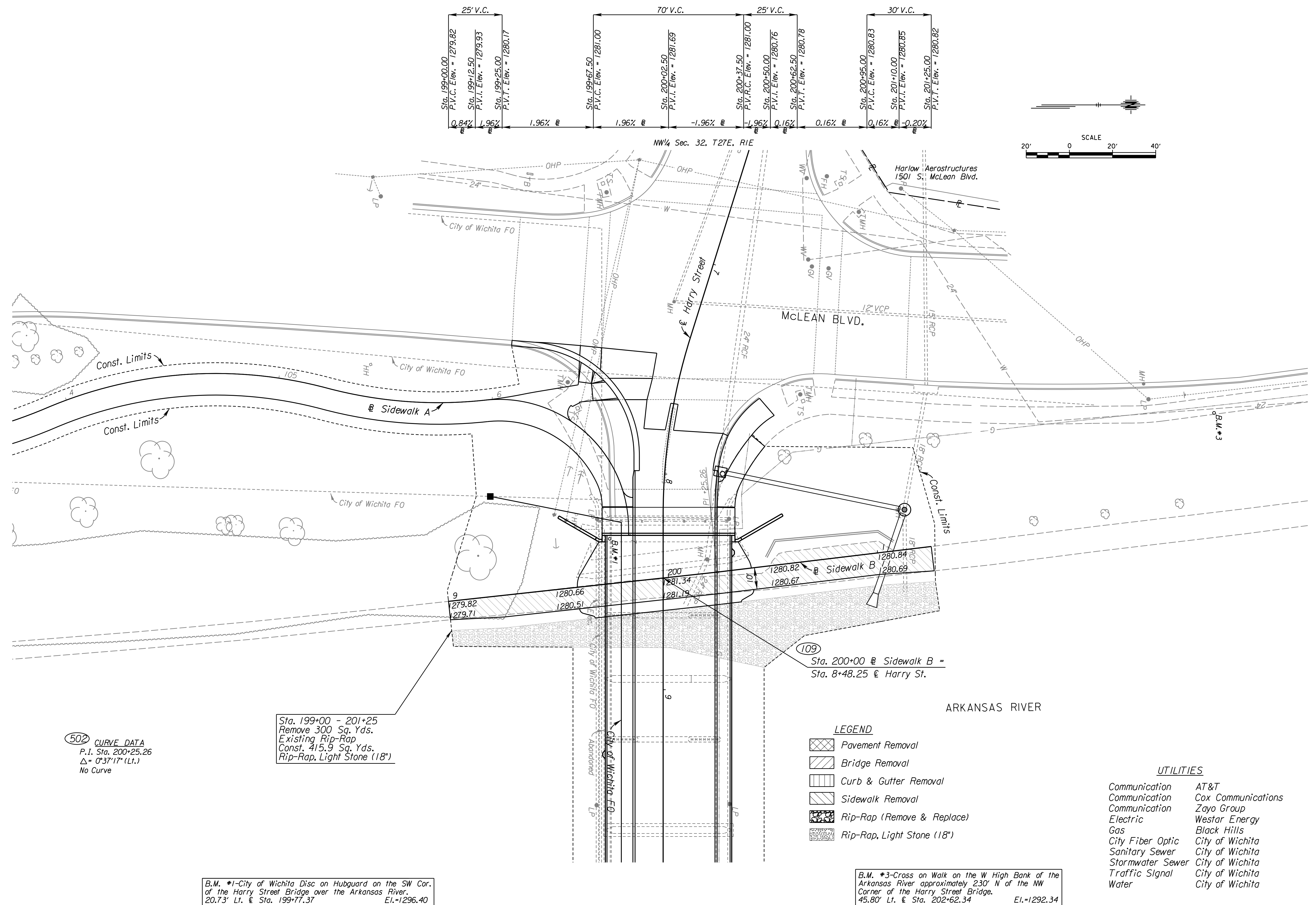

25' V.C.	70' V.C.	25' V.C.	30' V.C.
Sta. 199+00.00 P.V.C. Elev. = 1279.82	Sta. 199+67.50 P.V.C. Elev. = 1281.00	Sta. 200+37.50 P.V.C. Elev. = 1281.00	Sta. 200+95.00 P.V.C. Elev. = 1280.83
Sta. 199+12.50 P.V.I. Elev. = 1279.93	Sta. 200+02.50 P.V.I. Elev. = 1281.69	Sta. 200+50.00 P.V.I. Elev. = 1280.76	Sta. 201+10.00 P.V.I. Elev. = 1280.85
Sta. 199+25.00 P.V.T. Elev. = 1280.17	Sta. 200+62.50 P.V.T. Elev. = 1280.78	Sta. 201+25.00 P.V.T. Elev. = 1280.82	
0.84%	1.96%	-1.96%	0.16%
1.96%	1.96%	-1.96%	-0.20%

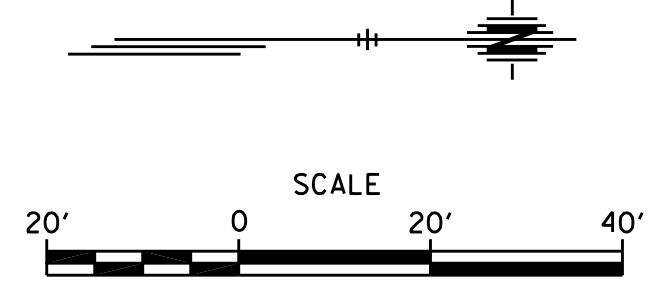

502 CURVE DATA
P.I. Sta. 200+25.26
 $\Delta = 0^{\circ}37'17''$ (Lt.)
No Curve

Sta. 199+00 - 201+25
Remove 300 Sq. Yds.
Existing Rip-Rap
Const. 415.9 Sq. Yds.
Rip-Rap, Light Stone (18")

B.M. *1-City of Wichita Disc on Hubguard on the SW Cor.
of the Harry Street Bridge over the Arkansas River.
20.73' Lt. & Sta. 199+77.37 El.=1296.40

B.M. *3-Cross on Walk on the W High Bank of the
Arkansas River approximately 230' N of the NW
Corner of the Harry Street Bridge.
45.80' Lt. & Sta. 202+62.34 El.=1292.34

- LEGEND**
- Pavement Removal
 - Bridge Removal
 - Curb & Gutter Removal
 - Sidewalk Removal
 - Rip-Rap (Remove & Replace)
 - Rip-Rap, Light Stone (18")

- UTILITIES**
- | | |
|------------------|--------------------|
| Communication | AT&T |
| Communication | Cox Communications |
| Communication | Zayo Group |
| Electric | Westar Energy |
| Gas | Black Hills |
| City Fiber Optic | City of Wichita |
| Sanitary Sewer | City of Wichita |
| Stormwater Sewer | City of Wichita |
| Traffic Signal | City of Wichita |
| Water | City of Wichita |

NO.	DATE	DESCRIPTION

PROJ NO:	35838B
SCALE:	AS NOTED
DATE:	
DESIGNED BY:	
DRAWN BY:	
CHECKED BY:	
YEAR:	2019
SHEET NO	10
SHEET	10 OF 135