

Plotted : 10/3/2019 2:11:09 PM File : T:\35838A-COW_HarryStreetBridge\Cadd\Sheets\Roadway\Details\838INT01.dgn

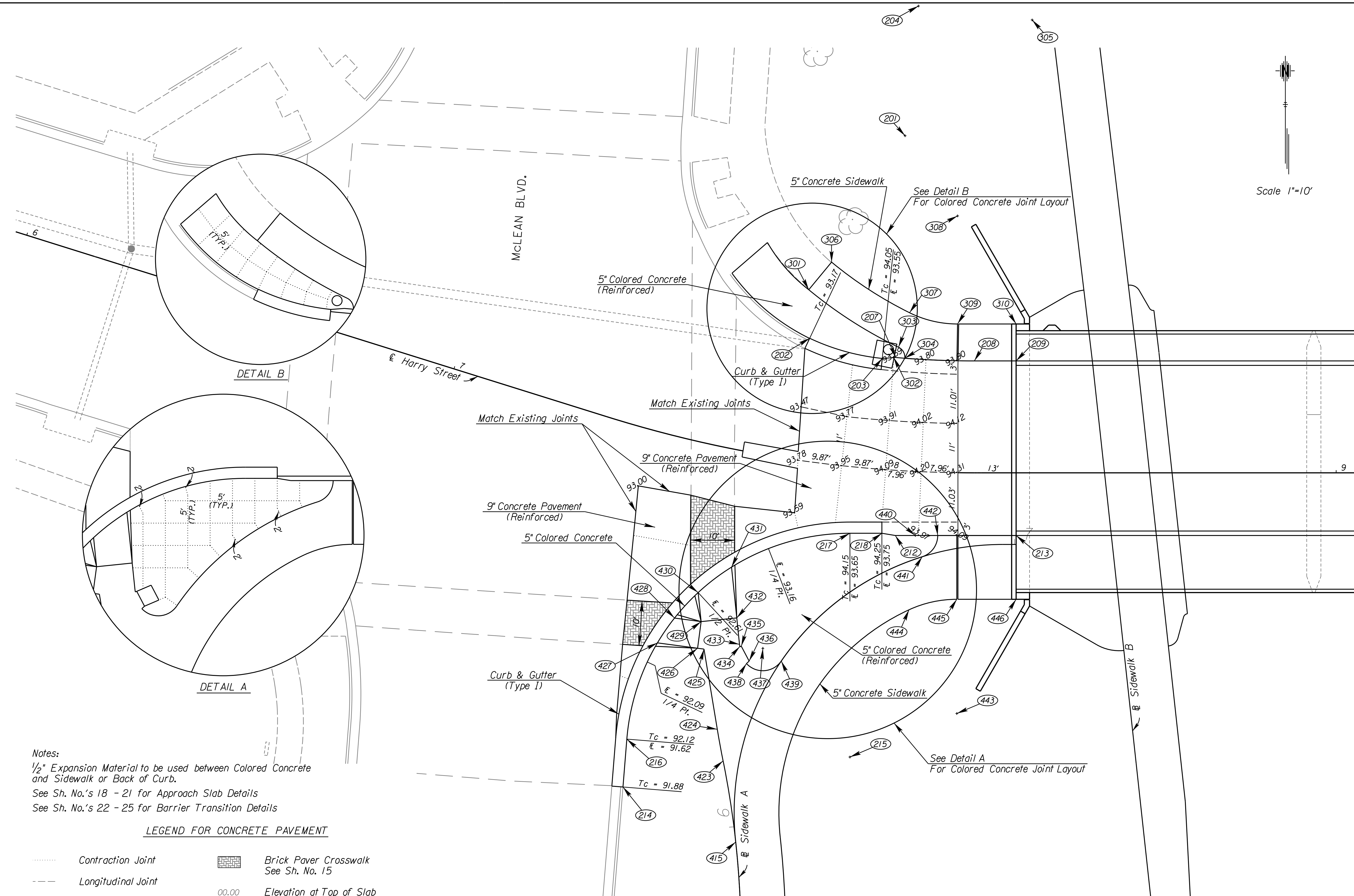

**HARRY STREET BRIDGE
OVER ARKANSAS RIVER**

PAVING PLANS HARRY STREET



Scale 1"=10'

Notes:
 1/2" Expansion Material to be used between Colored Concrete and Sidewalk or Back of Curb.
 See Sh. No.'s 18 - 21 for Approach Slab Details
 See Sh. No.'s 22 - 25 for Barrier Transition Details

LEGEND FOR CONCRETE PAVEMENT

- Contraction Joint
- Longitudinal Joint
- Brick Paver Crosswalk See Sh. No. 15
- 00.00 Elevation at Top of Slab (Add 1200 to establish true elevation based on 1988 NAVD)

NO.	DATE	DESCRIPTION

PROJ NO:	35838B
SCALE:	AS NOTED
DATE:	
DESIGNED BY:	
DRAWN BY:	
CHECKED BY:	
YEAR:	2019
SHEET NO	12
SHEET	12 OF 135