

NO.	DATE	DESCRIPTION

PROJ NO:	35838B
SCALE:	AS NOTED
DATE:	
DESIGNED BY:	
DRAWN BY:	
CHECKED BY:	
YEAR:	2019
SHEET NO	37
SHEET	37 OF 135

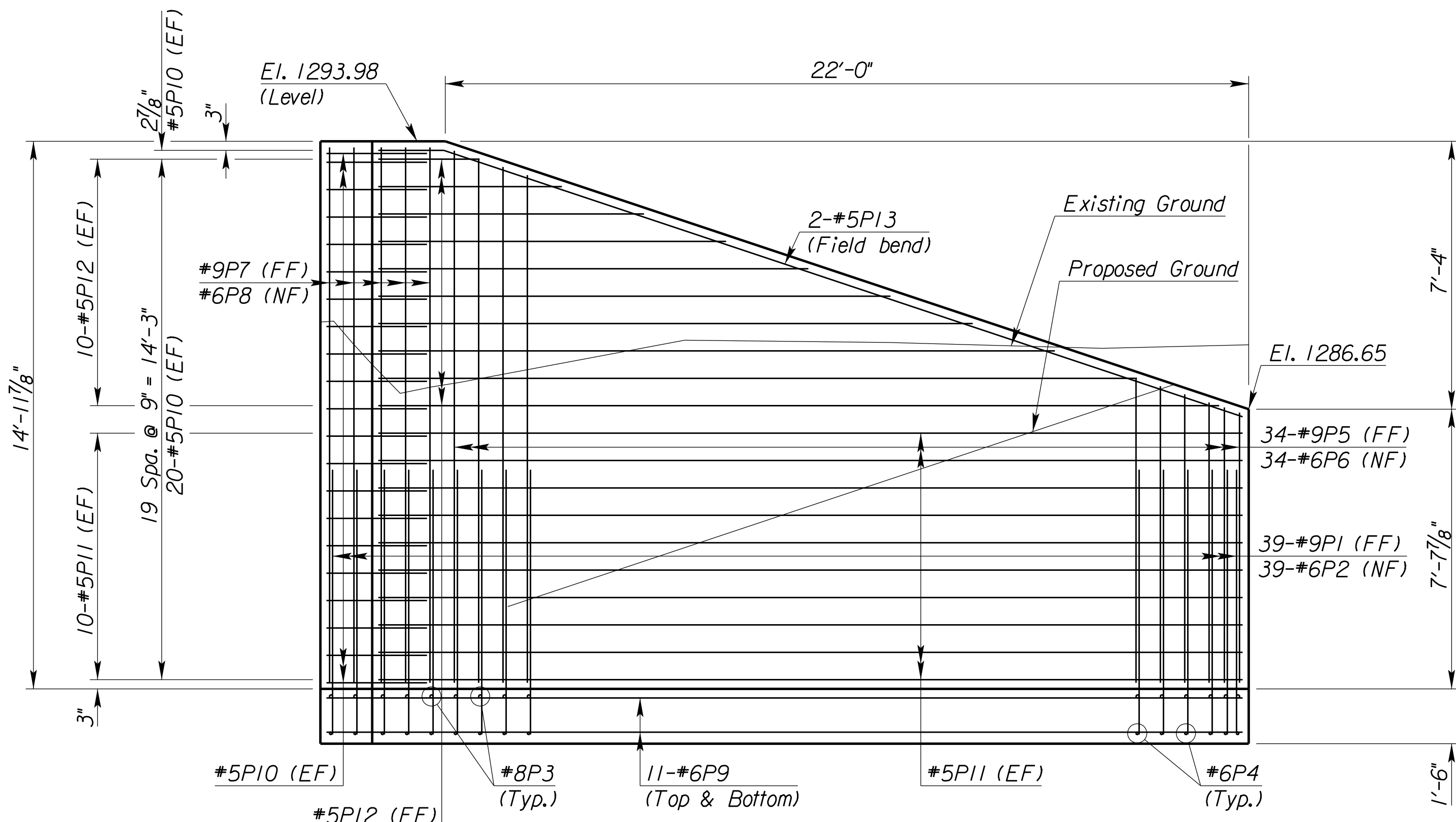

**VIEW A-A**

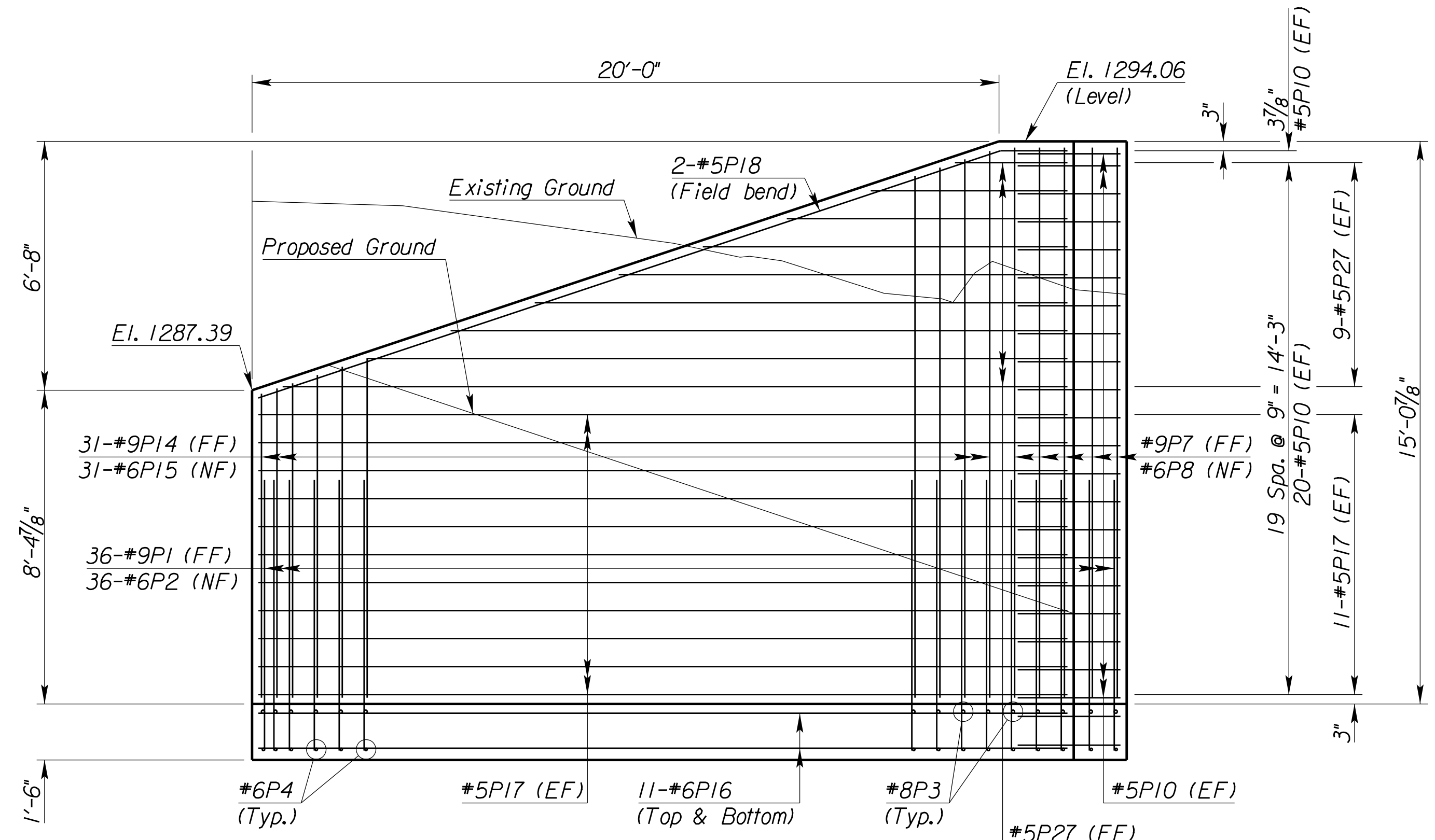

**VIEW B-B**

**NOTES:**  
 Proposed and Existing Ground lines are in front of wall.  
 1" formliner and 1'-1" wall thickness. Wall and footing dimensions remain constant at wall bend.  
 Field cut P1, P2, P3 & P4 bars as required at wall bend.

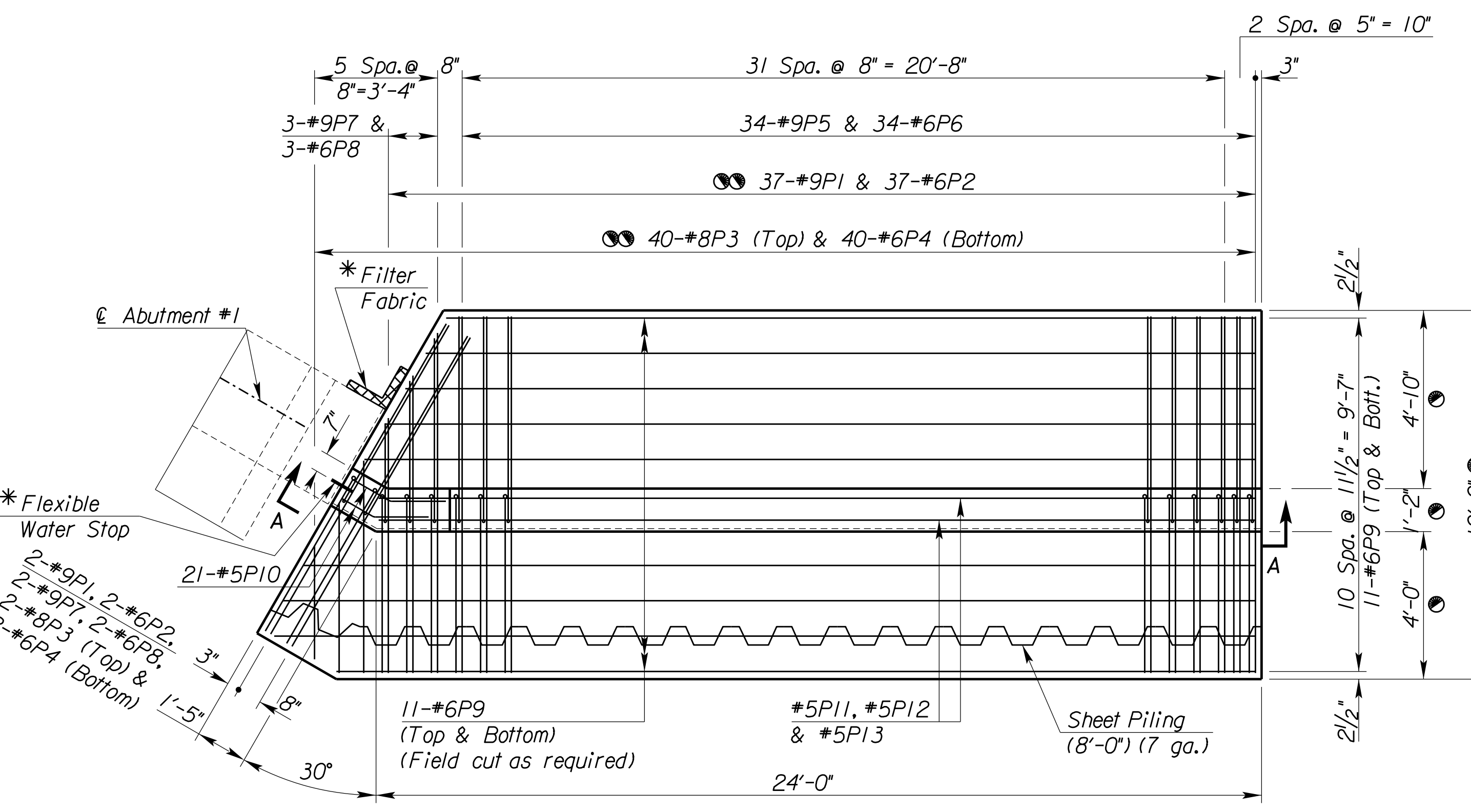

**PLAN**  
(Northwest Corner)

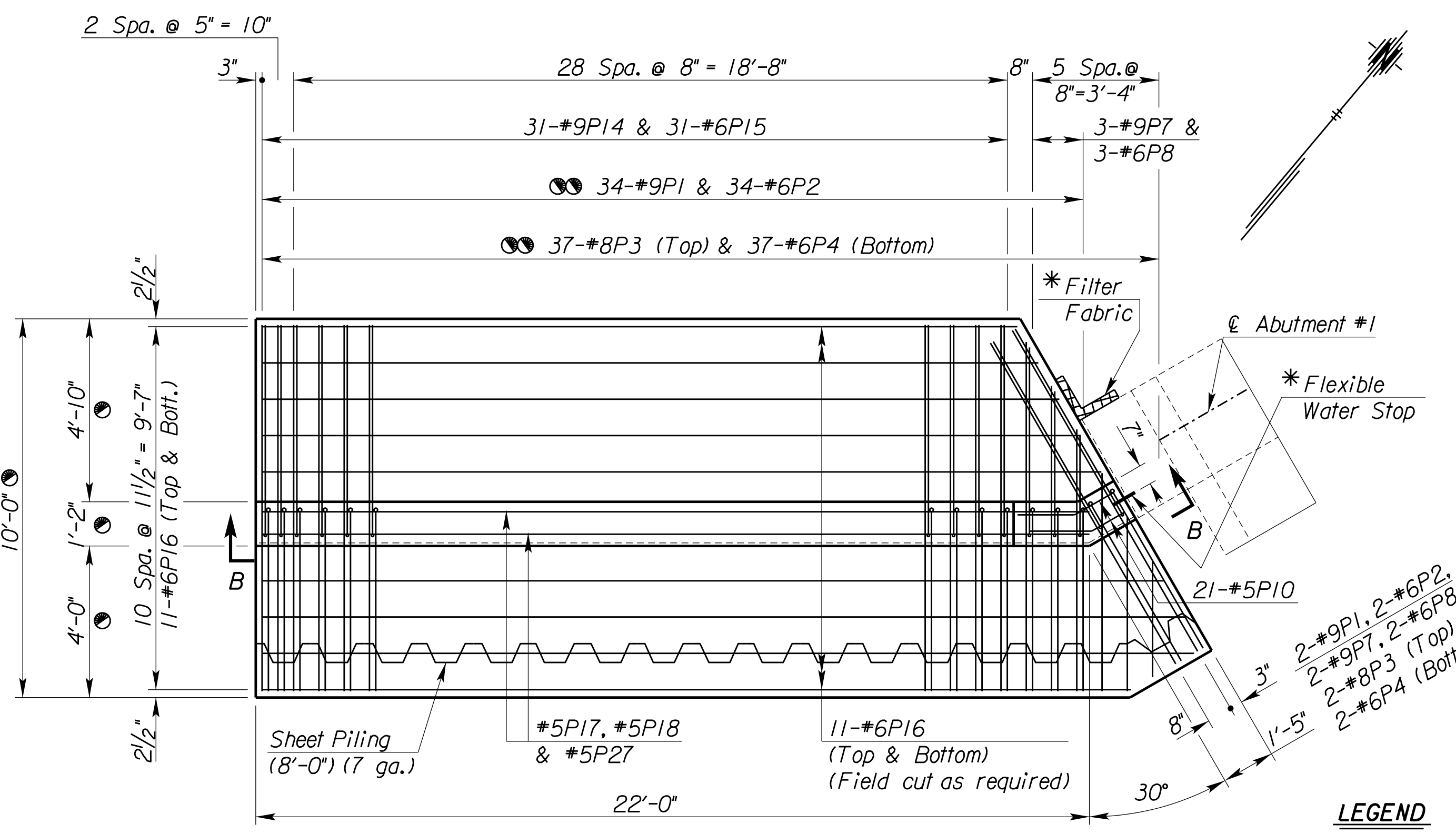

**PLAN**  
(Southwest Corner)

**LEGEND**  
 EF = Each Face  
 NF = Near Face  
 FF = Far Face

\*Flexible Water Stop & Filter Fabric shall be subsidiary to the bid item "Abutment Aggregate Drain".

Plotted: 10/3/2019 2:13:02 PM File: T:\35838A-COW\_HarryStreetBridge\Cadd\Sheets\Structures\38WALL01.dgn