

Saved 7-3-2019 1:37:06 PM by CP
 Plot Scale 1:1 7-3-2019 1:43:17 PM by CARLOS PEREZ
 U:\Wichita-Civil\2018\187042\000\Main\Trans\Drawings\187042-006-26C-WACO & THIRD TS PLAN

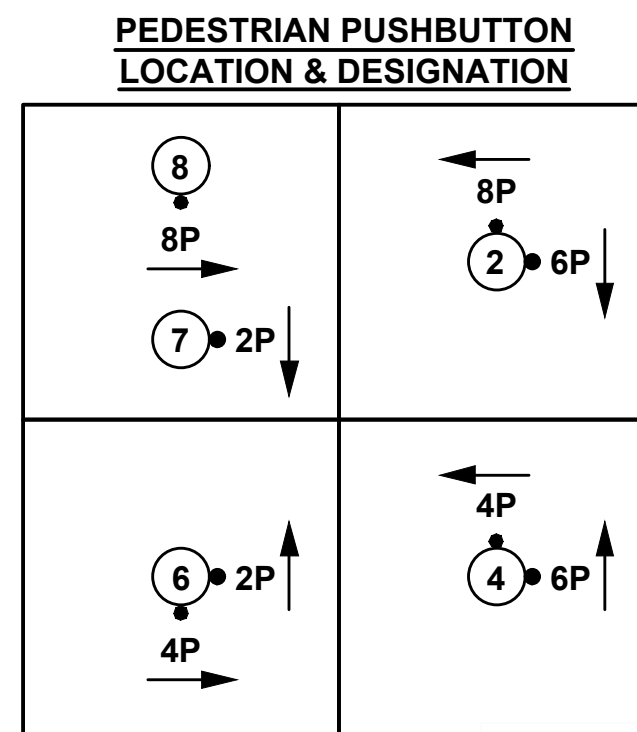
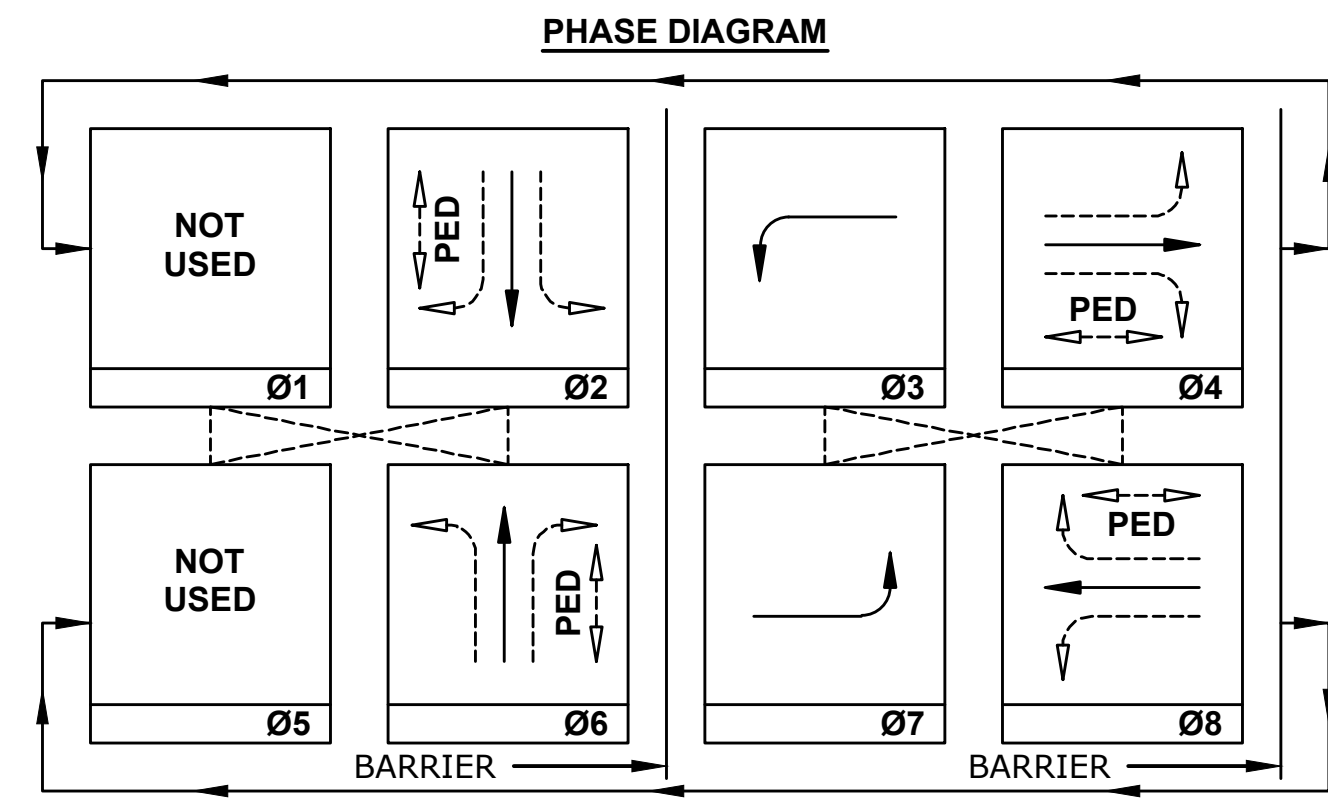

NOTE:
 DASHED LINES CONNECTING PHASES DENOTE NON-CONFLICTING SIGNAL PHASES THAT CAN OCCUR CONCURRENTLY.
MOVEMENTS
 ——— PROTECTED PHASE
 - - - PERMITTED PHASE

TRAFFIC SIGNAL CONSTRUCTION NOTES

- 1 Contractor shall install new Traffic Signal Pedestal #2 with APS Pushbutton Units. Contractor shall relocate existing Pedestrian Signal Heads #6K and #8K from existing Traffic Signal Pole #1 and relocate to new Traffic Signal Pedestal #2.
- 2 Contractor shall remove outer existing "A" Traffic Signal Head from existing Traffic Signal Pole #3. Contractor shall install new "H" Traffic Signal Head, R10-12 Sign and Blank-out R3-2 Sign on existing Traffic Signal Pole #3.
- 3 Contractor shall install new Traffic Signal Pedestal #4 with APS Pushbutton Units. Contractor shall relocate existing Pedestrian Signal Heads #4K and #6K from existing Traffic Signal Pole #3 and relocate to new Traffic Signal Pedestal #4.
- 4 Contractor shall install new Traffic Signal Pedestal #6 with APS Pushbutton Units. Contractor shall relocate existing Pedestrian Signal Heads #2K and #4K from existing Traffic Signal Pole #5 and relocate to new Traffic Signal Pedestal #6.
- 5 Contractor shall remove outer existing "A" Traffic Signal Head from existing Traffic Signal Pole #7. Contractor shall install new "H" Traffic Signal Head, R10-12 Sign, Blank-out R3-2 Sign and APS Pushbutton Unit on existing Traffic Signal Pole #7.

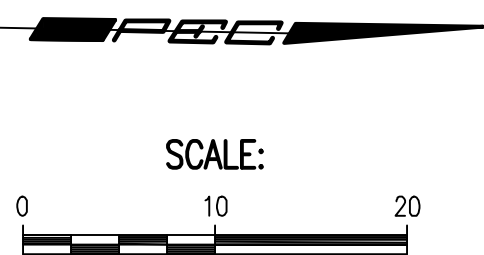
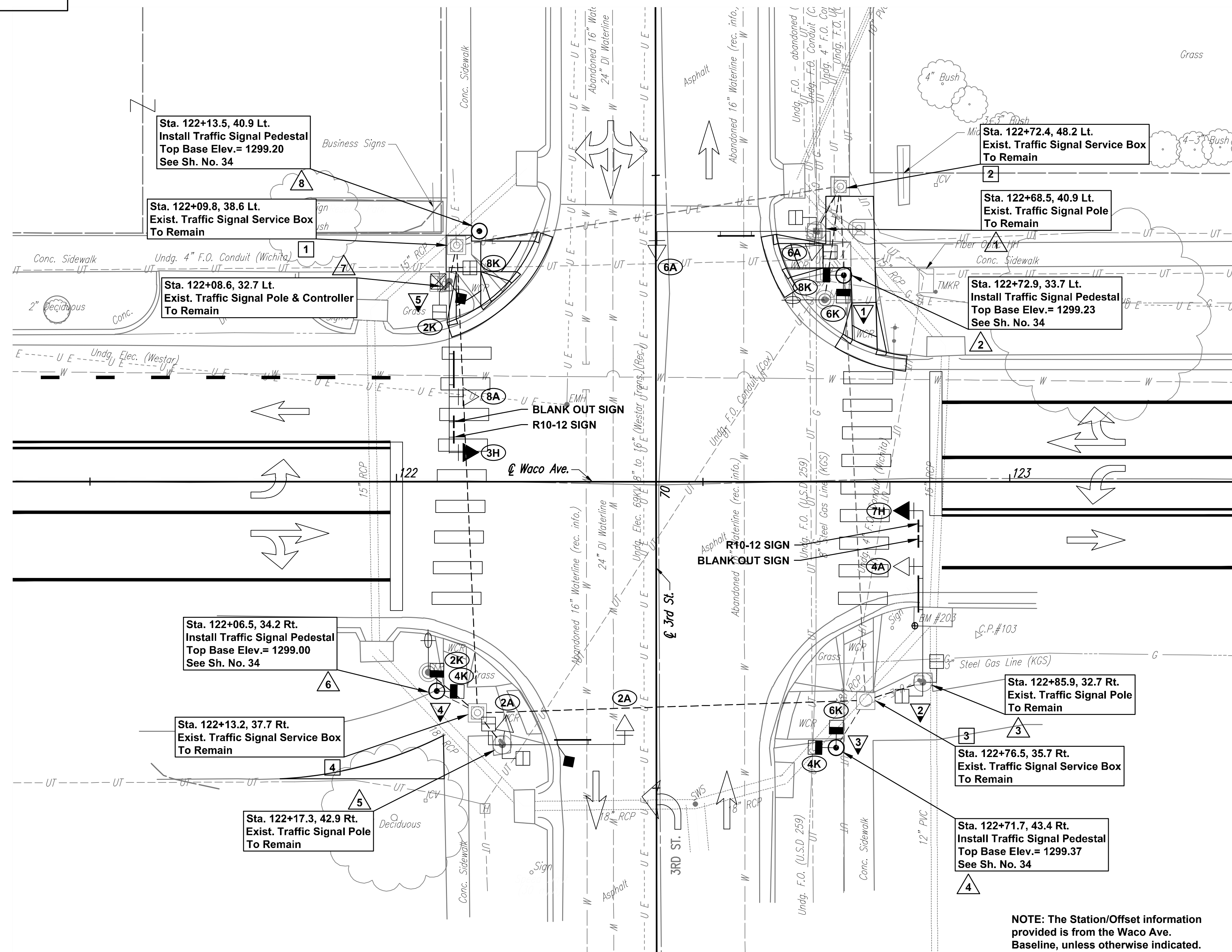

PAVING IMPROVEMENTS
 WACO AVENUE FROM DOUGLAS TO CENTRAL
 GARY JANZEN, P.E. - CITY ENGINEER
 CITY OF WICHITA PROJECT NO. 472-85496

Issue:	
JOB NO.	187042-006
DATE	JUNE 2019
PM	BMM
DESIGNED BY	RJS, SAC
DRAWN BY	CP, BJS
CHECKED BY	BMM

WACO & THIRD TRAFFIC SIGNAL PLAN

NOTE: The Station/Offset information provided is from the Waco Ave. Baseline, unless otherwise indicated.