

Saved 6/7/2019 10:23:19 AM by CP
 Plot Scale: 1" = 10'
 U:\Wichita-Civil\011817042\000\Main\Trans\Drawings\187042-006-08C-PLAN FIRST

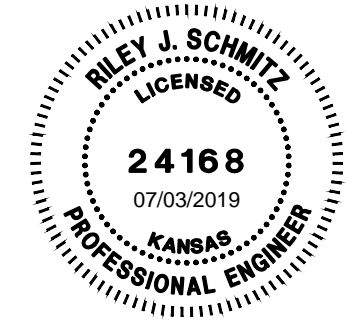
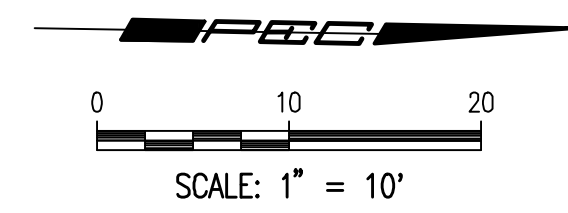
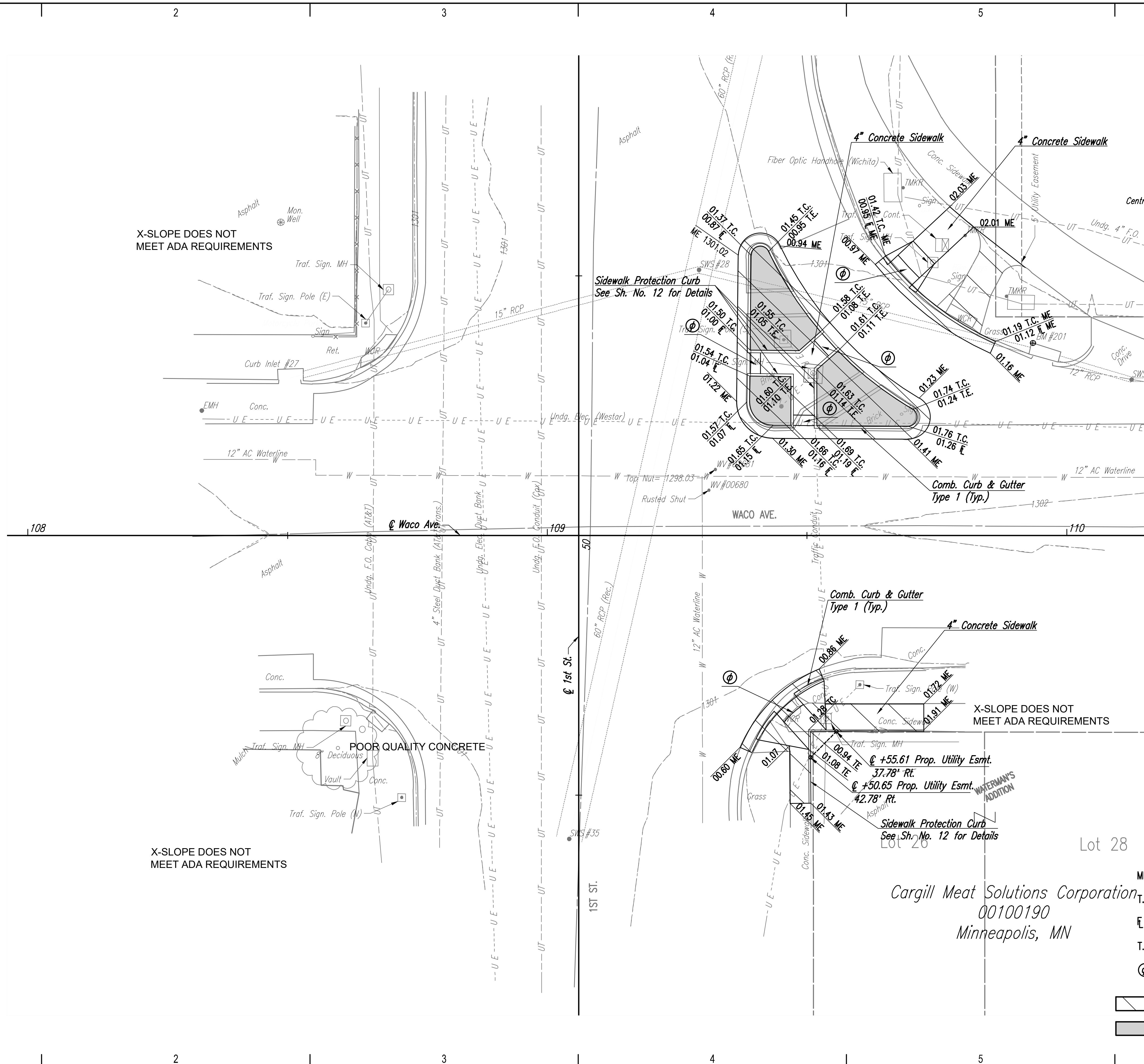

PAVING IMPROVEMENTS
WACO AVENUE FROM DOUGLAS TO CENTRAL
 GARY JANZEN, P.E. - CITY ENGINEER
 CITY OF WICHITA PROJECT NO. 472-85496

LEGEND

- ME - Match Existing
- T.C. - Top of Curb
- FL - Flowline
- T.E. - Toe Elevation
- Ⓢ - Wheelchair Ramp with Detectable Warning
- ▨ - Pavement Removal
- ▩ - Median Paving, See Sh. No. 03

Issue:	
JOB NO.	187042-006
DATE	JUNE 2019
PM	BMM
DESIGNED BY	RJS, SAC
DRAWN BY	CP, BJS
CHECKED BY	BMM
WACO & FIRST ST. PLAN	
08	
08 OF 48	

Cargill Meat Solutions Corporation
 00100190
 Minneapolis, MN

Lot 28