

PLOT12: Wednesday, October 16, 2019 @ 11:02AM

J:\PROJECTS\2017\1701010567\_COW\_STRYKER\_170567\_CAD\SH1505\_OVAL\_NORTH\_PARKING\17567\_ELEC\_SITE\_PLAN.DWG

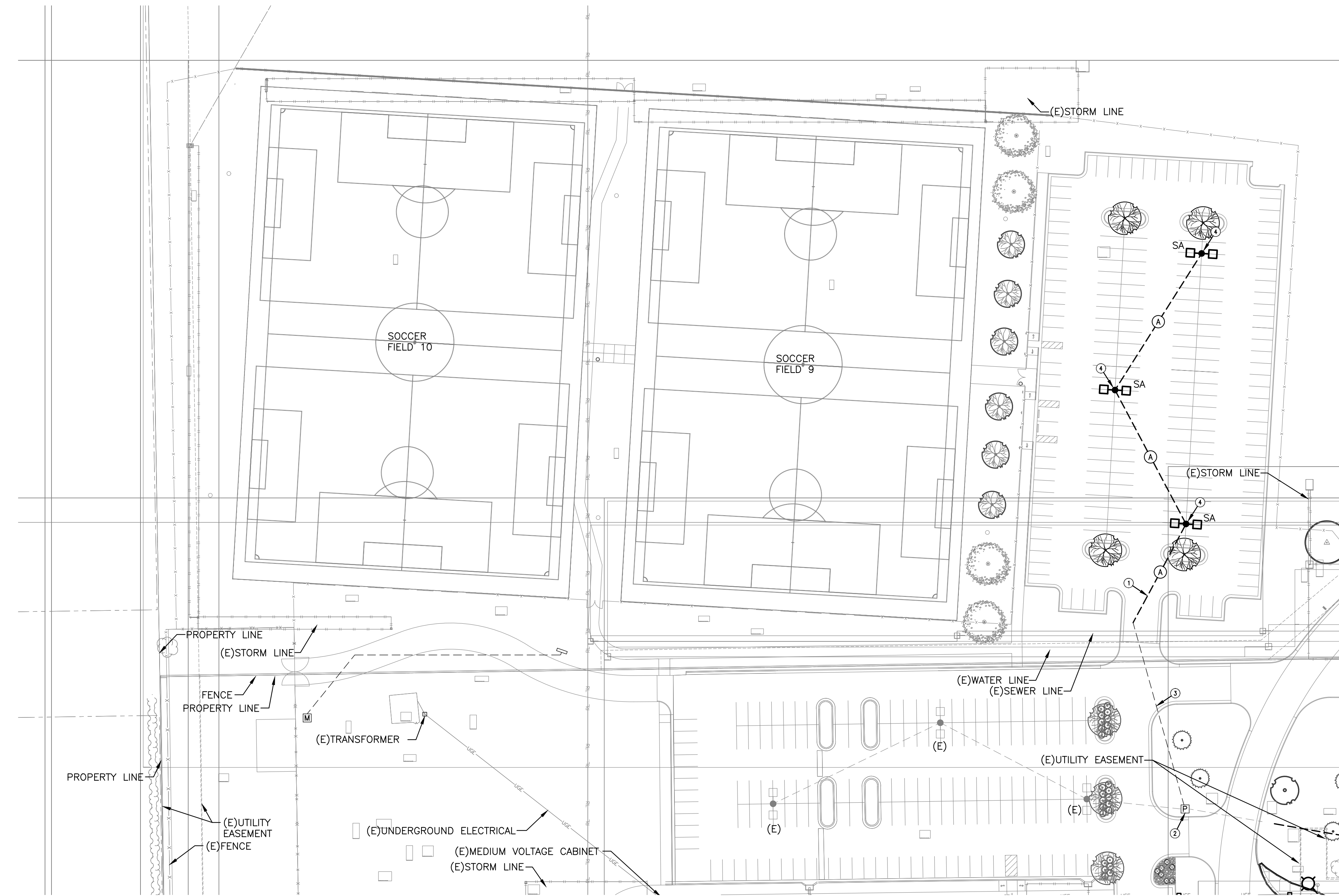

FIXTURE LEGEND	
●□	SINGLE ARM FIXTURE.
□●□	DOUBLE ARM FIXTURE AT 0° AND 180°.
⊠	PEDESTRIAN FIXTURE.
○	FLAG POLE FIXTURE.

GENERAL NOTES	
1.	EXISTING CONDITIONS SHOWN ON THE DRAWINGS WERE TAKEN FROM ORIGINAL DOCUMENTS AND FIELD OBSERVATIONS. THIS CONTRACTOR SHALL BE RESPONSIBLE FOR VERIFICATION OF EXISTING CONDITIONS. E.C. SHALL VISIT THE JOBSITE PRIOR TO BID AND VERIFY ALL EXISTING CONDITIONS.
2.	UPON COMPLETION OF PROJECT, E.C. SHALL PROVIDE A FULL TYPED AND UPDATED PANEL DIRECTORY FOR EACH PANELBOARD AFFECTED BY THE SCOPE OF THIS PROJECT.
3.	FEEDER ROUTING INDICATED ON THE DRAWINGS DOES NOT INDICATE NEC CODE REQUIRED PULL BOXES. E.C. SHALL BE RESPONSIBLE FOR LOCATING AND INSTALLING REQUIRED PULL BOXES FOR EACH FEEDER.

KEYED NOTES	
1.	EXTEND EXISTING CONDUIT TO NEW PARKING POLE LIGHT.
2.	SPLICE EXISTING CIRCUIT SC1:1,3 TO FEED NEW LIGHTS.
3.	ROUTE CIRCUIT THROUGH EXISTING SPARE CONDUIT.
4.	PROVIDE NEW POLE BASE PER DETAIL.

FEEDER SCHEDULE	
A	PROVIDE (2)-#10, (1)-#10 GND IN 1" CONDUIT FOR LIGHTING.

**ELECTRICAL SITE PLAN**  
SCALE: 1" = 50'-0"



PAVING, LANDSCAPE, AND LIGHTING  
**STRYKER SPORTS**  
 WICHITA, KANSAS

©2019 MKEC Engineering All Rights Reserved www.mkec.com  
 These drawings and their contents, including, but not limited to, all concepts, designs, & ideas are the exclusive property of MKEC Engineering (MKEC), and may not be used or reproduced in any way without the express consent of MKEC.

**ELECTRICAL SITE PLAN - AREA A**

PROJECT NO.	1701010567
DATE	OCT. 16, 2019
SCALE	1"=50'-0"
DESIGNED	JRBW
DRAWN	JAC
CHECKED	JRBW

NO.	REVISION	DATE
0	ISSUED FOR CONSTRUCTION	10-16-19

SHEET NO.  
15 OF 16

