

BENCHMARKS:
BM #1: "□" on Fence Footing under warning US Air Force Installation Sign West of Rock Road, 400' N. of W 1/2 Cor. Elev. = 1377.45 NAVD88

BM #2: Cross cut in top of curb West end of southwest curb return, 34th & 34th Ct. (Lots 1-13, Block A) Elev. = 1379.36 NAVD88

BM #3: Cross cut in top of curb North end of north curb return, 34th & 34th Ct. (Lots 22-36, Block A) Elev. = 1377.16 NAVD88

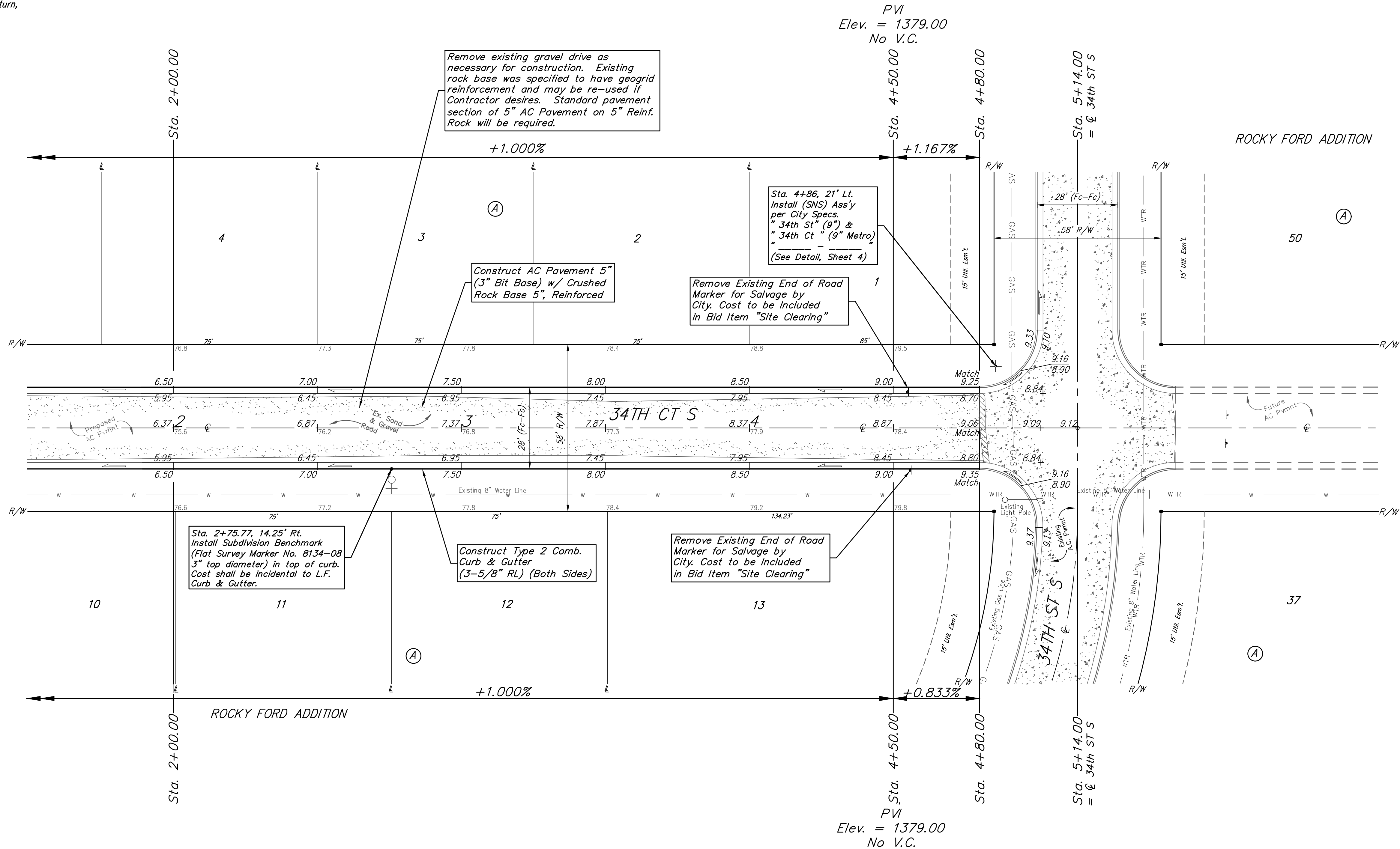
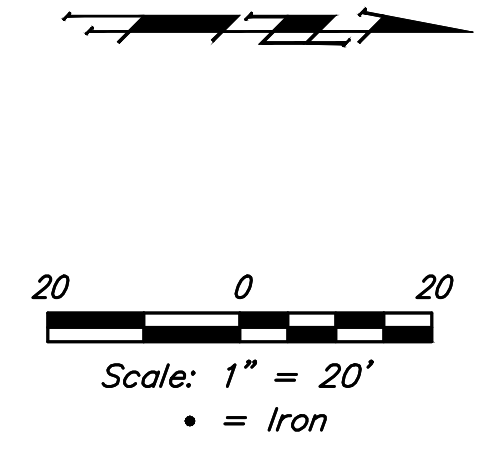

Subdivision Benchmarks

Street & Station	Location Description	Elevation
Anna St 0+32.38, 14.25' Rt.	Adjacent to Fire Hydrant West of the NW Cor., Lot 11, Blk A	

Roll type curb & gutter to be constructed on the pavement on this sheet.
 Top of curb elevation are given for full height curb.

	Rocky Ford Addition - Phase 2A	
	34TH CT	
Lots 1-13, Block A		
Baughman Company, P.A. 315 Ellis St. Wichita, KS 67211 P 316-262-7271 F 316-262-0149 ENGINEERING SURVEYING PLANNING LANDSCAPE ARCHITECTURE		
PROJECT NUMBER 472-2019-085558	DESIGN AEG	DRAWN JAK
REVISIONS:	APPROVED	DATE 10/23/19
	SCALE Noted	SHEET
		6 OF 16