

MABCD REVIEWER:

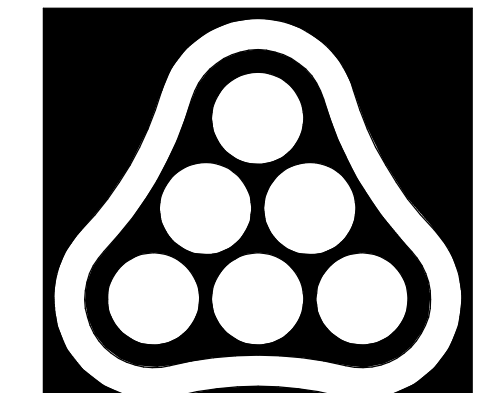

**PEC**  
PROFESSIONAL ENGINEERING CONSULTANTS  
303 SOUTH TOPEKA  
WICHITA, KS 67202  
316-262-2691 www.pec1.com

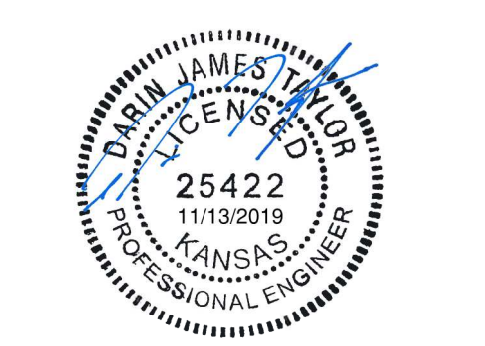

2020 HESS PUMP STATION  
DEHUMIDIFIER REPLACEMENT  
WICHITA, KS

MECHANICAL COMPOSITE  
PLAN

JOB NO. 197043-008  
DATE 11/13/2019  
DRAWN BY JPB  
CHECKED BY DJT

M1.1

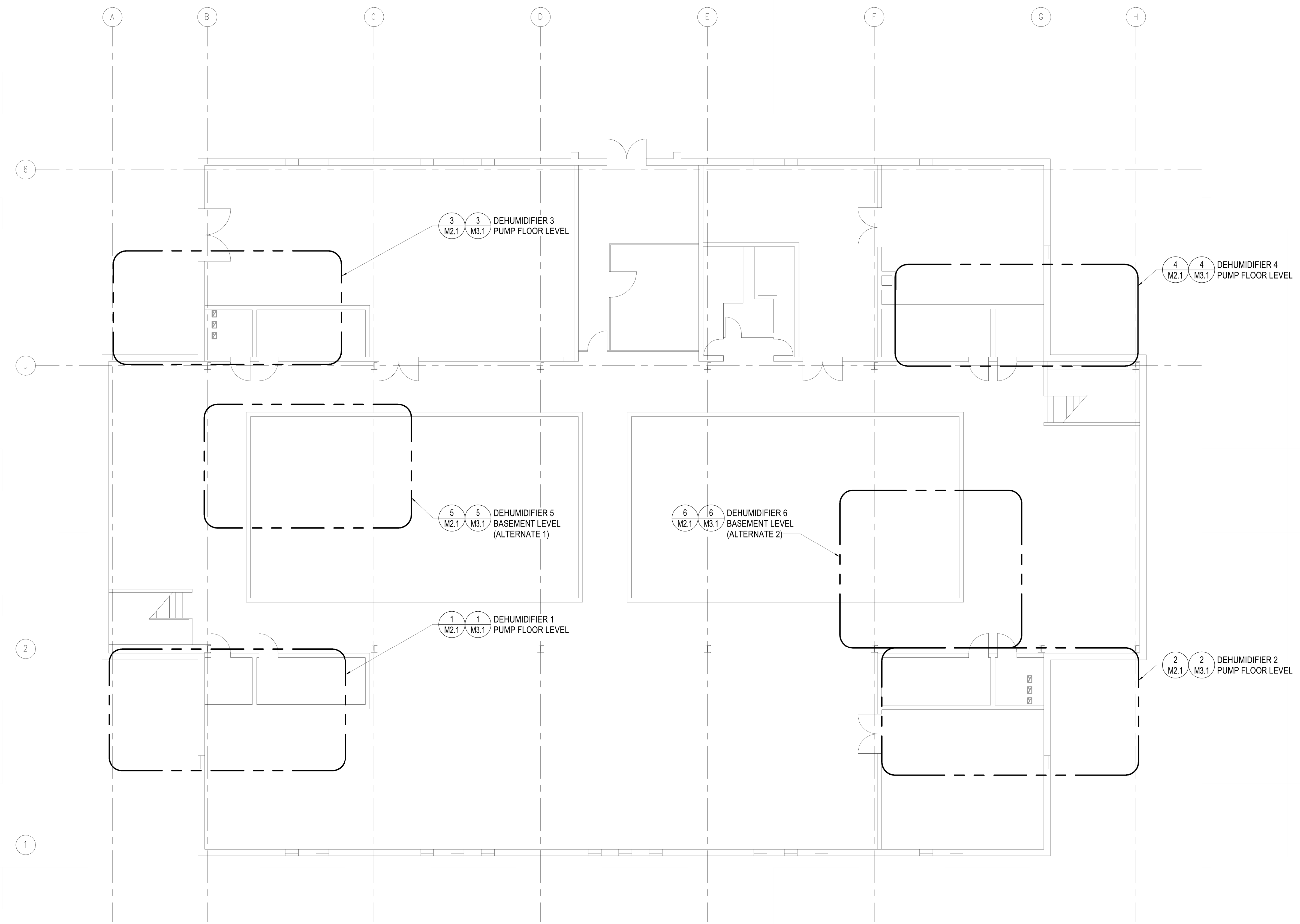

**1 COMPOSITE PLAN - GROUND FLOOR**

0' 4' 8' 12' 1/8" = 1'-0"

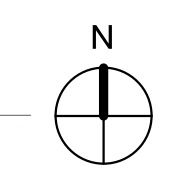

11/13/2019 12:43:29 PM C:\Users\jeff.bogner\Documents\197043-008-MECH-R19\_Jeff.Bogner@pec1.com.rvt