

PAVING AND INCIDENTAL DRAINAGE IMPROVEMENTS

CONSTRUCTION PLANS FOR THE VILLAS AT OAK CREEK-PHASE 1

CITY OF WICHITA PROJECT NO. 472-2019-085583
OCA NO. 766482

CITY OF WICHITA, KANSAS
GARY JANZEN, P.E. - CITY ENGINEER

DEVELOPER CONTACT

MR. BUTCH NUSS
SLAWSON COMPANIES INC.
727 N. WACO, SUITE 400
WICHITA, KANSAS 67203
(316) 263-3201

EARTHWORK SUMMARY		
ALIGNMENT	EXCAVATION (CU. YD.)	EMBANKMENT (CU. YD.)
Steeplechase	3,030	369
Steeplechase Cir.	686	2,085
Steeplechase Ct.	123	807
Carriage Oaks	801	85
TOTAL	4,640	3,346

No Shrinkage Factor has been applied.

The quantity shown for "Excavation" is measured from the Original Ground Line to the Finished Subgrade Line or Finished Ground Line as shown on the Cross Sections.

Only satisfactory soil shall be used in the construction of embankments.

Any double-handling and/or stockpiling of excavated material which may be required will not be measured or paid for separately, but shall be Subsidiary to the Contract Unit Price bid for "Excavation".

Estimated Waste Material = $4,640 - (3,346 / 0.85) = 704$ Cu. Yd.
(assumes 15% shrinkage)

Stockpile Excess Material on Site. See Sh. No. C102
Project No. 472-2019-085434 for Stockpile Location.

All unpaved areas disturbed by construction shall be graded smooth, sloped to drain and seeded/fertilized/mulched in accordance with the Erosion Control Plan.

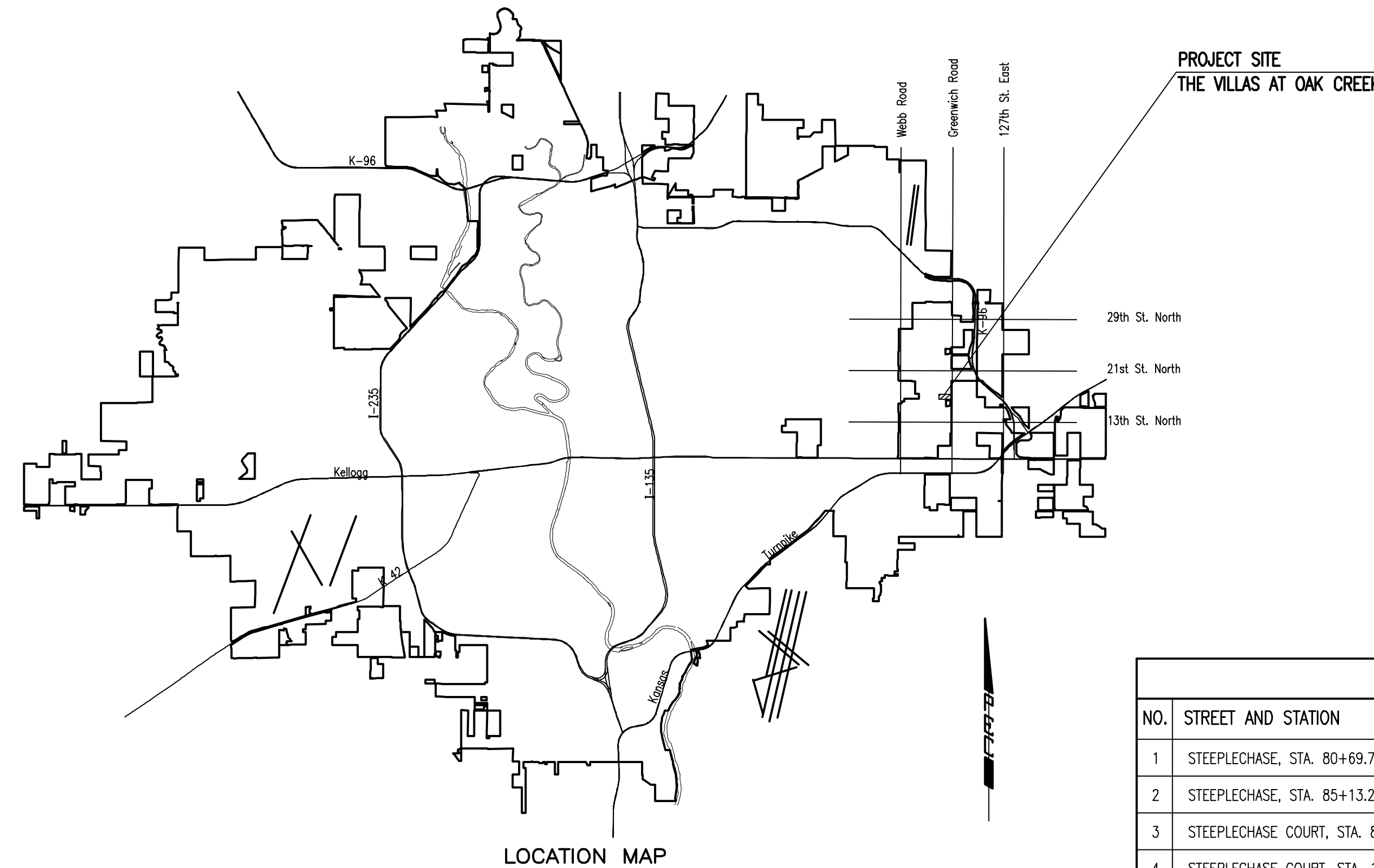

INDEX OF SHEETS

1. TITLE SHEET
2. KEY MAP AND GENERAL NOTES
3. PLAT
4. TYPICAL SECTIONS
- 5-6. PLAN-STEEPLECHASE
7. PLAN-STEEPLECHASE CIRCLE
8. PLAN-CARRIAGE OAKS
9. PLAN-STEEPLECHASE COURT
- 10-11. COORDINATE GEOMETRY PLAN & TABLES
12. VALLEY GUTTER PLAN CUL-DE-SAC
13. VALLEY GUTTER PLAN-STEEPLECHASE
14. VALLEY GUTTER PLAN-CARRIAGE OAKS
15. CUL-DE-SAC PLAN
16. PARKING DETAILS
17. CURB AND GUTTER DETAILS
18. VALLEY GUTTER DETAILS
19. WHEELCHAIR RAMP DETAILS
20. PLAN AND PROFILE-SWS LINE NO. 3
21. PLAN AND PROFILE-SWS LINE NO. 4
22. PLAN AND PROFILE-SWS LINE NO. 5
23. PLAN AND PROFILE-SWS LINE NO. 6
24. STD. TYPE 1A CURB INLET DETAILS
25. CURB INLET PAVEMENT UNDERDRAIN DETAILS
26. DOUBLE-DOUBLE DROP INLET
27. MANHOLE/INLET FRAME AND COVER
28. HEADWALL 15, 18, 24 DETAILS
29. MISCELLANEOUS RIPRAP DETAILS
30. WALL DETAILS
31. EROSION CONTROL PLAN
- 32-36. EROSION CONTROL DETAILS
37. SIGN DETAILS
- 38-51. CROSS SECTIONS

SUBDIVISION BENCH MARKS (SBM)				
NO.	STREET AND STATION	FROM C.	DESCRIPTION	ELEVATION
1	STEEPLECHASE, STA. 80+69.77	14.50' LT.	WEST END, SOUTHWEST CURB RETURN PRC, STEEPLECHASE	
2	STEEPLECHASE, STA. 85+13.24	14.50' LT.	WEST END, SOUTHWEST CURB RETURN PRC, STEEPLECHASE	
3	STEEPLECHASE COURT, STA. 88+91.00	14.50' LT.	SOUTH END CUL-DE-SAC, CURB RETURN PCC, STEEPLECHASE CIRCLE	
4	STEEPLECHASE COURT, STA. 105+32.34	14.50' LT.	SOUTH END, NORTHWEST CURB RETURN PT, STEEPLECHASE CT.	
5				

THE COST OF THE BENCH MARK DISC, INCLUDING INSTALLATION, SHALL BE SUBSIDIARY TO THE CURB.

NOVEMBER 2019

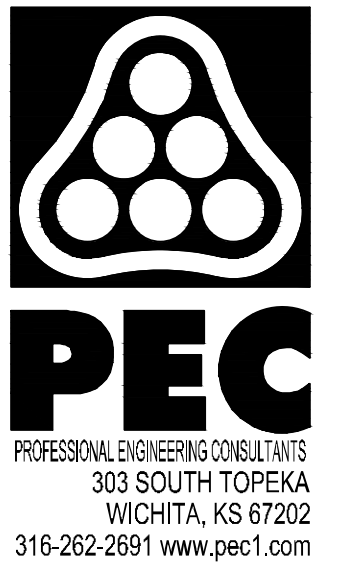

**PAVING INCIDENTAL
DRAINAGE IMPROVEMENTS
THE VILLAS AT OAK CREEK
PHASE 1**
 GARY JANZEN, P.E. - CITY ENGINEER
 CITY OF WICHITA PROJECT NO. 472-2019-085583

Issue:	
JOB NO.	170551
DATE	NOVEMBER, 2019
PM	BMM
DESIGNED BY	AKL
DRAWN BY	BJS, CP
CHECKED BY	BMM
TITLE SHEET	
01 TOTAL SHEETS 51	

Sheet 11 - 11-2019, 3:45:00 PM, by CP
 Plot Scale: 1/8" = 1'-0", 11/15/2019, 7:11:56 PM, by KURTIS DEKAT
 U:\Wichita-Civil\2017\170551\Drawings\170551-000-010-TITLE SHEET