

STORM WATER DRAIN NO. 463

TO SERVE

THE VILLAS AT OAK CREEK

OCA NO. 751600

CITY OF WICHITA PROJECT NO. 468-2019-085434

CITY OF WICHITA, KANSAS

GARY JANZEN, P.E. - CITY ENGINEER

EARTHWORK

EXCAVATION 49,860 CU. YDS.
COMPACTED FILL 39,666 CU. YDS.

DEVELOPER CONTACT

MR. BUTCH NUSS
SLAWSON COMPANIES
727 N. WACO, SUITE 400
WICHITA, KANSAS 67203
(316) 263-3201

Stormwater Certification:

New Development or Redevelopment (Circle One)

Stormwater Permit # Submitted

NOI State Permit # S-WA20-0103

NOI Federal Permit # KSR114136

These construction plans were prepared in accordance with the current Stormwater management Regulations as set forth in the City of Wichita's Stormwater Management Ordinance 16.32 and the policies/guidelines presented in the Wichita/Sedgwick County Stormwater Manual.

Site Area (Acres) = 30

Disturbed Area (Acres) = 20

Water Quality Treatment: Wet Detention Pond

Downstream Channel Protection: Wet Detention Pond

Detention: Wet Detention Pond

The BMP used for this development is Wet Detention Pond

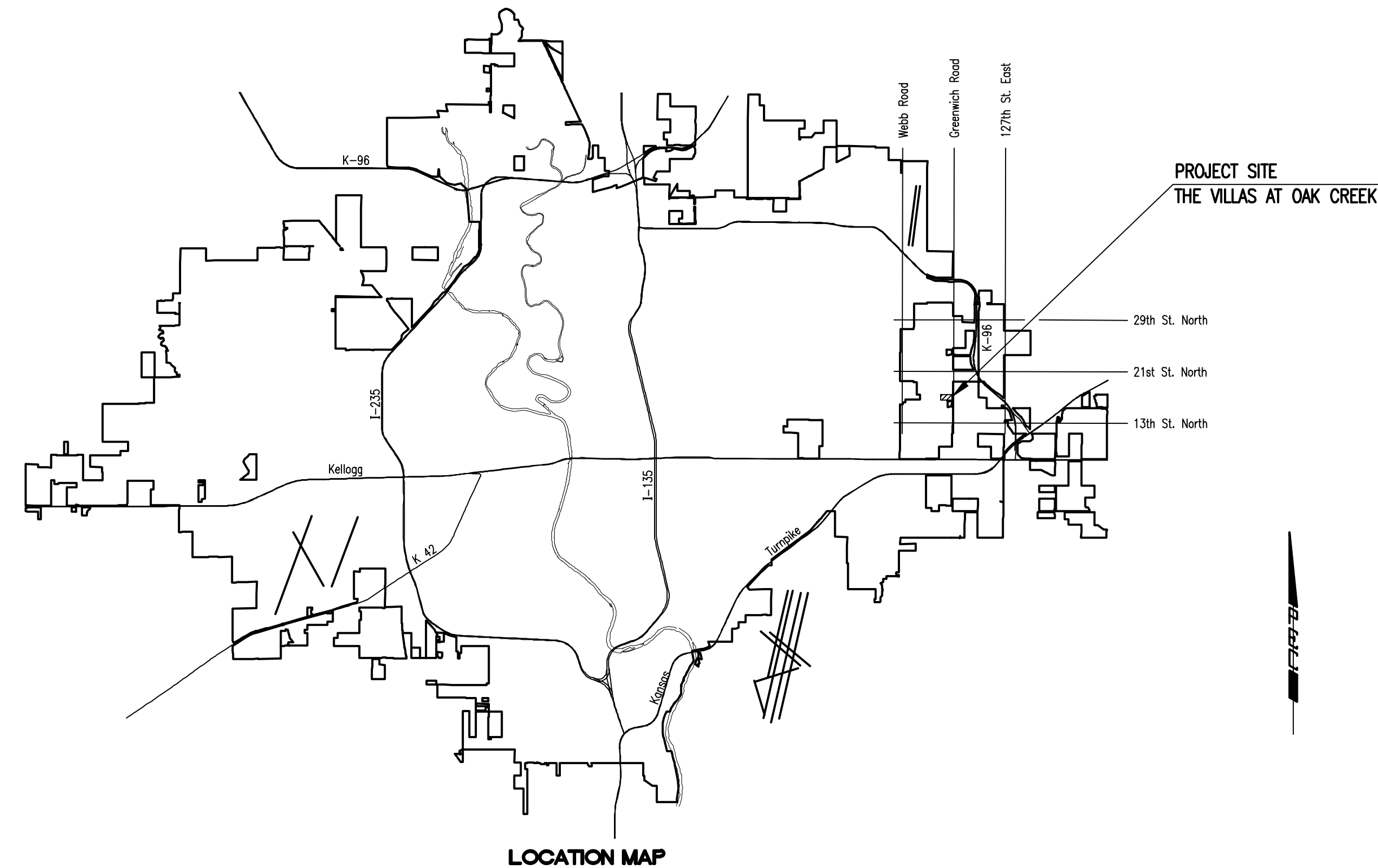

LOCATION MAP

NOVEMBER 2019

INDEX OF SHEETS

C101	TITLE SHEET
C102	KEY MAP AND GENERAL NOTES
C103	PLAT BUBBLE MAP
C104	GRADING PLANS - EAST
C105	GRADING PLANS - WEST
C106	TYPICAL SECTIONS
C107	STORM WATER SEWER LINE NO. 1 AND LINE NO. 2
C108	HEADWALL DETAILS FOR 30" AND 36" PIPE
C109	RETAINING WALL PLAN
C110	RIPRAP AND MISCELLANEOUS DETAILS
C111	FOUR CORNER PLAN GRADING PLAN
C112	EROSION CONTROL PLAN
C113-C117	EROSION CONTROL DETAILS
C118	COPY OF PLAT - THE VILLAS AT OAK CREEK

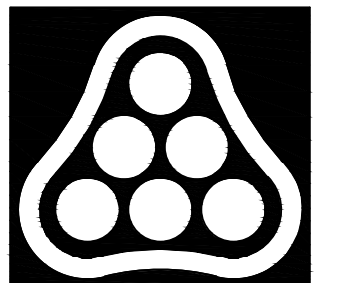

PEC
PROFESSIONAL ENGINEERING CONSULTANTS
303 SOUTH TOPEKA
WICHITA, KS 67202
316-262-2691 www.pec1.com

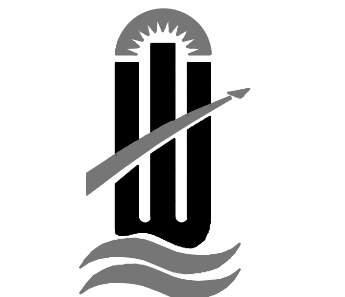

CITY OF
WICHITA



STORM DRAIN NO. 463
TO SERVE
THE VILLAS AT OAK CREEK
GARY JANZEN, P.E. - CITY ENGINEER
CITY OF WICHITA PROJECT NO. 468-2019-085434

Issue:									

JOB NO.	35-170551-001-0042
DATE	NOVEMBER 2019
PM	JAG
DESIGNED BY	JAG
DRAWN BY	CSL, KTD
CHECKED BY	CSB

SWD TITLE SHEET

C101