

Sta. 0+17.69,
RE-LINE Exist. MH as necessary to
fix any damage caused by Adjustment
Adjust MH
Exist. Elev. = 1353.96
Prop. Elev. = 1354.39
N=1697169.45
E=1689828.13
See Sht. No. 90

CAUTION !!
Exist. 21" San. Sewer

N=1697151.87
E=1689835.19

CL REDBUD ACCESS PATH STA. 0+00.00 =
CL REDBUD BIKE PATH STA. 109+33.20

Sta. 0+06.00, Construct
Concrete Pavement (6" Uniform)(AE),
Begin Redbud Access Path Typical Section
N=1697157.87
E=1689835.09
See Sht. No. 2,90

Sta. 1+42.68
N=1697294.53
E=1689832.87

CAUTION !!
Exist. OHP
(3 Loc.)

Sta. 1+26.18
Construct Bollards (Permanent)
(3 Loc.)
N=1697278.04
E=1689833.13
See Sht. No. 2,42,90

Sta. 1+32.68
Construct Std. WCR, W=12'
To be Paid for as
Concrete Pavement (6" Uniform)(AE)
No Detectable Warnings,
End Redbud Access Path Typical Section
N=1697284.53
E=1689833.03
See Sht. No. 2,39,40,90

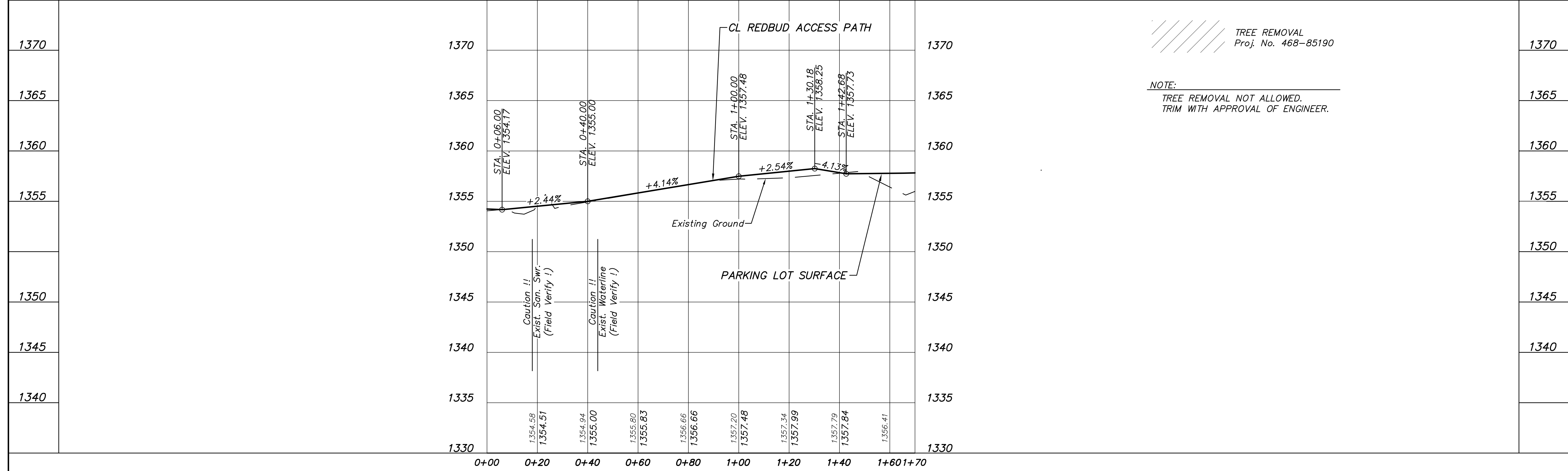

REDBUD BIKE PATH K-96 TO 159TH STREET EAST	PLAN & PROFILE	City of Wichita, Kansas CARY JANZEN, P.E. - CITY ENGINEER C.O.N. Project #472-85360, O.C.A. #707125
POE & ASSOCIATES, INC. CONSULTING ENGINEERS 544 West Douglas Avenue Wichita, KS 67203 Phone 316/685-4114 FAX 316/685-4444	THOMAS S. EVANS LICENSED 24211 KANSAS Professional Engineer	Engineer: T. EVANS Designer: J. UNRUH Dwg: P:\02027 Redbud Wichita\DWG\02027-BASE-tal grade.dwg Poe Job No: 102127 Date: SEPTEMBER 2018
By: Approved	Date	No.
29	of	222