

BENCHMARKS:
 BM#1: RR spike in high line pole, 40' west and 30' south of Lot 60, Block D, Firefly Way Addition.
 Elev. = 1399.54 NAVD88

BM#2: V-notch in sidewalk along Eagle St., adjacent to NE corner of Lot 15, Block E, Firefly Way Addition.
 Elev. = 1401.26 NAVD88

The Contractor shall give all property owners and/or tenants of developed property abutting the construction of this project a minimum of ten (10) days notice prior to start of construction.

- Lot 6 - MOORE, MAURICE D 2623 N WOODRIDGE CT
- Lot 13 - GODFREY, GREGORY J & TRISHA 2651 N WOODRIDGE CT
- Lot 14 - PREHEIM, JANELLE L LIV TR 2655 N WOODRIDGE CT
- Lot 21 - GRAF, STEPHEN P & ASHLEY R 2715 N WOODRIDGE CT
- Lot 22 - PISTOTNIK, KEVIN ANTHONY 2719 N WOODRIDGE CT.

Remove and replace fences as necessary for sewer riser construction. Riser location may be adjusted slightly north or south to avoid fence posts. Replace and repair any damage to sprinkler systems and replace sod to match. Costs for fence, sprinkler and sod work included in bid item "Site Restoration".

SEWER SERVICE TABLE

NUMBER	TYPE	LOCATION				FOR INFORMATION ONLY	
		LOT NO.	BLOCK NO.	LINE NO.	STATION \ DIRECTION	APPROXIMATE LENGTH 4" PIPE VERTICAL	HORIZONTAL
22	Extend existing riser*	6	D	-	0+40.2/Rt.	-	20.0'
23	8" X 4" Saddle Tap W/Riser	7	D	-	1+52.7/Rt.	11.5'	34.5'
24	8" X 4" Saddle Tap W/Riser	8	D	-	1+62.7/Rt.	11.5'	34.5'
25	8" X 4" Saddle Tap W/Riser	9	D	-	2+57.7/Rt.	11.0'	34.5'
26	Extend existing riser*	10	D	-	3+38.3/Rt.	-	20.0'
27	8" X 4" Saddle Tap W/Riser	11	D	-	4+19.5/Rt.	10.0'	34.5'
28	8" X 4" Saddle Tap W/Riser	12	D	-	5+54.5/Rt.	10.0'	34.5'
29	8" X 4" Saddle Tap W/Riser	13	D	-	5+64.5/Rt.	10.0'	34.5'
30	Extend existing riser*	14	D	-	6+80.2/Rt.	-	20.0'
31	8" X 4" Saddle Tap W/Riser	15	D	-	7+39.5/Rt.	7.5'	34.5'

NOTE: Vertical Riser Pipe shall be extended to 2' minimum above ground water elevation and 4' maximum below proposed ground elevation.

Risers #23-25 #27-29: These risers can go either under or over the existing sws and still be deep enough to serve the lots with basement service.
 Riser #31: The 8"x4" service tee shall be rotated to a 2% slope above horizontal for the service connection to fit under the existing 18" SWS pipe, which has a flow of approximately 1388.75

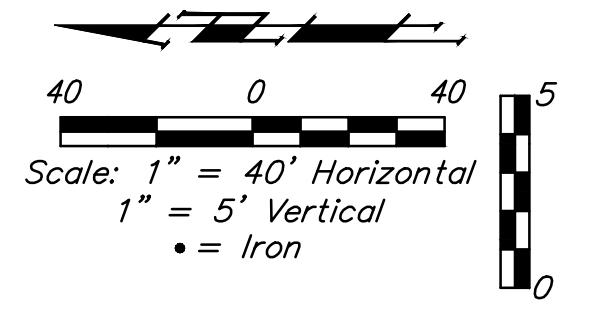

*Extend existing riser 20.0' west to edge of easement.

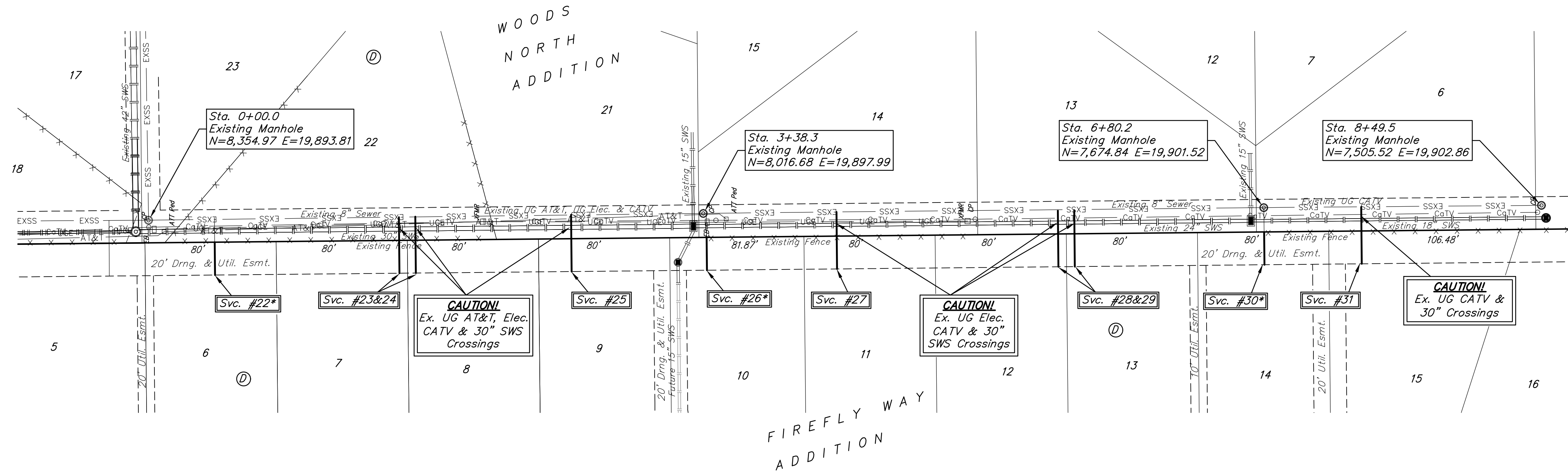

Baughman Company, P.A.
 ENGINEERING ARCHITECTURE PLANNING LANDSCAPE ARCHITECTURE
 1125 W. WILSON ST. SUITE 1000, P.O. BOX 20771, KANSAS CITY, MO 64116
 Justin E. Gottlieb, P.E.
 License No. 17919, State of Kansas
 Date: 11/25/19

FIREFLY WAY ADDITION
ADDL. RISERS
 SANITARY SEWER IMPROVEMENTS



Contractor shall verify elevation and alignment of existing 8" pipe prior to construction and notify Engineer of any discrepancy.