

STATE	PROJECT NO.	YEAR	SHEET NO.	TOTAL SHEETS
KANSAS	87 N-0662-01	2019	13	194

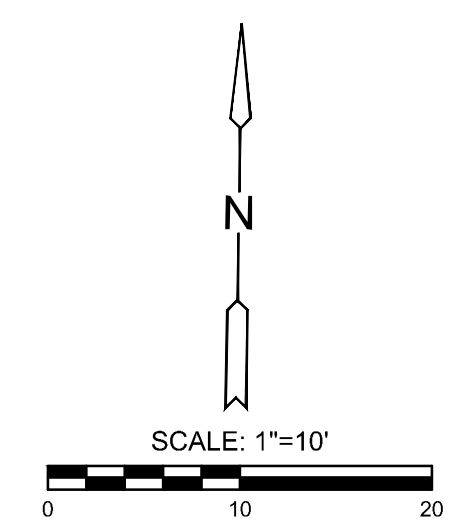

STA. 116+86.86, 15.5' LT. TO STA. 118+31.07, 15.6' LT.
 CONSTRUCT 144.2 L.F. OF "CONCRETE C&G (SPECIAL)
 REMOVED AND REPLACED". THE REPLACEMENT CURB SHALL
 CONFORM TO THE CURB AND GUTTER SHOWN ON THIS SHEET.

MONITORING WELL TO REMAIN IN SERVICE.
 CONTRACTOR SHALL PROTECT FROM DAMAGE.

STA. 118+11.07, 13.1' LT. TO 13.0' RT.
 CONSTRUCT 26.1 L.F. OF "CONCRETE
 PAVEMENT REMOVED AND REPLACED".
 SEE SH. NO. 85

STA. 116+73.23 TO STA. 118+26.07, 15.5' RT.
 CONSTRUCT 152.9 L.F. OF "CONCRETE C&G
 (SPECIAL) REMOVED AND REPLACED". THE
 REPLACEMENT CURB SHALL CONFORM TO THE
 CURB AND GUTTER SHOWN ON THIS SHEET.

BASELINE POINTS				
POINT #	STATION, / OFFSET	NORTHING	EASTING	DESC.
200	116+50.00 / 0.00'	1697149.13	1649981.36	POT
201	118+50.00 / 0.00'	1697152.34	1650181.34	POT

PAVING POINTS				
POINT #	STATION, / OFFSET	NORTHING	EASTING	DESC.
100	116+73.26 / 15.47' RT.	1697134.03	1650004.87	TC/BK
101	118+26.07 / 15.49' RT.	1697136.47	1650157.66	TC/BK
102	116+86.86 / 15.45' LT.	1697165.17	1650017.97	TC/BK
103	118+31.07 / 15.60' LT.	1697167.63	1650162.16	TC/BK

POT = POINT ON TANGENT
 TC/BK = TOP CURB AT BACK

* HEIGHT OF FULL-HEIGHT CURB (AND PROFILE GRADE).
 THE LAST THREE FEET OF CURB SHALL BE
 TRANSITIONED TO 0" HIGH.

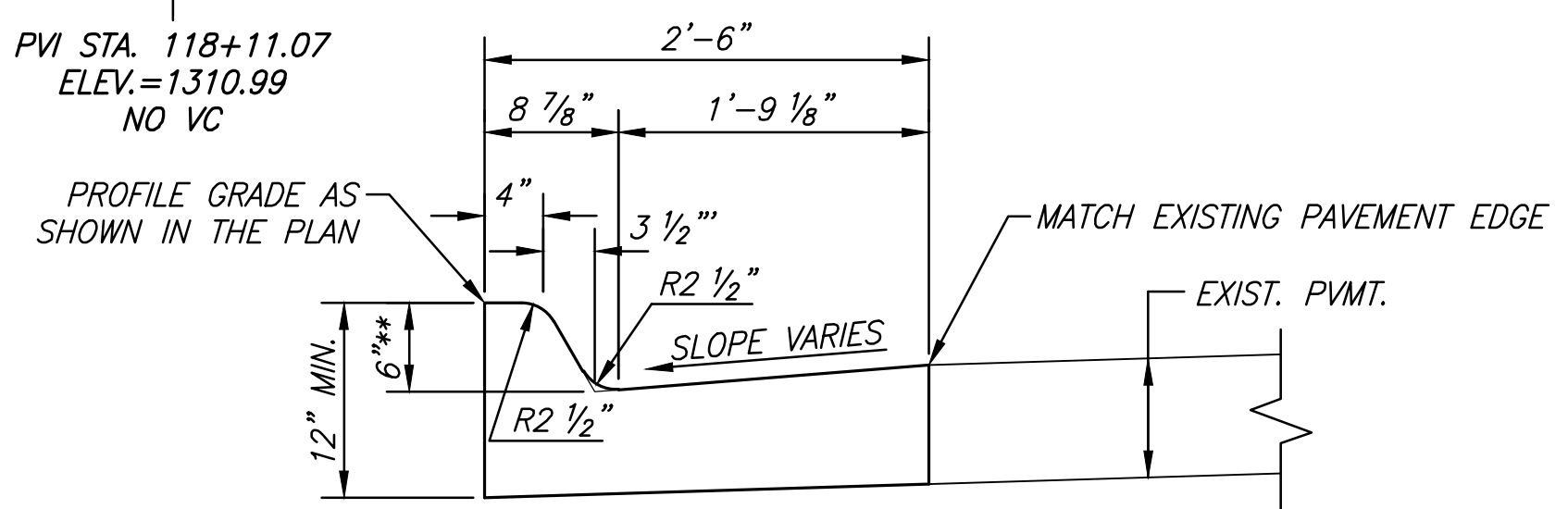
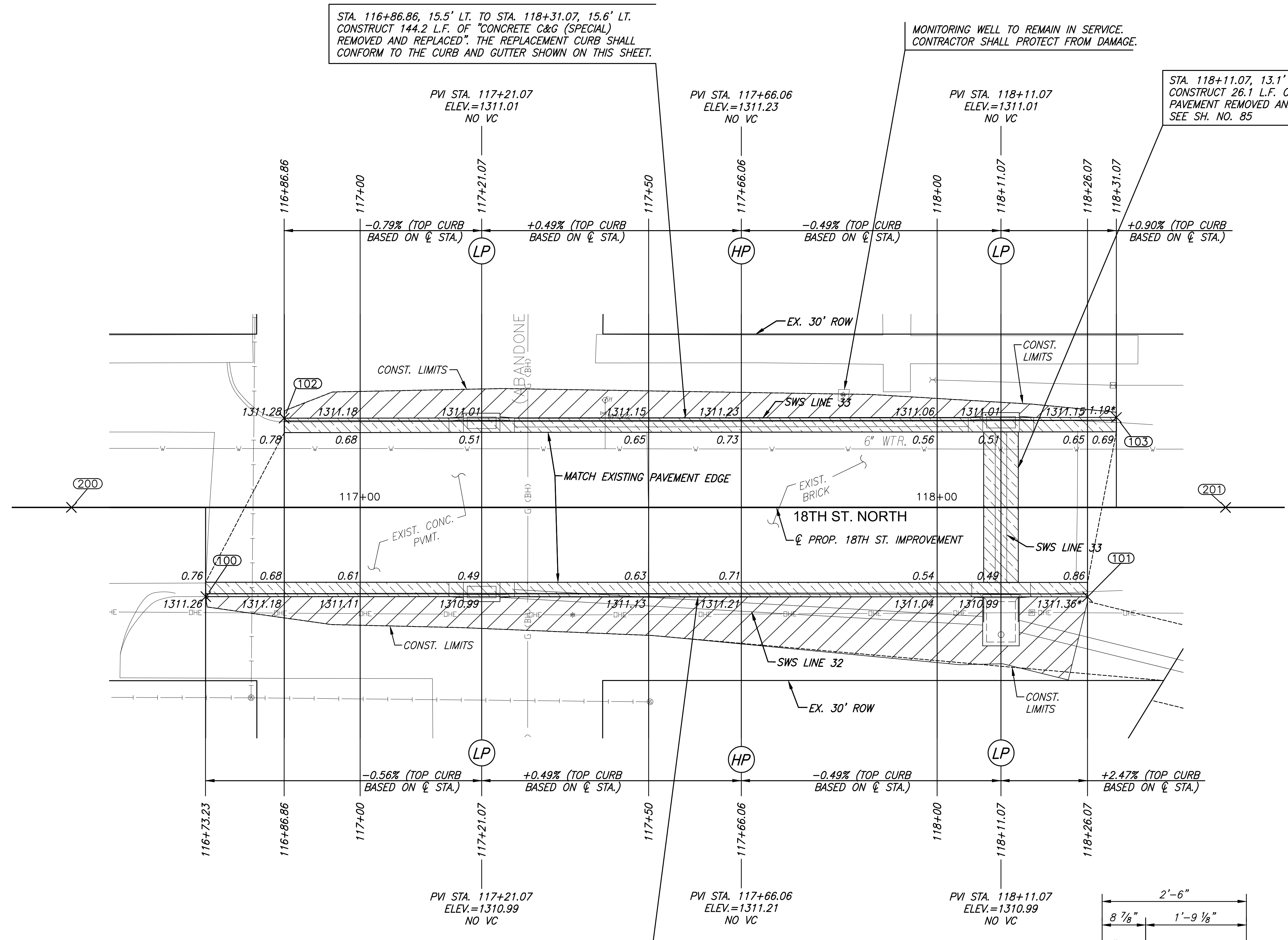

CONCRETE C&G, TYPE I (6" & 1 1/2"), SPECIAL

NO SCALE
 ** TRANSITION TO 0" OVER THE FARTHEST
 EAST THREE FEET OF CURB.

- LEGEND**
- PAVEMENT REMOVAL
 - CONSTRUCT WHEELCHAIR RAMP
SEE SH. NO. 66
 - BRICK PAVERS
 - AGGREGATE HOOKUP
 - 8" SIDEWALK
 - STORM SEWER REMOVAL
 - PAVEMENT REMOVED AND
REPLACED, SEE SH. NO. 85
 - PROPOSED WESTAR POLE

STREET IMPROVEMENTS FOR
17TH ST - BROADWAY TO I-135
 FROM BROADWAY TO I-135

©2019
 MKEC Engineering
 All Rights Reserved
 www.mkec.com
 These drawings and their contents,
 including, but not limited to, all concepts,
 designs, & ideas are the exclusive
 property of MKEC Engineering (MKEC),
 and may not be used or reproduced in any
 way without the express consent of MKEC.

**18TH ST. CURB
 AND GUTTER
 PLAN**

PROJECT NO.	87 N-0662-01	
DATE	8/30/2019	
SCALE	1"=10'	
DESIGNED	DRAWN	CHECKED
GN	RAM	JRA
NO.	REVISION	DATE

SHEET NO.
 13 OF 194