

STATE	PROJECT NO.	YEAR	SHEET NO.	TOTAL SHEETS
KANSAS	87 N-0662-01	2019	47	194

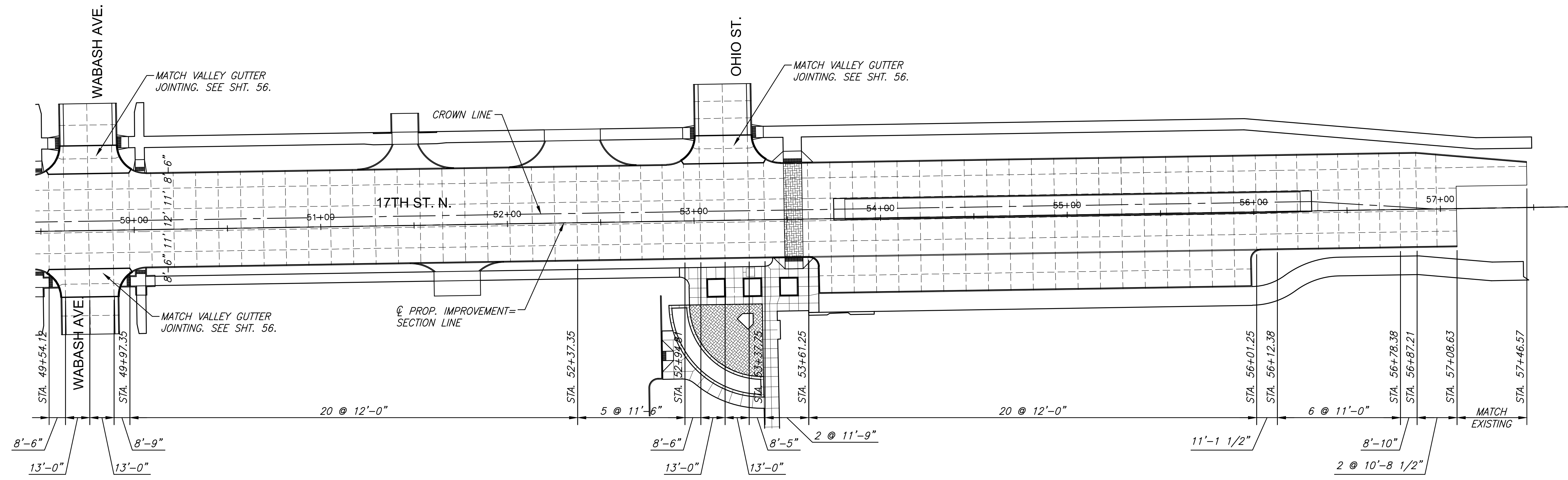

PLAN - 17TH ST. N.

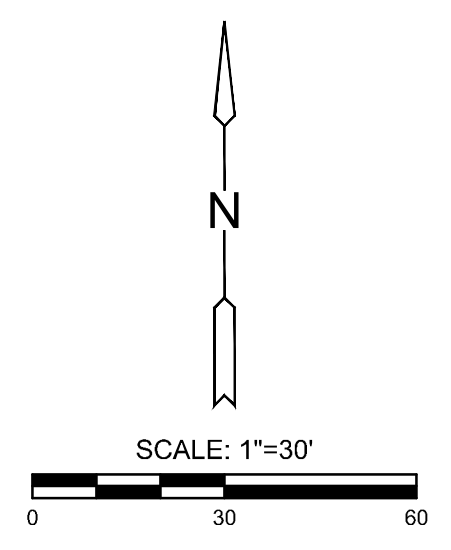

STREET IMPROVEMENTS FOR
17TH ST - BROADWAY TO I-135
 FROM BROADWAY TO I-135

©2019
 MKEC Engineering
 All Rights Reserved
 www.mkec.com
 These drawings and their contents, including, but not limited to, all concepts, designs, & ideas are the exclusive property of MKEC Engineering (MKEC), and may not be used or reproduced in any way without the express consent of MKEC.

CONCRETE PAVEMENT JOINTING PLAN

PROJECT NO.	87 N-0662-01	
DATE	8/30/2019	
SCALE	1"=30'	
DESIGNED	DRAWN	CHECKED
JRA	RAM	JRA

NO.	REVISION	DATE

SHEET NO.

47 OF 194

PLOTTED: Tuesday, September 03, 2019 @ 02:14PM
 J:\CIVIL\0417\DWG\PAV\041717-EJ03.DWG