

PLOTTED: Tuesday, September 03, 2019 @ 03:05PM

J:\CIVIL\0417\DWGS\SW\0417_0202.DWG

STATE	PROJECT NO.	YEAR	SHEET NO.	TOTAL SHEETS
KANSAS	87 N-0662-01	2019	86	194

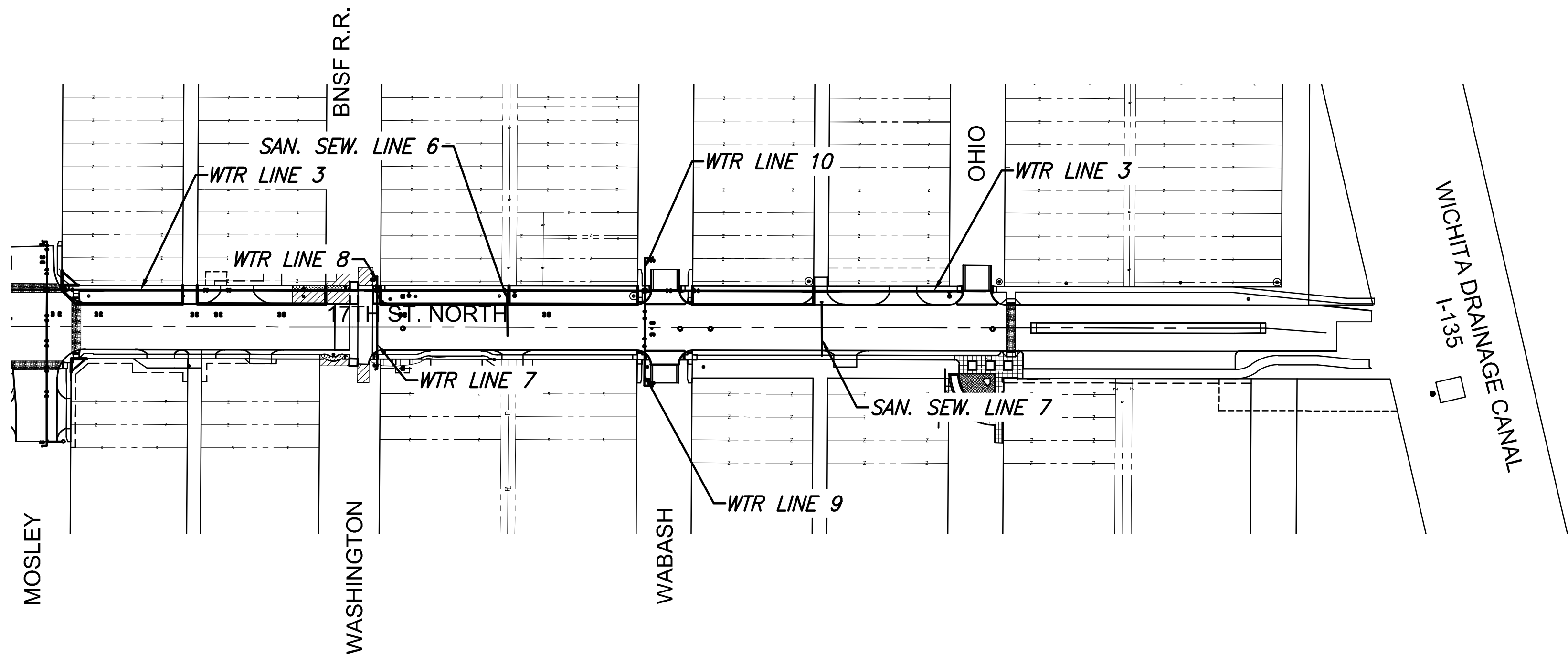
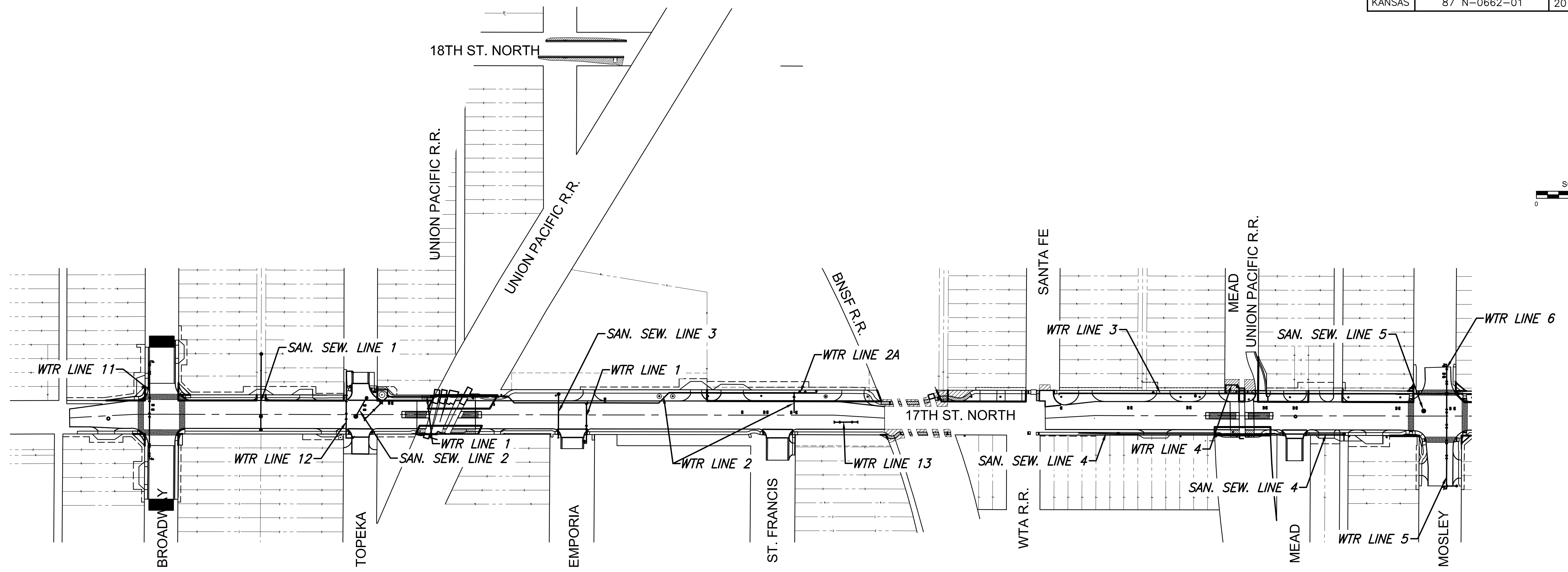
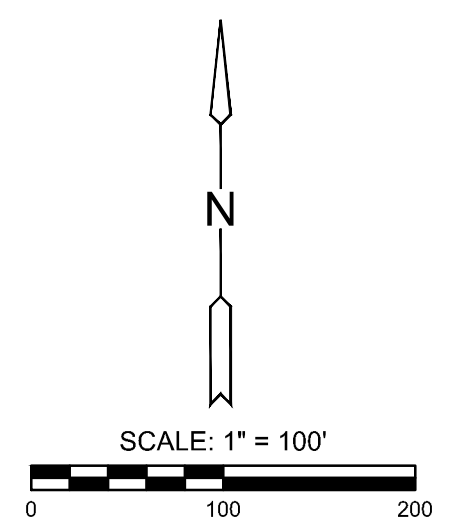

SANITARY SEWER INFORMATION TABLE

LINE NO.	SHEET NO.
SAN LINE 1	87
SAN LINE 2	87
SAN LINE 3	87
SAN LINE 4	88
SAN LINE 5	88
SAN LINE 6	89
SAN LINE 7	89

WATER LINE INFORMATION TABLE

LINE NO.	SHEET NO.
WTR LINE 1	94
WTR LINE 2 & 2A	95
WTR LINE 3	96, 97, 98, 99
WTR LINE 4	99
WTR LINE 5	99
WTR LINE 6	100
WTR LINE 7	100
WTR LINE 8	100
WTR LINE 9	101
WTR LINE 10	101
WTR LINE 11	101
WTR LINE 12	102
WTR LINE 13	102

STREET IMPROVEMENTS FOR
17TH ST - BROADWAY TO I-135
 FROM BROADWAY TO I-135

©2019 MKEC Engineering All Rights Reserved www.mkec.com
 These drawings and their contents, including, but not limited to, all concepts, designs, & ideas are the exclusive property of MKEC Engineering (MKEC), and may not be used or reproduced in any way without the express consent of MKEC.

UTILITY KEY MAP - WTR. & SAN.

PROJECT NO.	87 N-0662-01	
DATE	8/30/2019	
SCALE	1"=100'	
DESIGNED	DRAWN	CHECKED
JRA	RAM	JRA

NO.	REVISION	DATE

SHEET NO.
 86 OF 194