



© 2018 GARVER, LLC
 THIS DOCUMENT, ALONG WITH THE IDEAS AND DESIGNS CONVEYED HEREIN, SHALL BE CONSIDERED INSTRUMENTS OF PROFESSIONAL SERVICE AND ARE PROPERTY OF GARVER, LLC. ANY USE, REPRODUCTION, OR DISTRIBUTION OF THIS DOCUMENT, ALONG WITH THE IDEAS AND DESIGN CONTAINED HEREIN, IS PROHIBITED UNLESS AUTHORIZED IN WRITING BY GARVER, LLC OR EXPLICITLY ALLOWED IN THE GOVERNING PROFESSIONAL SERVICES AGREEMENT FOR THIS WORK.



Digitally Signed 11/18/2019

REV.	DATE	DESCRIPTION	BY



CITY OF WICHITA
 WICHITA, KANSAS
 Consolidation of Lift Stations
 Near 151st St. & W. Kellogg

ELECTRICAL SITE PLAN

JOB NO.: 17264967
 DATE: NOV. 2019
 DESIGNED BY: SAH
 DRAWN BY: SAH

BAR IS ONE INCH ON ORIGINAL DRAWING
 IF NOT ONE INCH ON THIS SHEET, ADJUST SCALES ACCORDINGLY.

DRAWING NUMBER

E2

SHEET NUMBER **15 OF 36**

KEY NOTES:

- 1 SEE ONELINE ON SHEET E1 FOR CONDUIT AND CONDUCTOR SIZING.
- 2 (12-#14, #14 GND) 1" C CONTROL, FROM ATS TO GENERATOR.
- 3 (4-#12, #12 GND) 1" C, 120VAC POWER FROM MPZ IN UTILITY ENCLOSURE TO GENERATOR FOR BATTERY CHARGER AND BLOCK HEATER.
- 4 SEE ONELINE ON SHEET E1 FOR CONDUIT AND CONDUCTOR SIZING FOR 480VAC FROM GENERATOR TO AUTOMATIC TRANSFER SWITCH.
- 5 (RF CABLE) 2" C, SIGNAL. FROM ANTENNA TO PLC/RTU CONTROL PANEL.
- 6 MAKE ALL REQUIRED CONNECTIONS BETWEEN GENERATOR, AUTOMATIC TRANSFER SWITCH, AND MINI POWER ZONE ACCORDING TO MANUFACTURER'S INSTALLATION INSTRUCTIONS.
- 7 (2) (MANUFACTURER'S SUPPLIED PUMP CORDS) 2" C, 480 VAC, FROM WET WELL, THROUGH VENTRIB TROUGH, TO JUNCTION BOX TB01.
- 8 (MANUFACTURER'S SUPPLIED CABLES) 2" C, SIGNAL. FROM FLOAT SWITCHES LS01/02/03/04 AT WETWELL, THROUGH VENTRIB TROUGH, TO TB01.
- 9 (MANUFACTURER SUPPLIED CABLE) 1"C, SIGNAL. FROM LEVEL TRANSDUCER LE01, THROUGH VENTRIB TROUGH, TO JUNCTION BOX TB01.

GENERAL NOTES:

1. UNLESS OTHERWISE NOTED, ALL CONDUIT AND PORTIONS OF THE CONDUIT SYSTEM SHALL BE SURFACE MOUNTED AND THE CONDUIT SYSTEM WITHIN THE FRP UTILITY ENCLOSURE SHALL BE GALVANIZED RIGID STEEL, ALL OTHERS SHALL BE PVC COATED RIGID STEEL. ALL BOXES, SUPPORTS, HANGERS, UNISTRUT AND ALL OTHER PORTIONS OF THE CONDUIT SYSTEM WITHIN THE FRP UTILITY ENCLOSURE SHALL BE GALVANIZED STEEL, ALL OTHERS SHALL BE PVC COATED OR STAINLESS STEEL. ALL BELOW GRADE CONDUIT FROM THE WET WELL TO THE ELECTRICAL ENCLOSURE SHALL BE PVC COATED RIGID STEEL, ALL OTHERS SHALL BE SCHEDULE 40 PVC WITH GALVANIZED ELBOWS.
2. THE CONTRACTOR SHALL FURNISH AND INSTALL ALL CONDUIT, WIRING, TERMINATIONS, DISCONNECTS, CONTROL RELAYS, CONTROL ENCLOSURES AND OTHER ITEMS AS NECESSARY FOR COMPLETE AND FUNCTIONAL LIFT STATION. THE CONTRACTOR SHALL REFER TO THE SPECIFICATIONS AND OTHER SECTIONS OF THE PLANS FOR ITEMS AS MAY BE REQUIRED.
3. COORDINATE ALL CONDUIT ROUTING WITH ENGINEER PRIOR TO INSTALLATION.
4. FIELD LOCATE FINAL LOCATIONS OF ALL DIRECT BURIED CONDUITS AND PULLBOXES (IF REQUIRED). PROVIDE PULLBOXES AS REQUIRED FOR A WORKABLE INSTALLATION. ALL PULLBOXES SHALL BE APPROPRIATELY SIZED BY THE CONTRACTOR AS REQUIRED BY THE NUMBER OF CONDUITS FOR A WORKABLE INSTALLATION WITH MINIMUM SIZES AS INDICATED WITHIN THE DETAILS. COORDINATE ALL WORK WITH APPLICABLE UTILITY COMPANIES, MATERIAL SUPPLIERS, AND OWNER REPRESENTATIVES.
5. ALL LOCATIONS WITHIN THE WET WELL AS INDICATED ON THIS PLAN SHEET SHALL BE CONSIDERED A CLASS 1, DIVISION 2 HAZARDOUS LOCATION AS DEFINED IN ACCORDANCE WITH NFPA 820.
6. CONTRACTOR SHALL STRICTLY ADHERE TO THE REQUIREMENTS IN NFPA 70, ARTICLE 500, HAZARDOUS (CLASSIFIED) LOCATIONS FOR ALL AREAS REFERENCED IN THE NOTE ABOVE. THIS INCLUDES PROVIDING APPROPRIATE SEAL FITTINGS ON CONDUITS AND CABLES ALONG WITH PROVIDING EXPLOSION PROOF EQUIPMENT, RATED FOR THE CLASSIFICATION REFERENCED ABOVE, AS APPLICABLE.
7. CONTRACTOR SHALL BE RESPONSIBLE FOR COORDINATING GAS SERVICE AND METER LOCATION WITH UTILITY COMPANY. CONTRACTOR SHALL PAY ALL COSTS ASSOCIATED WITH PROVIDING GAS SERVICE FROM THE EXISTING MAIN THROUGH THE SITE.
8. INSTALL NATURAL GAS SYSTEM PER:

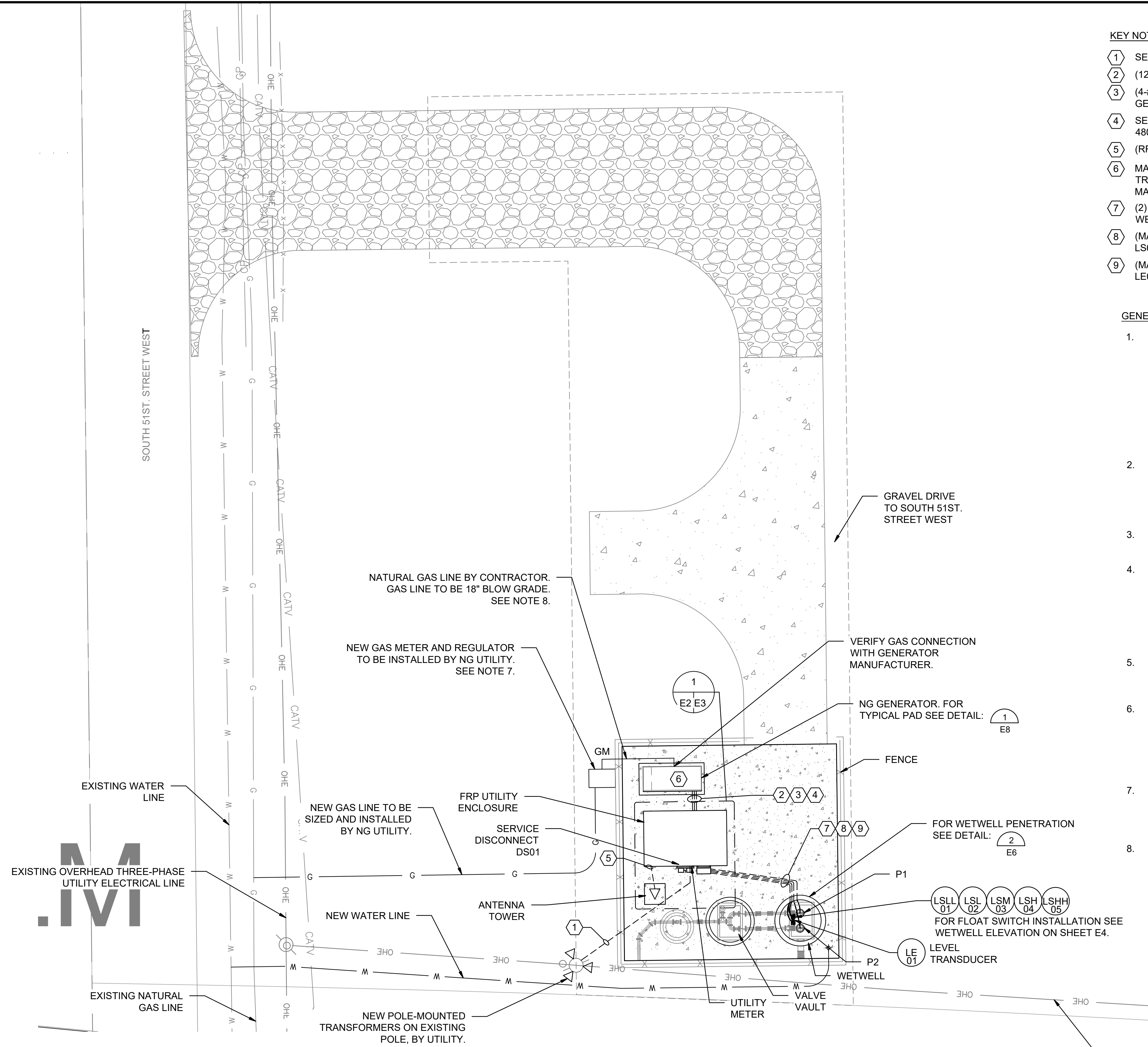

KELLOGG LIFT STATION ELECTRICAL SITE PLAN
 SCALE: 1/8" = 1'-0"
 PROJECT NORTH

File: L:\2017\17264967 - LS 53 Replacement No. 1\Drawings\KLPs\E2.dwg Last Save: 11/16/2019 3:23 PM Last saved by: SAHalsey
 Last plotted by: Haydock, Joseph C. Plot Style: AECmono.ctb Plot Scale: 1.0/4255 Plot Date: 11/18/2019 3:21 PM Plotter used: DWG To PDF.pc3