

- Notes
1. Tree removal and trimming should be limited to only those necessary for construction. The contractor shall protect all trees as specifically noted. All trees located outside of easements or trail right of way shall be protected.
 2. Any bypass pumping necessary for construction shall be subsidiary to abandoning existing lift stations. Contractor to ensure that existing sanitary sewer flow is maintained and existing lift stations are operational until new lift station and force main is accepted and operational. Sanitary sewer service shall be maintained during the entire project.
 3. For easements near lift station see Lift Station Site Plan (Sheet 10).
 4. Construction shall not impact trail or trail users. Contractor to ensure construction area is safely separated from trail, trail users. Open trenches shall be fenced off when work is not in progress or workers are not present.

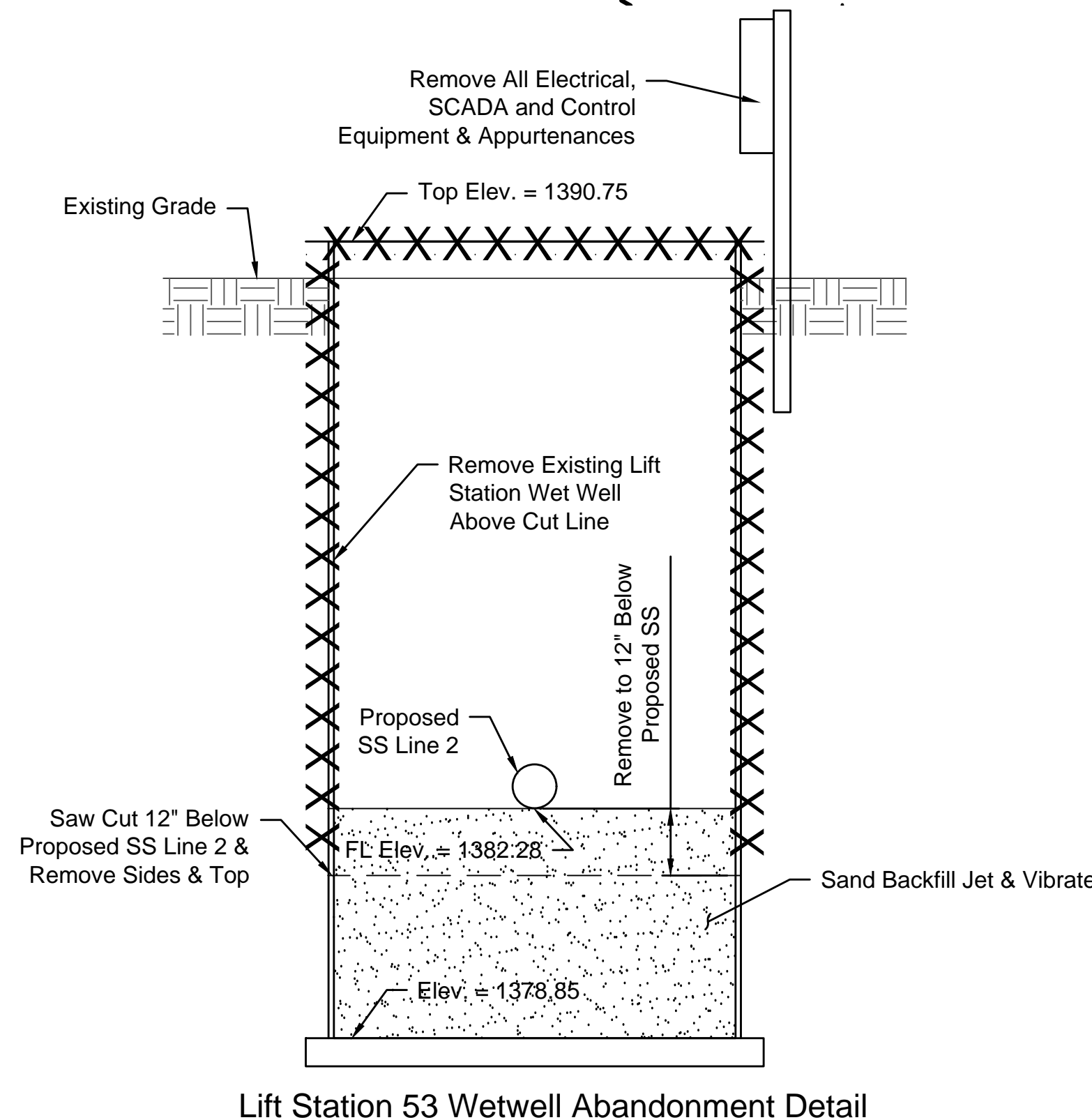

- Notes for Detail
1. Pumps, SCADA, control and electrical equipment to be salvaged to City of Wichita.
 2. Contractor may at their option remove entire lift station base in lieu of cutting and removing top portion only. Sand backfill will still be required under the proposed SS Line 2.

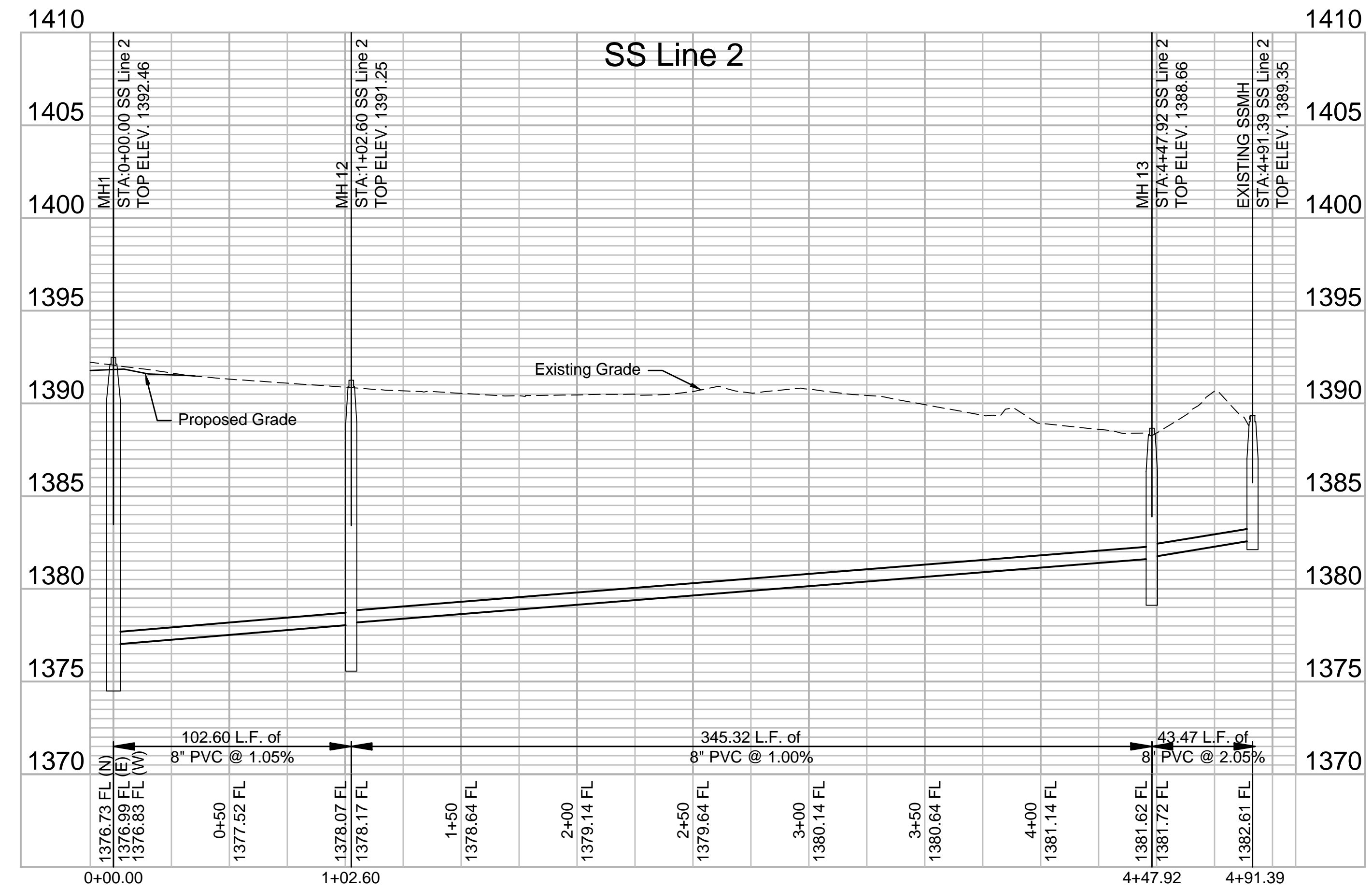

REV.	DATE	DESCRIPTION	BY

CITY OF WICHITA
 WICHITA, KANSAS

Consolidation of Lift Stations
 Near 151st St. & W. Kellogg

SS Line 2

JOB NO.: 17264967
 DATE: NOV. 2019
 DESIGNED BY: MTD
 DRAWN BY: MTD

BAR IS ONE INCH ON ORIGINAL DRAWING
 0 1" IF NOT ONE INCH ON THIS SHEET, ADJUST SCALES ACCORDINGLY.

DRAWING NUMBER

SHEET NUMBER **5** OF **36**