

BENCHMARK:
 BM #1 - Crow's Foot Cut on Top of Curb 80' North of the Centerline
 of 11th Street North on the West Side of Poplar.
 Elev. = 1307.25 (NAVD 88)

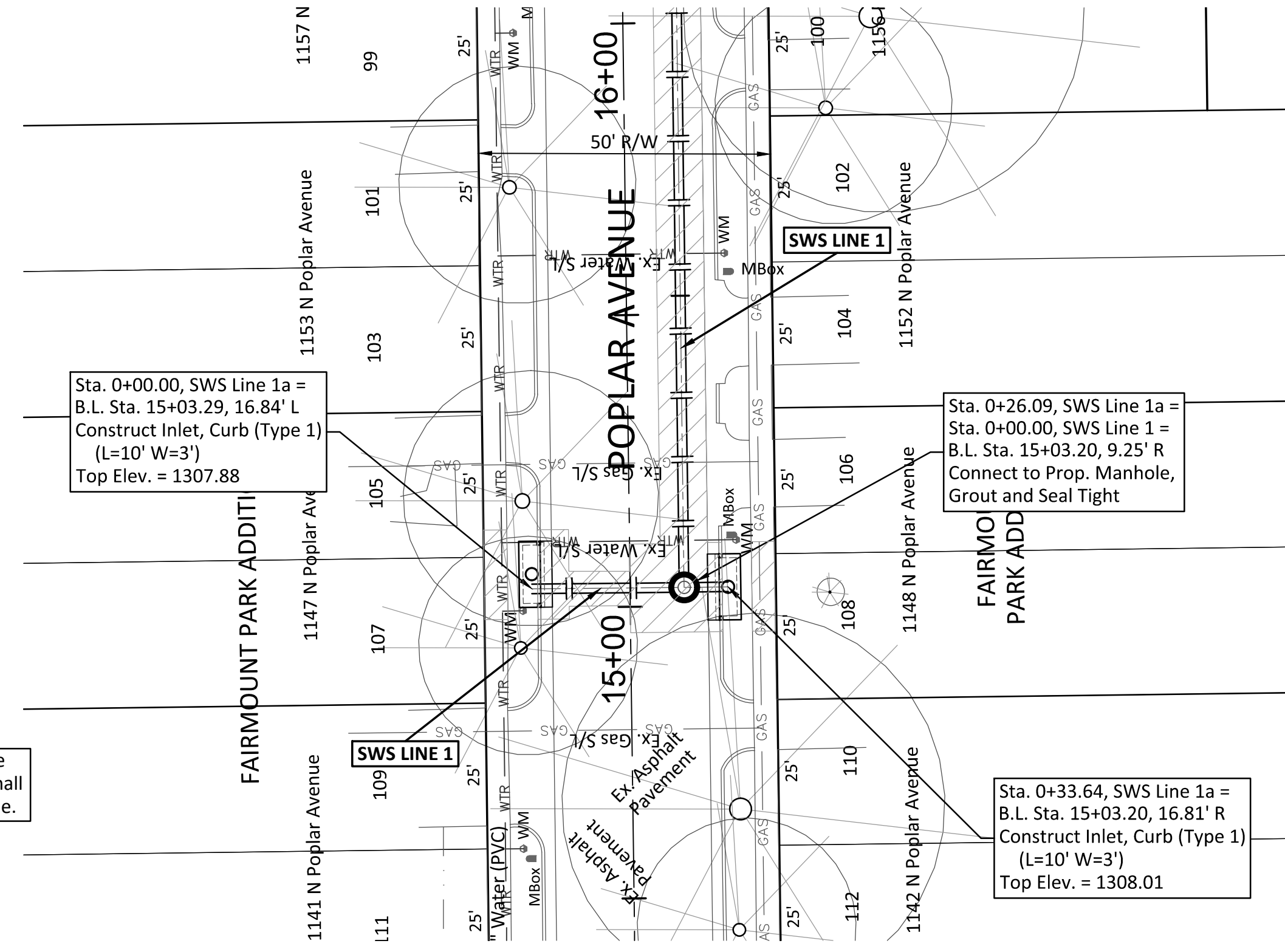

The Block Out for the 15" RCP in the Inlet at Sta. 0+00.00, SWS Line 1a shall be Located 2.5' Left of the Centerline.

Sta. 0+00.00, SWS Line 1a =
 B.L. Sta. 15+03.29, 16.84' L
 Construct Inlet, Curb (Type 1)
 (L=10' W=3')
 Top Elev. = 1307.88

Sta. 0+26.09, SWS Line 1a =
 Sta. 0+00.00, SWS Line 1 =
 B.L. Sta. 15+03.20, 9.25' R
 Connect to Prop. Manhole,
 Grout and Seal Tight

Sta. 0+33.64, SWS Line 1a =
 B.L. Sta. 15+03.20, 16.81' R
 Construct Inlet, Curb (Type 1)
 (L=10' W=3')
 Top Elev. = 1308.01

Note:
 Pavement, Sidewalks, Etc.
 To Be Removed Are
 Indicated By:

BENCHMARK:
 BM #1 - Crow's Foot Cut on Top of Curb 80' North of the Centerline
 of 11th Street North on the West Side of Poplar.
 Elev. = 1307.25 (NAVD 88)

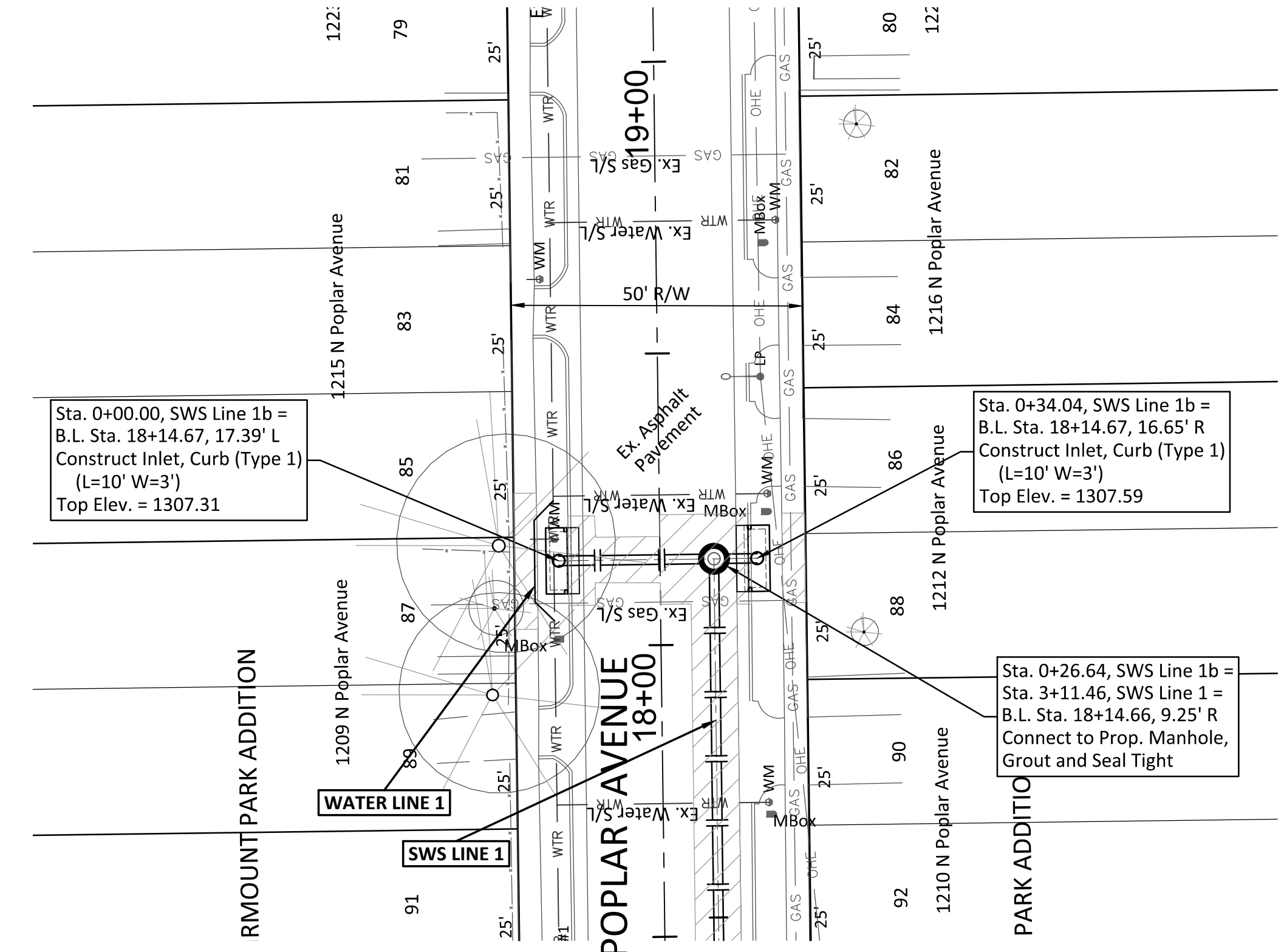

Sta. 0+00.00, SWS Line 1b =
 B.L. Sta. 18+14.67, 17.39' L
 Construct Inlet, Curb (Type 1)
 (L=10' W=3')
 Top Elev. = 1307.31

Sta. 0+34.04, SWS Line 1b =
 B.L. Sta. 18+14.67, 16.65' R
 Construct Inlet, Curb (Type 1)
 (L=10' W=3')
 Top Elev. = 1307.59

Sta. 0+26.64, SWS Line 1b =
 Sta. 3+11.46, SWS Line 1 =
 B.L. Sta. 18+14.66, 9.25' R
 Connect to Prop. Manhole,
 Grout and Seal Tight

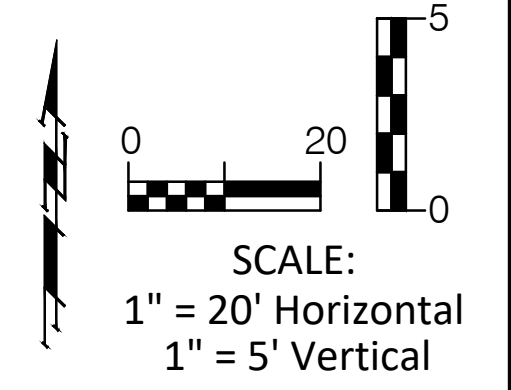

1315			
1310			
1305			
1300			
1295			
1290			
1285			
	Sta. 0+00.00, SWS Line 1a Construct Inlet, Curb (Type 1) (L=10' W=3') Top Elev. = 1307.88 Sta. 0+26.09, SWS Line 1a = Sta. 0+00.00, SWS Line 1 = Connect to Prop. Manhole, Grout and Seal Tight Sta. 0+33.64, SWS Line 1a Construct Inlet, Curb (Type 1) (L=10' W=3') Top Elev. = 1308.01		
	0+00.00	0+26.09	0+33.64

1315			
1310			
1305			
1300			
1295			
1290			
1285			
	Sta. 0+00.00, SWS Line 1b Construct Inlet, Curb (Type 1) (L=10' W=3') Top Elev. = 1307.31 Sta. 0+26.64, SWS Line 1b = Sta. 3+11.46, SWS Line 1 = Connect to Prop. Manhole, Grout and Seal Tight Sta. 0+34.04, SWS Line 1b Construct Inlet, Curb (Type 1) (L=10' W=3') Top Elev. = 1307.59		
	0+00.00	0+26.64	0+34.04