

BENCHMARKS:
 BM#1: RR spike in high line pole, 40' west and 30' south of Lot 60, Block D, Firefly Way Addition.
 Elev. = 1399.54 NAVD88

BM#2: Benchmark disc in top of curb, adjacent to fire hydrant 15' south of SE corner of Lot 2, Block C, Firefly Way Addition.
 Elev. = 1396.95 NAVD88

Baseline = CL Bracken Ct.

WATER VALVE LOCATION TABLE

VALVE NUMBER	STREET	BASELINE STATION	OFFSET DISTANCE	OFFSET DIRECTION
V7	Bracken Ct.	0+26.54	39.73'	Rt.
V8	Bracken Ct.	2+29.14	23'	Lt.

Paving contractor will be responsible to operate all water valves on the project, in the presence of the inspector, to ensure accessibility to the valves, and that all valves (except blowoffs) are left in the "ON" position when the project is completed.

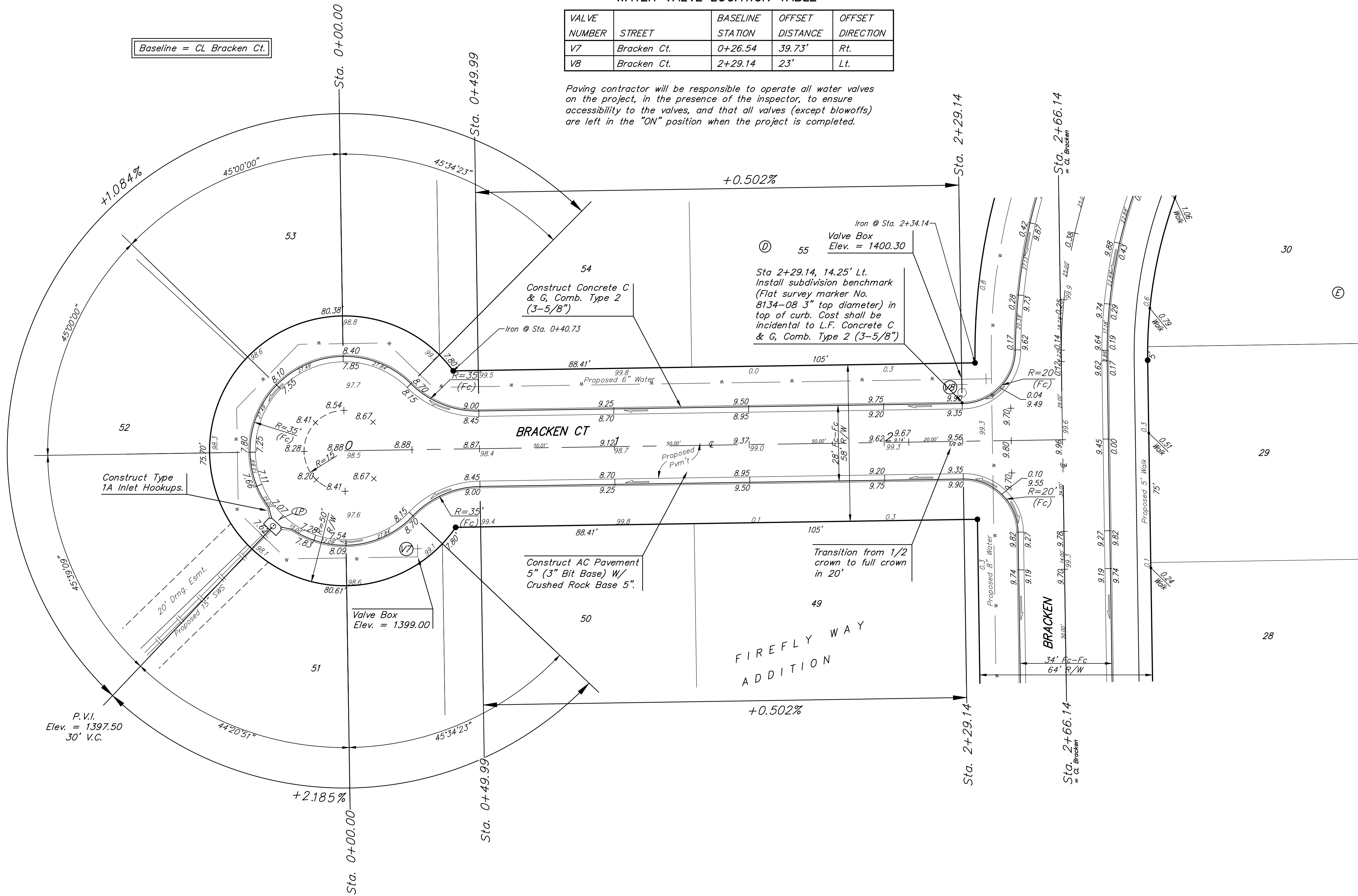
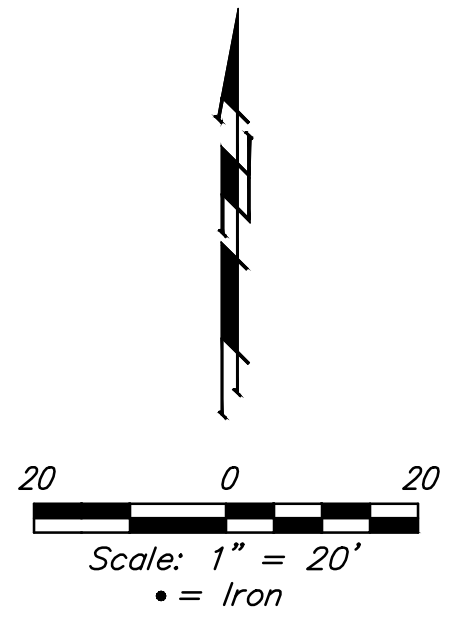

Subdivision Bench Marks

Street & Station	Location Description	Elevation
BRACKEN CT. 2+29.14, 14.25' Lt.	Adjacent to Fire Hydrant at W. End of N. Curb Return of Bracken & Bracken Ct. (Lots 49-55, Block D)	

NOTE: ROLL TYPE CURB & GUTTER (TYPE 2) TO BE CONSTRUCTED ON THE PAVEMENT SHOWN ON THIS SHEET. TOP OF CURB ELEVATIONS ARE GIVEN FOR FULL HEIGHT CURB (TYPE 4).

Baughman Company, P.A.
 ENGINEERING, ARCHITECTURE, PLANNING & LANDSCAPE ARCHITECTURE
 1000 W. BROAD ST., SUITE 200, RICHMOND, VA 23220
 (804) 781-1111
 www.baughman.com

BRACKEN CT.
 (LOTS 49-55, BLOCK D)