

GENERAL NOTES:

- The Contractor shall give all property owners and/or tenants of developed property abutting the project limits a minimum of ten (10) days advance notice prior to start of construction. See Project Special Provisions for additional notification requirements.
- Contractor will be required to provide a minimum advance notice of seventy-two (72) hours to utility companies prior to excavation or working adjacent to utilities. Kansas One-Call 687-2470
- Existing utilities and their locations, as shown on the plan, represent the best information obtainable at the time of design. The Contractor shall be aware that construction will occur in close proximity to existing utilities, and any conflicts with such utilities shall be reported to the Engineer. The Contractor should also be aware that some utility lines within the Project corridor may have been abandoned in place as new lines are installed. Contractor shall be responsible for notifying the affected utility to determine the status of said lines.
- The Water Department shall field locate water valves one time during construction when requested by the Contractor. It shall be the Contractor's responsibility to preserve such field locations during the construction process. Water valves, water valve boxes or fire hydrant damaged during construction shall be repaired by the Contractor at his own expense.
- All project waste including any trees, milled asphalt, rubble from miscellaneous structures, abandoned pipes, excess excavation & etc. shall be disposed of on sites to be provided by the Contractor. These sites shall be approved by the Engineer as to suitability, appearance and site location. Locations that, in the opinion of the Engineer, will leave an unsightly appearance will not be approved. All disposal sites must be approved by the Kansas Department of Health and Environment. Material either stockpiled or disposed of in a flood plain would require a Kansas State Board of Agriculture permit. Any material dumped in waters of the United States or wetlands is subject to U.S. Corps. of Engineers permitting regulations. Any material buried or stockpiled beyond approved construction limits would require additional archaeological investigations unless buried in a previously approved borrow location.
- The Contractor shall be made aware that he will be working in close proximity of existing utilities. Any conflicts with such utilities shall be reported to the Engineer. The Contractor shall coordinate the construction of this project with relocation of any existing utilities by the utility companies.
- Irons and monuments found are shown on the Plans. The Contractor shall be responsible for notifying the Engineer prior to excavation or clearing operations that will endanger said irons so that accurate ties can be determined for resetting. The Contractor shall be responsible for replacing shown property irons that are damaged or removed during construction. The Contractor shall procure a licensed Land Surveyor to locate and re-install the property iron.
- The Contractor shall be responsible for implementing erosion control methods during construction to prevent unnecessary silt/sediment discharge through downstream properties and/or storm sewer systems. The Contractor install and maintain erosion controls as directed by the Engineer. These controls may include, but not limited to: hay bales; silt Fences, temporary seeding, Excelsior I Erosion Control Blanket (Curlex), or approved equal, or other controls necessary to inhibit sediment runoff during construction.
- Sewer Service shall not be interrupted throughout the length of the Project. The Contractor shall be responsible for maintaining continuous sewage flows. Cost for by-pass pumping at all sewer crossings shall be SUBSIDIARY to other items in the Project.
- The Contractor shall not start work on the Project until the Project Inspector is assigned and is present on site. Any work done without inspection will be required to be uncovered for inspection. Staking and inspection for this Project will be the responsibility of the City of Wichita.
- The Contractor shall comply with all applicable safety regulations, Special Provisions and City of Wichita Specifications and Standards.
- The Contractor shall be responsible for all traffic control measures to facilitate construction. All Construction Zone markings and signage shall conform to the latest version of the Manual on Uniform Traffic Control Devices (MUTCD) as published by the US Dept. of Transportation, Federal Highway Administration. All costs associated with construction markings and signage shall be SUBSIDIARY to the lump sum Bid Item "Traffic Control".
- The Contractor shall protect utility lines that cross or abut the Project corridor. For larger lines, the Contractor's method of supporting the utility structure shall be provided to the Engineer, as well as the affected Utility Company's representative for review and approval. Any shutdown of a utility line that may be required by construction of this Project shall be coordinated with the said affected utility.
- Adjacent Buildings, Structures, Parking Lots, Driveways, etc. other than those shown for replacement shall be protected from damage during construction of this Project.
- A full depth saw cut of the existing surface courses or the existing total pavement thickness shall be provided at the locations where proposed construction abuts an existing surface course or pavement for which partial removal of that surface or pavement is required. Sawed joint to facilitate removal within three (3) feet of existing joints will not be permitted and for such instances the limits of removal shall extend to the existing joint. Such saw cuts will not be paid for directly and this cost shall be considered SUBSIDIARY to the pavement removal.
- All traffic signs that are located in direct conflict with the proposed construction shall be removed and protected from damage by the Contractor. All signs that are removed during construction shall be replaced or reset by the Contractor as soon as construction permits. Any sign damaged by the Contractor shall be replaced at no additional cost to the project. All Traffic Control Signs shall remain operational during all phases of the project by either resetting existing or erecting temporary signs. This shall include all school crossing, warning signs, and applicable regulatory signs. The cost for any removal, replacement and/or resetting of traffic signs shall be SUBSIDIARY to "Site Restoration".
- All Elevations shown are based on NAVD 88 Datum.
- Existing Power & Light poles may require bracing or removal/replacement during certain phases of the Project. The Contractor shall be responsible for coordinating the pole bracing with Randy Truitt with Westar at 261-6521 at least 3 weeks prior to beginning construction.
- All existing sanitary service connections that are active shall be reconnected to the new sewer line. To be paid as measured quantity bid item "Service Line Reconnections." Contractor is to confirm that all buildings that are being served will be served during and after construction and that any service found that is thought to be dead is confirmed to be dead before abandoning the connection.
- The original water mains for this neighborhood were located in the back yards with service lines going into the back of the houses. As new water mains were installed, the meters were set closer to the new mains, but there is no record of where the service lines were installed. As a result, the Contractor may encounter abandoned or live water services during the installation of the proposed sanitary sewer. Abandoned service lines shall be removed as necessary and both ends crimped off, and all cost associated with this work shall be SUBSIDIARY to the pipe installation. Live water service lines shall be repaired as soon as possible by installing a section of 1" plastic line and using approved fittings and inserts to connect to the existing ends. All cost associated with repairing live water line services shall be SUBSIDIARY to the Measured Quantity Bid Item "Service Reconnection, Water".

RECAPITULATION OF QUANTITIES		
ITEM	QUANTITY TOTAL	UNIT
LUMP SUM BID ITEMS - SANITARY SEWER		
SITE CLEARING	1	Lump Sum
SITE RESTORATION	1	Lump Sum
SODDING	1	Lump Sum
REMOVAL OF EXISTING STRUCTURES (Includes Pipe, Manholes, etc.)	1	Lump Sum
MEASURED QUANTITY BID ITEMS - SANITARY SEWER		
PIPE, SS 8"	565	Ft.
MH, STANDARD SS (4')	6	Each
SERVICE RECONNECTION, SEWER (4")	14	Each
MH, OUTSIDE DROP CONSTRUCTED	1	Each
TREE REMOVED, LARGE	1	Each
TREE REMOVED, SMALL	1	Each
FENCE REMOVED & RESET	60	Ft.
MEASURED QUANTITY BID ITEMS - PAVING		
CONCRETE DRIVEWAY REMOVED AND REPLACED	20	Ft.
CONCRETE SIDEWALK REMOVED AND REPLACED	80	Ft.
MEASURED QUANTITY BID ITEMS - EROSION CONTROL		
BMP, CONSTRUCTION ENTRANCE	1	Each

TURF RESTORATION	
RESTORATION	QUANTITY
Sodding	150 S.Y.
For Information Only.	

LIST OF UTILITY COMPANIES

TYPE	OWNER	CONTACT	TELEPHONE	(ALT.)
Locator Service	Kansas One-Call		687-2470	800-344-7233
TV	Cox Communications (Cable)	James Walburn	260-7491	262-0661
Electric	Westar Energy - Distribution	Shane Price	261-6315	383-8600
Gas	Kansas Gas Service	Joe Bridgewater	832-3158	888-482-4950
Gas	Black Hills Energy	Jesse Lunsford	941-1607	800-694-8989
Telephone	AT&T	Jason Edwards	268-2008	800-344-7233
Water	Wichita Water Department	Greg Lolley	268-4555	219-8921
Storm Water Sewer	Wichita SWS Maintenance	Darrin Deutscher	268-4037	
Sanitary Sewer	Wichita Sewer Maintenance	Joe Loggins	268-4073	219-8921

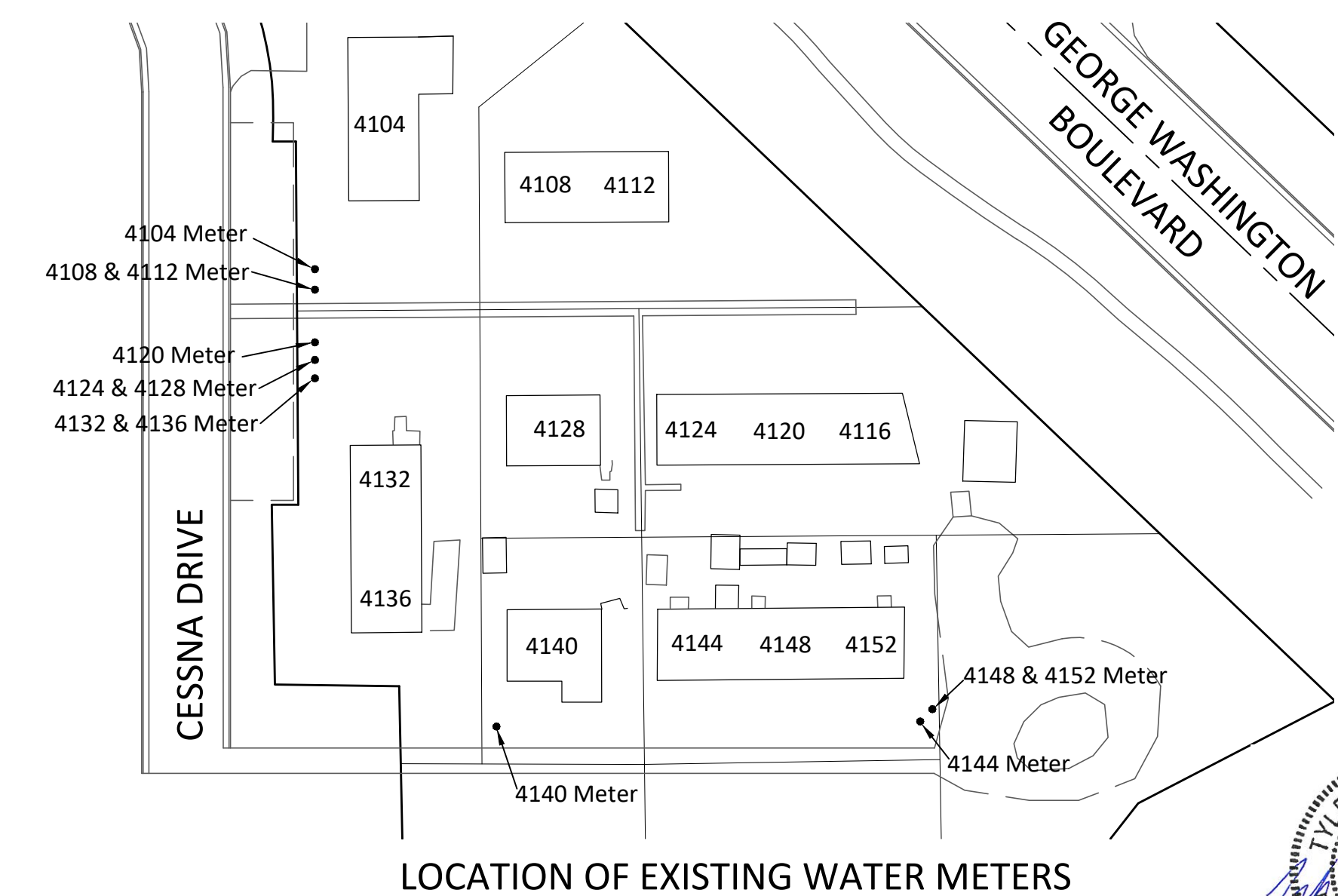

LOCATION OF EXISTING WATER METERS



BAUGHMAN COMPANY
 315 Ellis St. Wichita, KS 67211 316-262-7271
 BaughmanCo.com
BAUGHMAN

GENERAL NOTEPAGE
 4100 BLOCK OF EAST CESSNA

PROJECT NUMBER: 468-85390
 INTERNAL NUMBER: 18-11-E127
 DESIGN: TPV
 DRAWN: TPV
 DATE: Feb. 2020
 SHEET 2 OF 13