

1001 W. HAVENSA ALBERT
1001 W. CENTRAL
MICHIGAN, MS B-235

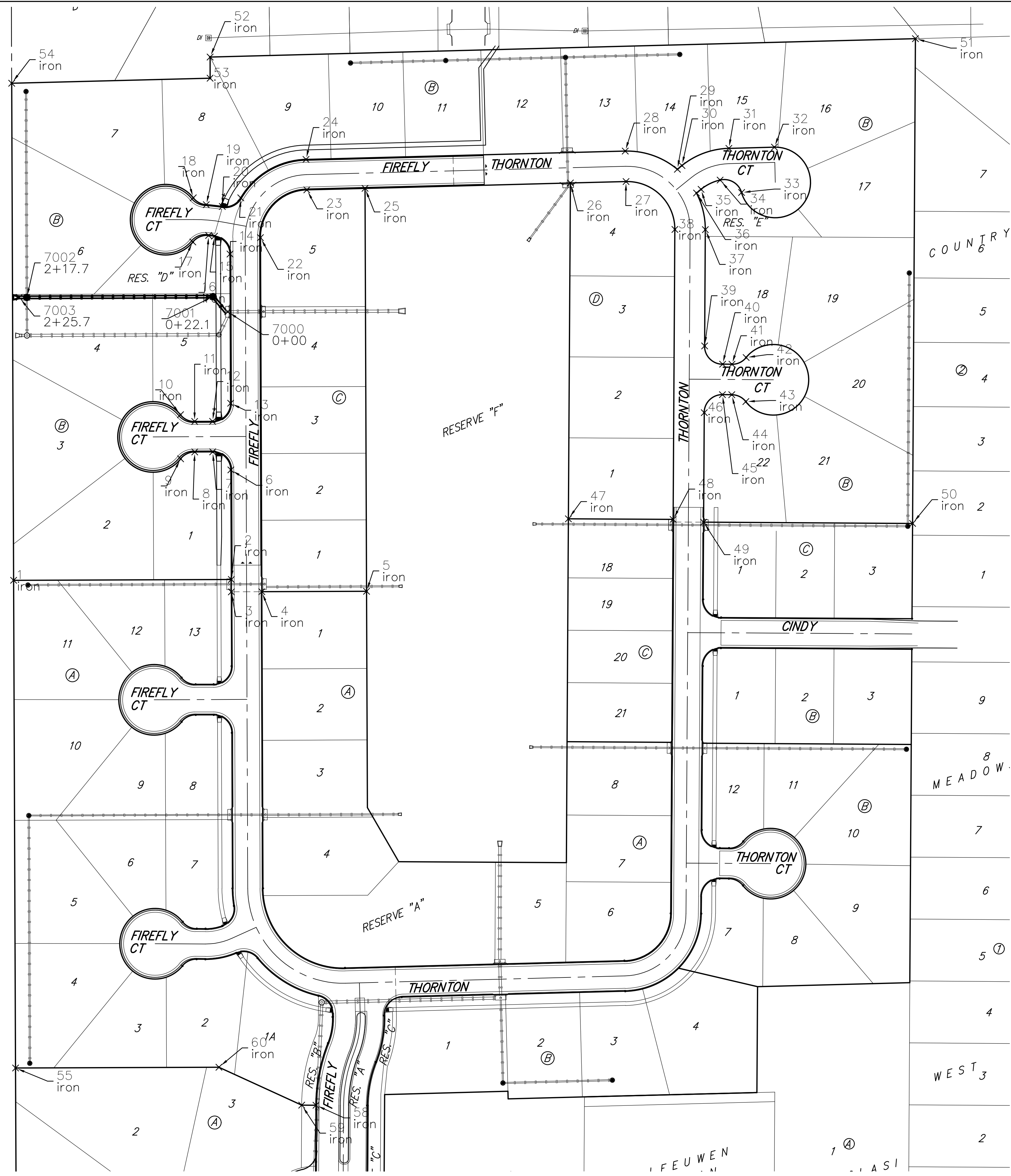

COORDS IRON

Point #	Northing	Easting	Raw Description
1	5741.09	5091.81	iron
2	5741.98	5320.42	iron
3	5728.98	5320.47	iron
4	5729.11	5352.47	iron
5	5729.53	5462.47	iron
6	5856.98	5319.97	iron
7	5875.91	5300.90	iron
8	5875.83	5282.03	iron
9	5868.65	5267.23	iron
10	5914.90	5267.05	iron
11	5907.83	5281.91	iron
12	5907.91	5300.78	iron
13	5926.98	5319.70	iron
14	6083.62	5319.09	iron
15	6102.36	5302.75	iron
16	6103.10	5296.60	iron
17	6096.24	5280.03	iron
18	6142.61	5280.50	iron
19	6135.41	5294.13	iron
20	6133.48	5310.95	iron
21	6142.59	5330.37	iron
22	6100.78	5351.03	iron
23	6150.95	5399.72	iron
24	6182.94	5398.89	iron
25	6152.55	5460.83	iron
26	6158.18	5676.57	iron
27	6159.70	5734.98	iron
28	6191.69	5734.14	iron
29	6172.59	5788.92	iron
30	6176.46	5793.73	iron
31	6194.53	5842.98	iron
32	6195.78	5890.79	iron
33	6148.20	5856.31	iron
34	6161.26	5833.80	iron
35	6151.53	5813.79	iron
36	6147.66	5808.98	iron
37	6109.23	5818.28	iron
38	6109.42	5786.28	iron
39	5987.10	5817.55	iron
40	5967.98	5836.43	iron

Point #	Northing	Easting	Raw Description
41	5967.92	5846.23	iron
42	5974.96	5861.10	iron
43	5928.71	5860.83	iron
44	5935.92	5846.04	iron
45	5935.98	5836.24	iron
46	5917.10	5817.13	iron
47	5805.67	5674.46	iron
48	5805.01	5784.46	iron
49	5802.10	5816.44	iron
50	5800.79	6035.90	iron
51	6309.69	6038.90	iron
52	6290.35	5298.19	iron
53	6268.16	5298.13	iron
54	6262.87	5089.76	iron
55	5229.10	5093.82	iron
56	5025.29	5094.62	iron
57	5033.48	5408.44	iron
58	5190.06	5409.37	iron
59	5190.15	5394.37	iron
60	5229.93	5307.41	iron

COORDS SWS

Point #	Northing	Easting	Raw Description
7000	6022.99	5316.66	0+00
7001	6038.91	5301.27	0+22.1
7002	6038.15	5105.68	2+17.7
7003	6038.12	5097.68	2+25.7

