

BENCHMARKS:
 BM #1: CHISELED CROSS CUT ON TOP OF CATCH BASIN, NORTH SIDE OF CENTRAL, 25.4' SOUTH & 95.7' WEST OF THE SOUTHWEST CORNER OF LOT 1, BLOCK A, CASTLEGATE ADDITION. ELEV. = 1341.99 (NAVD88)
 BM #2: CHISELED PLUS CUT INSIDE OF CHISELED SQUARE CUT, TOP OF CURB ON NORTH SIDE OF CINDY, 2.1' SOUTH & 14.9' EAST OF THE SOUTHEAST CORNER OF RESERVE "E", CASTLEGATE ADDITION. ELEV. = 1342.39 (NAVD88)

WATER VALVE LOCATION TABLE

VALVE NUMBER	STREET	BASELINE STATION	OFFSET DISTANCE	OFFSET DIRECTION
V3	Firefly	3+98.67	32'	Lt.
V4	Firefly	6+35.34	25'	Rt.
V5	Firefly	6+60.34	25'	Rt.

Paving contractor will be responsible to operate all water valves on the project, in the presence of the inspector, to ensure accessibility to the valves, and that all valves (except blowoffs) are left in the "ON" position when the project is completed.

Curve #1
 Curve Data Based on Centerline
 Rad. = 66' Delta = 88°43'38" Tangent = 64.55'
 Arc = 102.21' L.C. = 92.30' Def./Ft. = 26.04262 Min.

Station	Arc	8' Left	8' Right	Defl.	Total Defl.
3+71.67	-	-	-	0°00'00"	0°00'00"
3+75.00	3.33'	4.49'	2.17'	1°26'43"	1°26'43"
4+00.00	25.00'	33.51'	16.19'	10°51'04"	12°17'47"
4+07.06	7.06'	9.52'	4.60'	3°03'52"	15°21'39"
4+25.00	17.94'	24.12'	11.65'	7°47'12"	23°08'51"
4+50.00	25.00'	33.51'	16.19'	10°51'04"	33°59'55"
4+73.88	23.88'	32.03'	15.47'	10°21'54"	44°21'49"

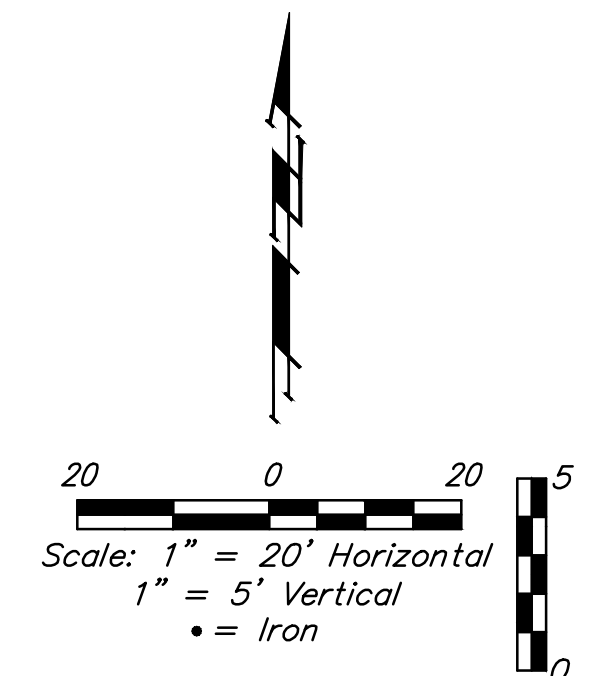
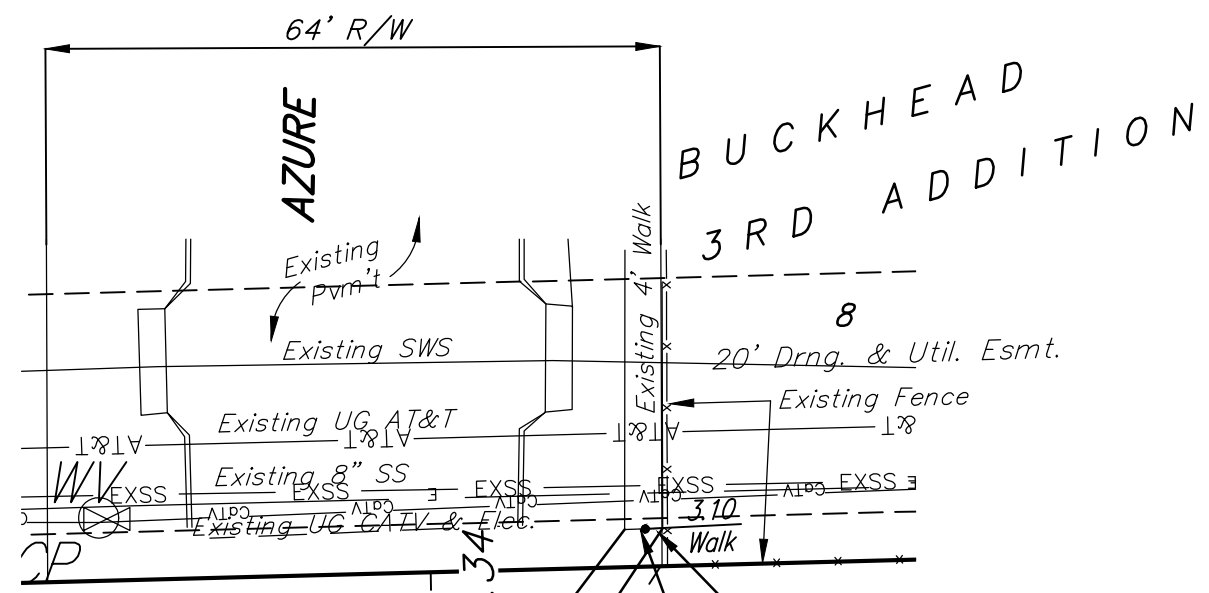
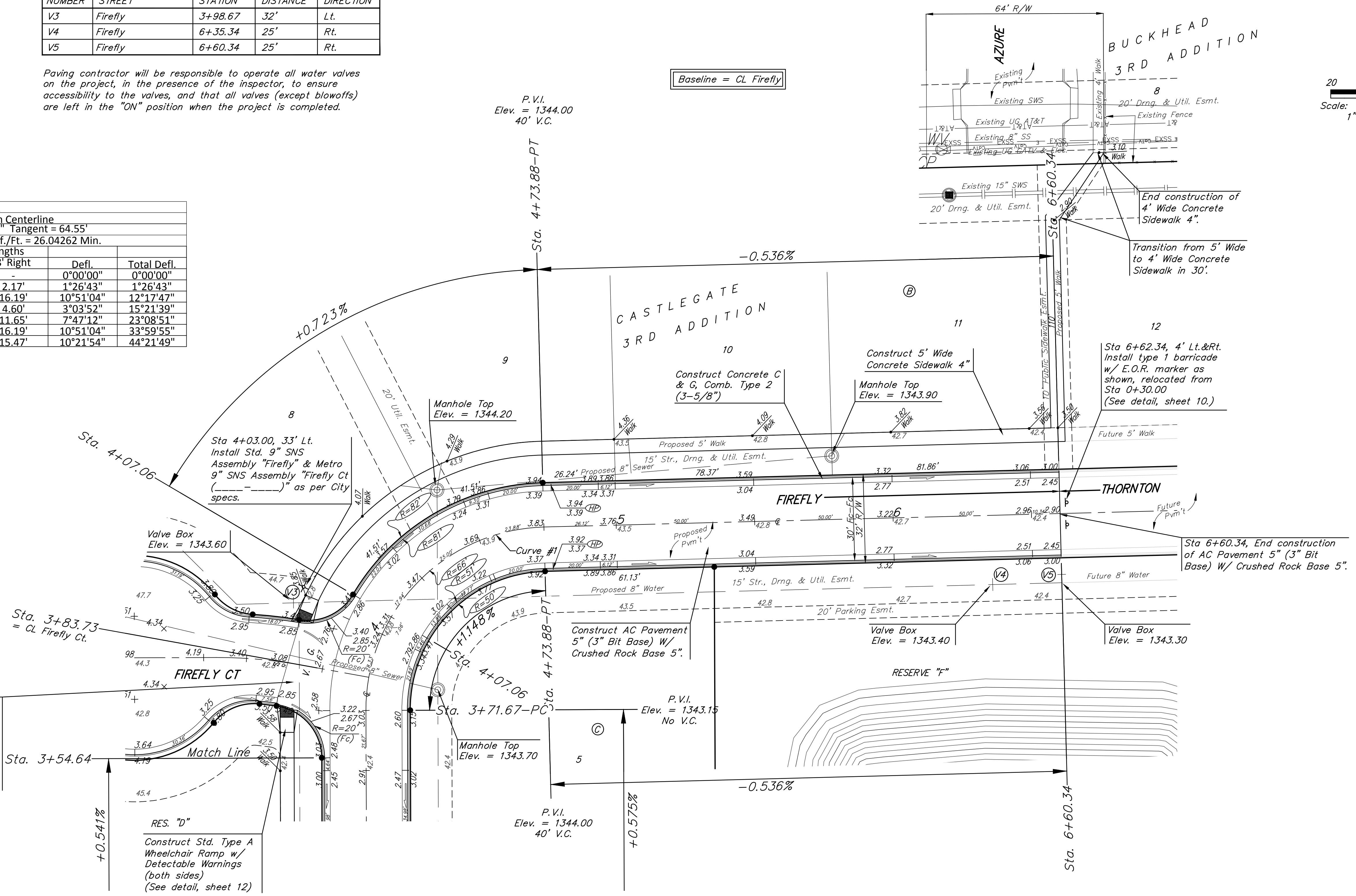

NOTE: ROLL TYPE CURB & GUTTER (TYPE 2) TO BE CONSTRUCTED ON THE PAVEMENT SHOWN ON THIS SHEET. TOP OF CURB ELEVATIONS ARE GIVEN FOR FULL HEIGHT CURB (TYPE 4).