

BENCHMARKS:
 BM #1: CHISELED CROSS CUT ON TOP OF CATCH BASIN, NORTH SIDE OF CENTRAL, 25.4' SOUTH & 95.7' WEST OF THE SOUTHWEST CORNER OF LOT 1, BLOCK A, CASTLEGATE ADDITION.
 ELEV. = 1341.99 (NAVD88)

BM #2: CHISELED PLUS CUT INSIDE OF CHISELED SQUARE CUT, TOP OF CURB ON NORTH SIDE OF CINDY, 2.1' SOUTH & 14.9' EAST OF THE SOUTHEAST CORNER OF RESERVE "E", CASTLEGATE ADDITION.
 ELEV. = 1342.39 (NAVD88)

Curve #2					
Curve Data Based on Centerline					
Rad. = 166.32' Delta = 10°27'54" Tangent = 15.23'					
Arc = 30.38' L.C. = 30.34' Def./Ft. = 10.33410 Min.					
Station	Arc	8' Left	8' Right	Defl.	Total Defl.
0+29.65	-	-	-	0°00'00"	0°00'00"
0+40.50	10.85'	12.35'	9.35'	1°52'08"	1°52'08"
0+45.24	4.74'	5.39'	4.08'	0°48'59"	2°41'07"
0+50.00	4.76'	5.42'	4.10'	0°49'11"	3°30'18"
0+53.63	3.63'	4.13'	3.13'	0°37'31"	4°07'49"
0+57.07	3.44'	3.92'	2.96'	0°35'33"	4°43'22"
0+60.03	2.96'	3.37'	2.55'	0°30'35"	5°13'57"

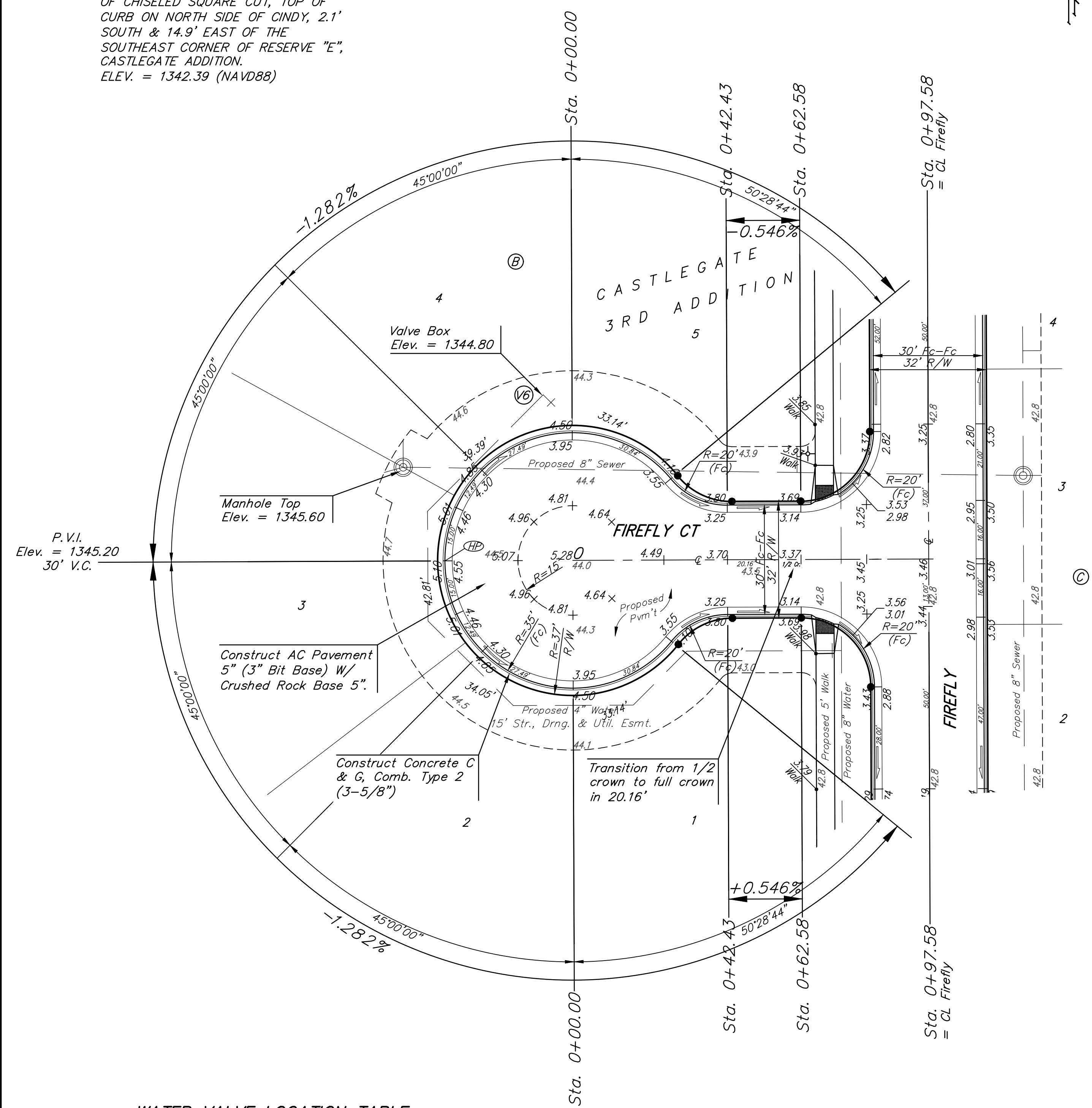
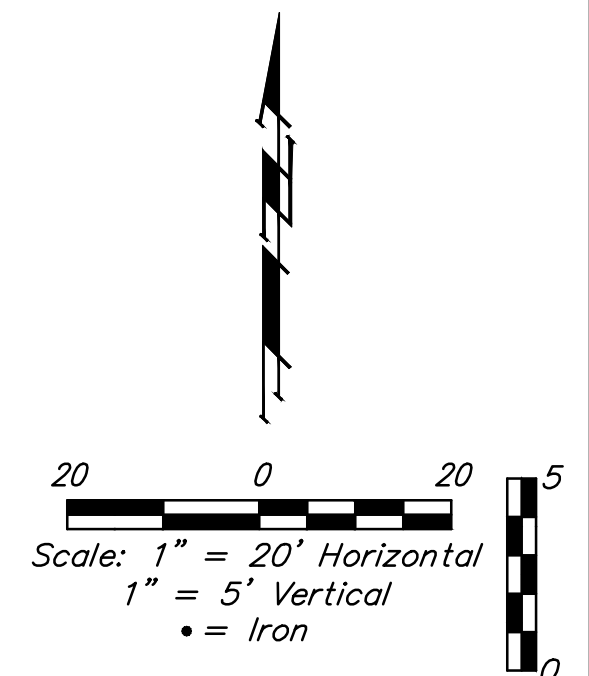

Baseline = CL Firefly Ct.

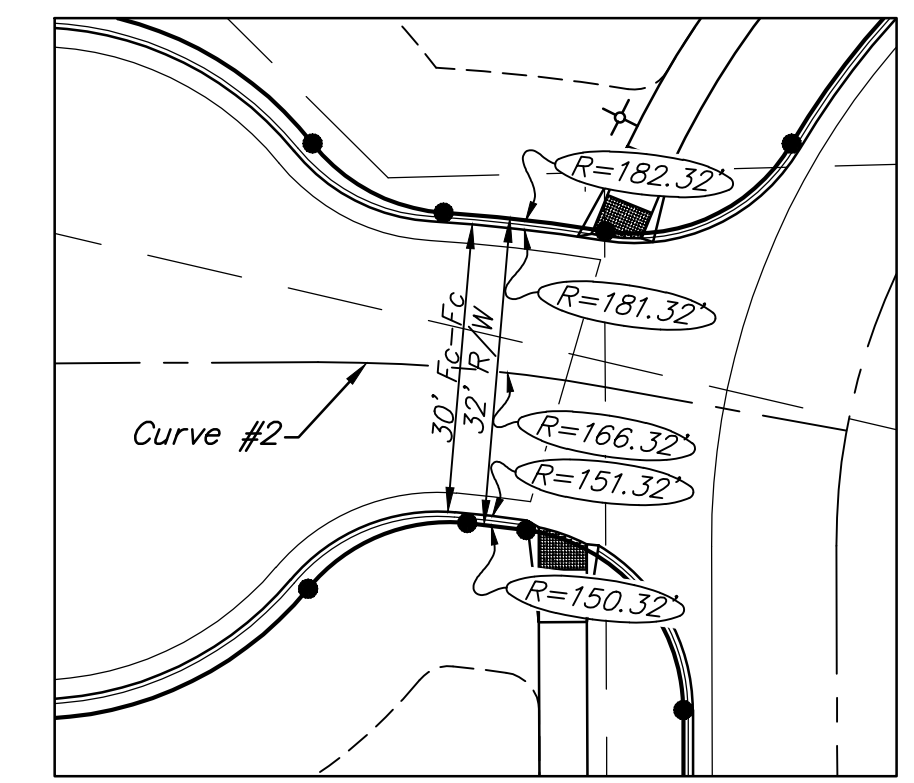
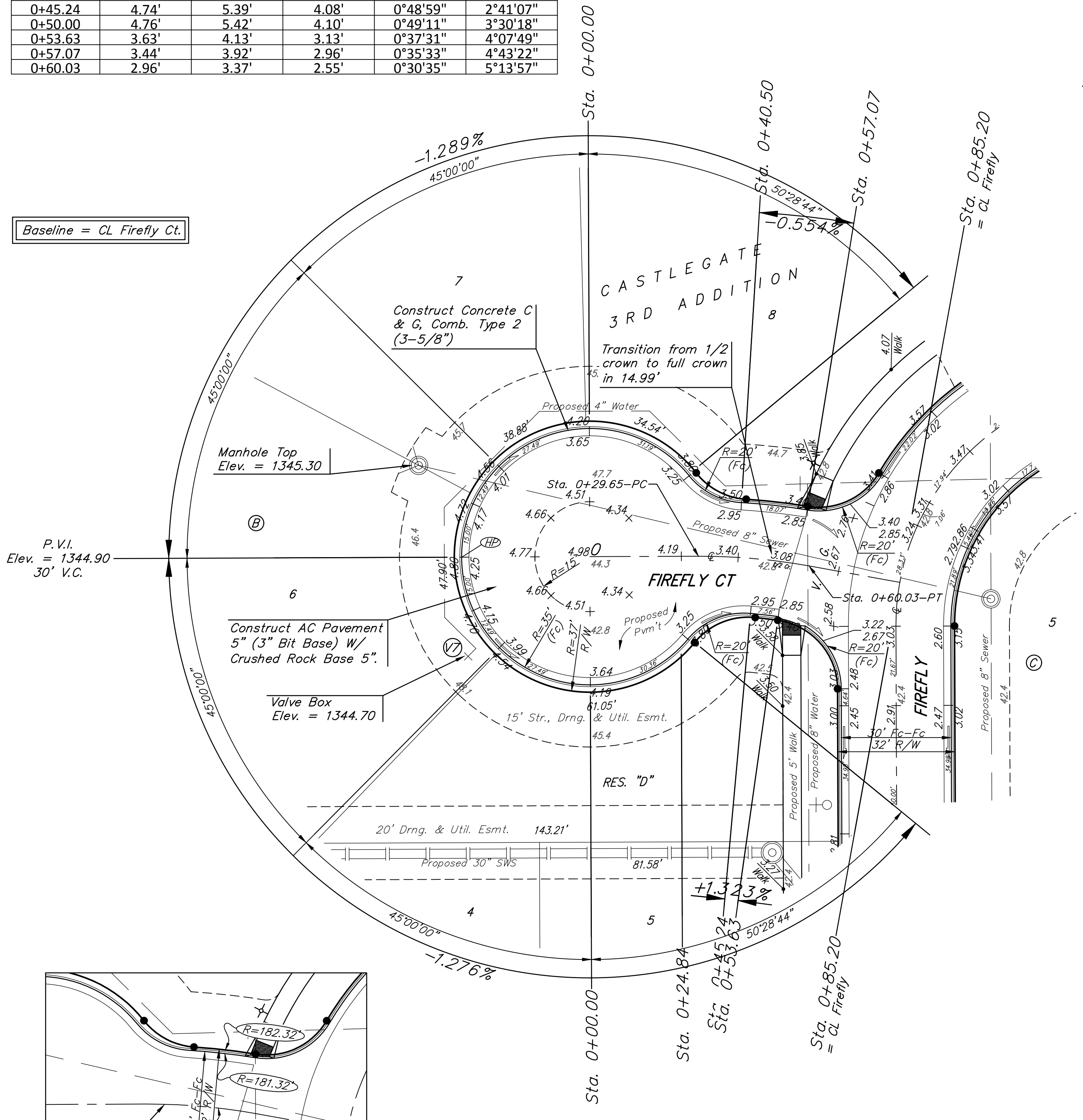

WATER VALVE LOCATION TABLE

VALVE NUMBER	STREET	BASELINE STATION	OFFSET DISTANCE	OFFSET DIRECTION
V6	Firefly Ct.	0-07.91	45.45'	Lt.
V7	Firefly Ct.	0-31.21	24.98'	Rt.

Paving contractor will be responsible to operate all water valves on the project, in the presence of the inspector, to ensure accessibility to the valves, and that all valves (except blowoffs) are left in the "ON" position when the project is completed.

NOTE: ROLL TYPE CURB & GUTTER (TYPE 2) TO BE CONSTRUCTED ON THE PAVEMENT SHOWN ON THIS SHEET. TOP OF CURB ELEVATIONS ARE GIVEN FOR FULL HEIGHT CURB (TYPE 4).