

13TH STREET & 135TH STREET

See Sheet No. 27 for Concrete Details  
See Sheet No. 23 for Sidewalk Staking Points  
Pavement joints shall be adjusted in the field to fit existing conditions when necessary  
See Sheet No. 7, 8 & 15 for NRDJ Concrete Pavement Locations  
NRDJ Concrete Pavement joints shall be: Lane Width x 10'

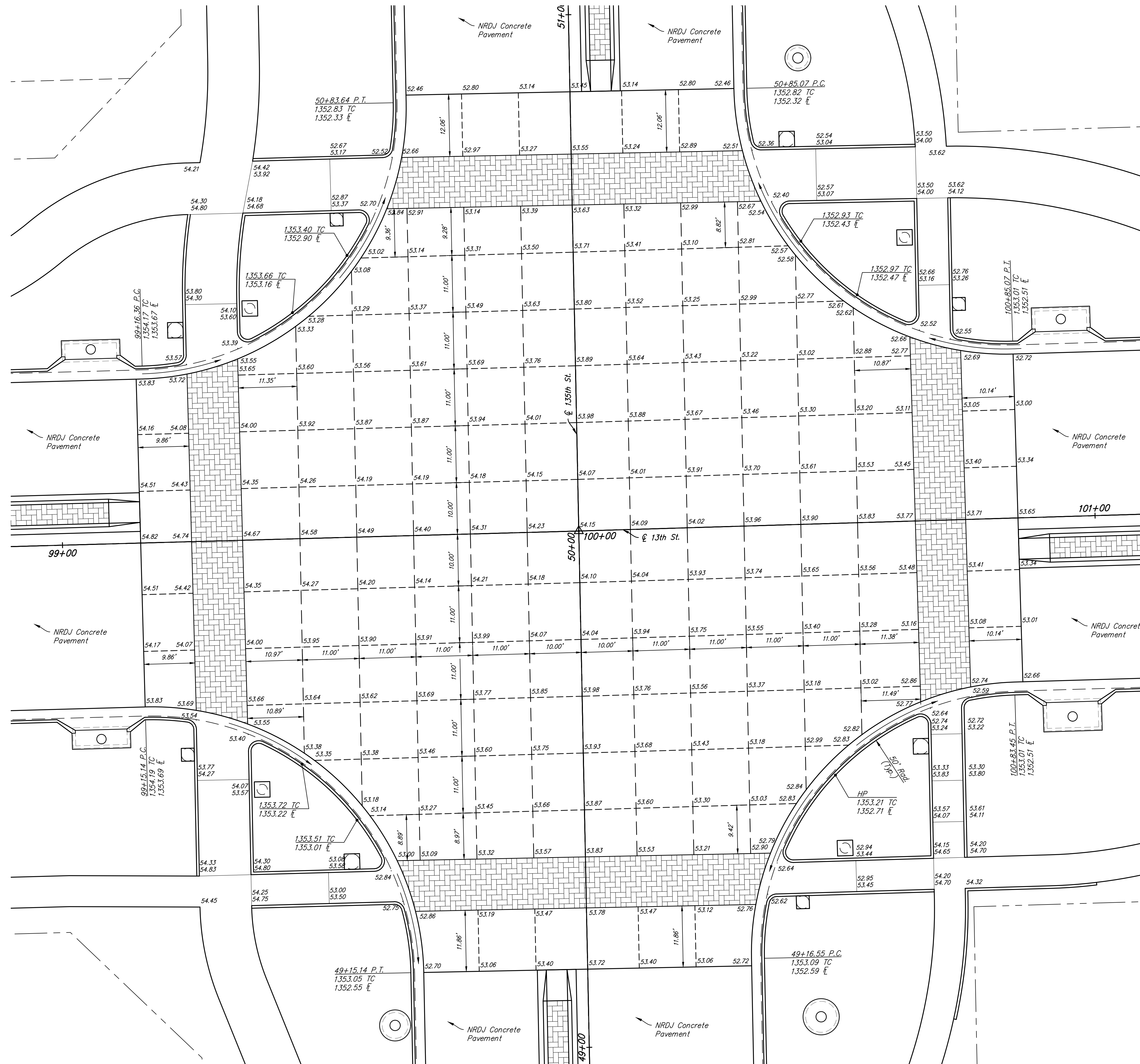
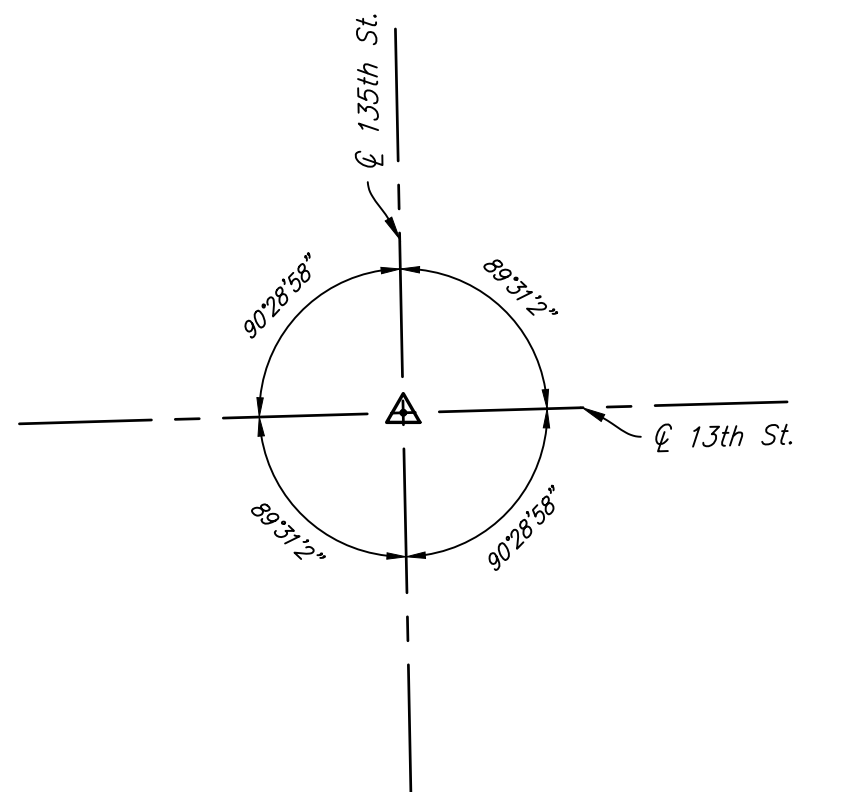

CITY OF WICHITA

INTERSECTION DETAIL

**Schwab Eaton**

DESIGNED	MS	DRAWN	JM	SCALE	SHEET NO.
CHECKED	MS	DATE	09/18	1" = 10'-0"	16

Drawn By: Schwab-Eaton, P.A.  
Plotted: 5/3/2019 1:42 PM  
File: 15.W01 Intersections.dwg