

Forestview shall remain open except during construction of connection with 13th St.

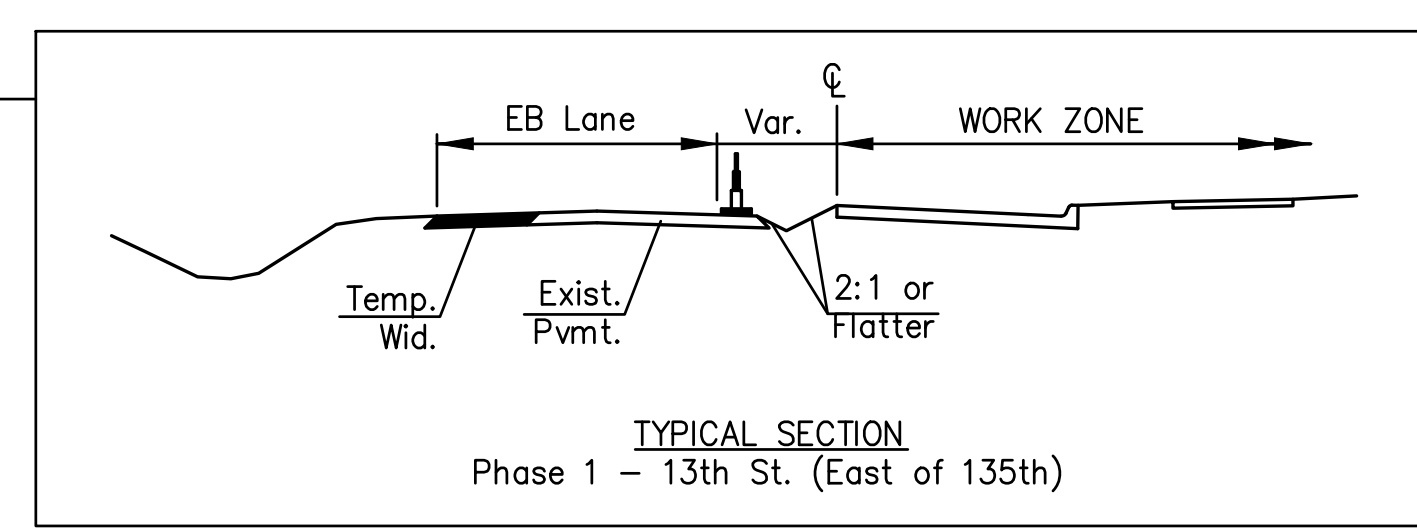

**LEGEND**

- Channelizing Device
- ➔ Traffic Flow
- ▨ Work Zone
- ▤ Temporary Pavement AC Pavement, Temporary 6" (5" Base)
- ⏏ Type III Barricades w/Lights (Complete Closure)
- ⏏ Type III Barricades (Staggered position)
- ⏏ Sign
- Type "A" Low Intensity Warning Light

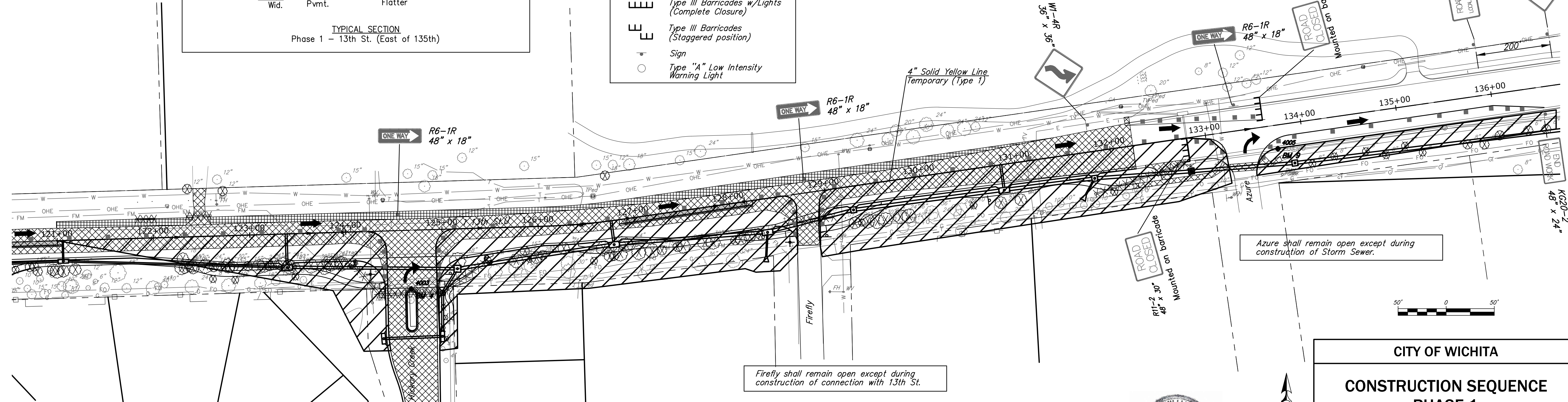

Firefly shall remain open except during construction of connection with 13th St.

Hickory Creek shall remain open except during construction of connection with 13th St.



CITY OF WICHITA  
**CONSTRUCTION SEQUENCE  
 PHASE 1**



DESIGNED	MS	DRAWN	MS	SCALE	No Scale	SHEET NO.	85
CHECKED	MS	DATE	09/18				



Drawn By: Schwab-Eaton, P.A.  
 5/3/2019 1:59 PM  
 Plotted:  
 File: 15.W01 Construction Sequence.dwg