

BENCHMARKS:
 BM #1: Crows foot cut at SE corner of curb inlet south side of Kollmeyer near NE corner of Lot 82, Block A, Edge Water Addition.
 Elev. = 1335.36 NGVD29

BM #2: Brass disc on top of curb by fire hydrant at SE corner of intersection of Kollmeyer and Kollmeyer Ct. (Lots 63-82, Block A) at the NW corner of Lot 82, Block A, Edge Water Addition.
 Elev. = 1336.61 NGVD29

Subdivision Bench Marks		
Street & Station	Location Description	Elevation
Kollmeyer Ct. 3+01.61, 14.25' Lt.	Adjacent to Fire Hydrant near common lot corner of Lots 97 & 98, Block A, Edge Water Add.	

WATER VALVE LOCATION TABLE

VALVE NUMBER	STREET	BASELINE STATION	OFFSET DISTANCE	OFFSET DIRECTION
V7	Kollmeyer Ct.	0+26.54	39.73'	Rt.
V8	Kollmeyer Ct.	3+01.61	23'	Lt.

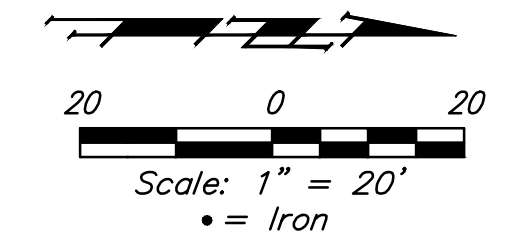

Paving contractor will be responsible to operate all water valves on the project, in the presence of the inspector, to ensure accessibility to the valves, and that all valves (except blowoffs) are left in the "ON" position when the project is completed.

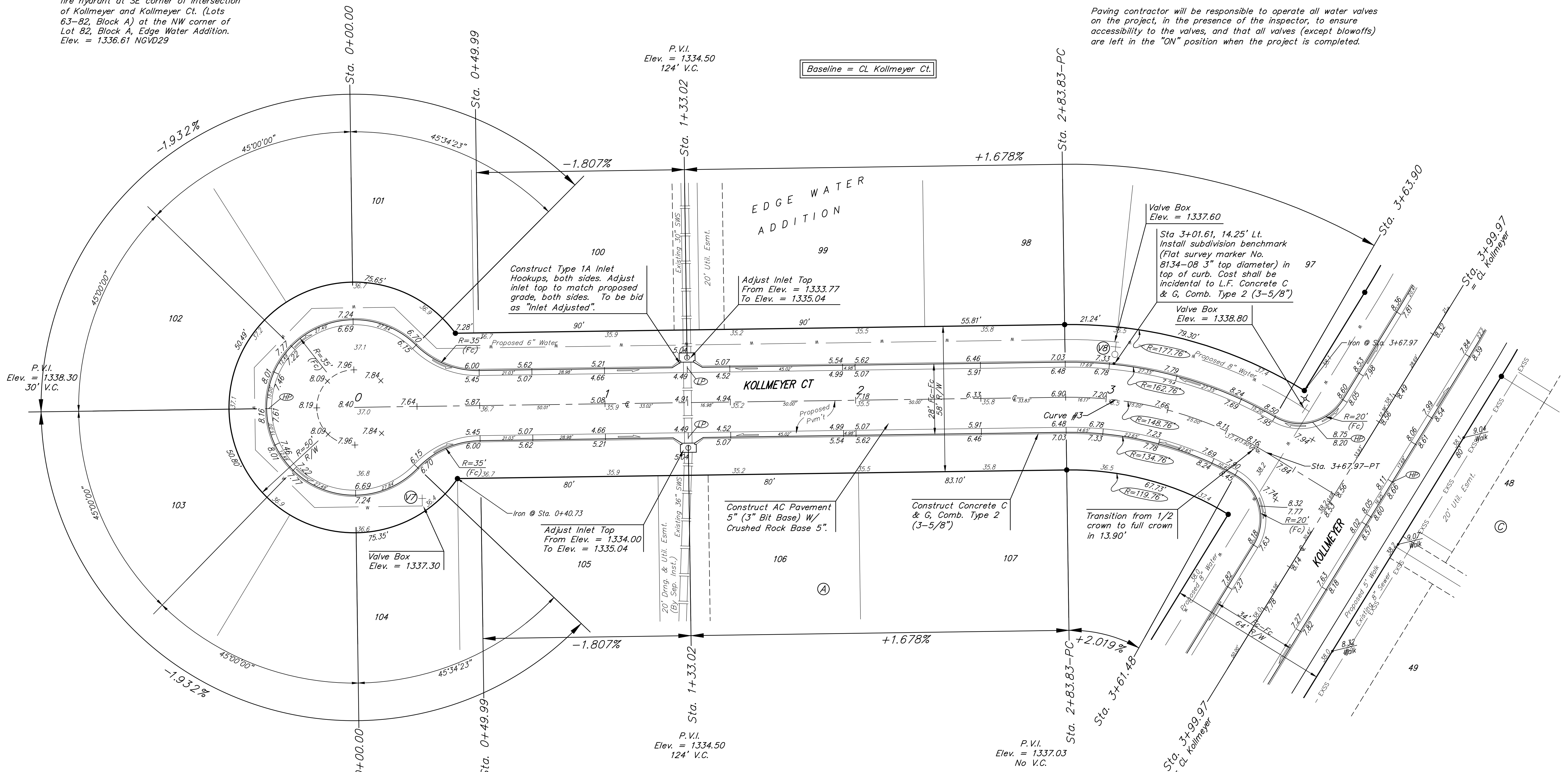

Curve #3					
Curve Data Based on Centerline					
Rad. = 148.76' Delta = 32°24'21" Tangent = 43.23'					
Arc = 84.14' L.C. = 83.02' Def./Ft. = 11.55425 Min.					
Face Chord Lengths					
Station	Arc	8' Left	8' Right	Defl.	Total Defl.
2+83.83	-	-	-	0°00'00"	0°00'00"
3+00.00	16.17'	18.55'	13.77'	3°06'50"	3°06'50"
3+25.00	25.00'	28.66'	21.28'	4°48'51"	7°55'41"
3+50.00	25.00'	28.66'	21.28'	4°48'52"	12°44'33"
3+61.48	11.48'	13.17'	9.78'	2°12'38"	14°57'11"
3+63.90	2.42'	2.78'	2.06'	0°27'58"	15°25'09"
3+67.97	4.07'	4.67'	3.47'	0°47'01"	16°12'10"

NOTE: ROLL TYPE CURB & GUTTER (TYPE 2) TO BE CONSTRUCTED ON THE PAVEMENT SHOWN ON THIS SHEET. TOP OF CURB ELEVATIONS ARE GIVEN FOR FULL HEIGHT CURB (TYPE 4).

EDGE WATER ADD. - PH. 4
KOLLMAYER CT.
 STREET IMPROVEMENTS
 DIVISIONS
 SHEET
 OF
4
23

Baughman Company, P.A.
 ENGINEERING, PLANNING, LANDSCAPE ARCHITECTURE
 1100 N. WILSON ST. #211 PHILADELPHIA, PA 19104
 PH: 215-381-1100 FAX: 215-381-1101
 www.baughman.com
 Date: 07/20/10
 Drawn: TMS
 Checked: JMS
 Approved: JMS